

F.A.P. RTE.	SECTION	COUNTY	TOTAL SHEETS	SHEET NO.
326	(111CS) W&RS-21	GRUNDY	85	42
STA. 18+00		TO STA. 24+10		
FED. ROAD DIST. NO.		ILLINOIS	FED. AID PROJECT	
CONTRACT NUMBER: 66720				

**TRAFFIC SIGNAL LEGEND**

- HANDHOLE
- DOUBLE HANDHOLE
- CONTROLLER AND CABINET
- SIGNAL HEAD WITH BACKPLATE
- POWER SERVICE INSTALLATION
- PEDESTRIAN SIGNAL HEAD
- PEDESTRIAN PUSH BUTTON
- SIGNAL POST
- STEEL COMBINATION MAST ARM ASSEMBLY AND POLE WITH LUMINAIRE, SODIUM VAPOR, 250 WATT
- CONDUIT: "T" TRENCH, "P" PUSHED
- DETECTOR LOOP
- LIGHT DETECTOR
- CONFIRMATION BEACON

**SCHEDULE OF SIGNAL HEAD QUANTITIES**

LOCATION	ITEM	UNIT	QUANTITY
1,2,6,7,9,10,14,15	SH, 1F, 3S, MAM	EACH	8
4,8,12,16	SH, 1F, 3S, BM	EACH	4
5,13	SH, 1F, 5S, MAM	EACH	2
3,11	SH, 1F, 5S, BM	EACH	2

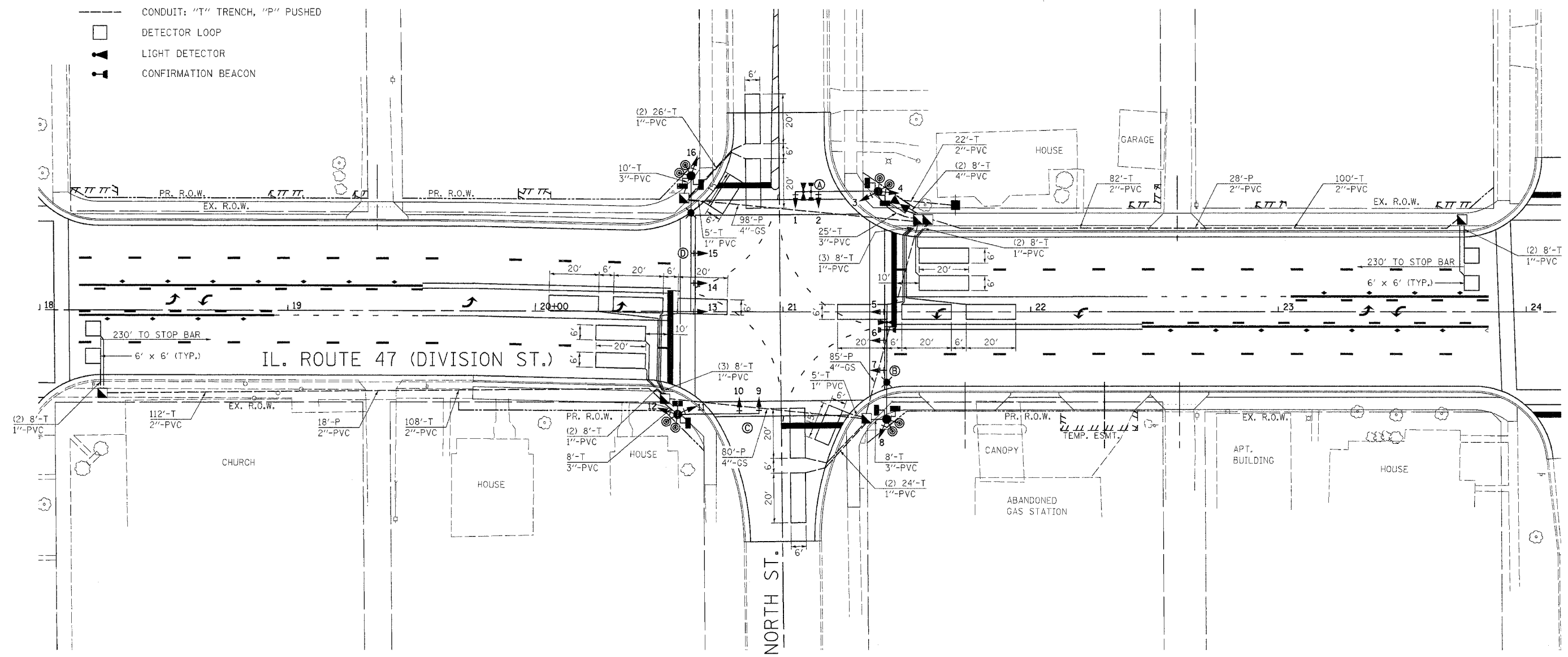

**SCHEDULE OF POLE/MAST ARM ASSEMBLIES**

LOCATION	LENGTH
A	34' S. M.A.A. & POLE
B	44' S. COMB. M.A.A. & POLE
C	32' S. M.A.A. & POLE
D	55' S. COMB. M.A.A. & POLE

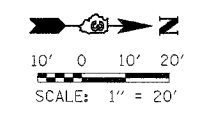

REVISIONS	
NAME	DATE

ILLINOIS DEPARTMENT OF TRANSPORTATION  
**PROPOSED TRAFFIC SIGNAL MODERNIZATION**  
 IL. 47 (DIVISION ST.) / NORTH ST.  
 SCALE: 1"=20'  
 DATE: JANUARY 2008  
 DRAWN BY: JVR  
 CHECKED BY: FML

**TRAFFIC SIGNAL PLANS - IL ROUTE 47 & NORTH ST.**