

F.A. RTE.	SECTION	COUNTY	TOTAL SHEETS	SHEET NO.
317	(22)I-1	IROQUOIS	13	1
FED. ROAD DIST. NO.	ILLINOIS	CONTRACT NO. 66755		

STATE OF ILLINOIS
DEPARTMENT OF TRANSPORTATION
DIVISION OF HIGHWAYS

**PROPOSED
HIGHWAY PLANS**

FAP ROUTE 317 (US 24)
SECTION (22)I-1

IROQUOIS COUNTY
C-93-036-08
STABILIZED SHOULDER REPAIR

INDEX OF SHEETS

1. COVER SHEET
2. GENERAL NOTES
3. SUMMARY OF QUANTITIES
- 4 - 5. TYPICAL SECTIONS
6. EXISTING PLAN
7. PROPOSED PLAN
8. TRAFFIC CONTROL SUPPLEMENTAL DETAILS
9. WIDTH RESTRICTION SIGNING
10. SHOULDER DETAILS
11. GUTTER TRANSITION A
12. GUTTER TRANSITION B
13. GUTTER OUTLET

STANDARDS

- | | |
|-----------|--|
| 000001-05 | STANDARD SYMBOLS, ABBREVIATIONS AND PATTERNS |
| 001001-01 | AREAS OF REINFORCEMENT BARS |
| 001006 | DECIMAL OF AN INCH AND OF A FOOT |
| 420001-07 | PAVEMENT JOINTS |
| 420701-02 | PAVEMENT FABRIC |
| 483001-04 | PCC SHOULDER |
| 606201-01 | TYPE B GUTTER (INLET, OUTLET AND ENTRANCE) |
| 630001-07 | STEEL PLATE BEAM GUARDRAIL |
| 631031-06 | TRAFFIC BARRIER TERMINAL, TYPE 6 |
| 635011-01 | REFLECTOR MARKER AND MOUNTING DETAILS |
| 701001-01 | OFF-ROAD OPERATIONS 2L, 2W, MORE THAN 4.5 m (15') AWAY |
| 701006-02 | OFF-ROAD OPERATIONS 2L, 2W, 4.5 m (15') TO 600 mm (24") FROM PAVEMENT EDGE |
| 701201-02 | LANE CLOSURE, 2L, 2W, DAY ONLY, FOR SPEEDS \leq 45 MPH |
| 701206-01 | LANE CLOSURE, 2L, 2W, NIGHT ONLY, FOR SPEEDS \leq 45 MPH |
| 701301-02 | LANE CLOSURE, 2L, 2W, SHORT TIME OPERATIONS |
| 701316-03 | LANE CLOSURE, 2L, 2W, BRIDGE REPAIR, FOR SPEEDS \leq 45 MPH |
| 701901 | TRAFFIC CONTROL DEVICES |

MICROFILMED _____
REEL NUMBER _____
AWARDED _____
RESIDENT ENGINEER _____
AS BUILT CHANGES WERE MADE
ON THE FOLLOWING SHEETS _____

J.U.L.I.E.
JOINT UTILITY LOCATION INFORMATION FOR EXCAVATION
1-800-892-0123

DISTRICT 3 NO. (815) 434-6131
PROJECT ENGINEER: JOE KANNEL
UNIT CHIEF: RON WOODSHANK

CONTRACT NO. 66755

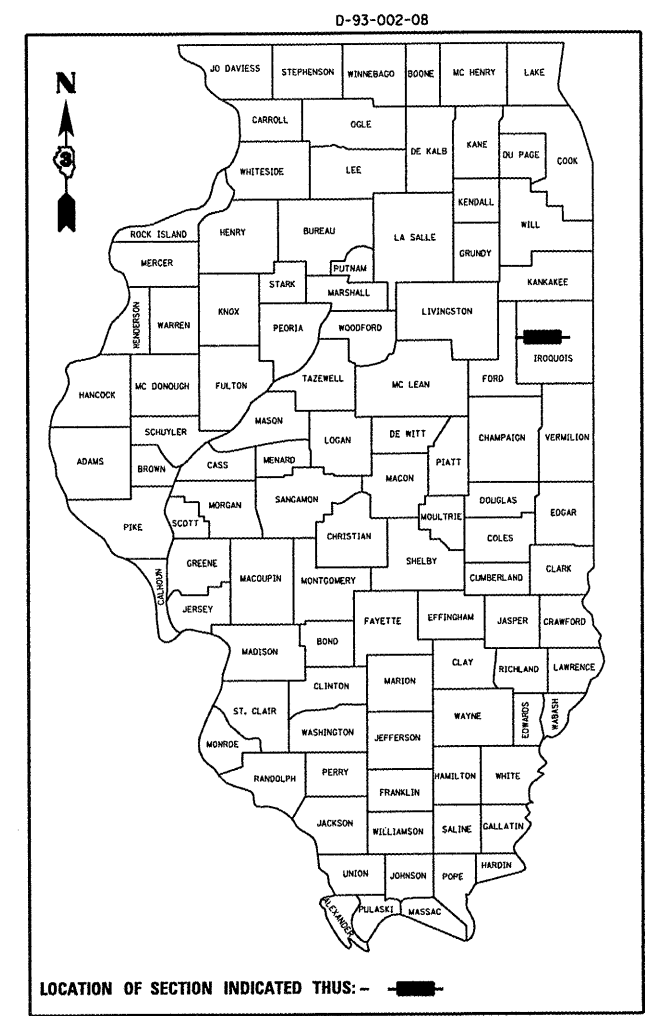

FUNCTIONAL CLASSIFICATION
RURAL - OTHER PRINCIPAL ARTERIAL
F.A.P. ROUTE 317 (US 24)
2005 ADT = 2600
P.V. = 75.0% M.U. = 19.2% S.U. = 5.8%

STATE OF ILLINOIS
DEPARTMENT OF TRANSPORTATION
DIVISION OF HIGHWAYS
SUBMITTED 3125 20 08
Gene F. Reed
DEPUTY DIRECTOR OF HIGHWAYS REGION ENGINEER
May 9, 2008
Eric E. Harnik
ENGINEER OF DESIGN AND ENVIRONMENT
May 9, 2008
Christine M. Reed
DIRECTOR OF HIGHWAYS, CHIEF ENGINEER

PRINTED BY THE AUTHORITY
OF THE STATE OF ILLINOIS

PROJECT LOCATION
ADJACENT TO S.N. 038-0186
4.52 MILES WEST OF I-57
STA. 1380+00 TO STA. 1389+42



LOCATION MAP
NOT TO SCALE
POINT LOCATION

GENERAL NOTES

PLAN DIMENSIONS AND DETAILS RELATIVE TO EXISTING PLANS ARE SUBJECT TO ROUTINE VARIATIONS. THE CONTRACTOR SHALL FIELD VERIFY EXISTING DIMENSIONS AND DETAILS AFFECTING NEW CONSTRUCTION AND MAKE NECESSARY APPROVED ADJUSTMENTS PRIOR TO CONSTRUCTION OR ORDERING OF MATERIALS. SUCH VARIATIONS SHALL NOT BE CAUSE FOR ADDITIONAL COMPENSATION FOR A CHANGE IN THE SCOPE OF THE WORK. HOWEVER, THE CONTRACTOR WILL BE PAID FOR THE QUANTITY FURNISHED BASED UPON THE UNIT BID PRICE FOR THE WORK.

FOR STABILIZATION, ALL TYPE III BARRICADES SHALL REQUIRE A MINIMUM OF FOUR SAND BAGS PER BARRICADE.

THE CONTRACTOR SHALL BE RESPONSIBLE FOR PROTECTING UTILITY PROPERTY FROM CONSTRUCTION OPERATIONS AS OUTLINED IN ARTICLE 107.31 OF THE STANDARD SPECIFICATIONS. THE "JULIE" NUMBER IS 1-800-892-0123. A MINIMUM OF FORTY-EIGHT (48) HOURS ADVANCE NOTICE IS REQUIRED.

THE COST OF ANY SAW CUTS MADE TO COMPLETE THE WORK AS DESCRIBED IN PLAN DETAILS, UNLESS OTHERWISE NOTED SHALL NOT BE PAID FOR SEPARATELY BUT SHALL BE INCLUDED WITH THE VARIOUS PAY REMOVAL PAY ITEMS INVOLVED.

WHERE SECTION OR SUBSECTION MONUMENTS ARE ENCOUNTERED, THE ENGINEER SHALL BE NOTIFIED BEFORE SUCH MONUMENTS ARE REMOVED. THE CONTRACTOR SHALL PROTECT AND CAREFULLY PRESERVE ALL MONUMENTS UNTIL AN AUTHORIZED SURVEYOR OR AGENT HAS WITNESSED OR OTHERWISE REFERENCED THEIR LOCATION. THE CONTRACTOR SHALL BE RESPONSIBLE FOR HAVING AN AUTHORIZED SURVEYOR REESTABLISH ANY SECTION OR SUBSECTION MONUMENTS DESTROYED BY HIS OPERATIONS.

ABANDONED UNDERGROUND UTILITIES THAT CONFLICT WITH CONSTRUCTION SHALL BE DISPOSED OF OUTSIDE THE LIMITS OF THE RIGHT OF WAY ACCORDING TO ARTICLE 202.03 OF THE STANDARD SPECIFICATIONS AND AS DIRECTED BY THE ENGINEER. THIS WORK WILL NOT BE PAID FOR SEPARATELY BUT SHALL BE INCLUDED IN THE COST OF EARTH EXCAVATION.

THE THICKNESS OF HMA SHOWN ON THE PLANS IS THE NOMINAL THICKNESS. DEVIATIONS FROM THE NOMINAL THICKNESS WILL BE PERMITTED WHEN SUCH DEVIATIONS OCCUR DUE TO IRREGULARITIES IN THE EXISTING SURFACE OR BASE ON WHICH THE HMA IS PLACED.

ANY REFERENCE TO A STANDARD IN THESE PLANS SHALL BE INTERPRETED TO MEAN THE EDITION AS INDICATED BY THE SUBNUMBER LISTED ON THE INDEX OF SHEETS OR THE COPY OF THE STANDARD INCLUDED IN THESE PLANS.

REINFORCEMENT BARS SHALL CONFORM TO THE REQUIREMENTS OF ASTM A 706 GR 60 (IL MODIFIED). SEE SPECIAL PROVISIONS.

REINFORCEMENT BARS DESIGNATED (E) SHALL BE EPOXY COATED.

PREPARED BY: *Rufanell*
 DISTRICT STUDIES & PLANS ENGINEER

DATE: 3-25-08

EXAMINED BY: *Heibert K. Jung*
 DISTRICT CONSTRUCTION ENGINEER

[Signature]
 DISTRICT MATERIALS ENGINEER

Bruce Hucker
 DISTRICT OPERATIONS ENGINEER

FILE NAME = c:\projects\cm307\details.dgn	USER NAME = carpenterdj	DESIGNED - DRAWN -	REVISED - REVISED -	STATE OF ILLINOIS DEPARTMENT OF TRANSPORTATION	GENERAL NOTES	F.A.P. RTE. 317	SECTION (22)1-1	COUNTY IROQUOIS	TOTAL SHEETS 13	SHEET NO. 2
PLOT SCALE = 1/8" = 1'-0"	CHECKED -	REVISED -	SCALE: _____			STA. 1380+00 TO STA. 1393+00	FED. ROAD DIST. NO. _____	(ILLINOIS) STATE AID PROJECT	CONTRACT NO. 66755	
PLOT DATE = Mar 07, 2008 - 07:35:01 AM	DATE -	REVISED -								

SUMMARY OF QUANTITIES

CODE NO.	ITEM	UNIT	TOTAL QUANTITY	RURAL 100% STATE SFTY-2A
20200100	EARTH EXCAVATION	CU YD	53.3	53.3
42001200	PAVEMENT FABRIC	SQ YD	331	331
44004260	PAVED SHOULDER REMOVAL (SPECIAL)	SQ YD	350	350
60600095	CLASS SI CONCRETE (OUTLET)	CU YD	2.2	2.2
60602800	CONCRETE GUTTER, TYPE B	FOOT	350	350
63000135	STEEL PLATE BEAM GUARD RAIL, TYPE B (SPECIAL)	FOOT	316	316
63100215	TRAFFIC BARRIER TERMINAL, TYPE 6 (SPECIAL)	EACH	1	1
63200310	GUARDRAIL REMOVAL	FOOT	350	350
67100100	MOBILIZATION	L SUM	1	1
70100100	TRAFFIC CONTROL AND PROTECTION, STANDARD 701316	EACH	1	1
70100450	TRAFFIC CONTROL AND PROTECTION, STANDARD 701201	L SUM	1	1
70106500	TEMPORARY BRIDGE TRAFFIC SIGNALS	EACH	1	1
* 78008210	POLYUREA PAVEMENT MARKING TYPE I - LINE 4"	FOOT	1220	1220
* 78008230	POLYUREA PAVEMENT MARKING TYPE I - LINE 6"	FOOT	80	80
* 78200410	GUARDRAIL MARKERS, TYPE A	EACH	5	5
78300100	PAVEMENT MARKING REMOVAL	SQ FT	328	328
X4832450	PORTLAND CEMENT CONCRETE SHOULDERS 11" (SPECIAL)	SQ YD	331	331
* X7200201	WIDTH RESTRICTION SIGNING	L SUM	1	1

* SPECIALTY ITEM

FILE NAME = c:\projects\main09\cm307\details.dgn	USER NAME = woodshenk1	DESIGNED - ---	REVISED - ---	STATE OF ILLINOIS DEPARTMENT OF TRANSPORTATION	SUMMARY OF QUANTITIES	F.A.P. RTE. 317	SECTION (221)-1	COUNTY IROQUOIS	TOTAL SHEETS 13	SHEET NO. 3
PLOT SCALE = 1/8" = 100' / IN.		CHECKED - ---	REVISED - ---	SCALE: -----		STA. 1380+00 TO STA. 1393+00		CONTRACT NO. 66755		
PLOT DATE = Mar 27, 2008 - 08:27:53 AM		DATE - -----	REVISED - ---	FED. ROAD DIST. NO. - ILLINOIS STATE AID PROJECT						

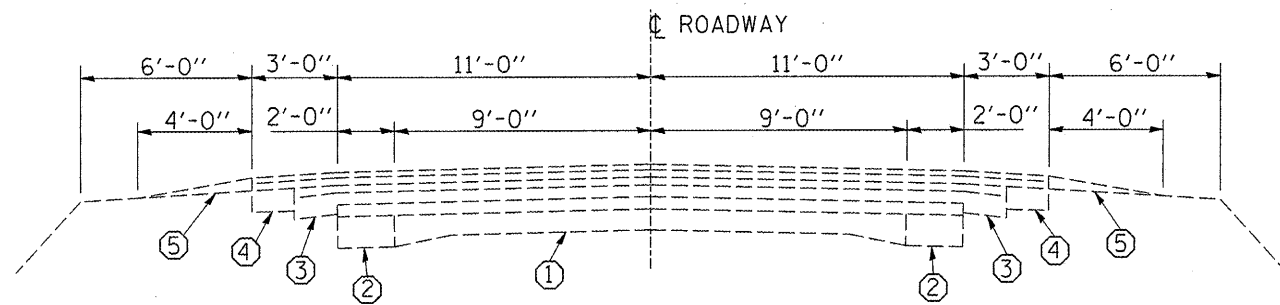

EXISTING TYPICAL SECTION 1
STA. 1380+00 TO STA. 1380+10

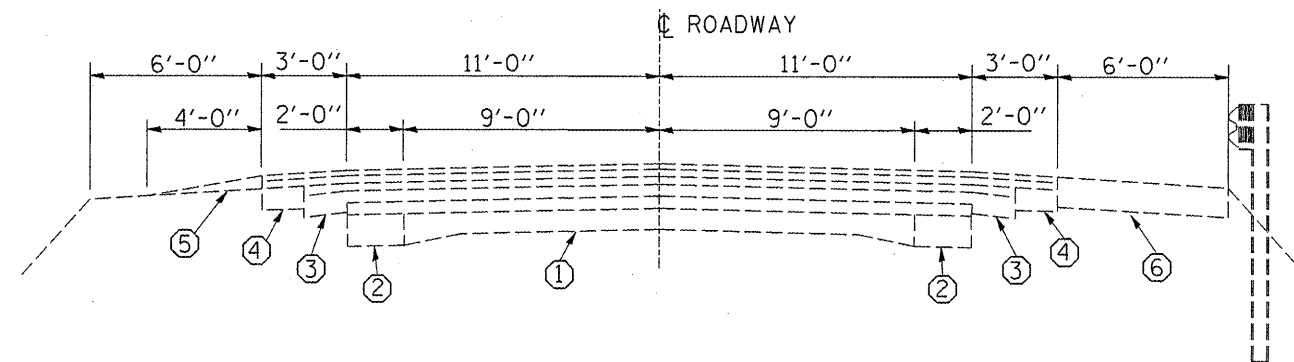

EXISTING TYPICAL SECTION 3
STA. 1380+76 TO STA. 1385+90

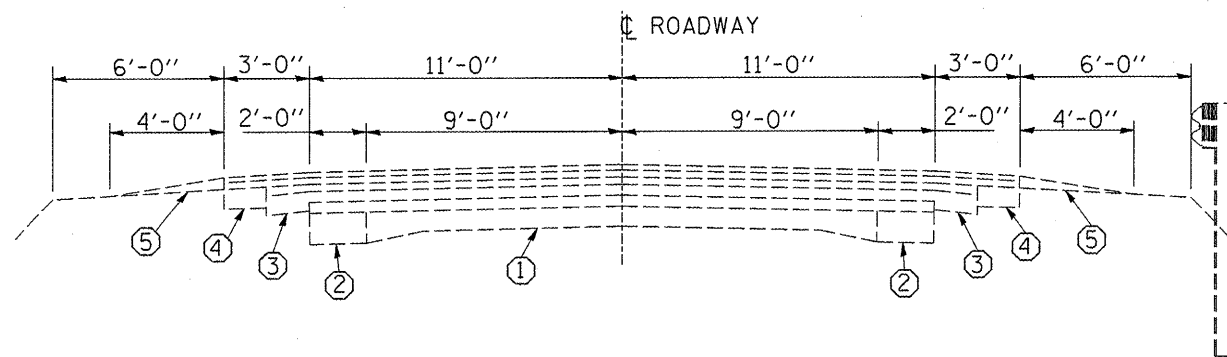

EXISTING TYPICAL SECTION 2
STA. 1380+10 TO STA. 1380+76

LEGEND

- ① PCC PAVEMENT 9''-6''-9''
- ② PCC WIDENING 9'' WITH ±13'' HOT-MIX ASPHALT OVERLAY
- ③ HOT-MIX ASPHALT SHOULDER 6'' WITH ±7'' HOT-MIX ASPHALT OVERLAY
- ④ HOT-MIX ASPHALT WIDENING 9'' WITH ±3'' HOT-MIX ASPHALT OVERLAY
- ⑤ AGGREGATE SHOULDER
- ⑥ HOT-MIX ASPHALT SHOULDER 9''

FILE NAME = c:\projects\omeur09\cm387\details.dgn	USER NAME = carpenterdj	DESIGNED - ---	REVISED - ---
		DRAWN - ---	REVISED - ---
		CHECKED - ---	REVISED - ---
		DATE - ---	REVISED - ---
PLOT SCALE = 1/83.1218 ' / IN.			
PLOT DATE = Mar 07, 2008 - 07:35:14 AM			

**STATE OF ILLINOIS
DEPARTMENT OF TRANSPORTATION**

TYPICAL SECTIONS

SCALE: ----- STA. 1380+00 TO STA. 1393+00

F.A.P. RTE.	SECTION	COUNTY	TOTAL SHEETS	SHEET NO.
317	(22)I-1	IROQUOIS	13	4
FED. ROAD DIST. NO. - ILLINOIS STATE AID PROJECT			CONTRACT NO. 66755	

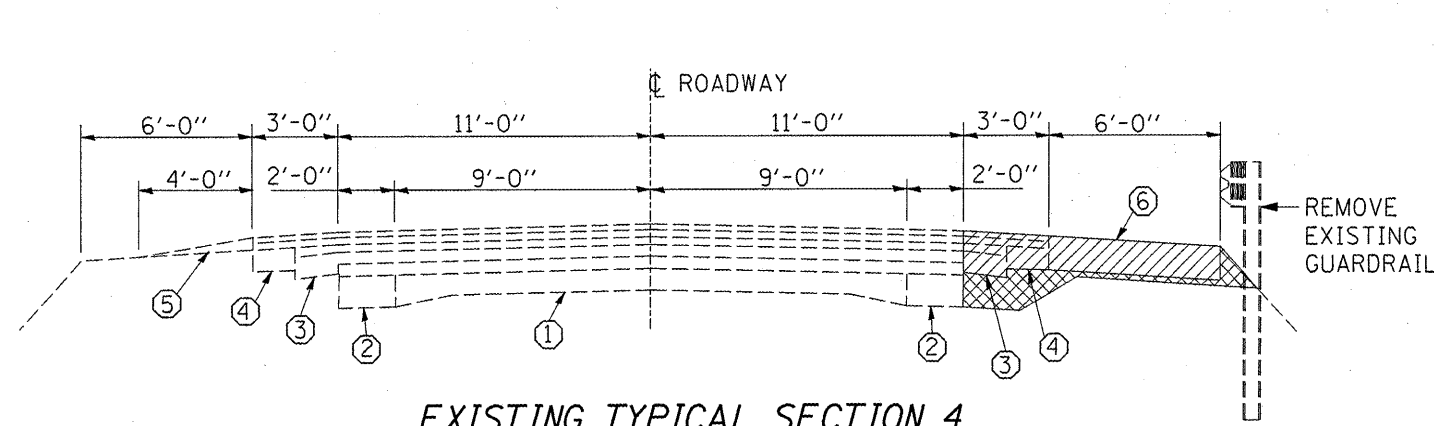

EXISTING TYPICAL SECTION 4

STA. 1385+90 TO STA. 1388+85

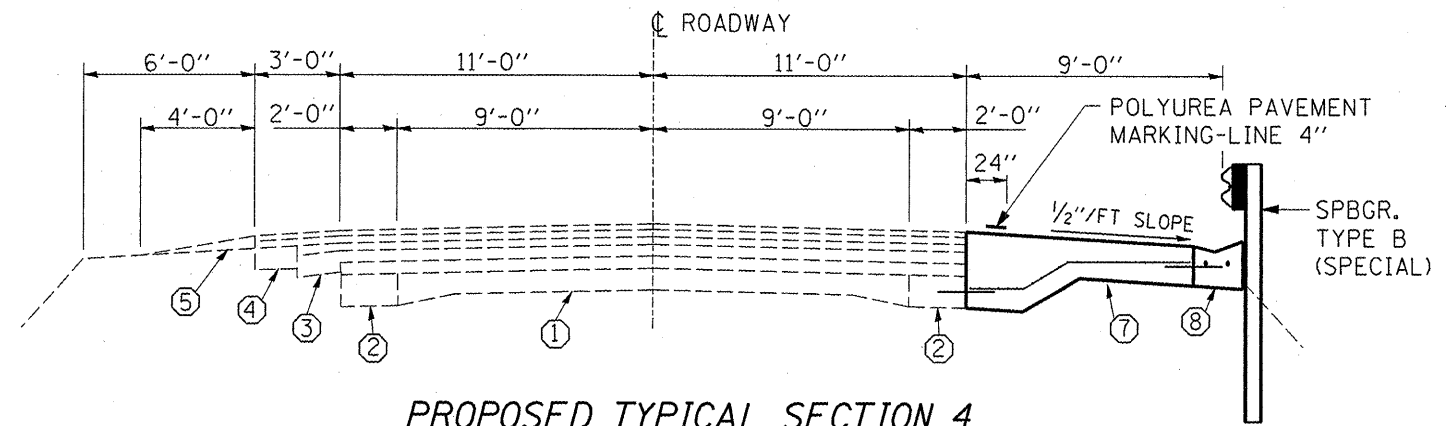

PROPOSED TYPICAL SECTION 4

STA. 1385+90 TO STA. 1388+85

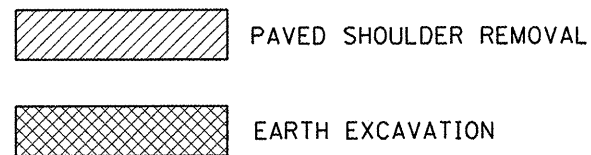

LEGEND

- ① PCC PAVEMENT 9"-6"-9"
- ② PCC WIDENING 9" WITH ±13" HOT-MIX ASPHALT OVERLAY
- ③ HOT-MIX ASPHALT SHOULDER 6" WITH ±7" HOT-MIX ASPHALT OVERLAY
- ④ HOT-MIX ASPHALT WIDENING 9" WITH ±3" HOT-MIX ASPHALT OVERLAY
- ⑤ AGGREGATE SHOULDER
- ⑥ HOT-MIX ASPHALT SHOULDER 9"
- ⑦ PCC SHOULDERS 11" (SPECIAL)
- ⑧ CONCRETE GUTTER, TYPE B (SPECIAL)

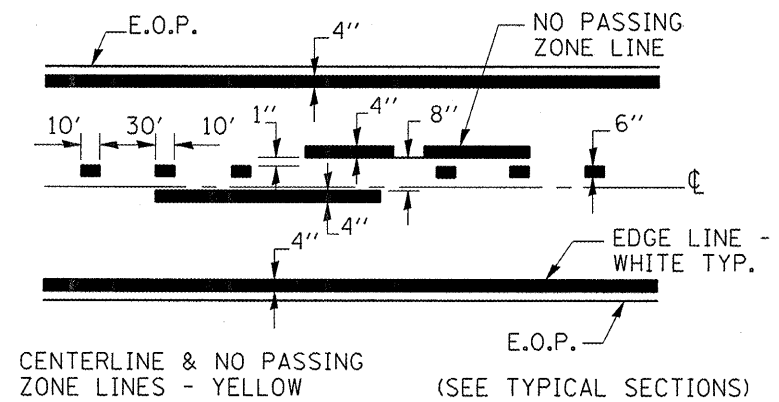

PAVEMENT MARKING

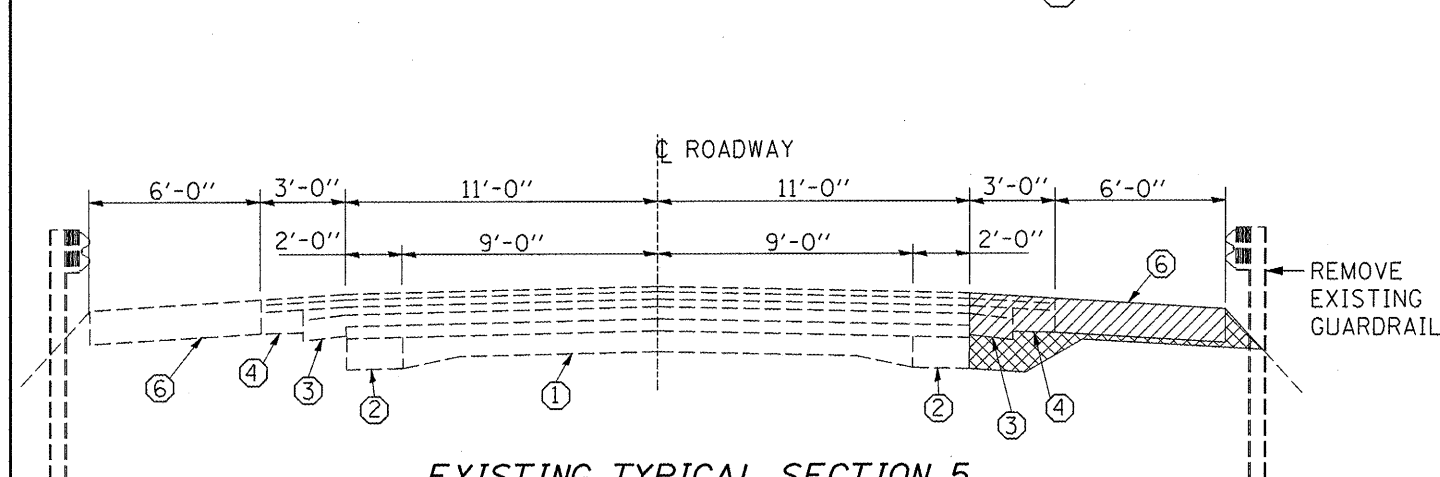

EXISTING TYPICAL SECTION 5

STA. 1388+85 TO STA. 1389+42

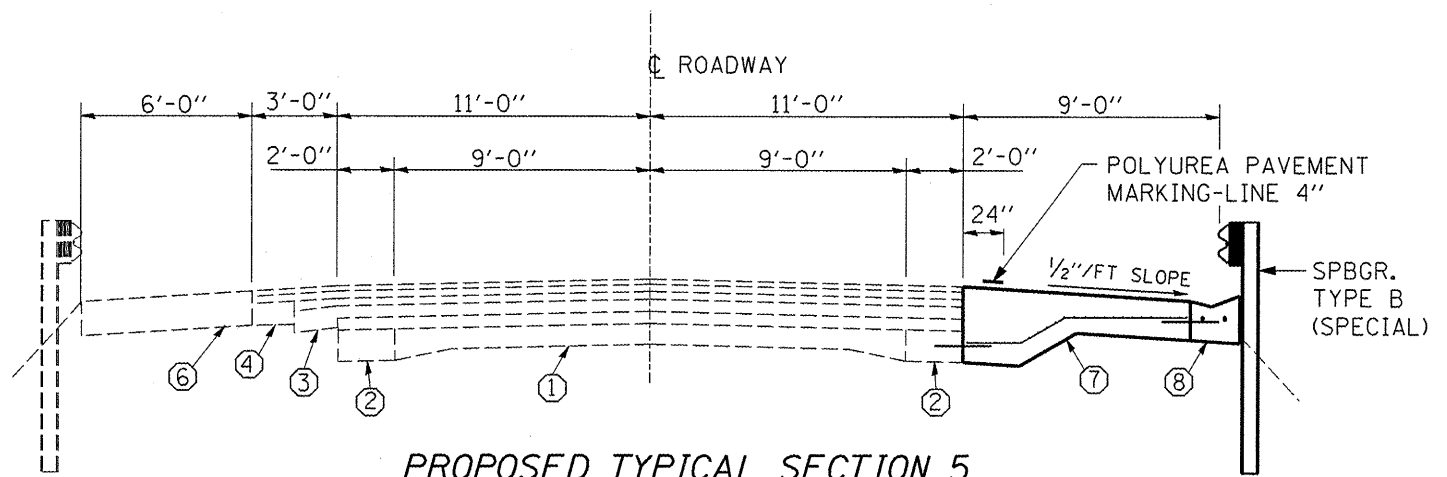

PROPOSED TYPICAL SECTION 5

STA. 1388+85 TO STA. 1389+42

FILE NAME =	USER NAME = carpenterdj	DESIGNED -	REVISD -
c:\projects\main09\cm307\details.dgn		DRAWN -	REVISD -
		CHECKED -	REVISD -
		DATE -	REVISD -

**STATE OF ILLINOIS
DEPARTMENT OF TRANSPORTATION**

TYPICAL SECTIONS

SCALE: _____ STA. 1380+00 TO STA. 1393+00

F.A.P. RTE.	SECTION	COUNTY	TOTAL SHEETS	SHEET NO.
317	(221)-1	IROQUOIS	13	5
FED. ROAD DIST. NO. - ILLINOIS STATE AID PROJECT			CONTRACT NO. 66755	

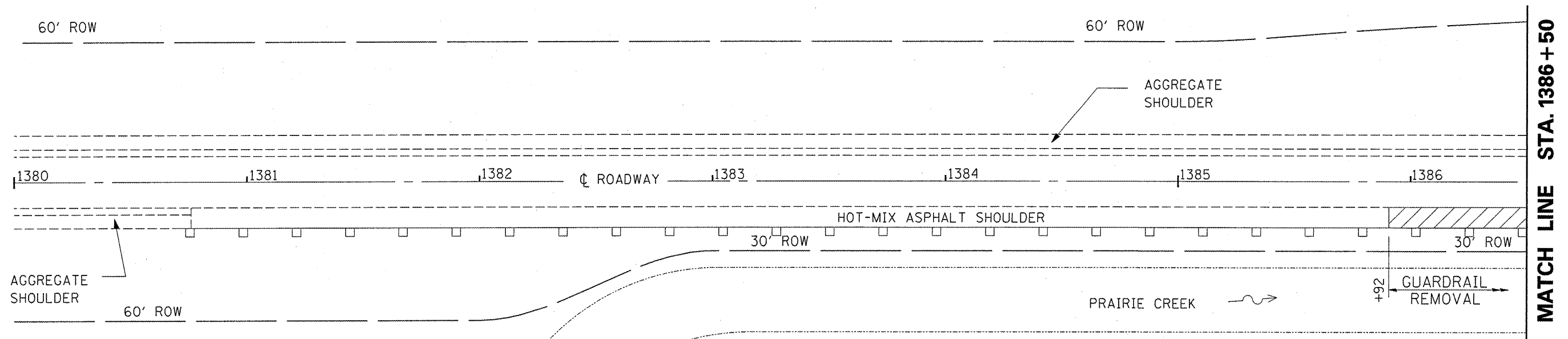

 PAVED SHOULDER REMOVAL

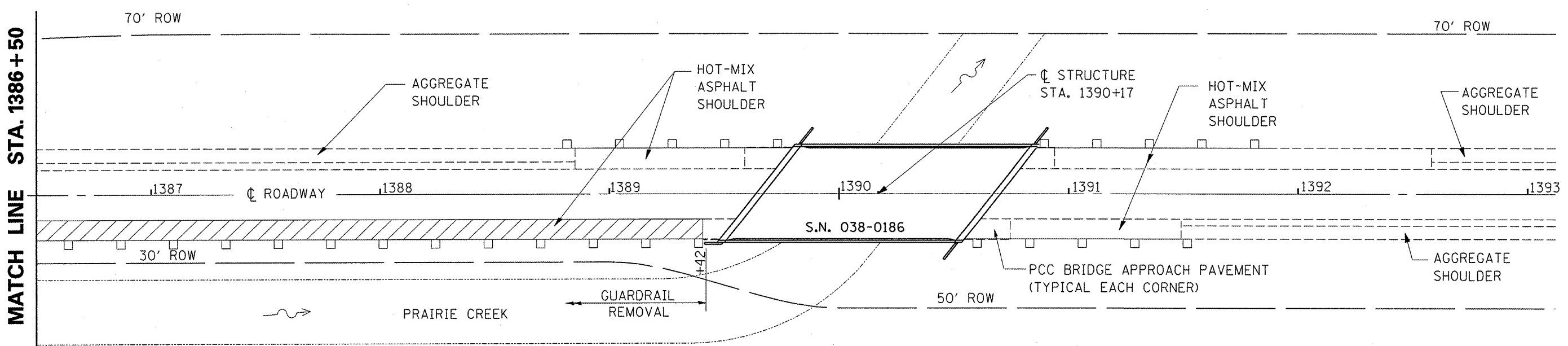

PLAN

FILE NAME = c:\projects\main09\on307\details.dgn	USER NAME = carpenterdj	DESIGNED - ---	REVISED - ---
		DRAWN - ---	REVISED - ---
		CHECKED - ---	REVISED - ---
		DATE - ---	REVISED - ---

**STATE OF ILLINOIS
DEPARTMENT OF TRANSPORTATION**

EXISTING PLAN

SCALE: _____ STA. 1380+00 TO STA. 1393+00

F.A.P. RTE. 317	SECTION (221)-1	COUNTY IROQUOIS	TOTAL SHEETS 13	SHEET NO. 6
CONTRACT NO. 66755				
FED. ROAD DIST. NO. - ILLINOIS STATE AID PROJECT				

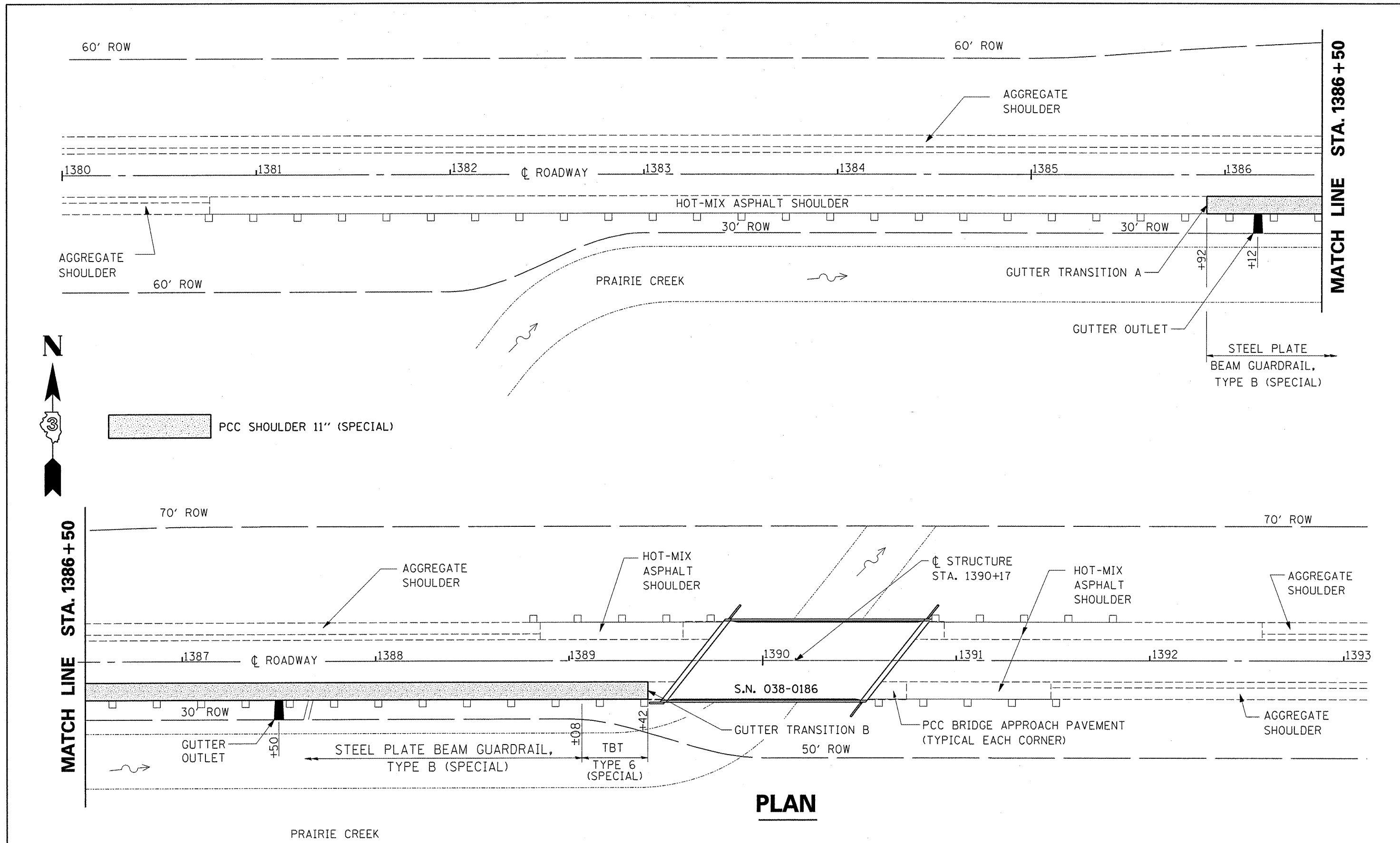

PLAN

FILE NAME = c:\projects\cm\09\cm307\details.dgn	USER NAME = carpenterdj	DESIGNED - ---	REVISED - ---
		DRAWN - ---	REVISED - ---
		CHECKED - ---	REVISED - ---
		DATE - Mar 07, 2008 - 07:35:34 AM	REVISED - ---

**STATE OF ILLINOIS
DEPARTMENT OF TRANSPORTATION**

PROPOSED PLAN

SCALE: _____ STA. 1380+00 TO STA. 1393+00

F.A.P. RTE. 317	SECTION (22)1-1	COUNTY IROQUOIS	TOTAL SHEETS 13	SHEET NO. 7
FED. ROAD DIST. NO. _____ (ILLINOIS) STATE AID PROJECT				
CONTRACT NO. 66755				

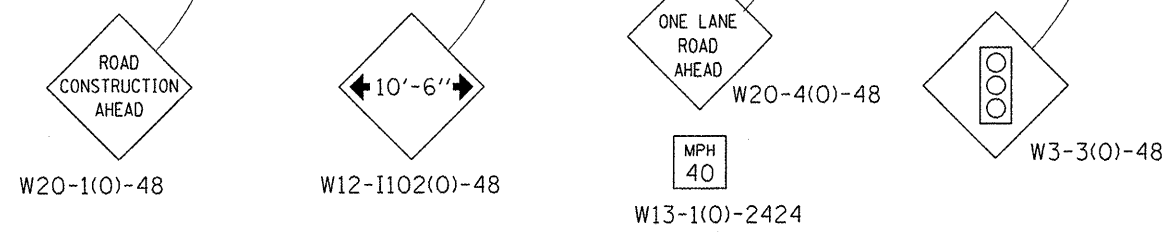
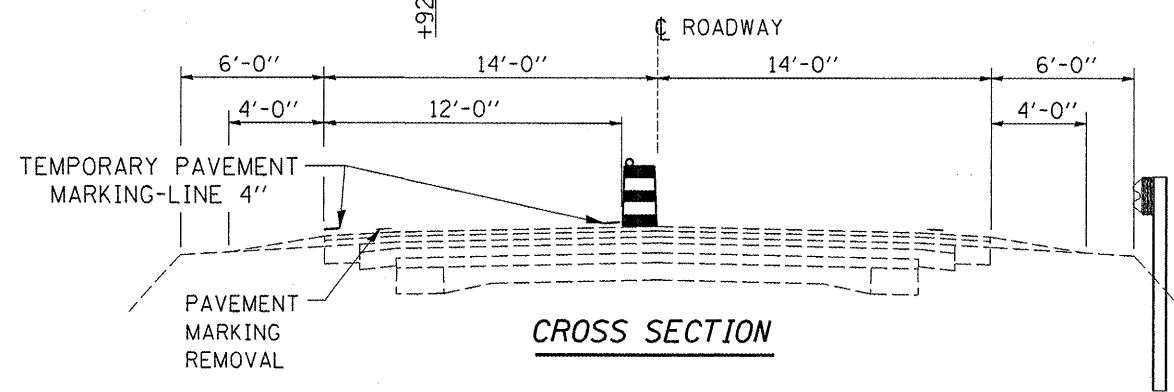
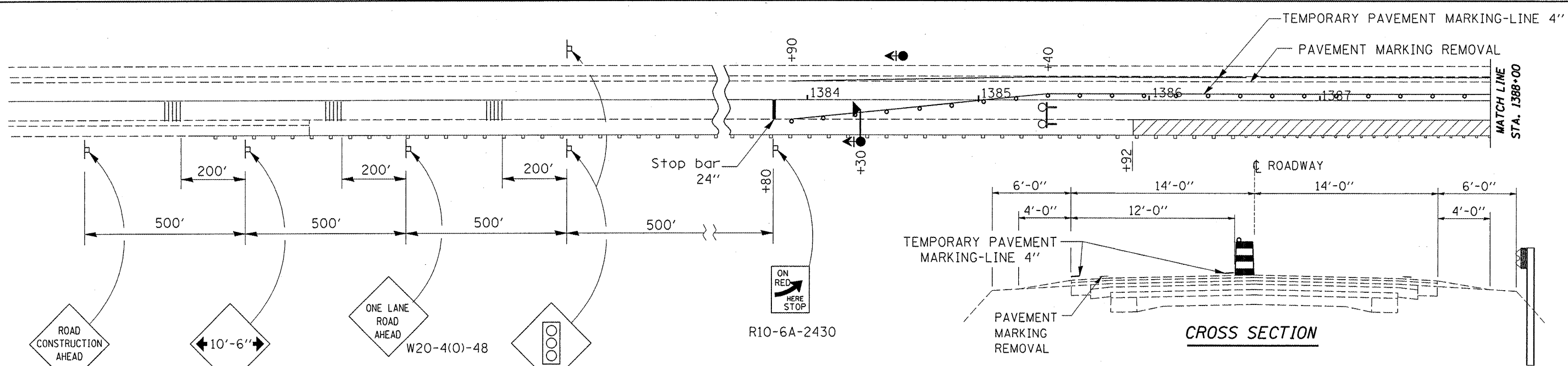

- SYMBOLS**
- Work area
 - Sign
 - Barricade, or drum with steady burning lights
 - Type III barricade with flashing lights
 - Traffic signal with back plate
 - Traffic signal with back plate and microwave detector
 - Temporary rumble strip (when specified)
 - Vertical panel (back to back)

NOTE: THIS DETAIL SHALL BE USED WITH TRAFFIC CONTROL AND PROTECTION STANDARD 701316.

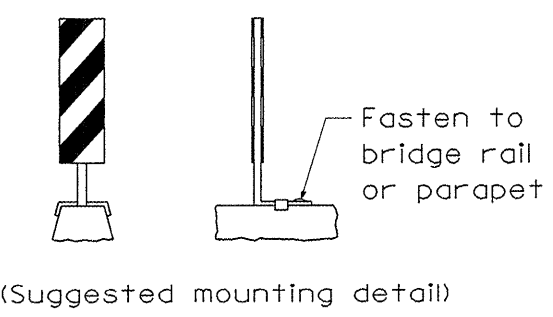

VERTICAL PANELS

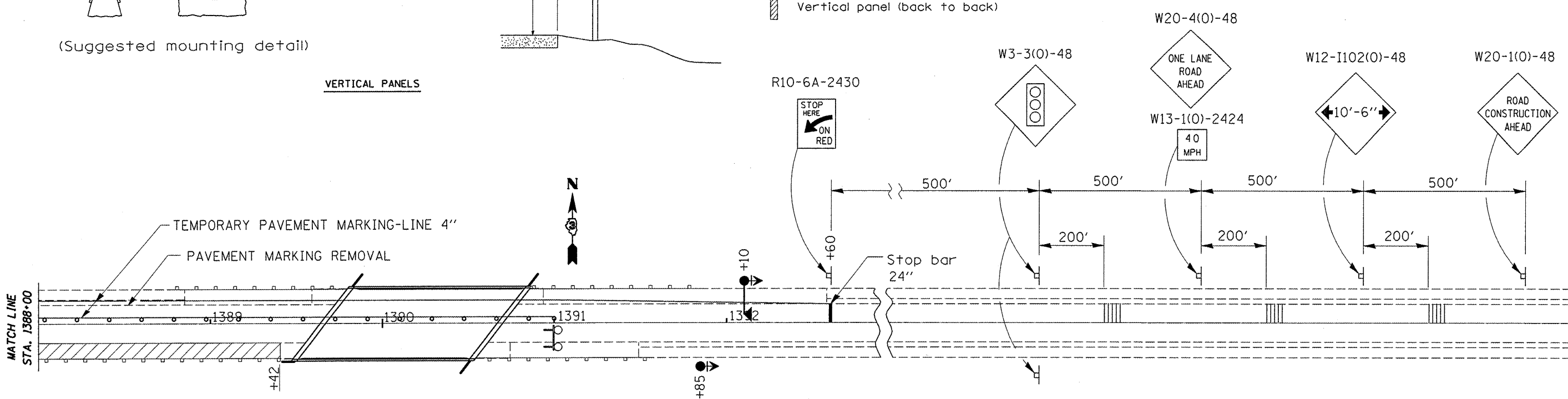

FILE NAME =	USER NAME = carpenterdj	DESIGNED -	REVISED -
c:\projects\cm01n09\cm007\details.dgn		DRAWN -	REVISED -
PLOT SCALE = 1/32" = 1' IN.		CHECKED -	REVISED -
PLOT DATE = Mar 07, 2008 - 07:35:41 AM		DATE -	REVISED -

**STATE OF ILLINOIS
DEPARTMENT OF TRANSPORTATION**

TRAFFIC CONTROL SUPPLEMENTAL DETAILS

SCALE: _____ STA. 1380+00 TO STA. 1393+00

F.A.P. RTE. =	SECTION	COUNTY	TOTAL SHEETS	SHEET NO.
317	(221)-1	IROQUOIS	13	8
FED. ROAD DIST. NO. - ILLINOIS STATE AID PROJECT			CONTRACT NO. 66755	

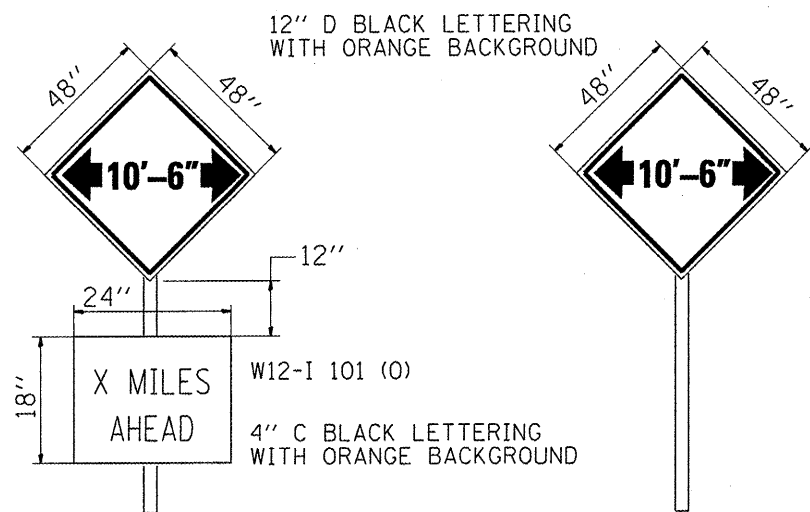

TO BE POST MOUNTED AS SHOWN ELSEWHERE IN THE PLANS.

THE CONTRACTOR SHALL NOTIFY THE ENGINEER A MINIMUM OF 21 CALENDAR DAYS PRIOR TO INSTALLING ANY TRAFFIC CONTROL DEVICES THAT WILL RESTRICT THE PAVEMENT WIDTH.

THE CONTRACTOR SHALL BE RESPONSIBLE FOR COORDINATING WITH THE ENGINEER TO MEET THIS REQUIREMENT.

WIDTH RESTRICTION SIGNING DETAILS

PROJECT LOCATION
S.N. 038-0186

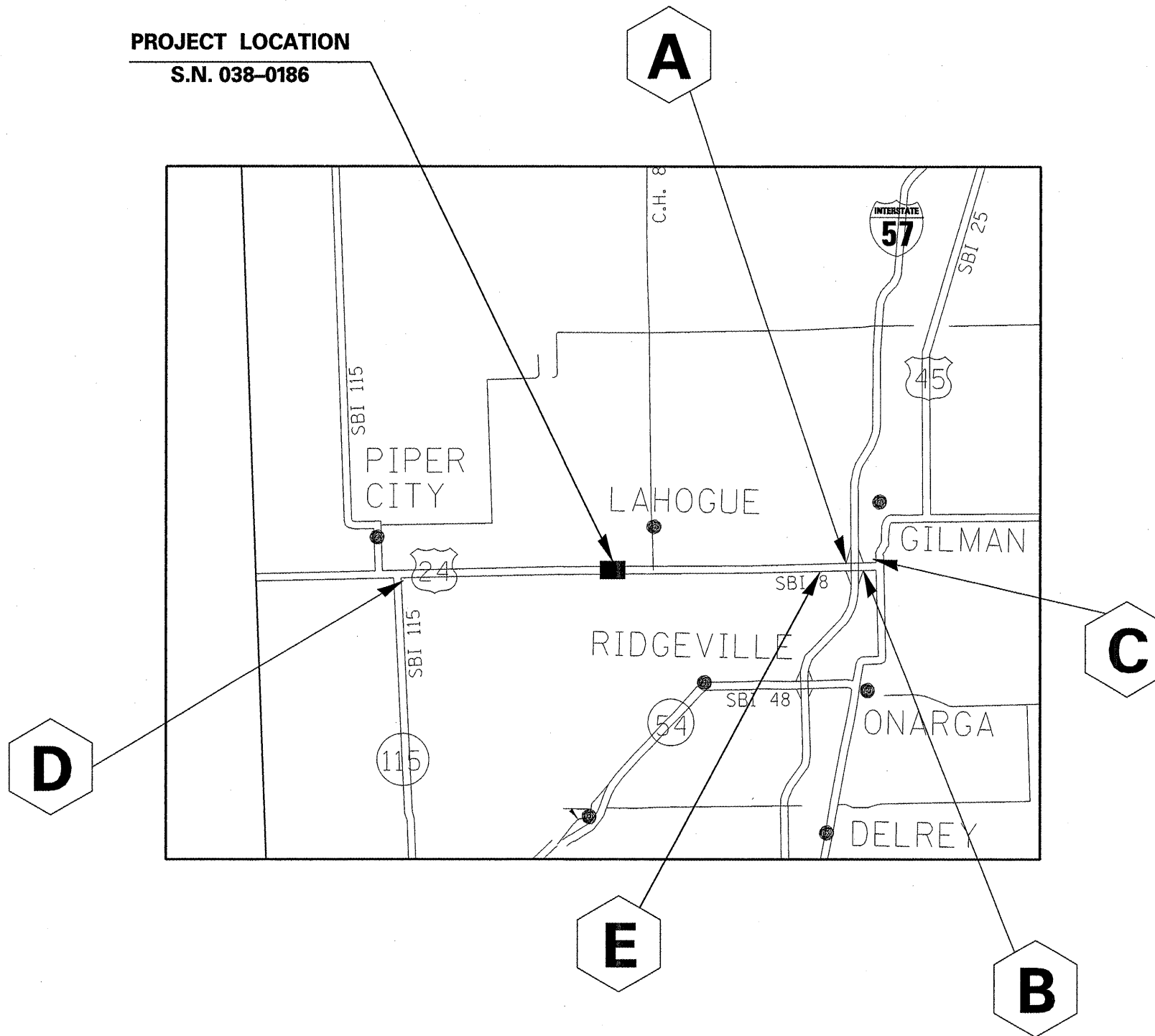
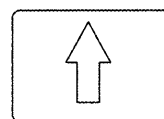
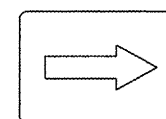

TABLE OF WIDTH RESTRICTION SIGNS				
NO. OF SIGNS	TYPE OF SIGN	SIGN	LOCATION	WIDTH RESTRICTION & MILES AHEAD
1	WIDTH RESTRICTION with W12-I101(O) & M6-1(RT)	A	TOP OF I-57 SOUTHBOUND OFF RAMP	10'-6" 4.4 MI AHEAD
1	WIDTH RESTRICTION with W12-I101(O) & M6-1(LT)	B	TOP OF I-57 NORTHBOUND OFF RAMP	10'-6" 4.6 MI AHEAD
1	WIDTH RESTRICTION with W12-I101(O) & M6-3	C	NW CORNER OF JUNCTION US 45 AND US 24	10'-6" 5.0 MI AHEAD
1	WIDTH RESTRICTION with W12-I101(O) & M6-3	D	SE CORNER OF JUNCTION US 24 AND IL 115	10'-6" 4.8 MI AHEAD
1	WIDTH RESTRICTION with W12-I101(O) & M6-3	E	1000 FEET WEST OF I-57	10'-6" 4.2 MI AHEAD



M6-3 21"X15"



**M6-1 21"X15"
(RT)**

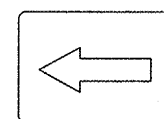

**M6-1 21"X15"
(LT)**

FILE NAME = c:\projects\cm307\details.dgn	USER NAME = carpenterdj	DESIGNED - ---	REVISED - ---
		DRAWN - ---	REVISED - ---
		CHECKED - ---	REVISED - ---
		DATE - ---	REVISED - ---
PLOT SCALE = 1/8" = 1' / IN.		PLOT DATE = Mar 07, 2008 - 07:35:47 AM	

**STATE OF ILLINOIS
DEPARTMENT OF TRANSPORTATION**

WIDTH RESTRICTION SIGNING

SCALE: _____ STA. 1380+00 TO STA. 1393+00

F.A.P. RTE. 317	SECTION (22)1-1	COUNTY IROQUOIS	TOTAL SHEETS 13	SHEET NO. 9
CONTRACT NO. 66755				
FED. ROAD DIST. NO. _____ (ILLINOIS) STATE AID PROJECT				

** NEAT LINE REMOVAL TO BE CUT WITH AN ASPHALT CUTTING WHEEL ATTACHED TO A GRADER OR SIMILAR METHOD APPROVED BY THE ENGINEER.

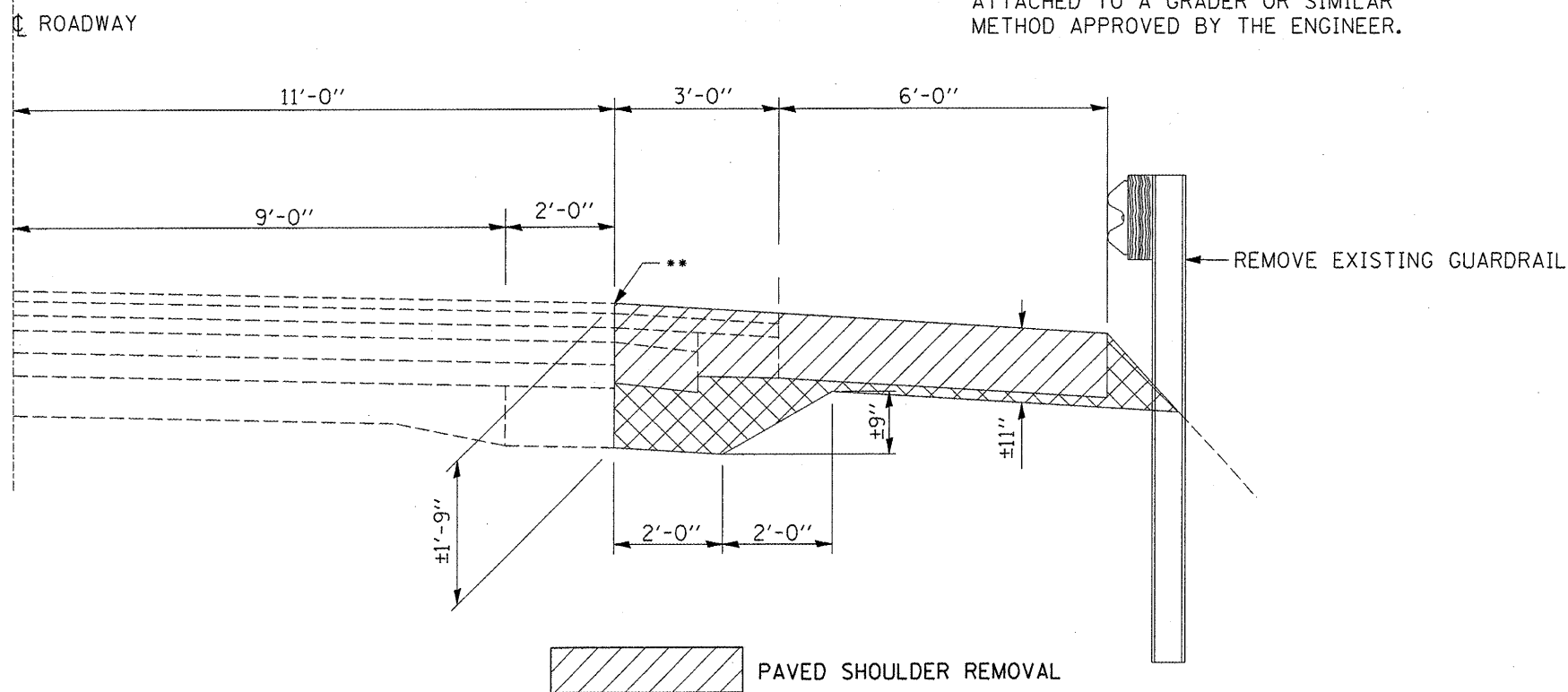

PAVED SHOULDER REMOVAL

EARTH EXCAVATION

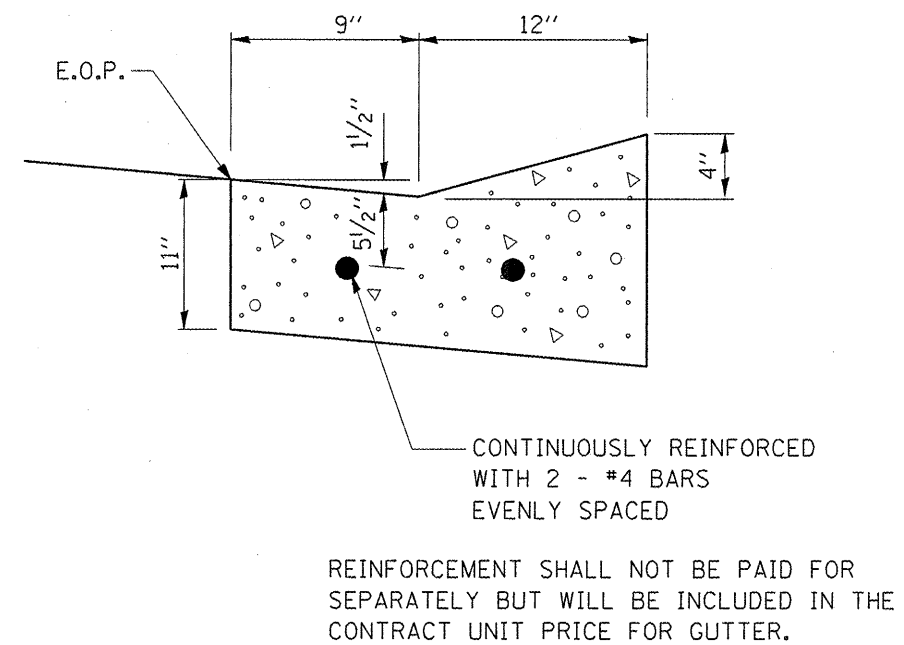

GUTTER DETAIL

REINFORCEMENT SHALL NOT BE PAID FOR SEPARATELY BUT WILL BE INCLUDED IN THE CONTRACT UNIT PRICE FOR GUTTER.

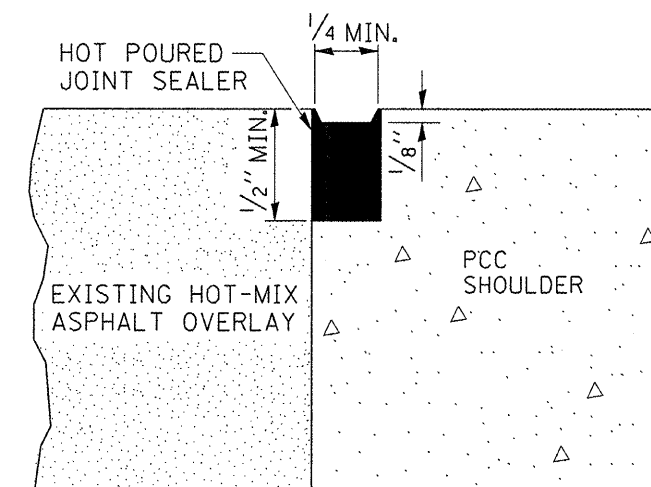
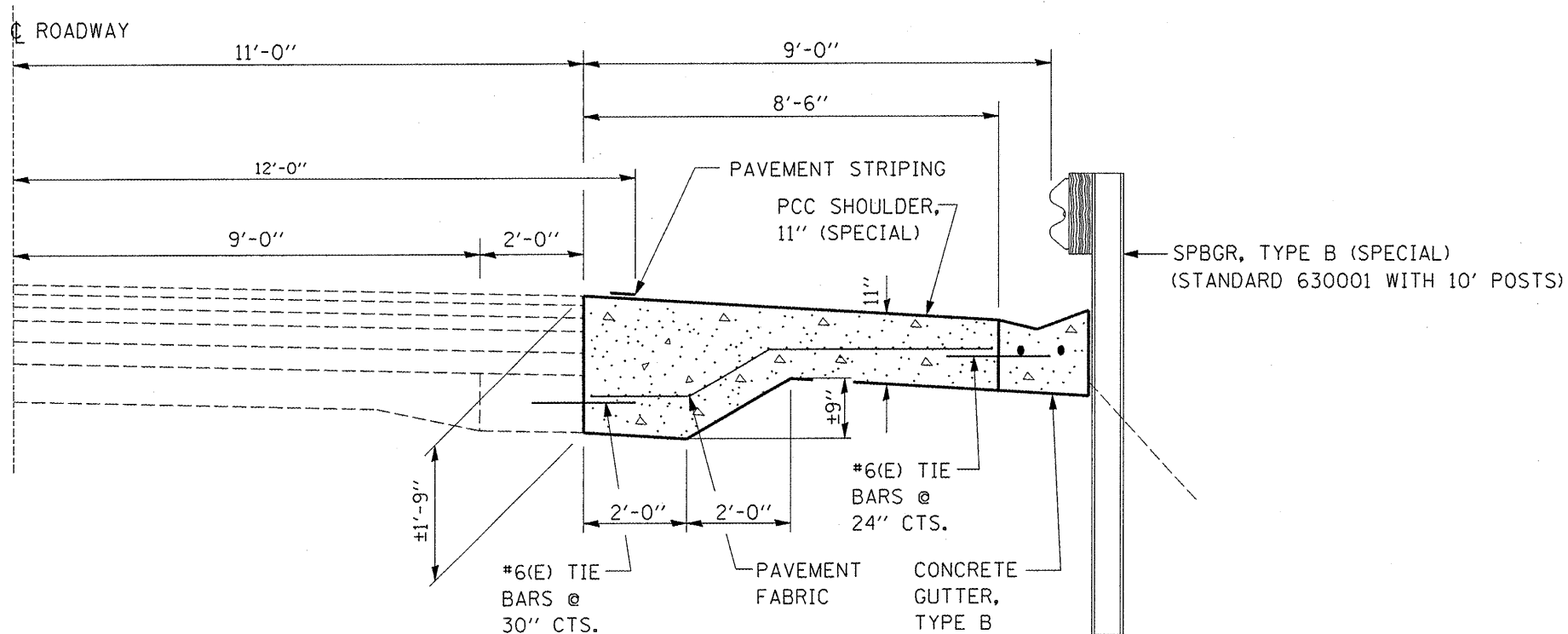

SAWED JOINT DETAIL

FILE NAME = c:\projects\main09\cm307\details.dgn	USER NAME = carpenterdj	DESIGNED - DRAWN -	REVISED - REVISED -
PLOT SCALE = 1/8" = 1' / IN.	CHECKED -	REVISED -	REVISED -
PLOT DATE = Mar 07, 2008 - 07:26:44 AM	DATE -	REVISED -	REVISED -

STATE OF ILLINOIS
DEPARTMENT OF TRANSPORTATION

SHOULDER DETAILS

SCALE: _____ STA. 1380+00 TO STA. 1393+00

F.A.P. RTE. = 317	SECTION (221)-1	COUNTY IROQUOIS	TOTAL SHEETS 13	SHEET NO. 10
FED. ROAD DIST. NO. - ILLINOIS STATE AID PROJECT			CONTRACT NO. 66755	

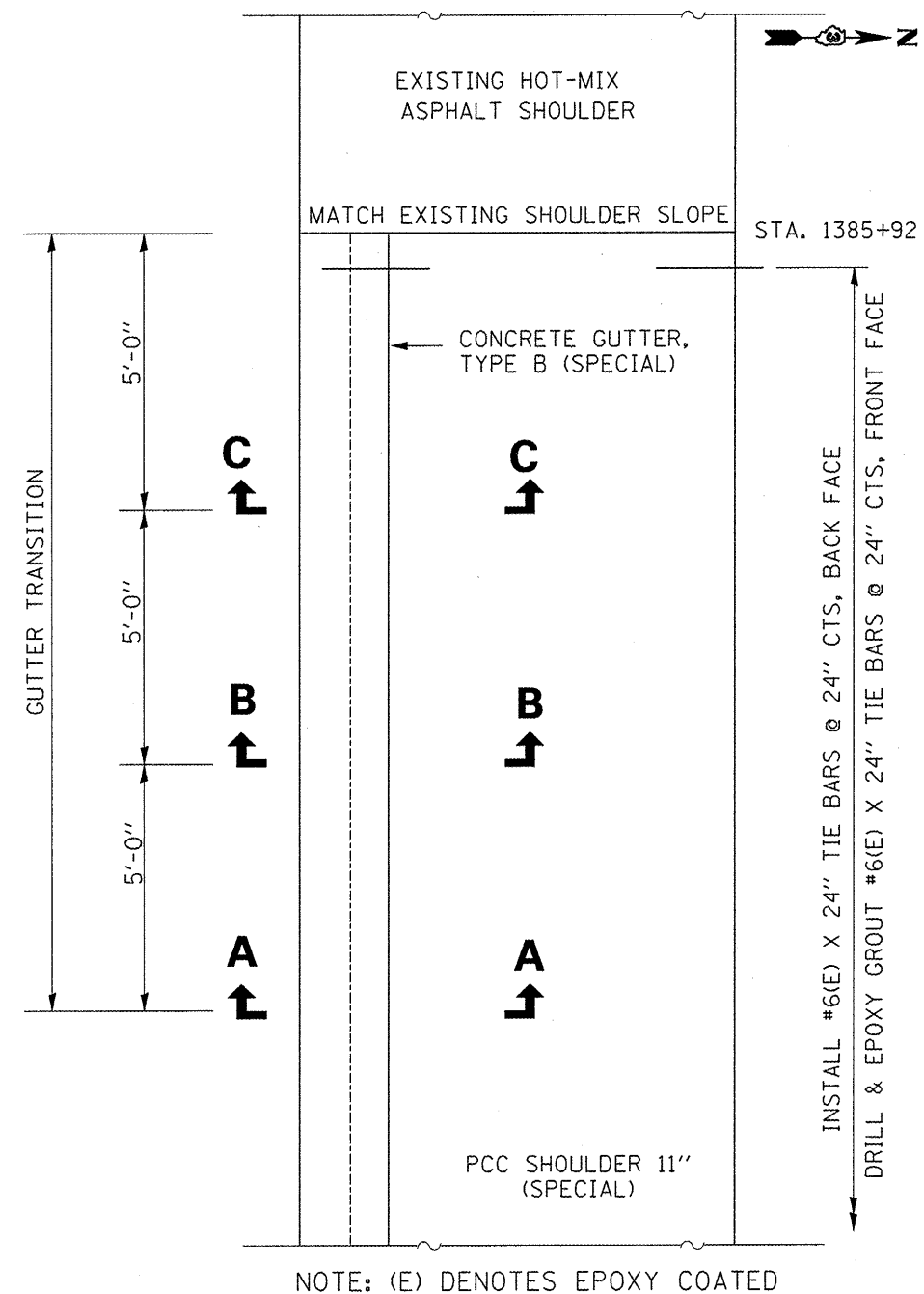

PLAN

STA. 1385+92 TO STA. 1386+07

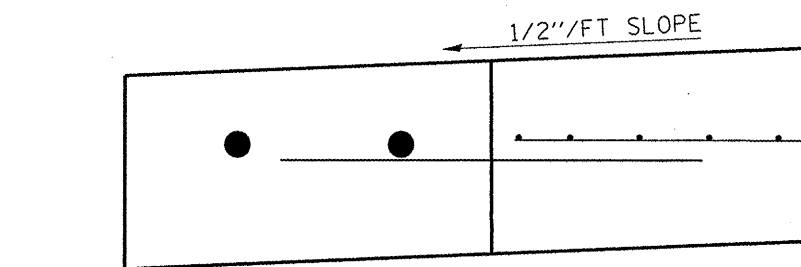

SECTION C-C

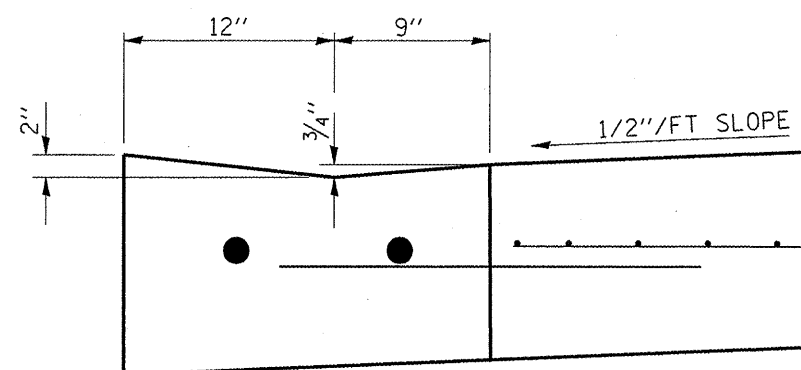

SECTION B-B

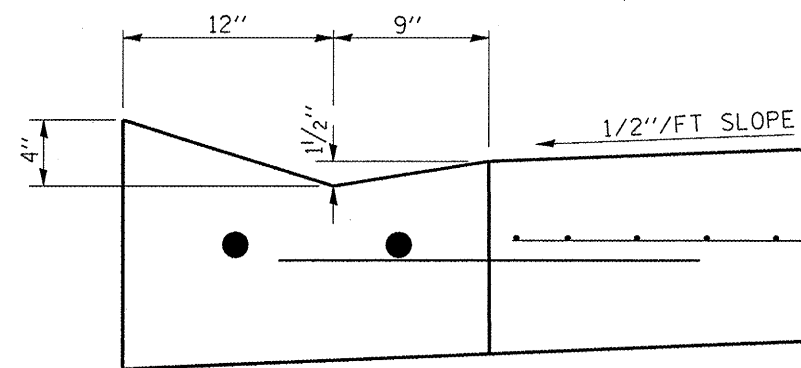

SECTION A-A

FILE NAME = c:\projects\cm09\cm387\details.dgn	USER NAME = carpenterdj	DESIGNED - ---	REVISED - ---
		DRAWN - ---	REVISED - ---
		CHECKED - ---	REVISED - ---
		DATE - ---	REVISED - ---

STATE OF ILLINOIS
DEPARTMENT OF TRANSPORTATION

GUTTER TRANSITION A

SCALE: _____ STA. 1380+00 TO STA. 1393+00

F.A.P. RTE. 317	SECTION (221)-1	COUNTY IROUOIS	TOTAL SHEETS 13	SHEET NO. 11
CONTRACT NO. 66755				
FED. ROAD DIST. NO. - [ILLINOIS] STATE AID PROJECT				

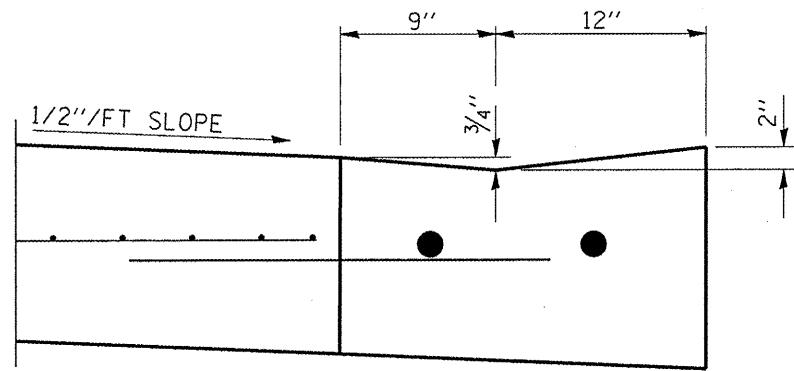

SECTION E-E

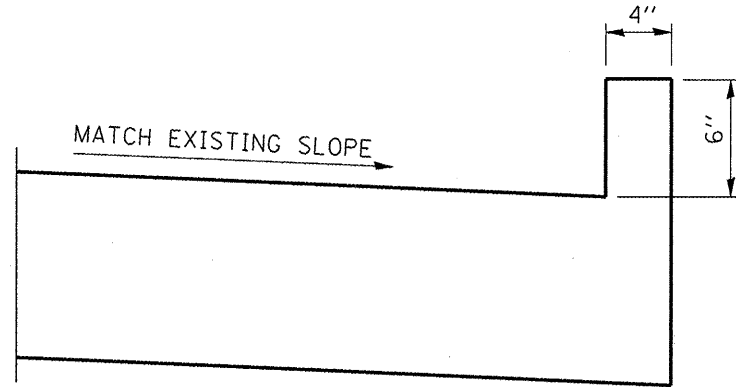

SECTION G-G

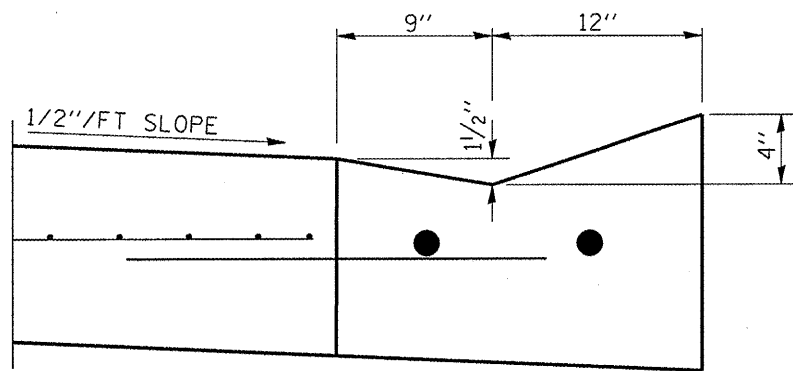

SECTION D-D

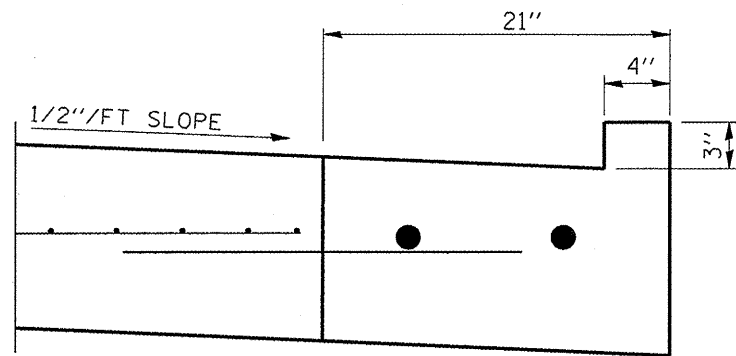

SECTION F-F

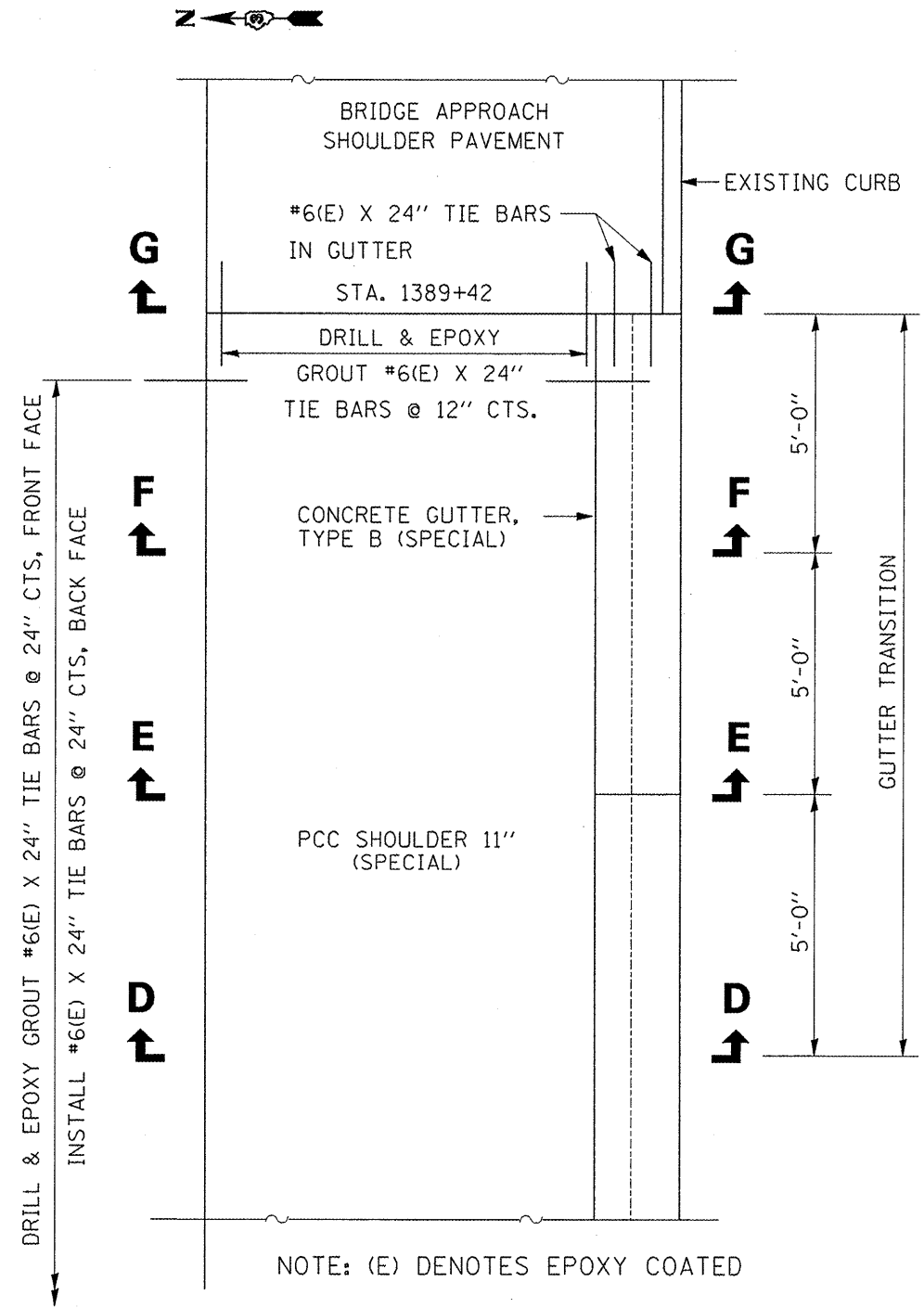

NOTE: (E) DENOTES EPOXY COATED

PLAN

STA. 1389+27 TO STA. 1389+42

FILE NAME = c:\projects\main09\on307\details.dgn	USER NAME = carpenterdj	DESIGNED - ---	REVISED - ---
		DRAWN - ---	REVISED - ---
		CHECKED - ---	REVISED - ---
		DATE - ---	REVISED - ---

**STATE OF ILLINOIS
DEPARTMENT OF TRANSPORTATION**

GUTTER TRANSITION B

SCALE: ----- STA. 1380+00 TO STA. 1393+00

F.A.P. RTE. 317	SECTION (221)-1	COUNTY IROUOIS	TOTAL SHEETS 13	SHEET NO. 12
CONTRACT NO. 66755				
FED. ROAD DIST. NO. - ILLINOIS STATE AID PROJECT				

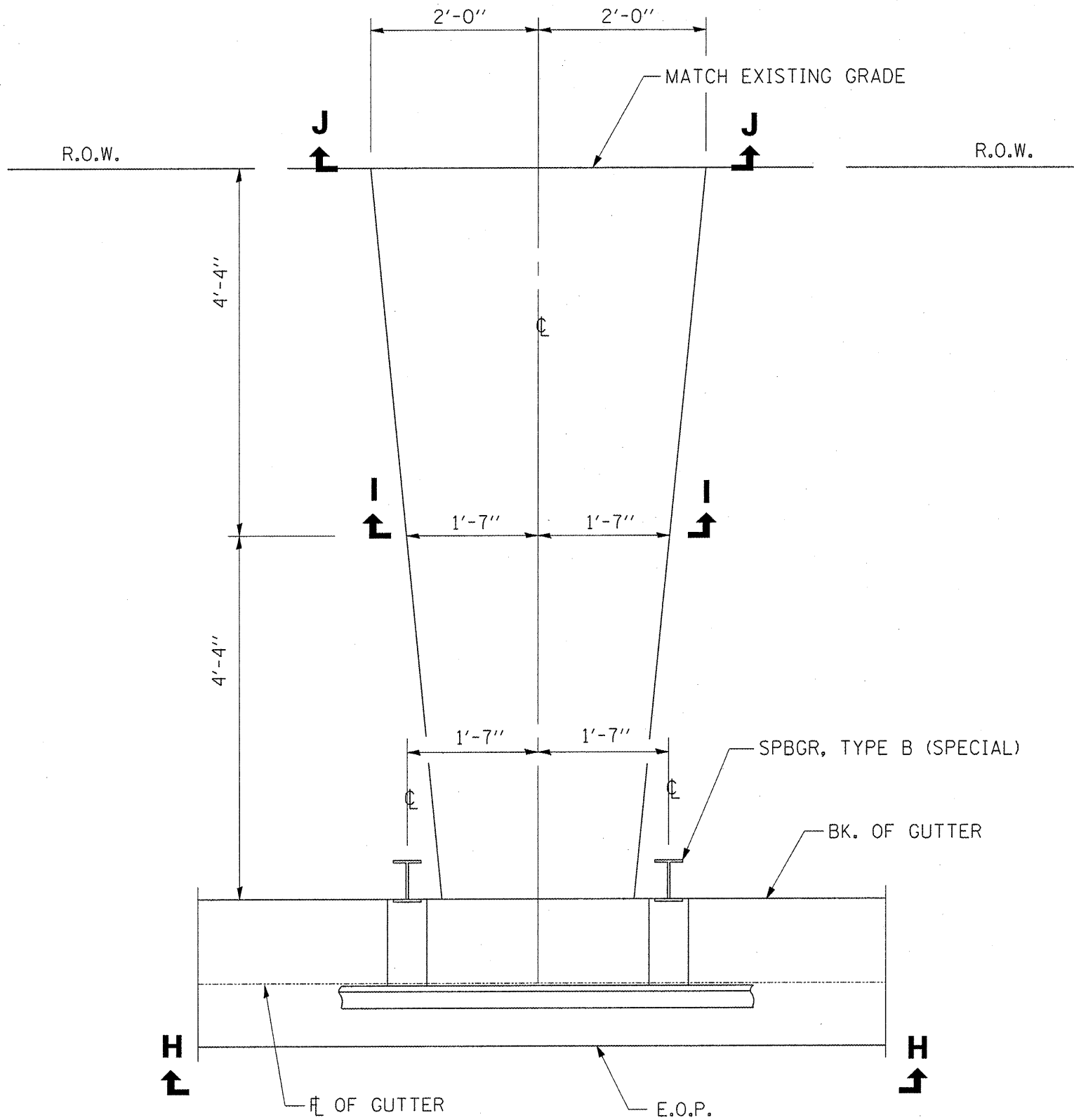

PLAN

STA. 1386+12
STA. 1387+50

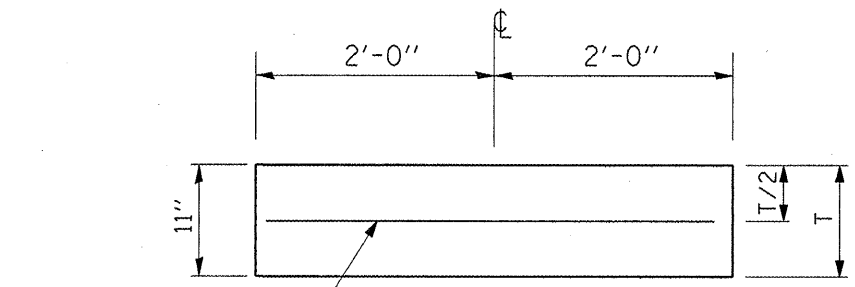

SECTION J-J

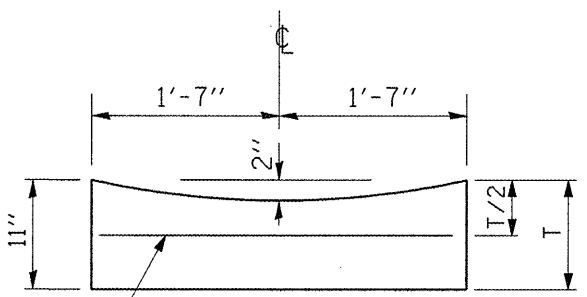

SECTION I-I

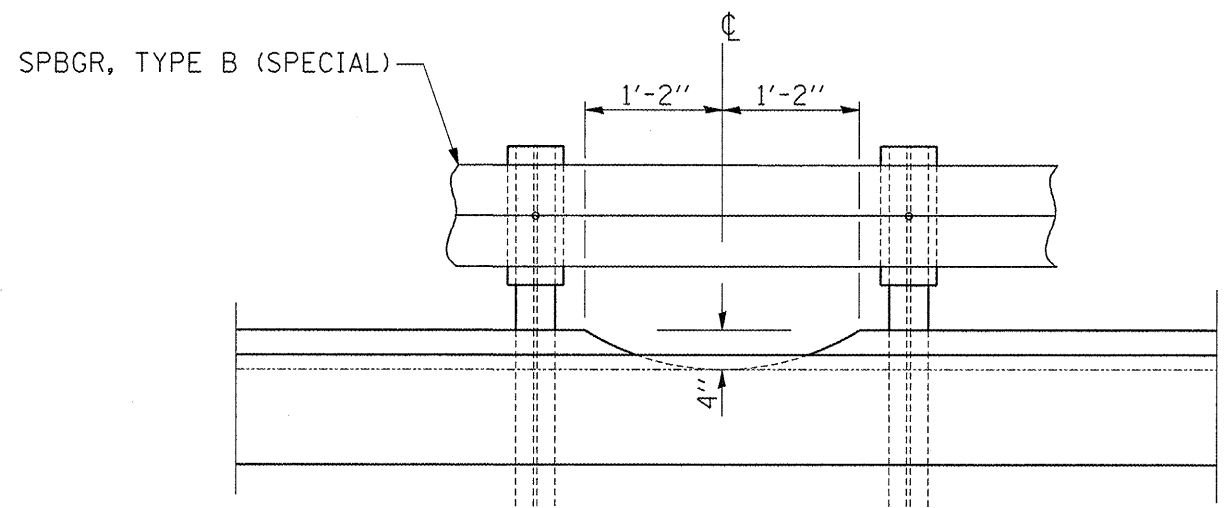

SECTION H-H

NOTE: DIMENSIONS MAY BE ADJUSTED TO FIT FIELD CONDITIONS AT TIME OF CONSTRUCTION

FILE NAME =	USER NAME = carpenterdj
o:\projects\cmeir09\cm307\details.dgn	

DESIGNED -	REVISD -
DRAWN -	REVISD -
CHECKED -	REVISD -
DATE -	REVISD -

STATE OF ILLINOIS
DEPARTMENT OF TRANSPORTATION

GUTTER OUTLET
SCALE: ----- STA. 1380+00 TO STA. 1393+00

F.A.P. RTE.	SECTION	COUNTY	TOTAL SHEETS	SHEET NO.
317	(22)-1	IROQUOIS	13	13
CONTRACT NO. 66755				