

**EXISTING PAVEMENT SAWING DETAIL**  
(AGAINST BITUMINOUS SHOULDER)

EXISTING LONGITUDINAL REINFORCEMENT BARS	A (min.)	B (min.)	C (min.)
No. 6	6'-0"	24"	19"

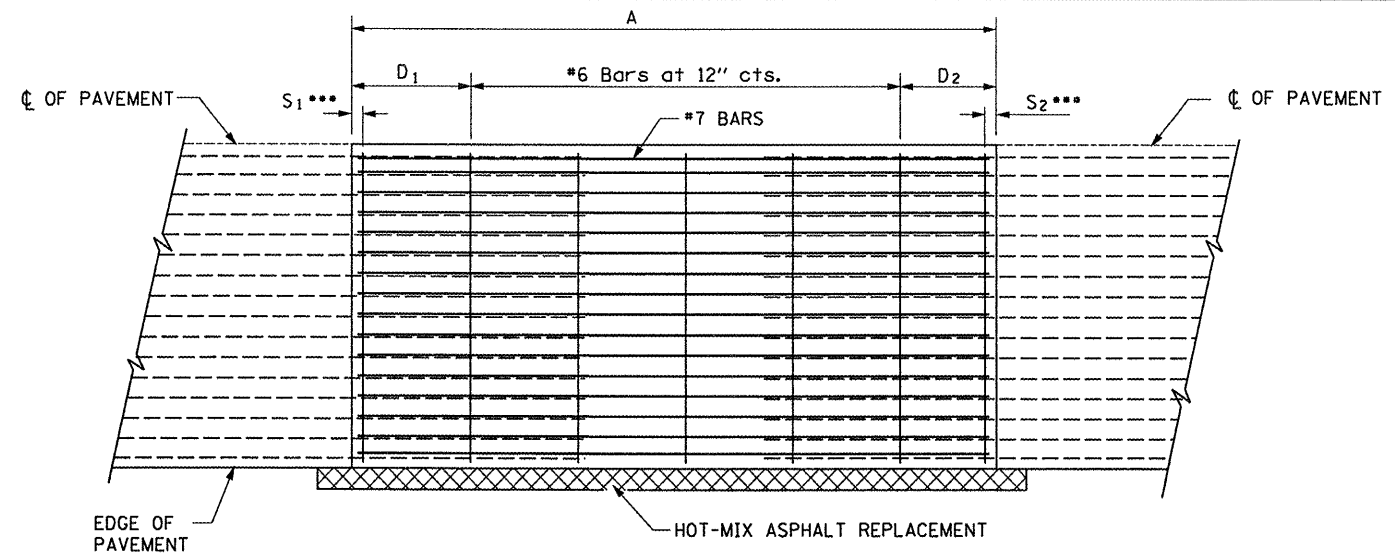

**PROPOSED PAVEMENT DETAIL**  
(AGAINST BITUMINOUS SHOULDER)

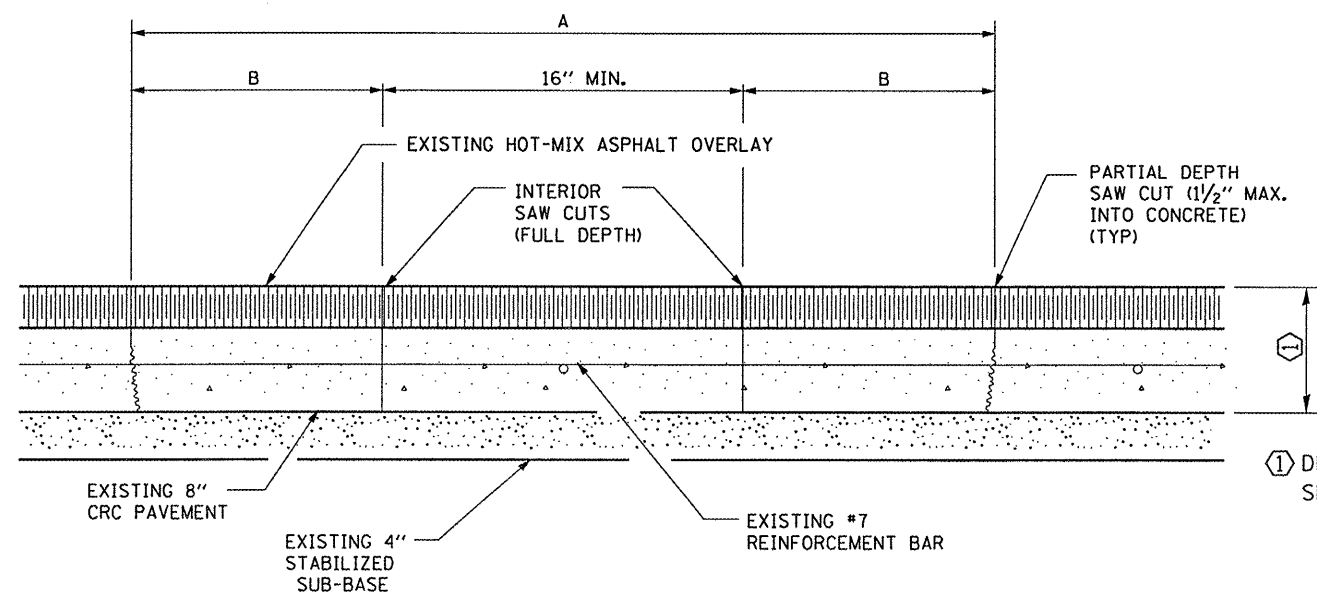

**EXISTING PAVEMENT SAW CUTTING DETAIL**

① DEPTH VARIES  
SEE TYPICAL SECTIONS

**NOTES:**

- EVERY 3rd INTERSECTION MUST BE TIED
- LAP NEW REINFORCEMENT WITH EXISTING LONGITUDINAL REINFORCEMENT
- VARIABLES: WHERE S<sub>1</sub> AND S<sub>2</sub> ARE 2 1/2" MIN. AND 12" MAX. D<sub>1</sub> = 2(S<sub>1</sub>) AND D<sub>2</sub> = 2(S<sub>2</sub>)

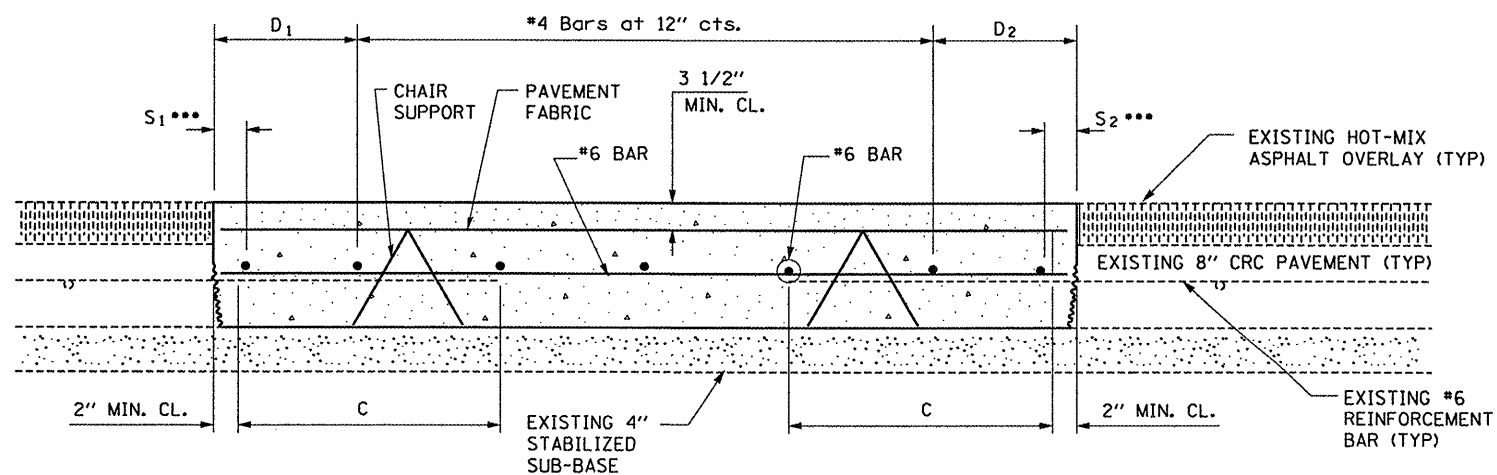

**PROPOSED CLASS A PATCHING DETAIL**

FILE NAME =	USER NAME = woodshenkr1	DESIGNED - RLW	REVISED -
ct:\projects\cmain09\cm310\details.dgn		DRAWN - RLW	REVISED -
	PLOT SCALE = 1/83,4829' / IN.	CHECKED -	REVISED -
	PLOT DATE = Mar 14, 2008 - 04:23:24 PM	DATE -	REVISED -

STATE OF ILLINOIS  
DEPARTMENT OF TRANSPORTATION

CLASS A PATCHING  
SCALE: SHEET NO. 1 OF 1 SHEETS

*FAI 57 & FAP 332	**D3 PAVEMENT PATCHING 2009-02		
SECTION	COUNTY	TOTAL SHEETS	SHEET NO.
**	IRROUOIS	17	12
FED. ROAD DIST. NO. - [ILLINOIS]		CONTRACT NO. 66800	