

F.A.P. RTE.	SECTION	COUNTY	TOTAL SHEETS	SHEET NO.
317	(25-B-1)I-1	LIVINGSTON	16	1
FED. ROAD DIST. NO.	ILLINOIS	CONTRACT NO. 66809		

STATE OF ILLINOIS  
DEPARTMENT OF TRANSPORTATION

DIVISION OF HIGHWAYS

**PROPOSED  
HIGHWAY PLANS**

FAP ROUTE 317 (US 24)  
SECTION (25-B-1)I-1

LIVINGSTON COUNTY  
C-93-086-08  
**DECK BEAM REPLACEMENT**

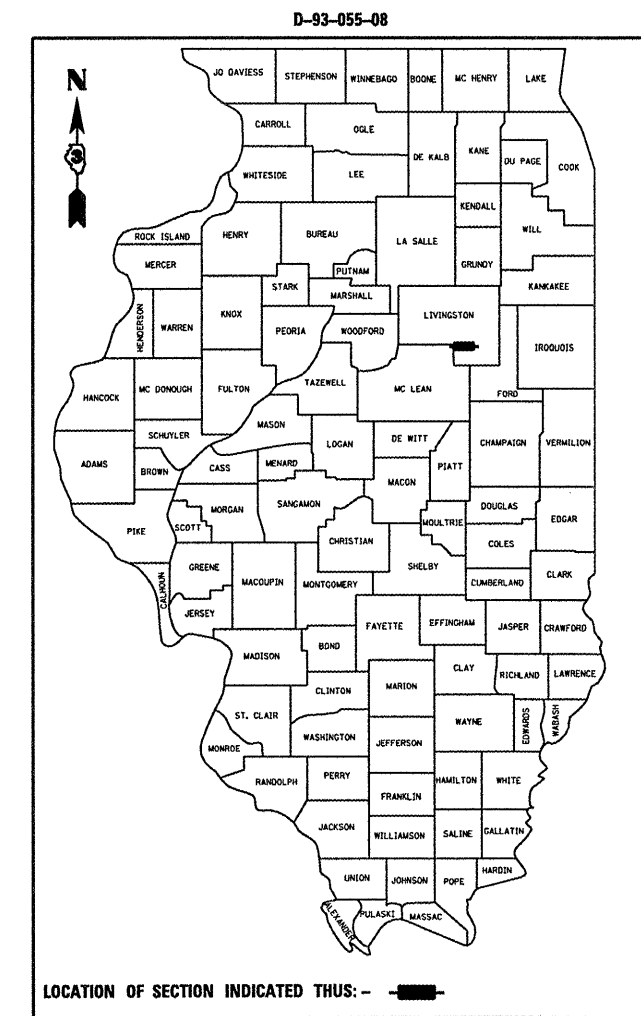

FUNCTIONAL CLASSIFICATION  
URBAN - OTHER PRINCIPAL ARTERIAL  
F.A.P. ROUTE 317 (US 24)  
2005 ADT = 5100  
P.V = 79.9% M.U. = 11.8% S.U. = 8.3%

STATE OF ILLINOIS  
DEPARTMENT OF TRANSPORTATION  
DIVISION OF HIGHWAYS

SUBMITTED 3/25 20 08

*George E. Ryan*  
DEPUTY DIRECTOR OF HIGHWAYS, REGION ENGINEER

May 9, 20 08  
*Eric E. Harn*  
INTERIM ENGINEER OF DESIGN AND ENVIRONMENT

May 9, 20 08  
*Christine M. Reed*  
DIRECTOR OF HIGHWAYS, CHIEF ENGINEER

PRINTED BY THE AUTHORITY  
OF THE STATE OF ILLINOIS

INDEX OF SHEETS

1. COVER SHEET
2. GENERAL NOTES
- 3 - 4. SUMMARY OF QUANTITIES
5. TYPICAL SECTIONS
- 6 - 7. STAGING DETAILS
8. TEMPORARY CONCRETE BARRIER
9. WIDTH RESTRICTION SIGNING
10. TYPICAL PAVEMENT MARKING
11. PLAN AND ELEVATION
12. SPANS 1 & 3 REPAIR DETAILS
13. SPANS 2 REPAIR DETAILS
- 14 - 16. REPAIR DETAILS

STANDARDS

- 000001-05 STANDARD SYMBOLS, ABBREVIATIONS AND PATTERNS
- 001006 DECIMAL OF AN INCH AND OF A FOOT
- 482011-03 HMA SHOULDER STRIPS/SHOULDERS WITH RS OR WIDENING & RS PROJECTS
- 701001-01 OFF-ROAD OPERATIONS 2L, 2W, MORE THAN 4.5 m (15') AWAY
- 701006-02 OFF-ROAD OPERATIONS 2L, 2W, 4.5 m (15') TO 600 mm (24") FROM PAVEMENT EDGE
- 701011-01 OFF-ROAD MOVING OPERATIONS 2L, 2W, DAY ONLY
- 701201-02 LANE CLOSURE, 2L, 2W, DAY ONLY, FOR SPEEDS P 45 MPH
- 701206-01 LANE CLOSURE, 2L, 2W, NIGHT ONLY, FOR SPEEDS P 45 MPH
- 701301-02 LANE CLOSURE, 2L, 2W, SHORT TIME OPERATIONS
- 701311-02 LANE CLOSURE, 2L, 2W, MOVING OPERATIONS - DAY ONLY
- 701321-09 LANE CLOSURE, 2L, 2W, BRIDGE REPAIR WITH BARRIER
- 701326-02 LANE CLOSURE, 2L, 2W, PAVEMENT WIDENING, FOR SPEEDS P 45 MPH
- 701901 TRAFFIC CONTROL DEVICES
- 704001-04 TEMPORARY CONCRETE BARRIER

MICROFILMED \_\_\_\_\_  
REEL NUMBER \_\_\_\_\_  
AWARDED \_\_\_\_\_  
RESIDENT ENGINEER \_\_\_\_\_  
AS BUILT CHANGES WERE MADE  
ON THE FOLLOWING SHEETS \_\_\_\_\_

J.U.L.I.E.  
JOINT UTILITY LOCATION INFORMATION FOR EXCAVATION  
1-800-892-0123

DISTRICT 3 NO. (815) 434-6131  
PROJECT ENGINEER: JOE KANNEL  
UNIT CHIEF: RON WOODSHANK

CONTRACT NO. 66809

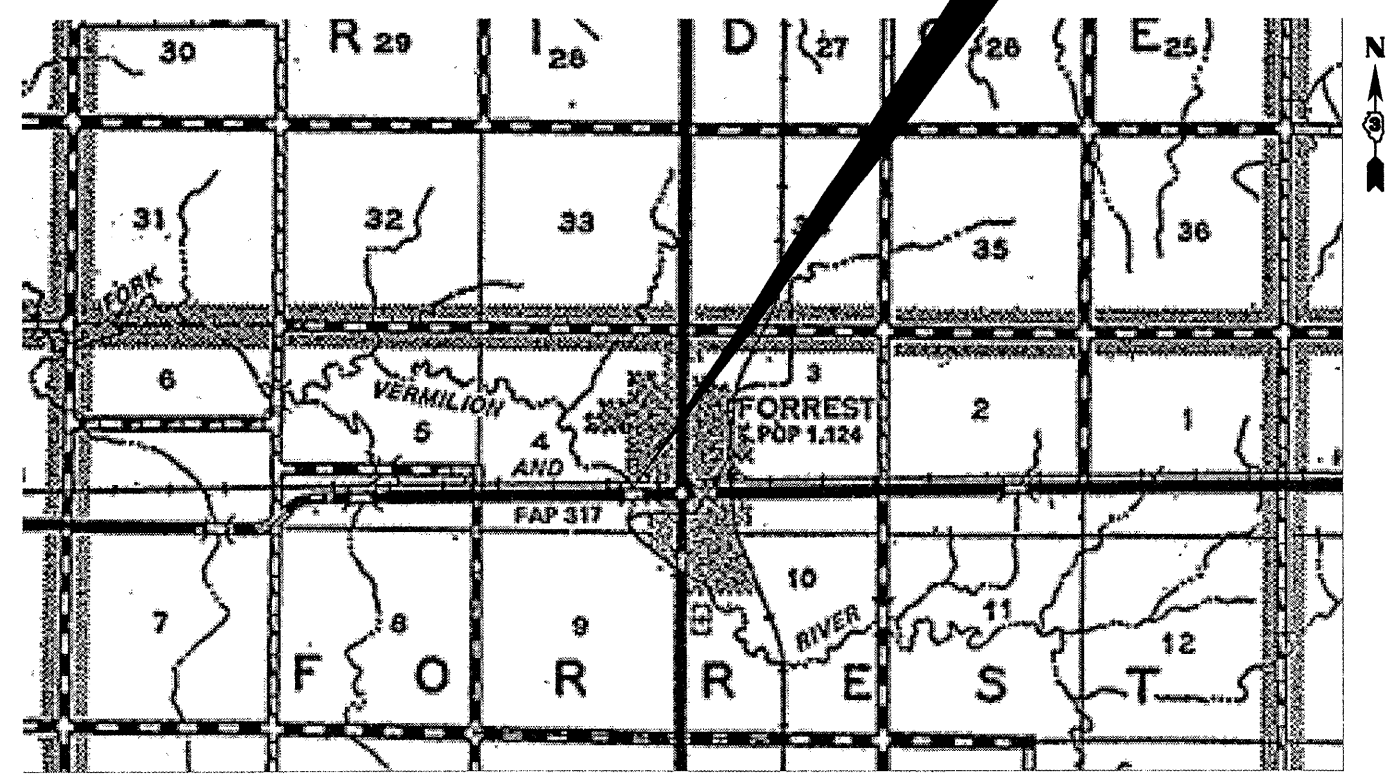

LOCATION MAP  
NOT TO SCALE  
POINT LOCATION