

NOTE 1: FACE OF ROADWAY CURB

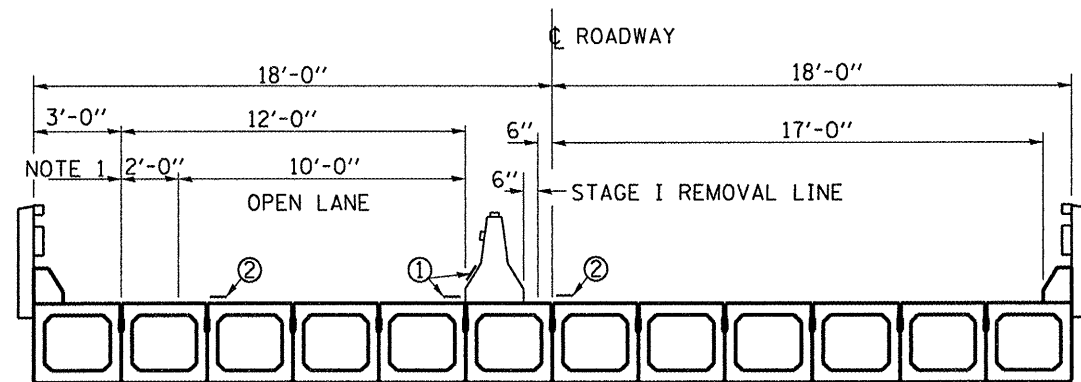

CROSS SECTION

NOTES:

1. THE CONTRACTOR HAS THE OPTION OF USING EITHER THE LINE ON THE TEMPORARY CONCRETE BARRIER OR ON THE PAVEMENT.
2. THE COST OF THE REFLECTORS AND THE BARRIER/PAVEMENT MARKING LINE IS INCLUDED IN THE COST OF THE TEMPORARY CONCRETE BARRIER.
3. THE COST OF THE TEMPORARY PAVEMENT MARKING IS INCLUDED IN THE COST OF STANDARD 701321

- ① MARKING LINE 4"
- ② PAVEMENT MARKING REMOVAL

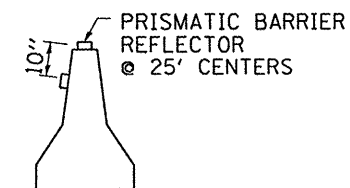
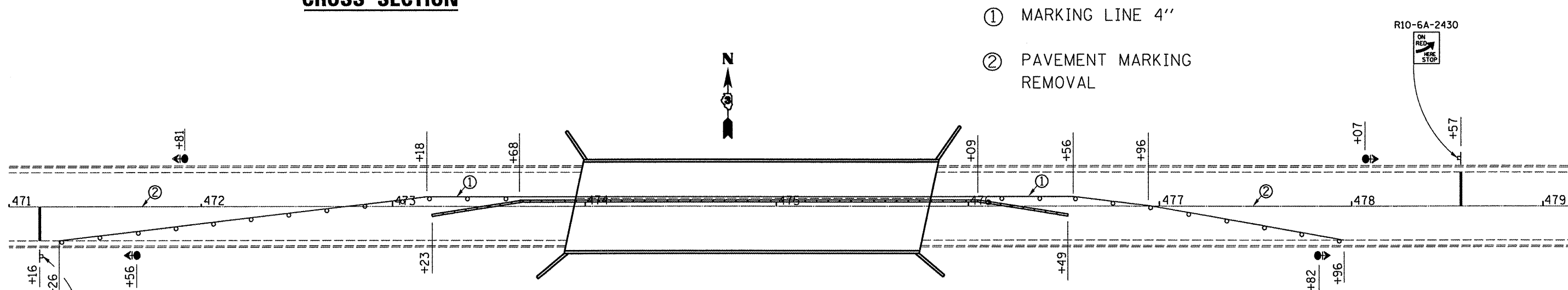

TEMPORARY CONCRETE BARRIER

BILL OF MATERIAL

PAVEMENT MARKING REMOVAL	SQ FT	93
TEMPORARY CONCRETE BARRIER	FOOT	326
IMPACT ATTENUATOR, TEMPORARY (NON-REDIRECTIVE, TEST LEVEL 3)	EACH	2
THERMOPLASTIC PAVEMENT MARKING - LINE 6"	FOOT	186

SYMBOLS

- Work area
- Sign
- Type III barricade
- Microwave detector
- Traffic signal with backplate
- Impact attenuator
- Drum with steady burning light at 25' cts.
- Temporary concrete barrier
- Double vertical panel at 25' cts.
- Crystal, bidirectional barrier wall/guardrail marker at 25' cts.

SEE STANDARD 701321 FOR DETAILS NOT SHOWN

FILE NAME =	USER NAME = woodshenkr1	DESIGNED - RLW	REVISED - ---	STATE OF ILLINOIS DEPARTMENT OF TRANSPORTATION	STAGE DETAILS - STAGE I	F.A.P. RTE.	SECTION	COUNTY	TOTAL SHEETS	SHEET NO.
ct:\projects\deck beam repl 08\an 053-012.dgn	DRAWN - RLW	REVISED - ---	317			(25-B-1)1-1	GRUNDY	16	6	
PLOT SCALE = 1/8" = 1'-0"	CHECKED - ---	REVISED - ---	CONTRACT NO. 66809							
PLOT DATE = Mar 24, 2008 - 10:55:35 AM	DATE - ---	REVISED - ---	FED. ROAD DIST. NO. - ILLINOIS FED. AID PROJECT							