

INDEX OF SHEETS

- 1. COVER SHEET
- 2. GENERAL NOTES
- 3.-4. SUMMARY OF QUANTITIES
- 5. TYPICAL SECTIONS
- 6.-8. STAGING DETAILS
- 9. TEMPORARY CONCRETE BARRIER
- 10. TYPICAL PAVEMENT MARKING
- 11. PLAN AND ELEVATION
- 12.-14. BEAM DETAILS
- 15.-16. REPAIR DETAILS

STANDARDS

- 000001-05 STANDARD SYMBOLS, ABBREVIATIONS AND PATTERNS
- 001006 DECIMAL OF AN INCH AND OF A FOOT
- 482011-03 HMA SHOULDER STRIPS/SHOULDERS WITH RS OR WIDENING & RS PROJECTS
- 701001-01 OFF-ROAD OPERATIONS 2L, 2W, MORE THAN 4.5 m (15') AWAY
- 701006-02 OFF-ROAD OPERATIONS 2L, 2W, 4.5 m (15') TO 600 mm (24") FROM PAVEMENT EDGE
- 701011-01 OFF-ROAD MOVING OPERATIONS 2L, 2W, DAY ONLY
- 701201-02 LANE CLOSURE, 2L, 2W, DAY ONLY, FOR SPEEDS P 45 MPH
- 701206-01 LANE CLOSURE, 2L, 2W, NIGHT ONLY, FOR SPEEDS P 45 MPH
- 701301-02 LANE CLOSURE, 2L, 2W, SHORT TIME OPERATIONS
- 701311-02 LANE CLOSURE, 2L, 2W, MOVING OPERATIONS - DAY ONLY
- 701321-09 LANE CLOSURE, 2L, 2W, BRIDGE REPAIR WITH BARRIER
- 701326-02 LANE CLOSURE, 2L, 2W, PAVEMENT WIDENING, FOR SPEEDS P 45 MPH
- 701901 TRAFFIC CONTROL DEVICES
- 704001-04 TEMPORARY CONCRETE BARRIER

MICROFILMED _____
 REEL NUMBER _____
 AWARDED _____
 RESIDENT ENGINEER _____
 AS BUILT CHANGES WERE MADE
 ON THE FOLLOWING SHEETS _____

J.U.L.I.E.
 JOINT UTILITY LOCATION INFORMATION FOR EXCAVATION
 1-800-892-0123

DISTRICT 3 NO. (815) 434-6131

PROJECT ENGINEER: JOE KANNEL
 UNIT CHIEF: RON WOODSHANK

CONTRACT NO. 66810

STATE OF ILLINOIS
DEPARTMENT OF TRANSPORTATION
DIVISION OF HIGHWAYS
PROPOSED
HIGHWAY PLANS

FAP ROUTE 68 (IL 23)
SECTION (102-B-1)I

LIVINGSTON COUNTY
C-93-087-08
DECK BEAM REPLACEMENT

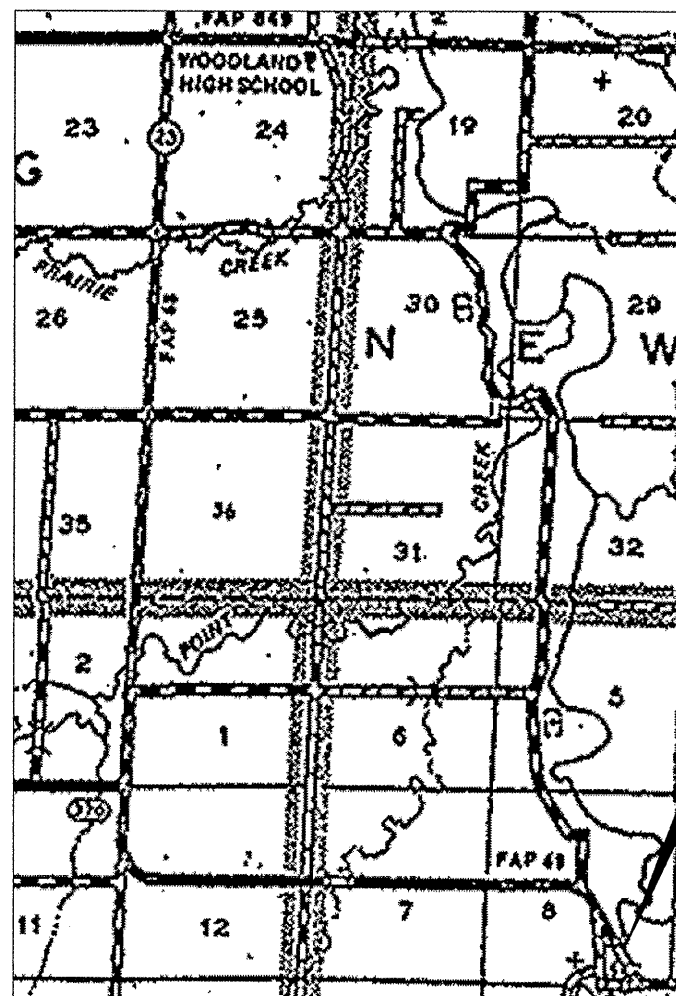

LOCATION MAP
 NOT TO SCALE
 POINT LOCATION

F.A.P. RTE.	SECTION	COUNTY	TOTAL SHEETS	SHEET NO.
68	(102-B-1)I	LIVINGSTON	16	1
FED. ROAD DIST. NO.	ILLINOIS	CONTRACT NO. 66810		

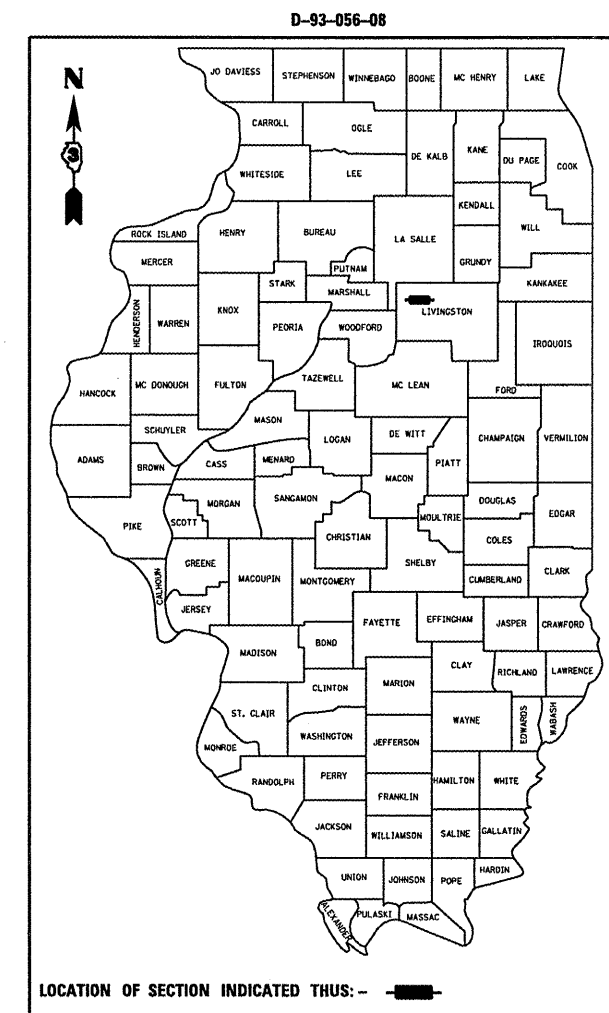

LOCATION OF SECTION INDICATED THUS: - [shaded area] -

PROJECT LOCATION
 SN 053-0161
 7.31 MILES SOUTH OF IL 17

FUNCTIONAL CLASSIFICATION
 RURAL - MINOR ARTERIAL
 F.A.P. ROUTE 68 (IL 23)
 2005 ADT = 1450
 P.V = 87.2 % M.U. = 4.1 % S.U. = 8.6 %

STATE OF ILLINOIS
 DEPARTMENT OF TRANSPORTATION
 DIVISION OF HIGHWAYS

SUBMITTED 3125 20 08

George E. Ryan
 DEPUTY DIRECTOR OF HIGHWAYS, REGION ENGINEER

May 9, 2008
Erin E. Harman
 INTERIM ENGINEER OF DESIGN AND ENVIRONMENT

May 9, 2008
Christine M. Reed
 DIRECTOR OF HIGHWAYS, CHIEF ENGINEER

PRINTED BY THE AUTHORITY
OF THE STATE OF ILLINOIS