

F.A.P. RTE.	SECTION	COUNTY	TOTAL SHEETS	SHEET NO.
693	(19-BR-1)I	FORD	15	1
FED. ROAD DIST. NO.	ILLINOIS	CONTRACT NO. 66819		

STATE OF ILLINOIS  
DEPARTMENT OF TRANSPORTATION  
DIVISION OF HIGHWAYS  
**PROPOSED  
HIGHWAY PLANS**

FAP ROUTE 693 (IL 9)  
SECTION (19-BR-1)I

C-93-093-08  
FORD COUNTY  
**DECK BEAM REPLACEMENT & SUPPORT**

**INDEX OF SHEETS**

1. COVER SHEET
2. GENERAL NOTES
- 3 - 4. SUMMARY OF QUANTITIES
5. TYPICAL SECTIONS
- 6 - 8. STAGING DETAILS
9. TEMPORARY CONCRETE BARRIER
10. TYPICAL PAVEMENT MARKING
11. PLAN AND ELEVATION
- 12 - 15. REPAIR DETAILS

**STANDARDS**

- |           |  |
|-----------|--|
| 000001-05 | STANDARD SYMBOLS, ABBREVIATIONS AND PATTERNS                               |
| 001006    | DECIMAL OF AN INCH AND OF A FOOT   |
| 482011-03 | HMA SHOULDER STRIPS/SHOULDERS WITH RS OR WIDENING & RS PROJECTS            |
| 701001-01 | OFF-ROAD OPERATIONS 2L, 2W, MORE THAN 4.5 m (15') AWAY                     |
| 701006-02 | OFF-ROAD OPERATIONS 2L, 2W, 4.5 m (15') TO 600 mm (24") FROM PAVEMENT EDGE |
| 701011-01 | OFF-ROAD MOVING OPERATIONS 2L, 2W, DAY ONLY                                |
| 701201-02 | LANE CLOSURE, 2L, 2W, DAY ONLY, FOR SPEEDS ≥ 45 MPH                        |
| 701206-01 | LANE CLOSURE, 2L, 2W, NIGHT ONLY, FOR SPEEDS ≥ 45 MPH                      |
| 701301-02 | LANE CLOSURE, 2L, 2W, SHORT TIME OPERATIONS                                |
| 701311-02 | LANE CLOSURE, 2L, 2W, MOVING OPERATIONS - DAY ONLY                         |
| 701321-09 | LANE CLOSURE, 2L, 2W, BRIDGE REPAIR WITH BARRIER                           |
| 701326-02 | LANE CLOSURE, 2L, 2W, PAVEMENT WIDENING, FOR SPEEDS ≥ 45 MPH               |
| 701901    | TRAFFIC CONTROL DEVICES  |
| 704001-04 | TEMPORARY CONCRETE BARRIER   |

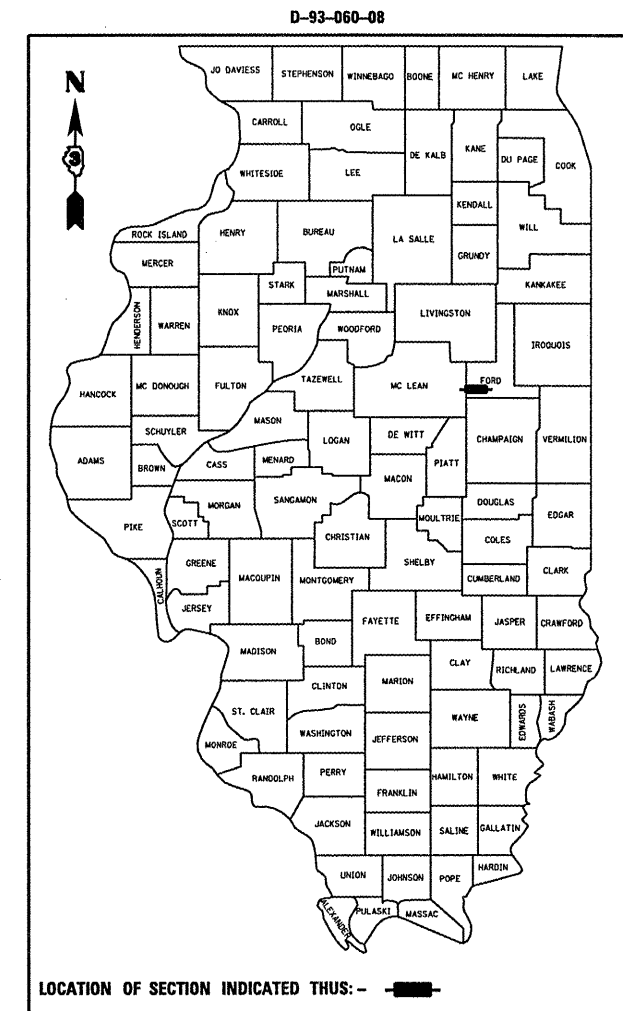

FUNCTIONAL CLASSIFICATION  
RURAL - MINOR ARTERIAL  
F.A.P. ROUTE 693 (IL 9)  
2005 ADT = 1550  
P.V = 88.4%    M.U. = 6.5%    S.U. = 5.2%

STATE OF ILLINOIS  
DEPARTMENT OF TRANSPORTATION  
DIVISION OF HIGHWAYS

SUBMITTED **3/25/08**

*George E. Ryan*  
DEPUTY DIRECTOR OF HIGHWAYS, REGION ENGINEER

May 9, 2008  
*Eric E. Harm*  
INTERIM ENGINEER OF DESIGN AND ENVIRONMENT

May 9, 2008  
*Christine M. Reed*  
DIRECTOR OF HIGHWAYS, CHIEF ENGINEER

**PRINTED BY THE AUTHORITY  
OF THE STATE OF ILLINOIS**

**PROJECT LOCATION**  
SN 027-0005  
1.04 MILES WEST OF IL ROUTE 47

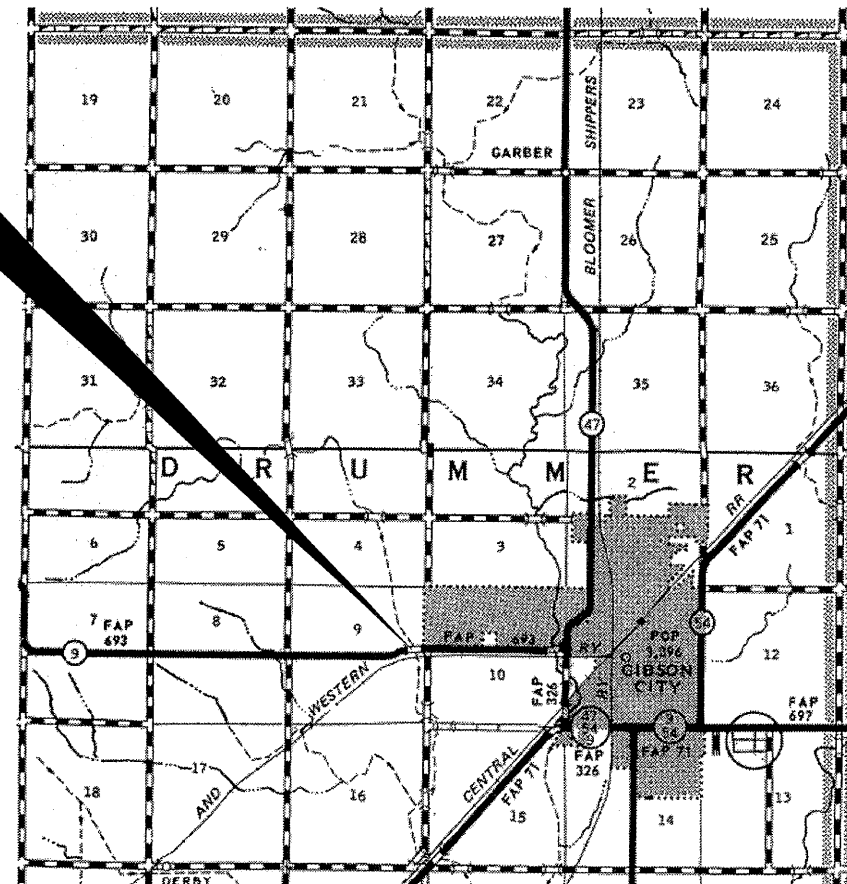

**LOCATION MAP**  
NOT TO SCALE  
POINT LOCATION

MICROFILMED \_\_\_\_\_  
REEL NUMBER \_\_\_\_\_  
AWARDED \_\_\_\_\_  
RESIDENT ENGINEER \_\_\_\_\_  
AS BUILT CHANGES WERE MADE  
ON THE FOLLOWING SHEETS \_\_\_\_\_

J.U.L.I.E.  
JOINT UTILITY LOCATION INFORMATION FOR EXCAVATION  
1-800-892-0123

DISTRICT 3 NO. (815) 434-6131

PROJECT ENGINEER: JOE KANNEL  
UNIT CHIEF: RON WOODSHANK

**CONTRACT NO. 66819**