

**CROSS SECTION  
LOOKING WEST**

- NOTES:
1. THE CONTRACTOR HAS THE OPTION OF USING EITHER THE LINE ON THE TEMPORARY CONCRETE BARRIER OR ON THE PAVEMENT.
  2. THE COST OF THE REFLECTORS AND THE BARRIER/PAVEMENT MARKING LINE IS INCLUDED IN THE COST OF THE TEMPORARY CONCRETE BARRIER.
  3. THE COST OF THE TEMPORARY PAVEMENT MARKING IS INCLUDED IN THE COST OF STANDARD 701321

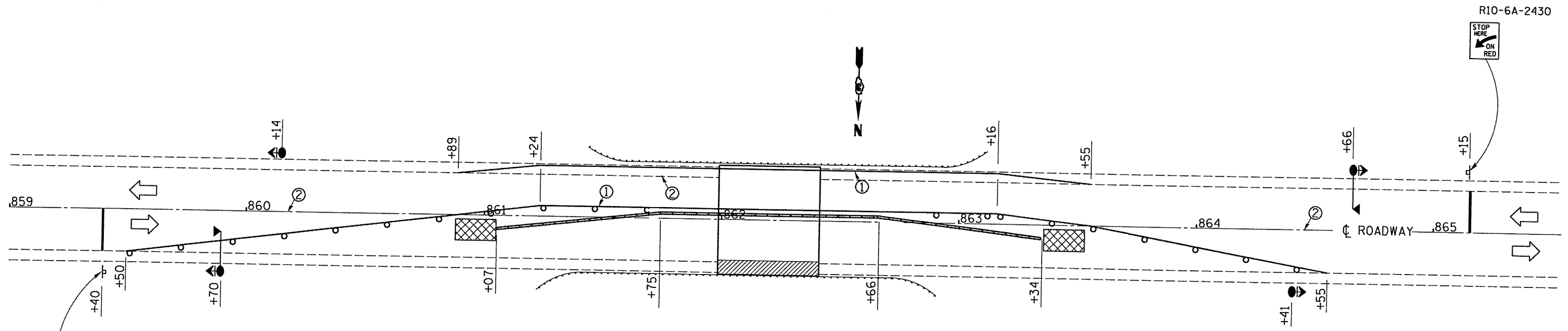

- ① TEMPORARY PAVEMENT MARKING LINE 4"
- ② PAVEMENT MARKING REMOVAL

**BILL OF MATERIAL**

PAVEMENT MARKING REMOVAL	SQ FT	124
TEMPORARY CONCRETE BARRIER	FOOT	227
IMPACT ATTENUATOR, TEMPORARY (NON-REDIRECTIVE, TEST LEVEL 3)	EACH	2

**SYMBOLS**

- Work area
- Sign
- Type III barricade
- Microwave detector
- Traffic signal with backplate
- Impact attenuator
- Drum with steady burning light at 25' cts.
- Temporary concrete barrier
- Double vertical panel at 25' cts.
- Crystal, bidirectional barrier wall/guardrail marker at 25' cts.

SEE STANDARD 701321 FOR DETAILS NOT SHOWN

FILE NAME =	USER NAME = woodshankr1	DESIGNED - RLW	REVISED -	<b>STATE OF ILLINOIS DEPARTMENT OF TRANSPORTATION</b>	<b>STAGING DETAILS - STAGE II</b>	F.A.P. RTE.	SECTION	COUNTY	TOTAL SHEETS	SHEET NO.
PROJECTS\view\deck beam repl 08\an 07-0005.dgn		DRAWN - RLW	REVISED -			693	(19-BR-11)	FORD	15	7
PLOT SCALE = 1/8" = 1' / IN.		CHECKED -	REVISED -			CONTRACT NO. 66819				
PLOT DATE = Mar 14, 2008 - 08:19:27 AM		DATE -	REVISED -			FED. ROAD DIST. NO. - ILLINOIS FED. AID PROJECT				