

**CROSS SECTION**

**NOTES:**

1. THE CONTRACTOR HAS THE OPTION OF USING EITHER THE LINE ON THE TEMPORARY CONCRETE BARRIER OR ON THE PAVEMENT.
2. THE COST OF THE REFLECTORS AND THE BARRIER/PAVEMENT MARKING LINE IS INCLUDED IN THE COST OF THE TEMPORARY CONCRETE BARRIER.
3. THE COST OF THE TEMPORARY PAVEMENT MARKING IS INCLUDED IN THE COST OF STANDARD 701321

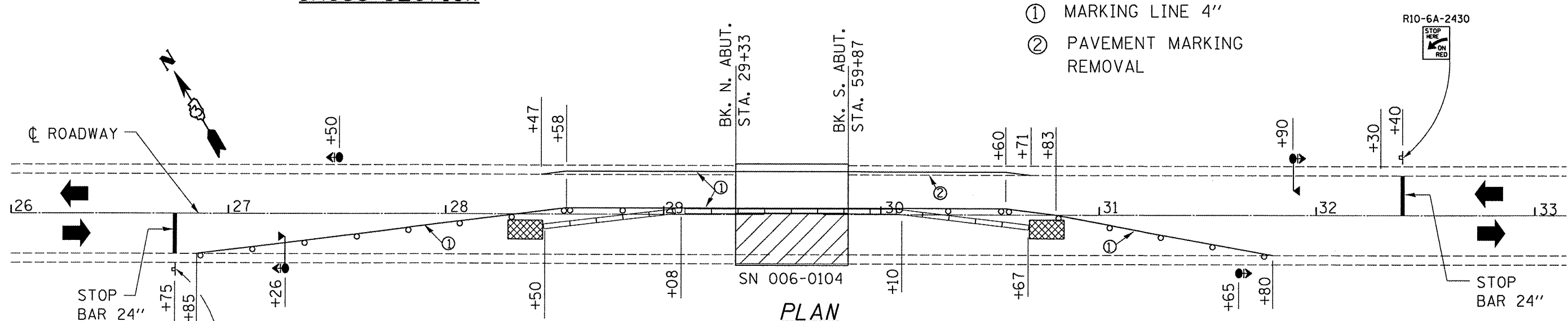

**PLAN**

- ① MARKING LINE 4"
- ② PAVEMENT MARKING REMOVAL

R10-6A-2430



R10-6A-2430



**BILL OF MATERIAL**

|   |       |     |
|---|-------|-----|
| PAVEMENT MARKING REMOVAL                                    | SQ FT | 74  |
| RELOCATE TEMPORARY CONCRETE BARRIER                         | FOOT  | 217 |
| IMPACT ATTENUATOR, RELOCATE (NON-REDIRECTIVE, TEST LEVEL 3) | EACH  | 2   |
| THERMOPLASTIC PAVEMENT MARKING - LINE 4"                    | FOOT  | 448 |
| THERMOPLASTIC PAVEMENT MARKING - LINE 6"                    | FOOT  | 141 |

**SYMBOLS**

- Work area
- Sign
- Type III barricade
- Microwave detector
- Traffic signal with backplate
- Impact attenuator
- Drum with steady burning light at 25' cts.
- Temporary concrete barrier
- Double vertical panel at 25' cts.
- Crystal, bidirectional barrier wall/guardrail marker at 25' cts.

SEE STANDARD 701321 FOR DETAILS NOT SHOWN