

STATE OF ILLINOIS
DEPARTMENT OF TRANSPORTATION

ROUTE NO.	SECTION	COUNTY	SHEETS	SHEET	SHEET NO.
F.A.P. 313	(21-HB-11)	KNOX	55	50	35 SHEETS
FED. ROAD DIST. NO. 7		ILLINOIS	FED. AID PROJECT-		

Contract #68216

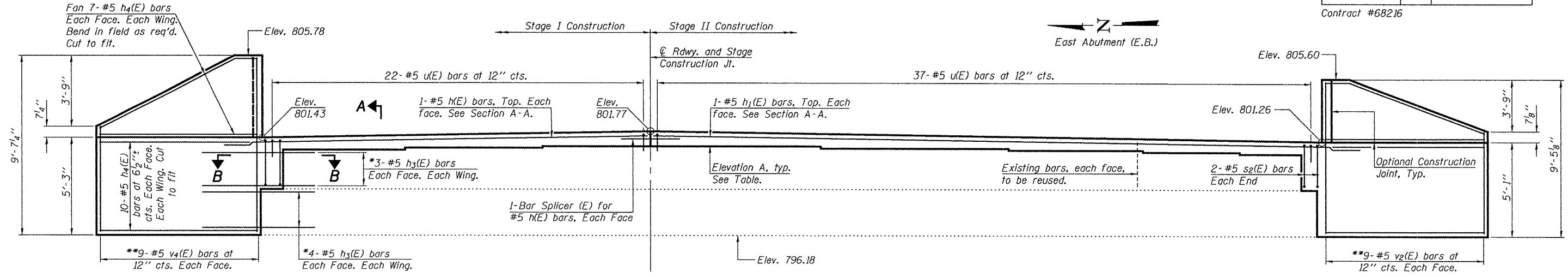

ELEVATION

Looking West at West Abutment (W.B.)
Looking East at East Abutment (E.B.)

*Epoxy Grout $h_3(E)$ bars in 9" min. drilled holes according to Article 584 of the Standard Specifications. Cost included with Reinforcement Bars, Epoxy Coated.
**See Field Cutting Diagram

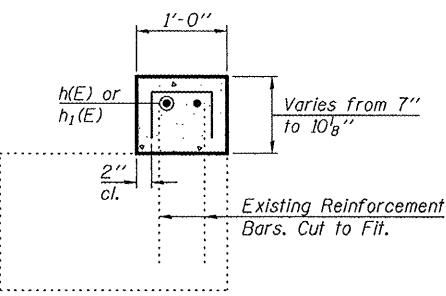

SECTION A-A

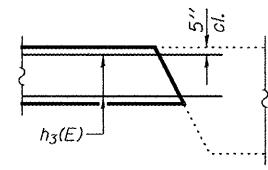

SECTION B-B

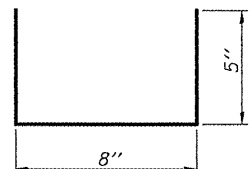

BAR U1(E)

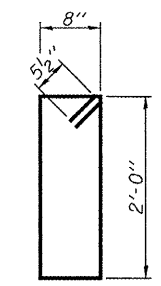

BAR S2(E)

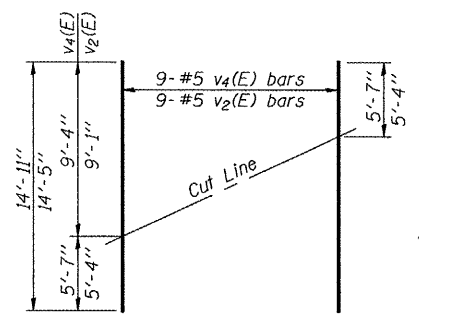

FIELD CUTTING DIAGRAM
Order $v_2(E)$ and $v_4(E)$ bars full length. Cut as shown and use remainder of bars in opposite face.

MIN. BAR LAP
#5 Bar = 1'-8"

ELEVATION A

Location	Elevation
Beams 1 & 18	800.68
Beams 2 & 17	800.74
Beams 3 & 16	800.80
Beams 4 & 15	800.84
Beams 5 & 14	800.84
Beams 6 & 13	800.93
Beams 7 & 12	800.93
Beams 8 & 11	800.87
Beams 9 & 10	800.75

BILL OF MATERIAL

Bar	No.	Size	Length	Shape
$h_1(E)$	4	#5	23'-8"	—
$h_2(E)$	4	#5	38'-5"	—
$h_3(E)$	56	#5	2'-11"	—
$h_4(E)$	136	#5	9'-7"	—
$s_2(E)$	8	#5	6'-3"	□
$u_1(E)$	118	#5	1'-6"	—
$v_2(E)$	18	#5	14'-5"	—
$v_4(E)$	18	#5	14'-11"	—
Concrete Sealer		Sq. Ft.	136	
Structure Excavation		Cu. Yd.	208.5	
Concrete Structures		Cu. Yd.	14.1	
Reinforcement Bars, Epoxy Coated		Pound	2580	

For details of Bar Splicers, see sheet 34 of 35.

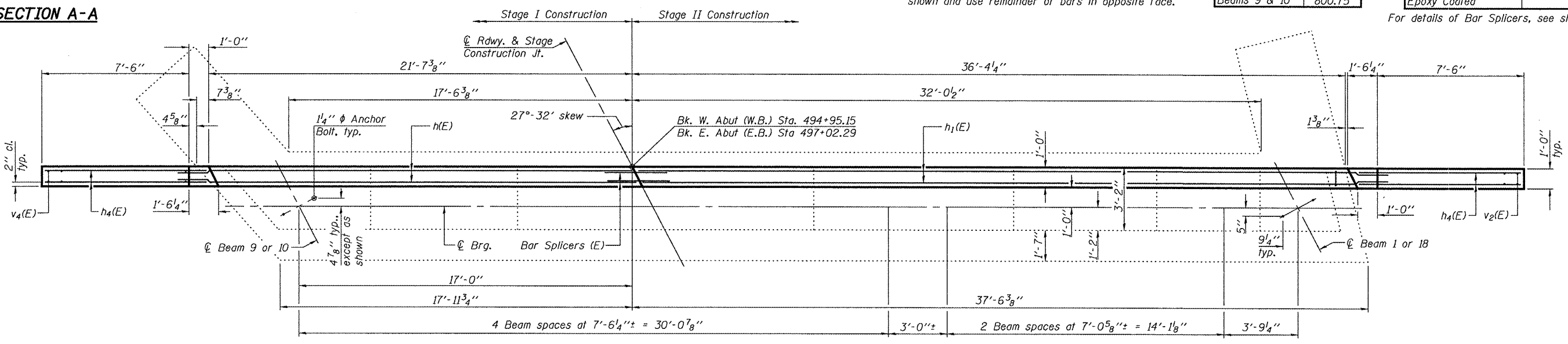

PLAN

Note:
Concrete Sealer shall be applied to the exposed area of existing concrete surface above the top of sloped wall or existing ground line.
Existing anchor bolts at each bearing location shall be cut off, ground flush and sealed with epoxy. Cost included with Concrete Removal.
Beams 1 thru 9 are at W.B. structure. Beams 10 thru 18 are at E.B. structure

WEST ABUTMENT (W.B.) AND EAST ABUTMENT (E.B.)

F.A.P. ROUTE 313 - SECTION (21-HB-11)
KNOX COUNTY
STA. 495+98.72
STRUCTURE NO. 048-0021 (W.B.)
STRUCTURE NO. 048-0022 (E.B.)

DESIGNED FT	April 28 2008
CHECKED DPN	EXAMINED <i>Thomas J. Demagallo</i>
DRAWN Gregory D. Farmer	PASSED <i>Ralph E. Carlson</i>
CHECKED FT/DPN	ENGINEER OF BRIDGES AND STRUCTURES