

PROJECT LOCATION
STA 1113+08.00 TO STA 1120+47.00
ROAD CLOSURE SHALL BE
ACCORDING TO STD. BLR 21-7

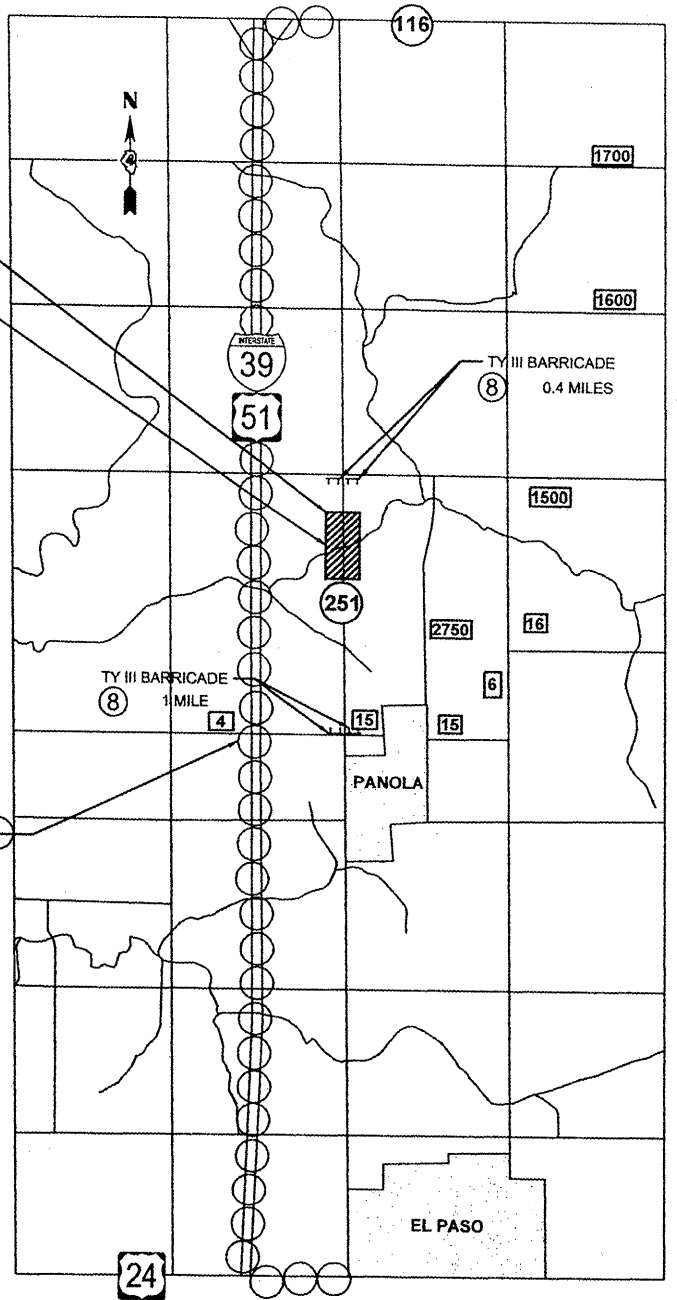
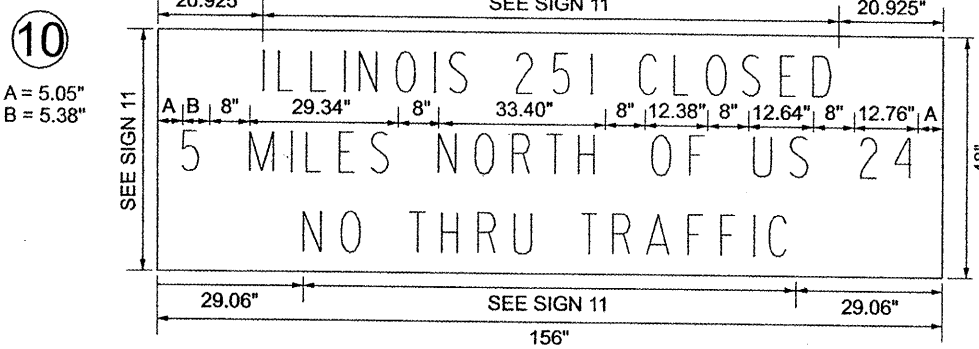
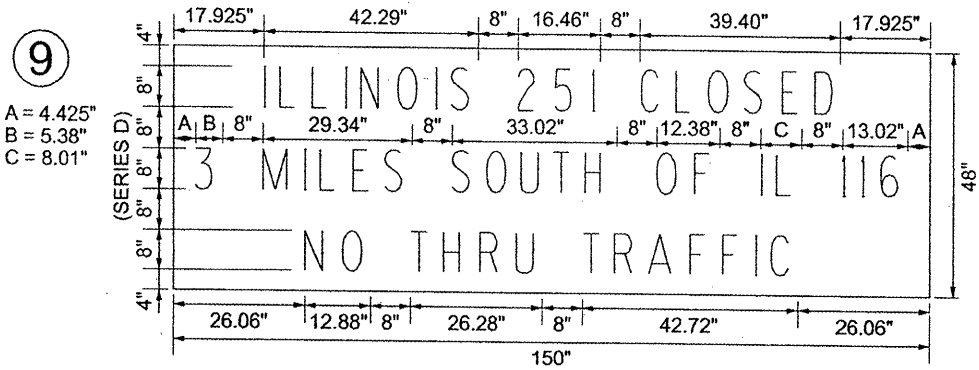

CONTACTS FOR CLOSURE

THE FOLLOWING ORGANIZATIONS SHALL BE NOTIFIED SEVEN (7) DAYS PRIOR TO THE CLOSING OF IL ROUTE 251.

- | | | |
|---|--|---|
| POSTMASTER JERRY BASSI
UNITED STATES POST OFFICE
401 WEST FRONT STREET
EL PASO, IL 61738
PHONE (309) 527-4220 | POSTMASTER LARRY MILES
UNITED STATES POST OFFICE
160 WEST 5TH STREET
MINONK, IL 61760
PHONE (309) 432-2848 | SUPERINTENDENT JAMES MILLER
EL PASO-GRIDLEY CUSD #11
97 WEST FIFTH STREET
EL PASO, IL 61738
PHONE (309) 527-4410 |
| CAPTAIN DEAN KENNEDY
ILLINOIS STATE POLICE
1265 LOURDES ROAD
METAMORA, IL 61548
PHONE (309) 383-2133 | CHIEF JEFF PRICE
EL PASO POLICE DEPARTMENT
540 EAST MAIN STREET
EL PASO, IL 61738
PHONE (309) 527-5340 | SHERIFF JIM PIERCEALL
WOODFORD COUNTY
SHERIFF DEPARTMENT
111 EAST COURT STREET
EUREKA, IL 61530
PHONE (309) 467-2375 |
| FIRE CHIEF DALE UPHOFF
EL PASO FIRE
PROTECTION DISTRICT
P.O. BOX 56
EL PASO, IL 61738
PHONE (309) 527-2555 | CAPTAIN JOHN LONGMAN
EL PASO EMERGENCY SQUAD
P.O. BOX 194
EL PASO, IL 61738
PHONE (309) 527-6145 | MR. DENNIS BACHMAN
WOODFORD COUNTY ENGINEER
301 SOUTH MAIN ST
ROANOKE, IL 61561
PHONE (309) 923-2891 |

DETOUR PLAN

THE WORK INCLUDED IN SECTION 65 BR CONSISTS OF REMOVING AND REPLACING THE EXISTING STRUCTURE. THIS REPLACEMENT WILL REQUIRE FAS 1360 (IL 251) TO BE DETOURED.

THE DETOUR WILL CONSIST OF:
IL 116 - 0.5 MILES
I 39 - 8.0 MILES
US 24 - 0.5 MILES
TOTAL - 9.0 MILES (ADVERSE TRAVEL DISTANCE 0.9 MILES)

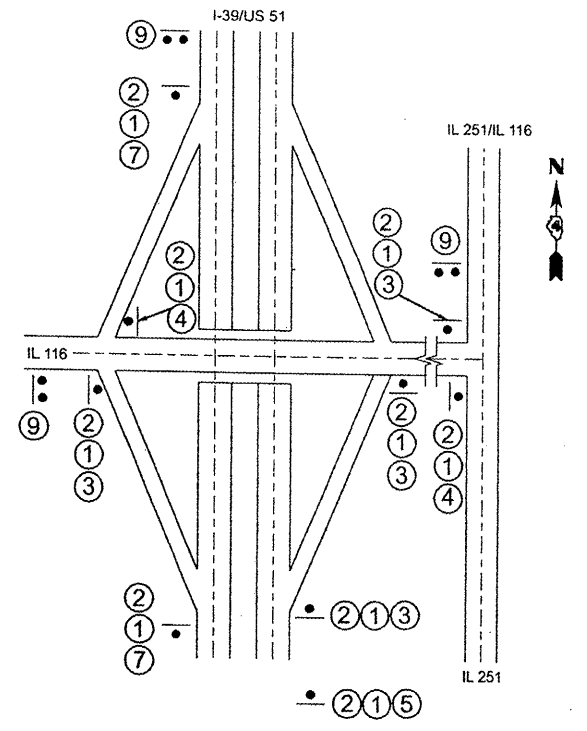

- | | |
|---|--|
| ① ILLINOIS 251
54" X 36"
20 SIGNS | ⑦ ↑
30" X 18"
6 SIGNS M6-3 |
| ② DETOUR
30" X 15"
20 SIGNS M4-8 | ⑧ ROAD CLOSED
MILES AHEAD
LOCAL TRAFFIC ONLY
60" X 30"
2 SIGNS
ONE SIGN WILL READ 0.4 MILES
ONE SIGN WILL READ 1 MILE R11-3a |
| ③ →
30" X 18"
8 SIGNS M6-1 | ⑨ ILLINOIS 251 CLOSED
3 MILES SOUTH OF IL 116
NO THRU TRAFFIC
150" X 48"
3 SIGNS |
| ④ ←
30" X 18"
4 SIGNS M6-1 | ⑪ NORTH
30" X 15"
1 SIGN M3-1 |
| ⑤ ↗
30" X 18"
2 SIGNS M5-1 | ⑫ SOUTH
30" X 15"
1 SIGN M3-3 |
| ⑥ ↖
30" X 18"
0 SIGNS M5-1 | ⑩ ILLINOIS 251 CLOSED
5 MILES NORTH OF US 24
NO THRU TRAFFIC
156" X 48"
4 SIGNS |

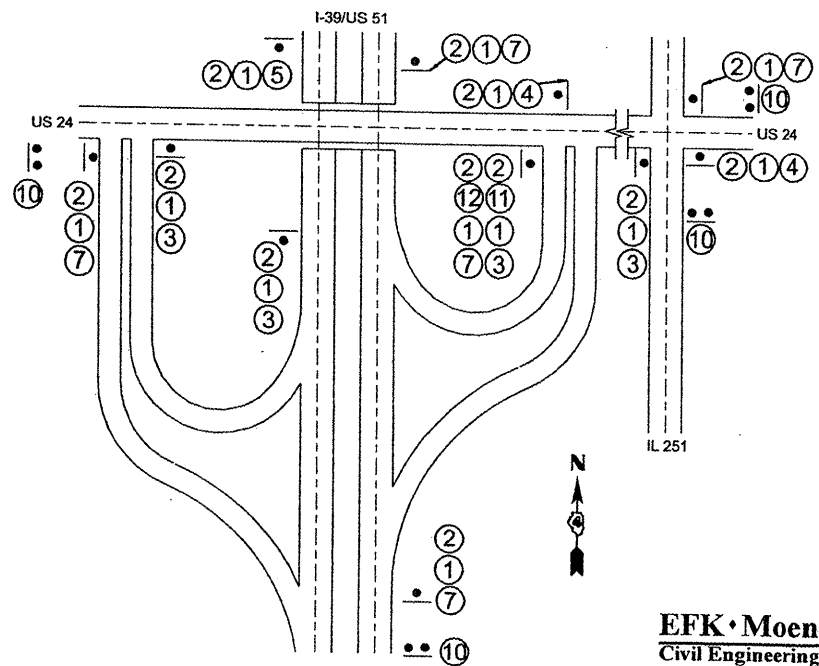

FILE NAME :	USER NAME :	DESIGNED -	REVISED -
		DRAWN - JD	REVISED -
		CHECKED - SD	REVISED -
		DATE - 2/25/08	REVISED -

STATE OF ILLINOIS
DEPARTMENT OF TRANSPORTATION

CONTACTS FOR CLOSURE, DETOUR PLAN
IL 251 DETOUR SIGNING

F.A.S. RTE. 1360	SECTION 65 BR	COUNTY WOODFORD	TOTAL SHEETS 39	SHEET NO. 7
CONTRACT NO. 68530				

EFK Moen, LLC
Civil Engineering Design