

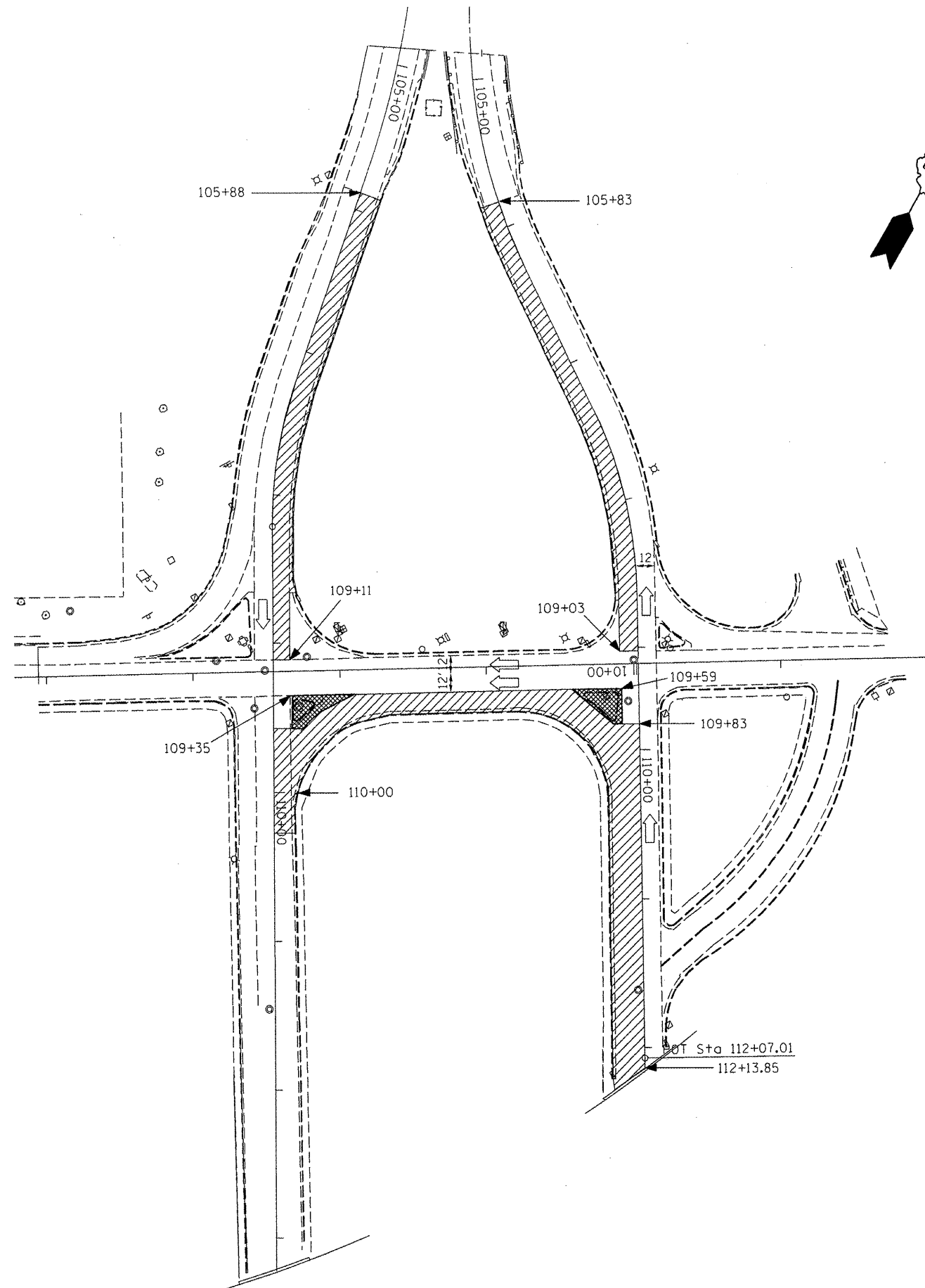





F.A.P. RTE.	SECTION	COUNTY	TOTAL SHEETS	SHEET NO.
693		TAZEWELL	82	32
STA. _____		TO STA. _____		
FED. ROAD DIST. NO. _____		ILLINOIS FED. AID PROJECT		

*13R-1:(9)TS:(12)BL,1-1

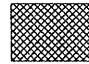

1. REMOVING EXISTING ISLANDS AT THE SE CORNER OF ANN ELIZA AND SECOND ST., AND THE NE CORNER OF MARGARET AND SECOND ST.; PLACE TEMPORARY PAVEMENT FLUSH WITH PAVEMENT TO PREPARE FOR THE NEW ISLANDS.
2. REMOVE EXISTING PAVEMENT AND CURB AND GUTTER; CONSTRUCT PROPOSED INSIDE LANES OF EAST BOUND AND WEST BOUND IL. 9 AND SECOND ST.

LEGEND

	REMOVAL/REPLACEMENT
	TEMPORARY PAVEMENT
	NOT TO BE DISTURBED
	TEMP PAVEMENT REMOVAL
	OPTIONAL HIGH EARLY STRENGTH CONCRETE

PLOT DATE : 5/29/2009
 FILE NAME : S:\GEN\PROJ\11208\PLANS\CONSTR\68608\11208\11208.dgn
 PLOT SCALE : 1/8" = 1'-0"
 USER NAME : brucebn

REVISIONS	
NAME	DATE

ILLINOIS DEPARTMENT OF TRANSPORTATION

CONSTRUCTION STAGING
STAGE 2

SCALE: VERT.
HORIZ.
DATE

DRAWN BY
CHECKED BY