

S. N. 092-0006 (EASTBOUND LANES)
S. N. 092-0007 (WESTBOUND LANES)

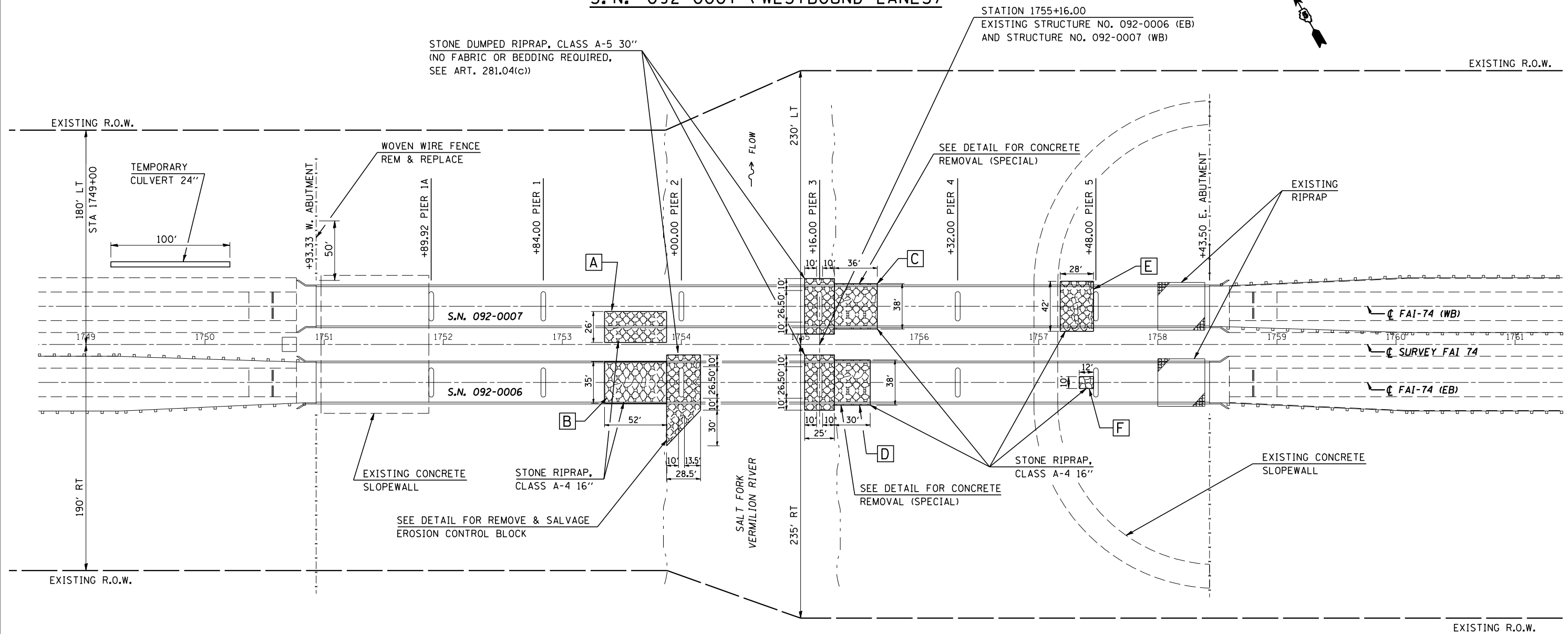

SCOUR REPAIR SCHEDULE

LOCATION	FABRIC AREA (SY)	REPAIR AREA (SY)	TYPE OF REPAIR	RIPRAP THICKNESS (IN)	BEDDING THICKNESS (IN)	RIPRAP ESTIMATED TONS	WOVEN WIRE FENCE (FT)	CONC. REMOVAL (SPECIAL) (CY)	REM & SALVAGE EROSION CONTROL BLOCK (L SUM)
PIER #2 (S)	0.0	185.0	A-5	30	0	238.0	50.0	0.0	1.0
PIER #3 (N)	0.0	123.0	A-5	30	0	157.5	0.0	0.0	0.0
PIER #3 (S)	0.0	123.0	A-5	30	0	157.5	0.0	0.0	0.0
A	150.0	150.0	A-4	16	6	101.0	0.0	0.0	0.0
B	202.0	202.0	A-4	16	6	135.0	0.0	0.0	0.0
C	152.0	152.0	A-4	16	6	101.0	0.0	11.5	0.0
D	127.0	127.0	A-4	16	6	85.0	0.0	11.5	0.0
E	131.0	131.0	A-4	16	6	88.0	0.0	0.0	0.0
F	14.0	14.0	A-4	16	6	9.0	0.0	0.0	0.0

NOTE:
 UNDER NO CIRCUMSTANCES
 ARE THE BRIDGE PIER
 FOOTINGS TO BE UNCOVERED.

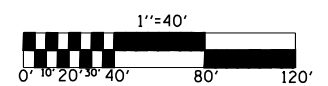

ILLINOIS DEPARTMENT OF TRANSPORTATION
PLANS SHEETS
S.N. 092-0006 & S.N. 092-0007
 F.A.I. ROUTE 74
 SECTION D5 SCOUR MITIGATION 2008-1
 VERMILION COUNTY

SCALE: N/A
 DATE: 02-07-08

DRAWN BY: CADD
 CHECKED BY: