

NORTHING: 1282938.8390
 EASTING: 1023318.2620
 ELEV. =
 STA. 69+81.76
 OFFSET: 22.42' RT

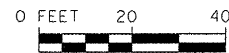

CONTROL POINT 500
IRON PIN WITH CAP

NORTHING: 1282938.7880
 EASTING: 1023525.5420
 ELEV. =
 STA. 71+89.04
 OFFSET: 23.25' RT

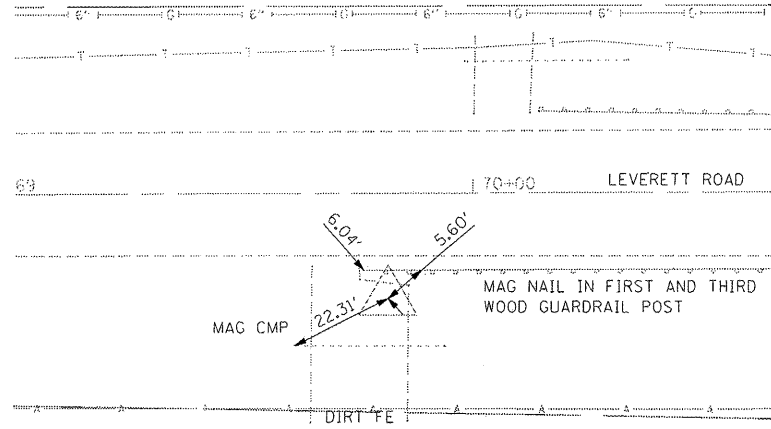
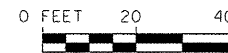
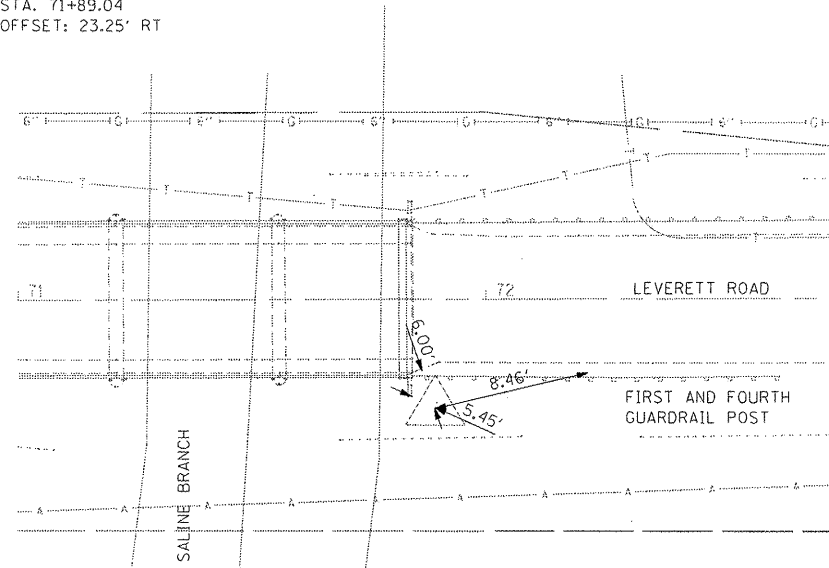

CONTROL POINT 400
IRON PIN WITH CAP

NORTHING: 1282930.8470
 EASTING: 1024274.0870
 ELEV. =
 STA. 79+37.55
 OFFSET: 33.95' RT

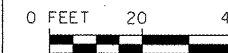
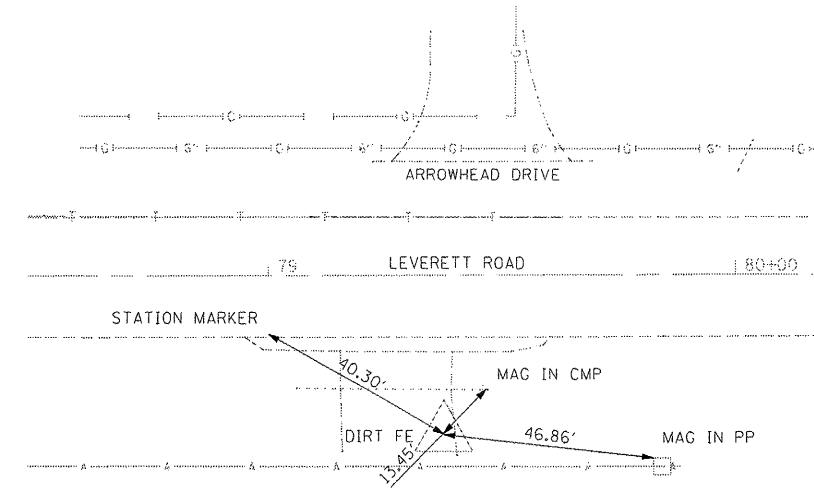

CONTROL POINT 401
IRON PIN WITH CAP

FILE NAME: s:\186\3811-358\346\088\micra\tie-off.dgn

STRAND ASSOCIATES, INC.
 ENGINEERS
 1170 SOUTH HOUBOLT ROAD
 JOLIET, ILLINOIS 60431
 (815) 744-4200

USER NAME: k1ndr08	DESIGNED: RRD	REVISED:
PLT SCALE:	DRAWN: KAS	REVISED:
PLT DATE: 3/28/2008	CHECKED: JAR	REVISED:
	DATE: 3/14/08	REVISED:

STATE OF ILLINOIS
DEPARTMENT OF TRANSPORTATION

CONTROL POINT TIE-OFFS

SCALE: AS SHOWN SHEET NO. OF SHEETS STA. TO STA.

F.A.S. RTE.	SECTION	COUNTY	TOTAL SHEETS	SHEET NO.
502	186BR1BR	CHAMPAIGN	30	7
CONTRACT NO. 70426				
FED. ROAD DIST. NO. ILLINOIS FED. AID PROJECT				