

F.A.I. RTE.	SECTION	COUNTY	TOTAL SHEETS	SHEET NO.
74	(20-1)RS-2	DEWITT	97	44
STA. 845+00		TO STA. 860+00		
FED. ROAD DIST. NO.	ILLINOIS	FED. AID PROJECT		

EXIST. CURVE RAMP-A-1  
 PI STA. = 109+68.49  
 $\Delta = 47^\circ 49' 29''$  (RT)  
 D = 8° 18' 00"  
 R = 690.31'  
 T = 306.08'  
 L = 576.20'  
 E = 64.81'  
 e = ----  
 T.R. = ----  
 S.E. RUN = ----  
 P.C. STA. = 106+62.40  
 P.T. STA. = 112+38.60

PLAN NOTE:  
 AREA OF 2 FT. SHOULDER WIDENING AT THE INTERCHANGE RAMP NOT SHOWN. SEE PROPOSED TYPICAL SECTION ④ AND THE SCHEDULE OF QUANTITIES FOR LOCATIONS.

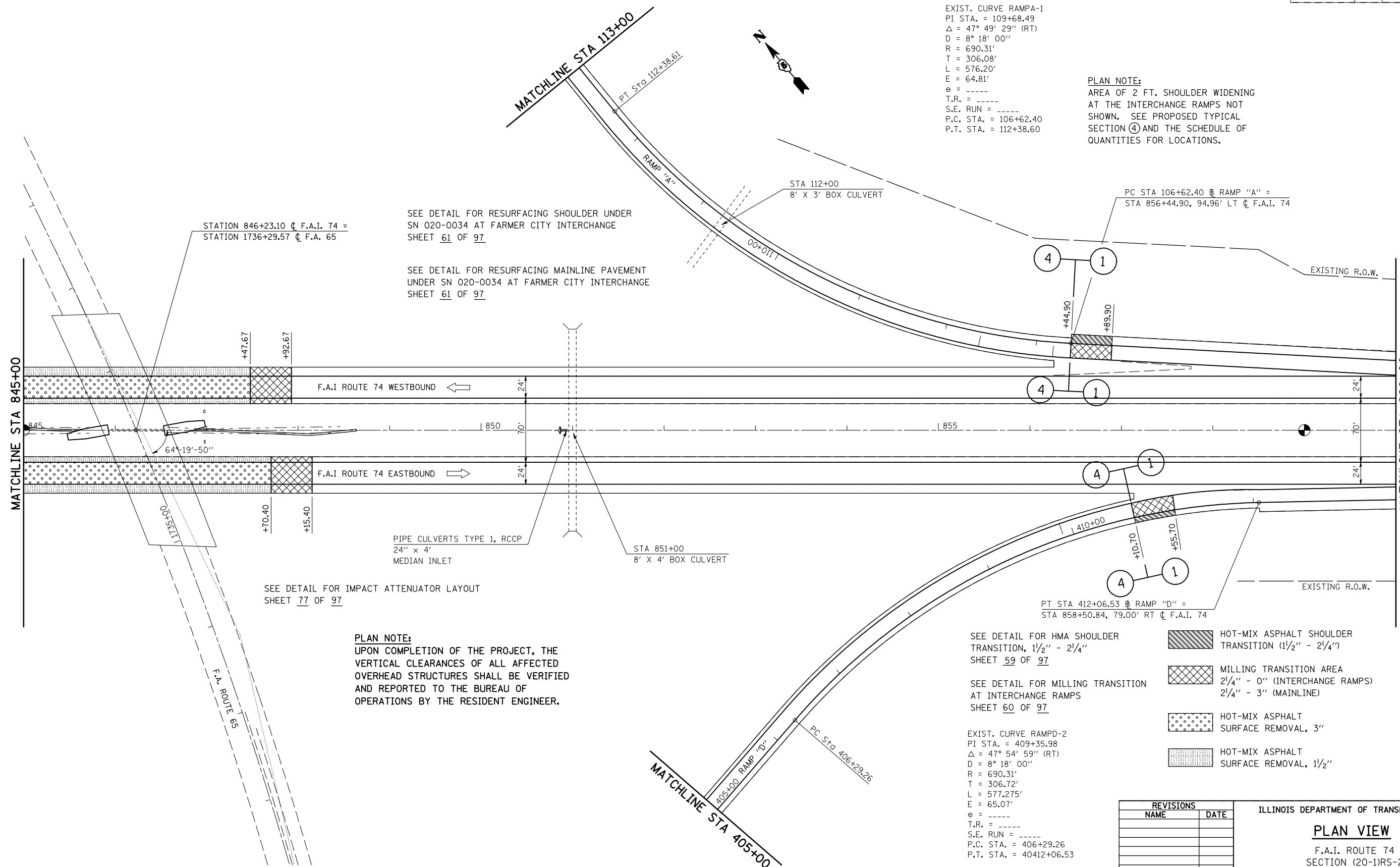

SEE DETAIL FOR RESURFACING SHOULDER UNDER SN 020-0034 AT FARMER CITY INTERCHANGE SHEET 61 OF 97

SEE DETAIL FOR RESURFACING MAINLINE PAVEMENT UNDER SN 020-0034 AT FARMER CITY INTERCHANGE SHEET 61 OF 97

SEE DETAIL FOR IMPACT ATTENUATOR LAYOUT SHEET 77 OF 97

PLAN NOTE:  
 UPON COMPLETION OF THE PROJECT, THE VERTICAL CLEARANCES OF ALL AFFECTED OVERHEAD STRUCTURES SHALL BE VERIFIED AND REPORTED TO THE BUREAU OF OPERATIONS BY THE RESIDENT ENGINEER.

SEE DETAIL FOR HMA SHOULDER TRANSITION, 1 1/2" - 2 1/4" SHEET 59 OF 97

SEE DETAIL FOR MILLING TRANSITION AT INTERCHANGE RAMP SHEET 60 OF 97

EXIST. CURVE RAMP-D-2  
 PI STA. = 409+35.98  
 $\Delta = 47^\circ 54' 59''$  (RT)  
 D = 8° 18' 00"  
 R = 690.31'  
 T = 306.72'  
 L = 577.275'  
 E = 65.07'  
 e = ----  
 T.R. = ----  
 S.E. RUN = ----  
 P.C. STA. = 406+29.26  
 P.T. STA. = 40412+06.53

- HOT-MIX ASPHALT SHOULDER TRANSITION (1 1/2" - 2 1/4")
- MILLING TRANSITION AREA 2 1/4" - 0" (INTERCHANGE RAMP) 2 1/4" - 3" (MAINLINE)
- HOT-MIX ASPHALT SURFACE REMOVAL, 3"
- HOT-MIX ASPHALT SURFACE REMOVAL, 1 1/2"

REVISIONS	
NAME	DATE

ILLINOIS DEPARTMENT OF TRANSPORTATION  
**PLAN VIEW**  
 F.A.I. ROUTE 74  
 SECTION (20-1)RS-2  
 DEWITT COUNTY

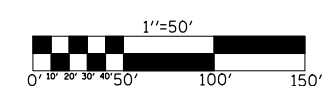

SCALE: VERT. 1"=50'  
 HORIZ. 1"=50'  
 DATE: 06/24/05  
 DRAWN BY: JRP  
 CHECKED BY: