

TRAFFIC SIGNAL MODERNIZATION

F.A.P. 730 U.S. 51 (CENTER ST.)

&

LOCUST STREET

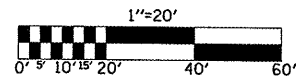

SIGNAL LAYOUT

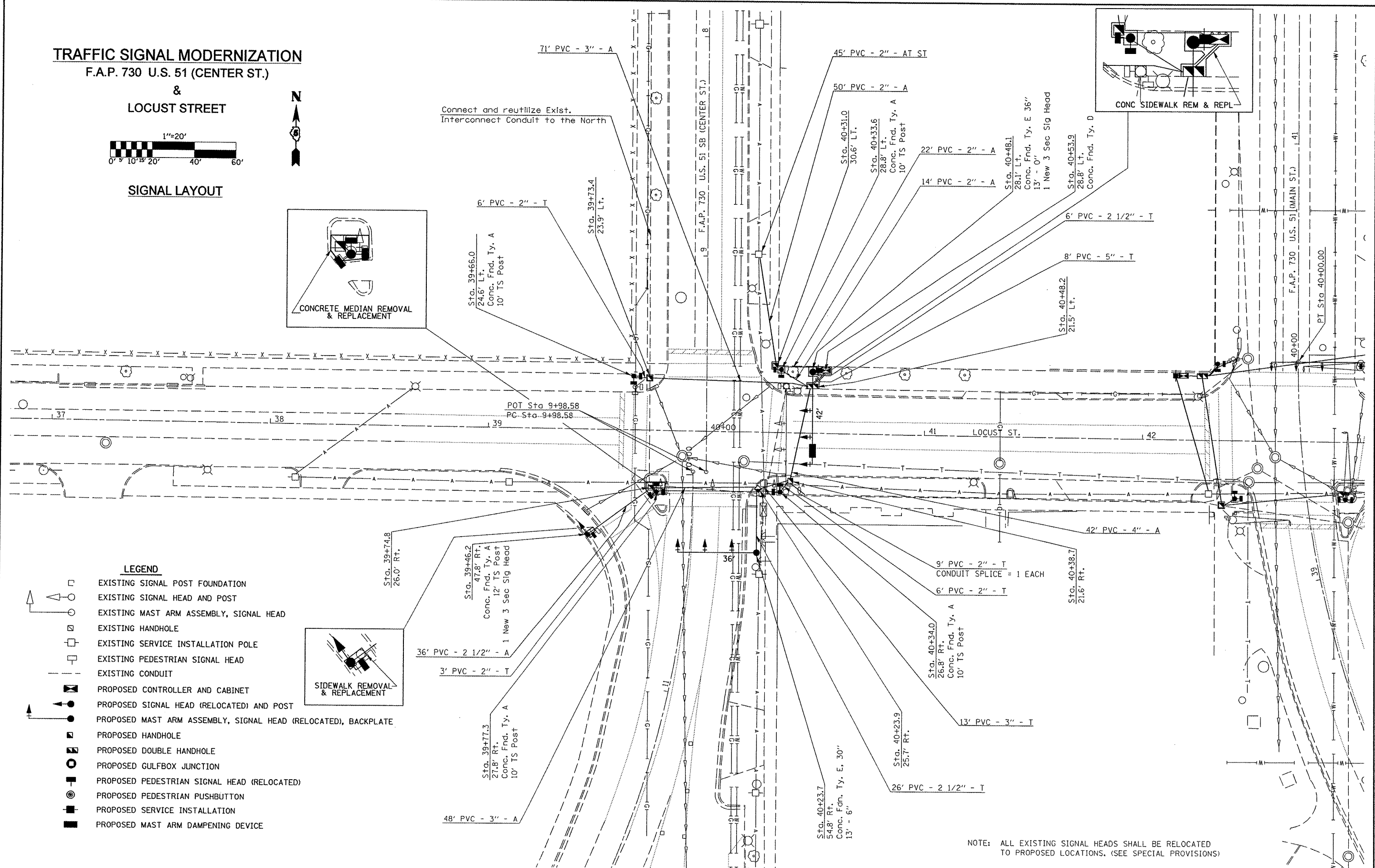
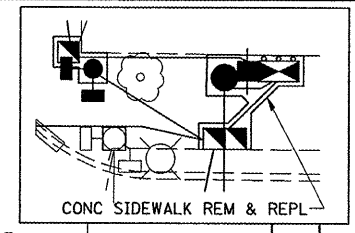
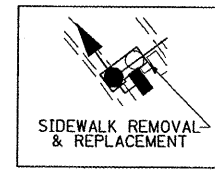
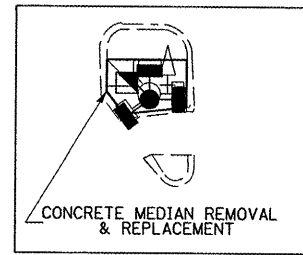

LEGEND

- EXISTING SIGNAL POST FOUNDATION
- EXISTING SIGNAL HEAD AND POST
- EXISTING MAST ARM ASSEMBLY, SIGNAL HEAD
- EXISTING HANDHOLE
- EXISTING SERVICE INSTALLATION POLE
- EXISTING PEDESTRIAN SIGNAL HEAD
- EXISTING CONDUIT
- PROPOSED CONTROLLER AND CABINET
- PROPOSED SIGNAL HEAD (RELOCATED) AND POST
- PROPOSED MAST ARM ASSEMBLY, SIGNAL HEAD (RELOCATED), BACKPLATE
- PROPOSED HANDHOLE
- PROPOSED DOUBLE HANDHOLE
- PROPOSED GULFBOX JUNCTION
- PROPOSED PEDESTRIAN SIGNAL HEAD (RELOCATED)
- PROPOSED PEDESTRIAN PUSHBUTTON
- PROPOSED SERVICE INSTALLATION
- PROPOSED MAST ARM DAMPENING DEVICE

NOTE: ALL EXISTING SIGNAL HEADS SHALL BE RELOCATED TO PROPOSED LOCATIONS. (SEE SPECIAL PROVISIONS)

FILE NAME =	USER NAME = collierbw	DESIGNED - RDB	REVISED -
cs:\projects\4506207 (v6)\locust.street.dgn		DRAWN - RDB	REVISED -
		CHECKED -	REVISED -
		DATE -	REVISED -

**STATE OF ILLINOIS
DEPARTMENT OF TRANSPORTATION**

SCALE:	SHEET NO. OF SHEETS	STA. TO STA.
--------	---------------------	--------------

F.A.P. RTE.	SECTION	COUNTY	TOTAL SHEETS	SHEET NO.
730	(61,62)TS	MCLEAN	13	6
CONTRACT NO. 70682				
FED. ROAD DIST. NO. ILLINOIS FED. AID PROJECT				