

STATE OF ILLINOIS
 DEPARTMENT OF TRANSPORTATION
 DIVISION OF HIGHWAYS

**PROPOSED
 HIGHWAY PLANS**

F.A.P. ROUTE 730 (BR U.S. 51)
 SECTION (61,62)TS
 MCLEAN COUNTY
 C-95-062-07
TRAFFIC SIGNAL MODERNIZATION

F.A.P. RTE.	SECTION	COUNTY	TOTAL SHEETS	SHEET NO.
730	(61,62)TS	MCLEAN	13	1
FED. ROAD DIST. NO.	ILLINOIS	CONTRACT NO. 70682		

FOR INDEX OF SHEETS, SEE SHEET NO. 2
 FOR SUMMARY OF QUANTITIES, SEE SHEET NO. 3

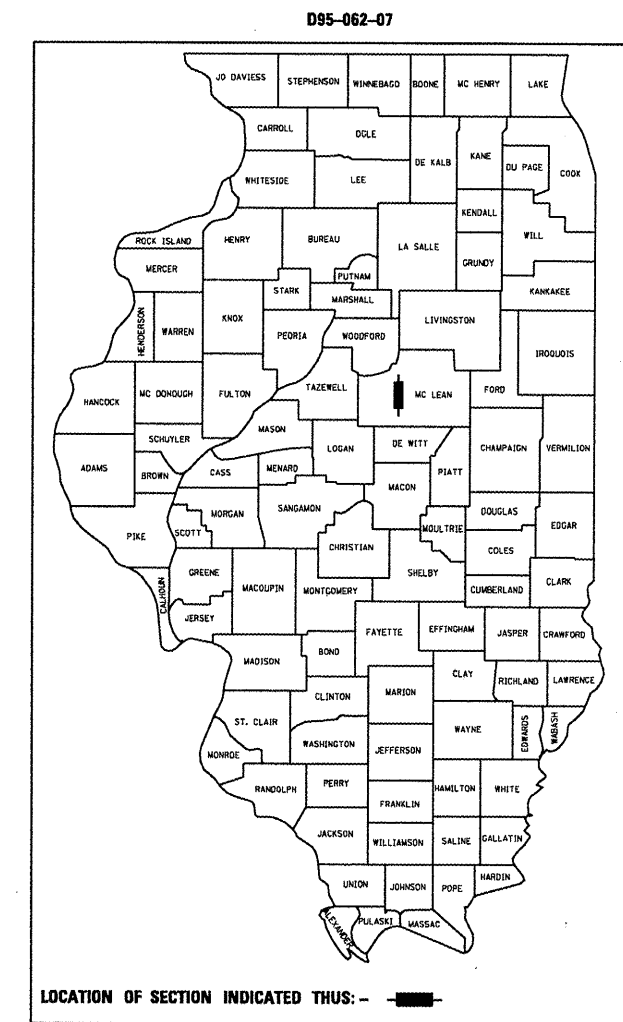

F.A.P. 730 (U.S. 51 BR) @ CENTER ST./MAIN ST.
 SECTION (61,62)TS

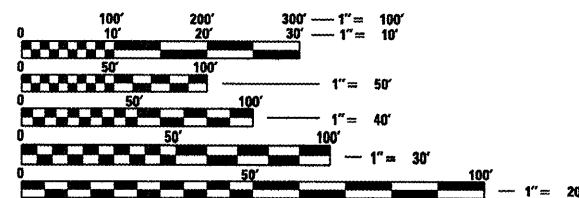

FULL SIZE PLANS HAVE BEEN PREPARED USING STANDARD ENGINEERING SCALES. REDUCED SIZED PLANS WILL NOT CONFORM TO STANDARD SCALES. IN MAKING MEASUREMENTS ON REDUCED PLANS, THE ABOVE SCALES MAY BE USED.

J.U.L.I.E.
 JOINT UTILITY LOCATION INFORMATION FOR EXCAVATION
 1-800-892-0123
 OR 811

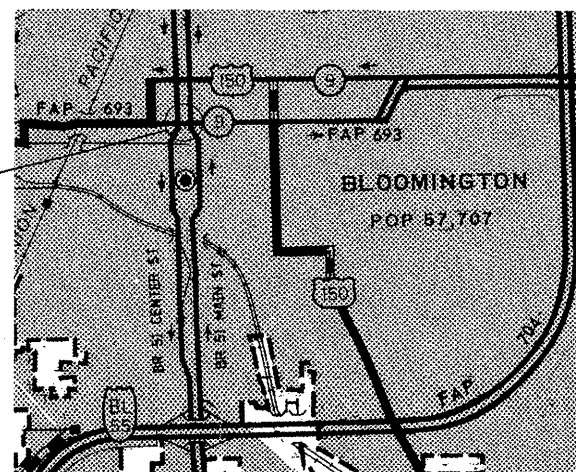

CITY OF BLOOMINGTON



STATE OF ILLINOIS
 DEPARTMENT OF TRANSPORTATION
 DIVISION OF HIGHWAYS

SUBMITTED 3/16 20 08

Joseph E. Gove
 DEPUTY DIRECTOR OF HIGHWAYS, REGION ENGINEER

May 9, 2008
Eric E. Harm (signature)
 INTERIM ENGINEER OF DESIGN AND ENVIRONMENT

May 9, 2008
Christine M. Reed (signature)
 DIRECTOR OF HIGHWAYS, CHIEF ENGINEER

**PRINTED BY THE AUTHORITY
 OF THE STATE OF ILLINOIS**

PROJECT ENGINEER: SCOTT NEIHART
 PROJECT MANAGER: ROGER BIGGS PH: 217-466-7370

CONTRACT NO. 70682

GENERAL NOTES

G.N.-100

ENGLISH UNITS OF MEASUREMENT SHALL GOVERN OVER AND SUPERSEDE ANY METRIC UNITS SHOWN IN THIS CONTRACT. WHERE INCLUDED, METRIC UNITS ARE FOR INFORMATION ONLY.

G.N.-105.07

EXISTING STATE-OWNED AND MAINTAINED UTILITY LINES ARE SHOWN ON THE PLANS TO INDICATE THEIR PRESENCE AND APPROXIMATE LOCATION. THE CONTRACTOR SHALL NOTIFY THE DISTRICT OPERATIONS ENGINEER TWO WEEKS PRIOR TO COMMENCING ANY EXCAVATION IN THE VICINITY OF THESE LINES. THE STATE WILL THEN LOCATE AND MARK THE HORIZONTAL LOCATIONS OF THE LINES AND PROVIDE ANY AVAILABLE INFORMATION AS TO THEIR DEPTH. SHOULD ANY OF THE LINES BE DAMAGED BY THE CONTRACTOR'S OPERATION, THE CONTRACTOR SHALL REPAIR THEM TO THE SATISFACTION OF THE ENGINEER AND AT NO COST TO THE STATE.

ALSO THERE MAY BE UTILITIES PRESENT WHICH WERE INSTALLED BY THE STATE BUT ARE MAINTAINED BY OTHERS (CITY, TOWN, ETC.) THE APPROXIMATE LOCATIONS OF THESE LINES ARE ALSO SHOWN ON THE PLANS ALONG WITH THE NAME OF THE MAINTAINING AGENCY. THE CONTRACTOR SHALL COORDINATE THE LOCATING OF THESE LINES WITH THE LOCAL AGENCY PRIOR TO COMMENCING ANY EXCAVATION OR BORING IN THEIR VICINITY. SHOULD THESE LINES BE DAMAGED BY THE CONTRACTOR'S OPERATIONS, THE CONTRACTOR SHALL REPAIR THEM TO THE SATISFACTION OF, AND AT NO COST TO, THE LOCAL AGENCY AND THE STATE.

G.N.-107.31

UTILITY LINES WERE PLOTTED FROM INFORMATION FURNISHED BY THE VARIOUS UTILITY COMPANIES INVOLVED (QUALITY LEVEL C &/OR QUALITY LEVEL D) AND THE ACCURACY SHOULD BE CONSIDERED APPROXIMATE ONLY.

UTILITY COMPANIES MAY BE ADJUSTING THEIR FACILITIES DURING CONSTRUCTION. THE CONTRACTOR SHALL COOPERATE WITH THESE ORGANIZATIONS WHILE THESE ADJUSTMENTS ARE BEING PERFORMED. J.U.L.I.E. - JOINT UTILITY LOCATION INFORMATION FOR EXCAVATORS SYSTEM (800)892-0123 OR 811.

G.N.-440B

THE EXISTING TIE BARS BETWEEN THE EXISTING PAVEMENT AND EXISTING MEDIANS, GUTTERS AND/OR COMBINATION CURB AND GUTTERS THAT ARE FOUND SUITABLE FOR REUSE SHALL BE CLEANED, STRAIGHTENED AND INCORPORATED INTO THE NEW CONSTRUCTION. ANY EXISTING TIE BARS THAT ARE FOUND UNSUITABLE TO BE INCORPORATED INTO THE PROPOSED CONSTRUCTION DUE TO EXCESSIVE RUSTING OR DISTRESS SHALL BE REMOVED FLUSH WITH THE FACE OF THE EXISTING CONCRETE AND DISPOSED OF OUTSIDE THE LIMITS OF THE RIGHT-OF-WAY IN ACCORDANCE WITH ARTICLE 202.03 OF THE STANDARD SPECIFICATIONS.

THIS WORK WILL NOT BE PAID FOR SEPARATELY BUT SHALL BE CONSIDERED INCLUDED IN THE VARIOUS REMOVAL PAY ITEMS AND NO ADDITIONAL COMPENSATION WILL BE ALLOWED.

G.N.-1004.01

COARSE AGGREGATE GRADATION CA-10 MAY BE USED WHENEVER COARSE AGGREGATE CA-6 IS SPECIFIED IN THE STANDARD SPECIFICATIONS.

STANDARDS IN THE PLANS

STANDARD	DESCRIPTION
000001-05	STANDARD SYMBOLS, ABBREVIATIONS AND PATTERNS
001001-01	AREAS OF REINFORCEMENT BARS
001006	DECIMAL OF AN INCH AND OF A FOOT
701701-05	URBAN CLOSURE MULTILANE INTERSECTION
701801-03	LANE CLOSURE MULTILANE, CROSSWALK OR SW
701901	TRAFFIC CONTROL DEVICES
720016-01	MAST ARM MOUNTED STREET NAME SIGNS
814001-01	HANDHOLES
814006-01	DOUBLE HANDHOLES
857001	STANDARD PHASE DESIGNATION DIAGRAMS AND PHASE SEQUENCE
873001-01	TRAFFIC SIGNAL GROUNDING AND BONDING
877001-02	STEEL MAST ARM ASSEMBLY AND POLE
878001-06	CONCRETE FOUNDATION DETAILS
880006	TRAFFIC SIGNAL MOUNTING DETAILS - POST AND BRACKET MOUNT

INDEX OF SHEETS

1	COVER SHEET
2	GENERAL NOTES, STANDARDS IN THE PLANS, INDEX
3 - 4	SUMMARY OF QUANTITIES
5	SCHEDULE OF QUANTITIES - CENTER & LOCUST
6 - 8	TRAFFIC SIGNAL PLANS - CENTER & LOCUST
9	SCHEDULE OF QUANTITIES - MAIN & LOCUST
10 - 12	TRAFFIC SIGNAL PLANS - MAIN & LOCUST
13	TRAFFIC SIGNAL DETAILS

FILE NAME : c:\projects\0506207 (v8)\locust.street.dgn	USER NAME = collierbv	DESIGNED - RDB	REVISED -	STATE OF ILLINOIS DEPARTMENT OF TRANSPORTATION	F.A.P. RTE. 730	SECTION (61,62)TS	COUNTY MCLEAN	TOTAL SHEETS 13	SHEET NO. 2	CONTRACT NO. 70682		
PLOT SCALE = 48,0000' / IN.	DRAWN - RDB	CHECKED -	REVISED -		SCALE:	SHEET NO.	OF	SHEETS	STA.		TO STA.	
PLOT DATE = 3/20/2008	DATE -	REVISED -	REVISED -		FED. ROAD DIST. NO.	ILLINOIS	FED. AID PROJECT					

70682

SUMMARY OF QUANTITIES

CODE NO	ITEM	CONSTRUCTION TYPE CODE:	UNIT	TOTAL QUANTITY	LOCATION OF WORK:	
					URBAN FAP 730 U.S. 51 BR (CENTER ST.) & LOCUST ST. 100% STATE	URBAN FAP 730 U.S. 51 BR (MAIN ST.) & LOCUST ST. 100% STATE
					Y031-1F	Y031-1F
					QUANTITY	QUANTITY
42400200	PORTLAND CEMENT CONCRETE SIDEWALK 5 INCH		SQ FT	114.0	63.0	51.0
44000600	SIDEWALK REMOVAL		SQ FT	162.0	92.0	70.0
44002020	CONCRETE MEDIAN SURFACE REMOVAL		SQ FT	34.0	34.0	
44002805	ISLAND REMOVAL		SQ FT	60.0		60.0
60618300	CONCRETE MEDIAN SURFACE, 4 INCH		SQ FT	38.0	38.0	
67100100	MOBILIZATION		L SUM	1.0	.5	.5
70102635	TRAFFIC CONTROL AND PROTECTION, STANDARD 701701		L SUM	1.0	.5	.5
70102640	TRAFFIC CONTROL AND PROTECTION, STANDARD 701801		L SUM	1.0	.5	.5
80500105	SERVICE INSTALLATION, TYPE A (MODIFIED)		EACH	2.0	1.0	1.0
81012600	CONDUIT IN TRENCH, 2" DIA., PVC		FOOT	54.0	22.0	32.0
81012700	CONDUIT IN TRENCH, 2 1/2" DIA., PVC		FOOT	38.0	32.0	6.0
81013100	CONDUIT IN TRENCH, 5" DIA., PVC		FOOT	15.0	8.0	7.0
81021550	CONDUIT, AUGERED 2" DIA., PVC		FOOT	140.0	86.0	54.0
81021560	CONDUIT, AUGERED 2 1/2" DIA., PVC		FOOT	36.0	36.0	
81021570	CONDUIT, AUGERED 3" DIA., PVC		FOOT	373.0	130.0	243.0
81021590	CONDUIT, AUGERED 4" DIA., PVC		FOOT	45.0	45.0	
81030100	CONDUIT SPLICE		EACH	2.0	1.0	1.0
81400100	HANDHOLE		EACH	9.0	5.0	4.0
81400300	DOUBLE HANDHOLE		EACH	2.0	1.0	1.0
81900200	TRENCH AND BACKFILL FOR ELECTRICAL WORK		FOOT	92.0	62.0	30.0
85700200	FULL-ACTUATED CONTROLLER AND TYPE IV CABINET		EACH	2.0	1.0	1.0
85900100	TRANSCEIVER		EACH	2.0	1.0	1.0
87301235	ELECTRIC CABLE IN CONDUIT, SIGNALNO. 14 4C		FOOT	885.0	370.0	515.0
87301245	ELECTRIC CABLE IN CONDUIT, SIGNALNO. 14 5C		FOOT	1,670.0	710.0	960.0
87301255	ELECTRIC CABLE IN CONDUIT, SIGNALNO. 14 7C		FOOT	860.0	402.0	458.0

FILE NAME =	USER NAME = collierbw	DESIGNED - RDB	REVISED -	STATE OF ILLINOIS DEPARTMENT OF TRANSPORTATION	SCALE:		SHEET NO.	OF	SHEETS	STA.	TO STA.	F.A.P. RTE.	SECTION	COUNTY	TOTAL SHEETS	SHEET NO.
ci:\projects\0506207 (v0)\locust.street.dgn		DRAWN - RDB	REVISED -		730	(61,62)TS	MCLEAN	13	3				CONTRACT NO. 70682			
PLOT SCALE = 40,0000' / IN.		CHECKED -	REVISED -		FED. ROAD DIST. NO.			ILLINOIS FED. AID PROJECT								
PLOT DATE = 3/20/2008		DATE -	REVISED -													

SUMMARY OF QUANTITIES (cont.)

			TOTAL	URBAN Y031-1F	URBAN Y031-1F
87301705	ELECTRIC CABLE IN CONDUIT, COMMUNICATION NO. 18 3 PAIR	FOOT	1,736.0	371.0	1,365.0
87502440	TRAFFIC SIGNAL POST, GALVANIZED STEEL 10 FT.	EACH	7.0	4.0	3.0
87502460	TRAFFIC SIGNAL POST, GALVANIZED STEEL 12 FT.	EACH	1.0	1.0	
87700220	STEEL MAST ARM ASSEMBLY AND POLE, 36 FT.	EACH	2.0	2.0	
87700230	STEEL MAST ARM ASSEMBLY AND POLE, 38 FT.	EACH	1.0		1.0
87700250	STEEL MAST ARM ASSEMBLY AND POLE, 42 FT.	EACH	1.0	1.0	
87700260	STEEL MAST ARM ASSEMBLY AND POLE, 44 FT.	EACH	1.0		1.0
87800100	CONCRETE FOUNDATION, TYPE A	FOOT	24.8	15.5	9.3
87800200	CONCRETE FOUNDATION, TYPE D	FOOT	7.0	3.5	3.5
87800400	CONCRETE FOUNDATION, TYPE E 30-INCH DIAMETER	FOOT	13.5	13.5	
87800415	CONCRETE FOUNDATION, TYPE E 36-INCH DIAMETER	FOOT	37.0	13.0	24.0
88040070	SIGNAL HEAD, POLYCARBONATE, LED, 1-FACE, 3-SECTION, BRACKET MOUNTED	EACH	2.0	1.0	1.0
88040090	SIGNAL HEAD, POLYCARBONATE, LED, 1-FACE, 3-SECTION, MAST ARM MOUNTED	EACH	7.0	1.0	6.0
88102810	PEDESTRIAN SIGNAL HEAD, POLYCARBONATE, LED, 1-FACE, BRACKET MOUNTED	EACH	1.0		1.0
88102830	PEDESTRIAN SIGNAL HEAD, POLYCARBONATE, LED, 2-FACE, BRACKET MOUNTED	EACH	3.0		3.0
88102850	PEDESTRIAN SIGNAL HEAD, POLYCARBONATE, LED, 3-FACE, BRACKET MOUNTED	EACH	1.0		1.0
88200110	TRAFFIC SIGNAL BACKPLATE, LOUVERED	EACH	6.0		6.0
89500100	RELOCATE EXISTING SIGNAL HEAD	EACH	5.0	5.0	
89500200	RELOCATE EXISTING PEDESTRIAN SIGNAL HEAD	EACH	10.0	10.0	
89502300	REMOVE ELECTRIC CABLE FROM CONDUIT	FOOT	2,380.0	353.0	2,027.0
89502350	REMOVE AND REINSTALL ELECTRIC CABLE FROM CONDUIT	FOOT	179.0	124.0	55.0
89502375	REMOVE EXISTING TRAFFIC SIGNAL EQUIPMENT	EACH	2.0	1.0	1.0
89502380	REMOVE EXISTING HANDHOLE	EACH	6.0	3.0	3.0
89502385	REMOVE EXISTING CONCRETE FOUNDATION	EACH	11.0	6.0	5.0
X0703200	CONCRETE ISLAND (SPECIAL)	SQ FT	56.0		56.0
X8730027	ELECTRIC CABLE IN CONDUIT, GROUNDING, NO. 6 1C	FOOT	801.0	414.0	387.0

FILE NAME =	USER NAME = collierbw	DESIGNED - RDB	REVISED -	STATE OF ILLINOIS DEPARTMENT OF TRANSPORTATION	F.A.P. RTE.	SECTION	COUNTY	TOTAL SHEETS	SHEET NO.
c:\projects\0506207 (w8)\locust_street.dgn	DRAWN - RDB	REVISED -			730	(61,62)TS	MCLEAN	13	4
PLOT SCALE = 40.0000' / IN.	CHECKED -	REVISED -			CONTRACT NO. 70682				
PLOT DATE = 3/20/2008	DATE -	REVISED -			SCALE:	SHEET NO.	OF	SHEETS	STA.
					FED. ROAD DIST. NO. ILLINOIS FED. AID PROJECT				

SCHEDULE OF QUANTITIES - CENTER ST. & LOCUST ST.

CONCRETE FOUNDATION TY A

LOCATION	FOOT
Sta. 39+46.2; 47.8' Rt.	3.1
Sta. 39+66.0; 24.6' Lt.	3.1
Sta. 39+77.3; 27.8' Rt.	3.1
Sta. 40+34.0; 26.8' Rt.	3.1
Sta. 40+33.6; 28.8' Lt.	3.1
Total =	15.5 FOOT

CONCRETE FOUNDATION TY E 30"

LOCATION	FOOT
Sta. 40+23.7; 54.8' Rt.	13.5

CONCRETE FOUNDATION TY E 36"

LOCATION	FOOT
Sta. 40+48.1; 28.1' Lt.	13.0

HANDHOLES

LOCATION	EACH
Sta. 39+63.4; 21.5' Lt.	1
Sta. 39+74.8; 26.0' Lt.	1
Sta. 40+23.9; 25.7' Rt.	1
Sta. 40+38.7; 21.6' Rt.	1
Sta. 40+31.0; 30.6' Rt.	1
Total =	5 EACH

TRAFFIC SIGNAL POST GALVS. 10

LOCATION	EACH
Sta. 39+66.0; 24.6' Lt.	1
Sta. 39+77.3; 27.8' Lt.	1
Sta. 40+34.0; 26.8' Rt.	1
Sta. 40+33.6; 28.8' Lt.	1
Total =	4 EACH

TRAFFIC SIGNAL POST GALVS. 12

LOCATION	EACH
Sta. 39+46.2; 47.8' Rt.	1

DOUBLE HANDHOLE

LOCATION	EACH
Sta. 40+53.9; 28.8' Lt.	1

SIDEWALK REMOVAL

LOCATION	SQ. FT.
SW QUAD	8
NE QUAD	82
Total =	92

CONCRETE MEDIAN SURFACE REMOVAL

LOCATION	SQ. FT.
SW CORNER ISLAND	34

PCC CONG. SIDEWALK 5

LOCATION	SQ. FT.
NE QUAD	56
SW QUAD	7
Total =	63 SQ. FT.

CONCRETE MEDIAN SURFACE 4

LOCATION	SQ. FT.
SW CORNER ISLAND	38

REMOVE EXIST HANDHOLE

LOCATION	EACH
Sta. 39+73.4; 23.9' Rt.	1
Sta. 39+74.1; 24.9' Rt.	1
Sta. 40+25.9; 27.6' rt.	1
Total =	3 EACH

REMOVE EXIST CONC FDN

LOCATION	EACH
Sta. 39+48.4; 45.9' Lt.	1
Sta. 39+66.8; 19.6' Rt.	1
Sta. 39+77.3; 27.2' Rt.	1
Sta. 40+26.5; 35.1' Lt.	1
Sta. 40+36.1; 21.3' Lt.	1
Sta. 40+36.6; 26.7' Lt.	1
Total =	6 EACH

FILE NAME =	USER NAME = collierbw	DESIGNED - RDB	REVISED -
c:\projects\0506207 (01)\locust_street.dgn		DRAWN - RDB	REVISED -
	PLOT SCALE = 40,0000 ' / IN.	CHECKED -	REVISED -
	PLOT DATE = 3/20/2008	DATE -	REVISED -

**STATE OF ILLINOIS
DEPARTMENT OF TRANSPORTATION**

SCALE:	SHEET NO. OF SHEETS	STA. TO STA.	F.A.P. RTE. 730	SECTION (61,62)TS	COUNTY MCLEAN	TOTAL SHEETS 13	SHEET NO. 5
			CONTRACT NO. 70682				
			FED. ROAD DIST. NO. ILLINOIS FED. AID PROJECT				

TRAFFIC SIGNAL MODERNIZATION

F.A.P. 730 U.S. 51 (CENTER ST.)

&
LOCUST STREET

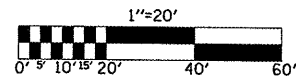

SIGNAL LAYOUT

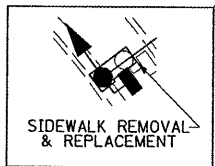
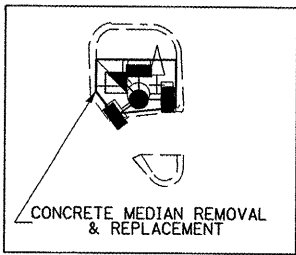

Connect and reutilize Exist.
Interconnect Conduit to the North

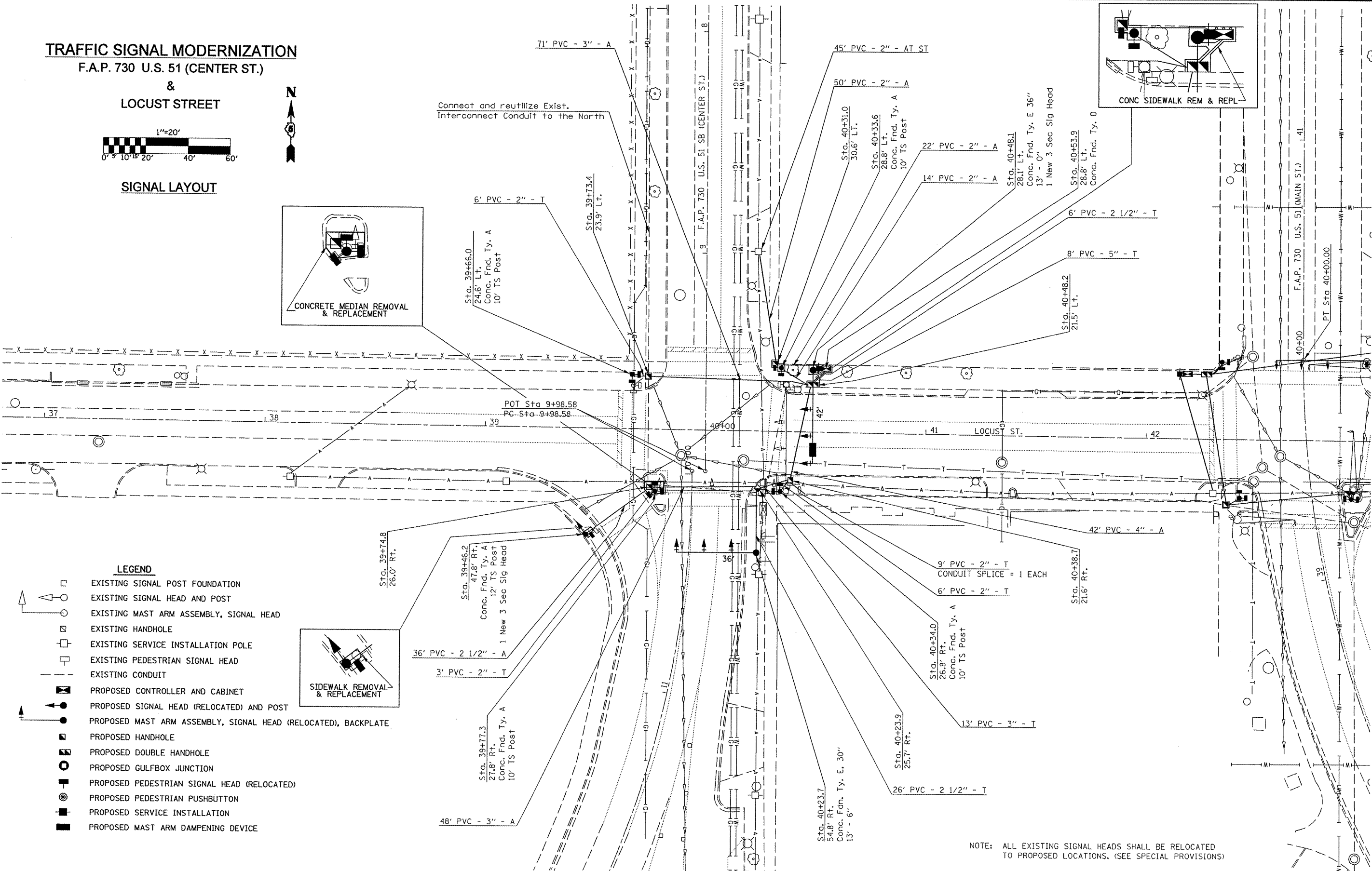
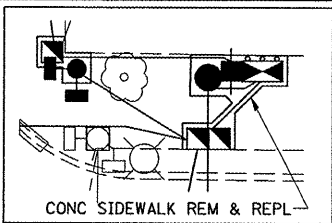

LEGEND

- EXISTING SIGNAL POST FOUNDATION
- EXISTING SIGNAL HEAD AND POST
- EXISTING MAST ARM ASSEMBLY, SIGNAL HEAD
- EXISTING HANDHOLE
- EXISTING SERVICE INSTALLATION POLE
- EXISTING PEDESTRIAN SIGNAL HEAD
- EXISTING CONDUIT
- PROPOSED CONTROLLER AND CABINET
- PROPOSED SIGNAL HEAD (RELOCATED) AND POST
- PROPOSED MAST ARM ASSEMBLY, SIGNAL HEAD (RELOCATED), BACKPLATE
- PROPOSED HANDHOLE
- PROPOSED DOUBLE HANDHOLE
- PROPOSED GULFBOX JUNCTION
- PROPOSED PEDESTRIAN SIGNAL HEAD (RELOCATED)
- PROPOSED PEDESTRIAN PUSHBUTTON
- PROPOSED SERVICE INSTALLATION
- PROPOSED MAST ARM DAMPENING DEVICE

NOTE: ALL EXISTING SIGNAL HEADS SHALL BE RELOCATED TO PROPOSED LOCATIONS. (SEE SPECIAL PROVISIONS)

FILE NAME =	USER NAME = collierbw	DESIGNED - RDB	REVISED -
cs:\projects\4506207 (v6)\locust.street.dwg		DRAWN - RDB	REVISED -
		CHECKED -	REVISED -
		DATE -	REVISED -

STATE OF ILLINOIS
DEPARTMENT OF TRANSPORTATION

SCALE:	SHEET NO. OF SHEETS	STA. TO STA.

F.A.P. RTE.	SECTION	COUNTY	TOTAL SHEETS	SHEET NO.
730	(61,62)TS	MCLEAN	13	6
CONTRACT NO. 70682				
FED. ROAD DIST. NO. ILLINOIS FED. AID PROJECT				

TRAFFIC SIGNAL MODERNIZATION
F.A.P. 730 U.S. 51 (CENTER ST.)
&
LOCUST STREET

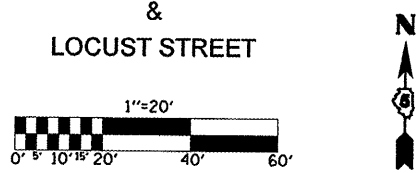

CABLE LAYOUT

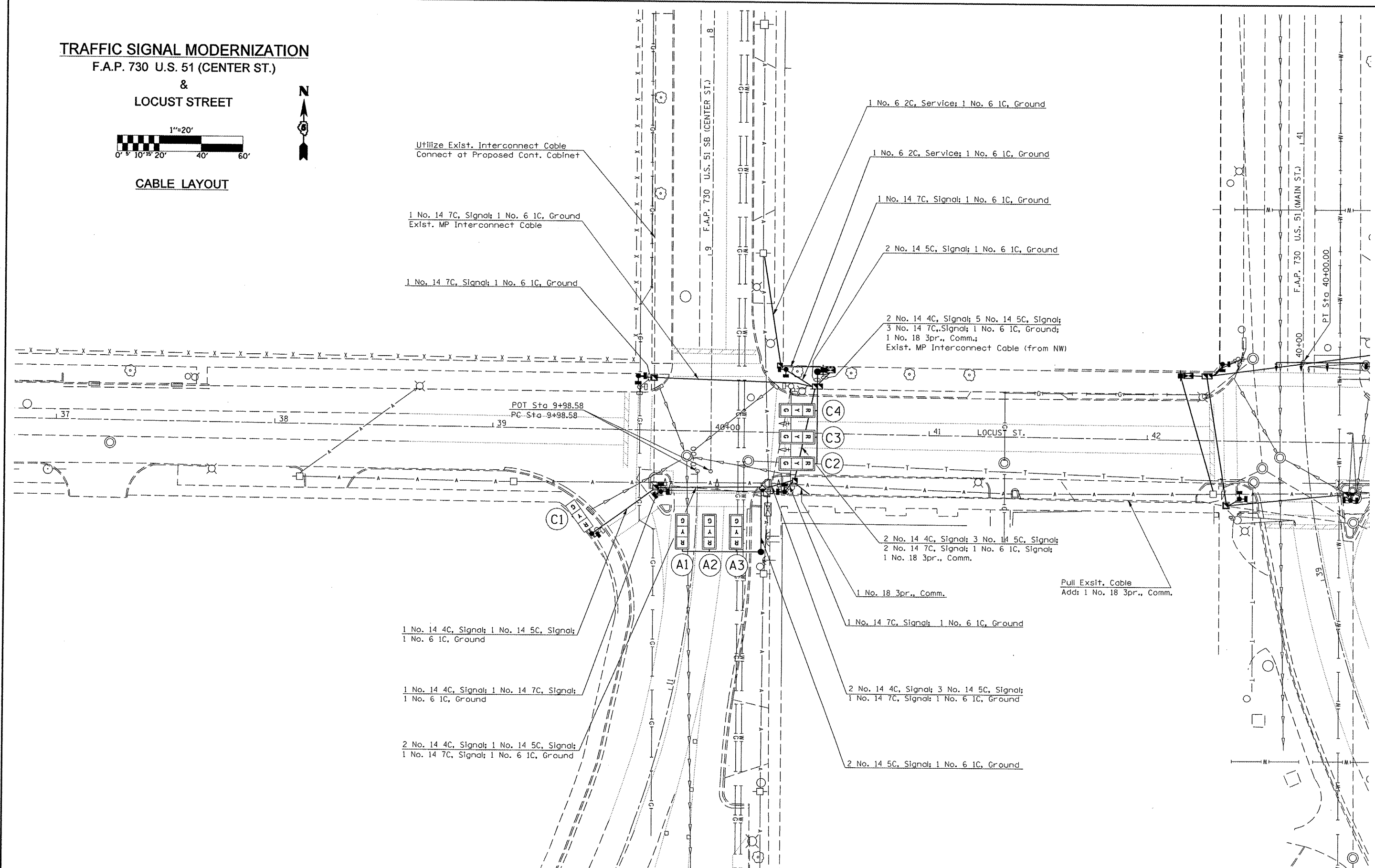

FILE NAME = c:\projects\4506207 (v8)\locust.street.dwg	USER NAME = collier-bw	DESIGNED - RDB	REVISED -
		DRAWN - RDB	REVISED -
	PLOT SCALE = 40.0000 / IN.	CHECKED -	REVISED -
	PLOT DATE = 3/14/2008	DATE -	REVISED -

STATE OF ILLINOIS
DEPARTMENT OF TRANSPORTATION

SCALE:	SHEET NO.	OF	SHEETS	STA.	TO STA.
--------	-----------	----	--------	------	---------

F.A.P. RTE. 730	SECTION 61,621TS	COUNTY MCLEAN	TOTAL SHEETS 13	SHEET NO. 7
CONTRACT NO. 70682				
FED. ROAD DIST. NO. ILLINOIS FED. AID PROJECT				

PHASE DESIGNATION DIAGRAM

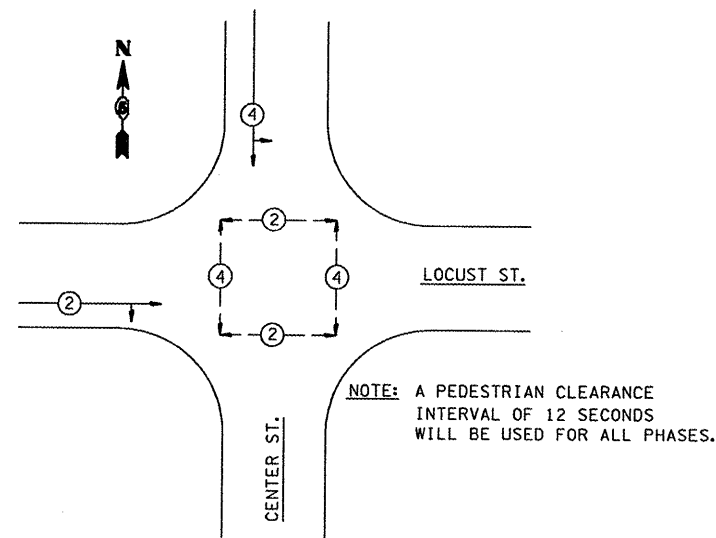

**ITEMS TO BE RETURNED TO THE CITY OF BLOOMINGTON
U.S. 51 BR (CENTER) & LOCUST ST.**

ITEM	QUANTITY
CONTROLLER CABINET & PERIPHERAL EQUIPMENT	1
CONTROLLER	1
TRAFFIC SIGNAL POSTS & BASES	3

GENERAL NOTES

1. THE FINAL LOCATIONS OF ALL TRAFFIC CONTROL ITEMS SHALL BE VERIFIED BY THE ENGINEER IN THE FIELD.
2. ALL TRAFFIC SIGNAL MAST ARMS MUST BE DESIGNED FOR THE LOADINGS SHOWN ON THE HIGHWAY STANDARDS OR THESE SIGNAL PLANS, WHICHEVER IS GREATER.
3. SIGNAL FACES FOR THE NORTH APPROACH ARE NOTED AS "A","B" FOR THE SOUTH APPROACH,"C" FOR THE WEST APPROACH, AND "D" FOR THE EAST APPROACH.
4. ITEMS REMOVED WILL BECOME THE PROPERTY OF THE CONTRACTOR UNLESS OTHERWISE NOTED ON THE PLANS. NOTED ITEMS TO BE RETURNED TO THE DEPARTMENT OF TRANSPORTATION SHALL BE STORED ON THE JOBSITE AS DIRECTED BY THE ENGINEER.
5. THE CONTRACTOR SHALL BE RESPONSIBLE FOR OBTAINING ELECTRICAL SERVICE FOR THE TRAFFIC SIGNALS. THE CONTRACTOR SHALL CONTACT THE UTILITY COMPANY PRIOR TO COMMENCEMENT OF WORK TO OBTAIN UTILITY COMPANY REQUIREMENTS FOR THE SERVICE INSTALLATION

BILL OF MATERIALS

U.S. 51 BR (CENTER ST.) & LOCUST ST.

ITEM	UNIT	QUANTITY
SERVICE INSTALLATION, TYPE A (MODIFIED)	EACH	1
CONDUIT IN TRENCH, 2" DIA., PVC	FOOT	22
CONDUIT IN TRENCH, 2 1/2" DIA., PVC	FOOT	32
CONDUIT IN TRENCH, 5" DIA., PVC	FOOT	8
CONDUIT, AUGERED 2" DIA., PVC	FOOT	86
CONDUIT, AUGERED 2 1/2" DIA., PVC	FOOT	36
CONDUIT, AUGERED 3" DIA., PVC	FOOT	130
CONDUIT, AUGERED 4" DIA., PVC	FOOT	45
CONDUIT SPLICE	EACH	1
HANDHOLE	EACH	5
DOUBLE HANDHOLE	EACH	1
TRENCH AND BACKFILL FOR ELECTRICAL WORK	FOOT	62
FULL-ACTUATED CONTROLLER AND TYPE IV CABINET	EACH	1
TRANSCEIVER	EACH	1
ELECTRIC CABLE IN CONDUIT, SIGNAL, NO. 14 4C	FOOT	370
ELECTRIC CABLE IN CONDUIT, SIGNAL, NO. 14 5C	FOOT	710
ELECTRIC CABLE IN CONDUIT, SIGNAL, NO. 14 7C	FOOT	402
ELECTRIC CABLE IN CONDUIT, COMMUNICATION 18 3 PAIR	FOOT	371
TRAFFIC SIGNAL POST, GALVANIZED STEEL 10 FT.	EACH	4
TRAFFIC SIGNAL POST, GALVANIZED STEEL 12 FT.	EACH	1
STEEL MAST ARM ASSEMBLY AND POLE, 36 FT.	EACH	2
STEEL MAST ARM ASSEMBLY AND POLE, 42 FT.	EACH	1
CONCRETE FOUNDATION, TYPE A	FOOT	15.5
CONCRETE FOUNDATION, TYPE D	FOOT	3.5
CONCRETE FOUNDATION, TYPE E 30-INCH DIAMETER	FOOT	13.5
CONCRETE FOUNDATION, TYPE E 36-INCH DIAMETER	FOOT	13
SIGNAL HEAD, POLYCARBONATE, LED, 1-FACE, 3-SECTION, BRACKET MOUNTED	EACH	1
SIGNAL HEAD, POLYCARBONATE, LED, 1-FACE, 3-SECTION, MAST ARM MOUNTED	EACH	1
RELOCATE EXISTING SIGNAL HEAD	EACH	5
RELOCATE EXISTING PEDESTRIAN SIGNAL HEAD	EACH	10
REMOVE ELECTRIC CABLE FROM CONDUIT	FOOT	353
REMOVE AND REINSTALL ELECTRIC CABLE FROM CONDUIT	FOOT	124
REMOVE EXISTING TRAFFIC SIGNAL EQUIPMENT	EACH	1
REMOVE EXISTING HANDHOLE	EACH	3
REMOVE EXISTING CONCRETE FOUNDATION	EACH	6
ELECTRIC CABLE IN CONDUIT, GROUNDING, NO. 6 1C	FOOT	414

TRAFFIC SIGNAL PLAN NOTES

1. THE FOLLOWING SIGNAL HEADS SHALL BE WIRED IN PARALLEL AT THE MAST POLE HANDHOLE:
(A2, A3), (C3, C4) - EACH MAST ARM MOUNTED SIGNAL HEAD SHALL HAVE ITS OWN INDIVIDUAL CABLE FROM THE MAST POLE HANDHOLE TO THE SIGNAL HEAD.
2. THE ACTUAL LOCATION OF ALL SIGNAL FOUNDATIONS, HANDHOLES, AND TRAFFIC CONTROLLER WILL BE DETERMINED IN THE FIELD BY THE ENGINEER.
3. POST MOUNTED SIGNALS SHALL BE INSTALLED SO THAT NO PART OF THE SIGNAL HEAD IS WITHIN 2 FT. OF THE FACE OF CURB.
4. ALL MAST ARM POLES SHALL BE A MINIMUM OF 6 FT. FROM THE CENTER OF THE POLE TO THE FACE OF CURB (ON THE MAST ARM SIDE) OR AS SHOWN ON THE PLANS.
5. ALIGN ADJACENT RED INDICATIONS TO SAME HEIGHT ABOVE PAVEMENT.
6. THE BASE FOR A TRAFFIC SIGNAL POST SHALL BE SITUATED SUCH THAT THE HANDHOLE IS LOCATED ON A SIDE AWAY FROM A TRAVELED LANE.

FILE NAME =	USER NAME = biggsrd	DESIGNED - RDB	REVISED -
c:\projects\10596207 (v8)\locust_street.dgn		DRAWN - RDB	REVISED -
	PLOT SCALE = 40.0000" / IN.	CHECKED -	REVISED -
	PLOT DATE = 3/26/2008	DATE -	REVISED -

**STATE OF ILLINOIS
DEPARTMENT OF TRANSPORTATION**

SCALE:	SHEET NO. OF SHEETS	STA. TO STA.	F.A.P. RTE. 730	SECTION 61.621TS	COUNTY MCLEAN	TOTAL SHEETS 13	SHEET NO. 8
			CONTRACT NO. 70682				
			FED. ROAD DIST. NO. ILLINOIS FED. AID PROJECT				

SCHEDULE OF QUANTITIES - MAIN ST. & LOCUST ST.

CONCRETE FOUNDATION TY A

LOCATION	FOOT
Sta. 42+33.9; 35.0' Rt.	3.1
Sta. 42+42.5; 26.2' Lt.	3.1
Sta. 42+93.4; 26.0' Rt.	3.1
Total =	9.3 FOOT

CONCRETE FOUNDATION TY E .36"

LOCATION	FOOT
Sta. 43+02.7; 36.7' Lt.	13.0
Sta. 43+52.4; 26.6' Rt.	11.0
Total =	24.0 FOOT

HANDHOLES

LOCATION	EACH
Sta. 42+36.5; 29.3' Lt.	1
Sta. 42+91.3; 23.4' Lt.	1
Sta. 43+03.0; 40.1' Rt.	1
Sta. 43+49.4; 25.2' Rt.	1
Total =	4 EACH

TRAFFIC SIGNAL POST GALVS. 10

LOCATION	EACH
Sta. 42+33.9; 35.0' Lt.	1
Sta. 42+42.5; 26.2' Lt.	1
Sta. 42+93.4; 26.0' Rt.	1
Total =	3 EACH

DOUBLE HANDHOLE

LOCATION	EACH
Sta. 42+27.0; 29.4' Lt.	1

SIDEWALK REMOVAL

LOCATION	SQ. FT.
NW QUAD	50
NE QUAD	15
SE QUAD	5
Total =	70 SQ. FT.

ISLAND REMOVAL

LOCATION	SQ. FT.
SE CORNER ISLAND	60

PCC CONC SIDEWALK 5

LOCATION	SQ. FT.
NW QUAD	33
NE QUAD	12
SE QUAD	2
SW QUAD	4
Total =	51 SQ. FT.

CONCRETE ISLAND SPECIAL

LOCATION	SQ. FT.
SE CORNER ISLAND	56

REMOVE EXIST HANDHOLE

LOCATION	EACH
Sta. 42+36.5; 29.3' Rt.	1
Sta. 43+11.5; 20.6' Rt.	1
Sta. 43+63.2; 23.8' rt.	1
Total =	3 EACH

REMOVE EXIST CONC.FDN

LOCATION	EACH
Sta. 42+40.9; 37.3' Lt	1
Sta. 42+41.7; 35.9' Rt.	1
Sta. 42+94.3; 21.6' Rt.	1
Sta. 42+99.3; 34.7' Lt.	1
Sta. 43+11.6; 20.1' Lt.	1
Total =	5 EACH

TRAFFIC SIGNAL MODERNIZATION

F.A.P. 730 U.S. 51 (MAIN ST.)

&
LOCUST STREET

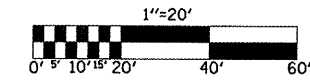

SIGNAL LAYOUT

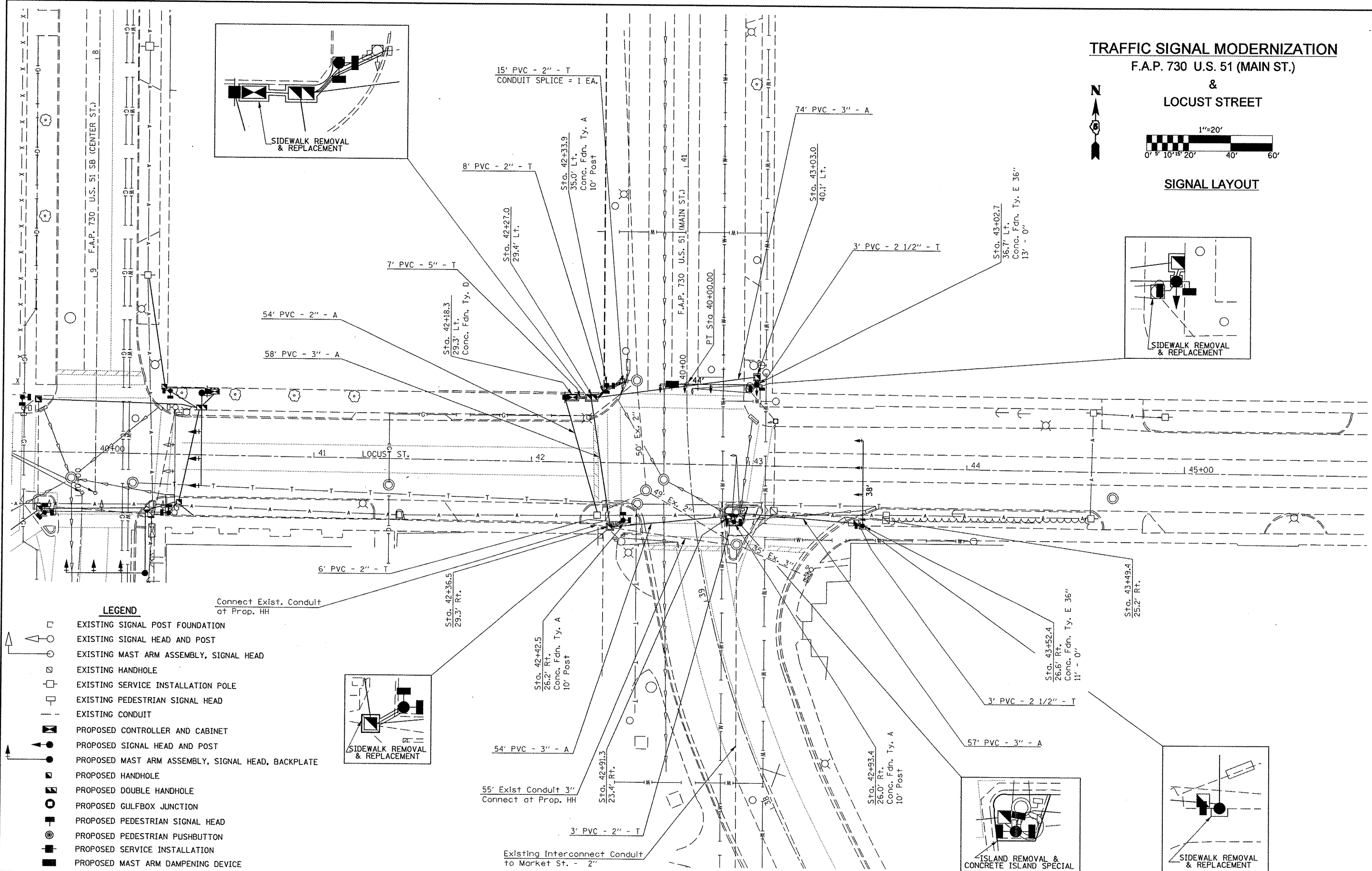
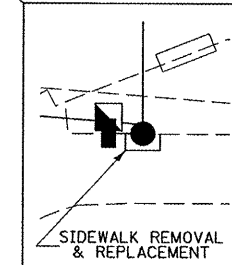
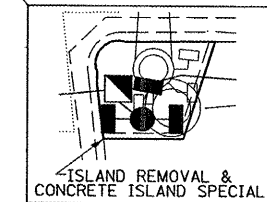
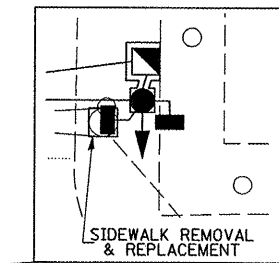

LEGEND

- EXISTING SIGNAL POST FOUNDATION
- EXISTING SIGNAL HEAD AND POST
- EXISTING MAST ARM ASSEMBLY, SIGNAL HEAD
- EXISTING HANDHOLE
- EXISTING SERVICE INSTALLATION POLE
- EXISTING PEDESTRIAN SIGNAL HEAD
- EXISTING CONDUIT
- PROPOSED CONTROLLER AND CABINET
- PROPOSED SIGNAL HEAD AND POST
- PROPOSED MAST ARM ASSEMBLY, SIGNAL HEAD, BACKPLATE
- PROPOSED HANDHOLE
- PROPOSED DOUBLE HANDHOLE
- PROPOSED GULFBOX JUNCTION
- PROPOSED PEDESTRIAN SIGNAL HEAD
- PROPOSED PEDESTRIAN PUSHBUTTON
- PROPOSED SERVICE INSTALLATION
- PROPOSED MAST ARM DAMPENING DEVICE

FILE NAME =	USER NAME = biggsrd	DESIGNED - RDB	REVISED -
c:\projects\4596207 (v8)\locust_street.dwg		DRAWN - RDB	REVISED -
		CHECKED -	REVISED -
		DATE -	REVISED -

PLOT SCALE = 40,0000 / IN.	CHECKED -	REVISED -
PLOT DATE = 3/26/2008	DATE -	REVISED -

**STATE OF ILLINOIS
DEPARTMENT OF TRANSPORTATION**

SCALE:	SHEET NO.	OF SHEETS	STA.	TO STA.

F.A.P. RTE.	SECTION	COUNTY	TOTAL SHEETS	SHEET NO.
730	(61,62)TS	MCLEAN	13	10
CONTRACT NO. 70682				
FED. ROAD DIST. NO. [ILLINOIS] FED. AID PROJECT				

TRAFFIC SIGNAL MODERNIZATION

F.A.P. 730 U.S. 51 (MAIN ST.)

&

LOCUST STREET

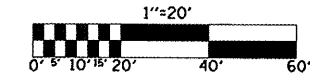

SIGNAL LAYOUT

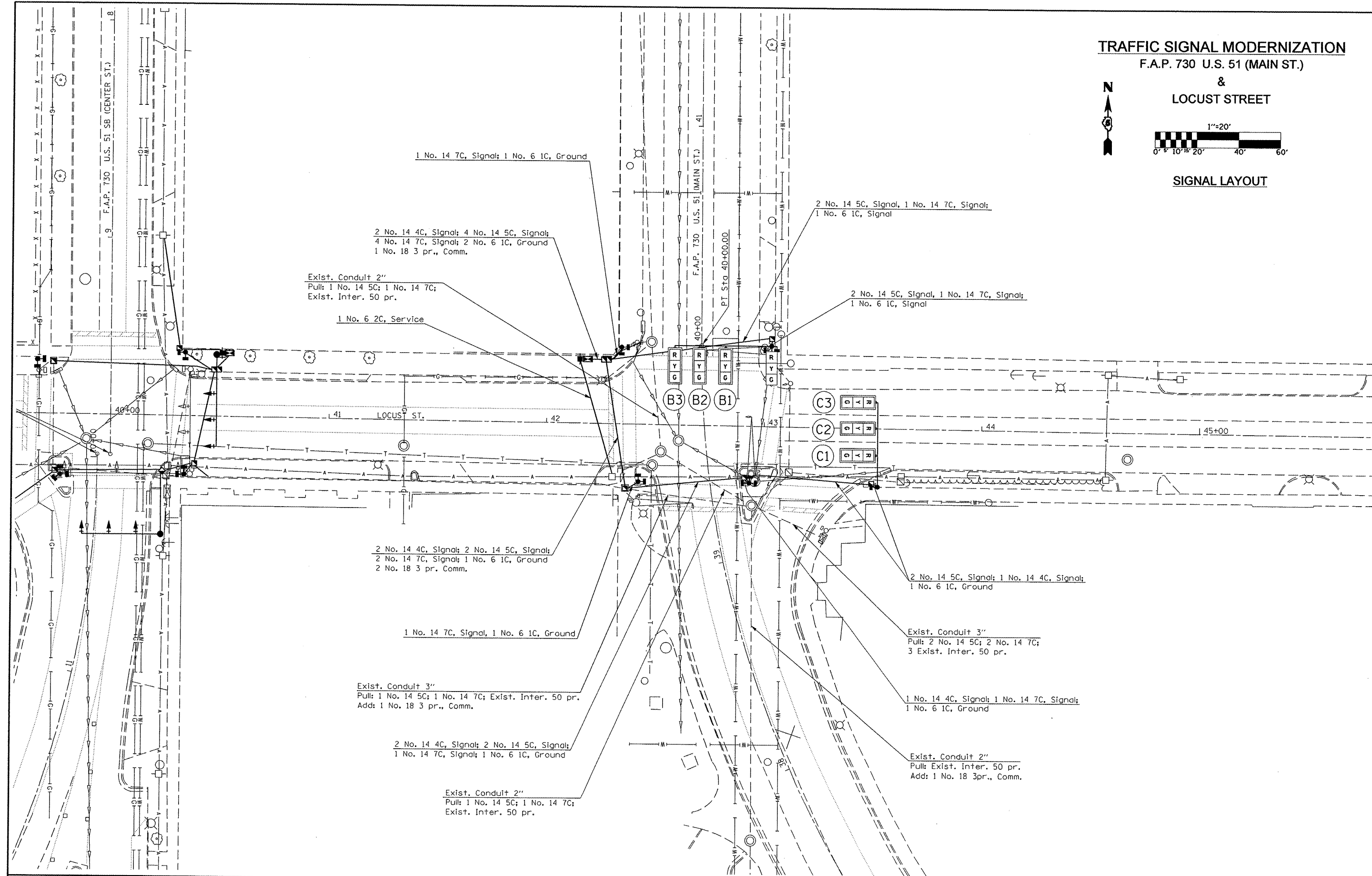

FILE NAME = c:\projects\1596207 (v8)\locust.street.dwg	USER NAME = collierbw	DESIGNED - RDB	REVISED -
		DRAWN - RDB	REVISED -
		CHECKED -	REVISED -
		DATE -	REVISED -

**STATE OF ILLINOIS
DEPARTMENT OF TRANSPORTATION**

SCALE:	SHEET NO. OF SHEETS	STA. TO STA.
--------	---------------------	--------------

F.A.P. RTE. 730	SECTION (61.621S)	COUNTY MCLEAN	TOTAL SHEETS 13	SHEET NO. 11
CONTRACT NO. 70682				
FED. ROAD DIST. NO. ILLINOIS FED. AID PROJECT				

PHASE DESIGNATION DIAGRAM

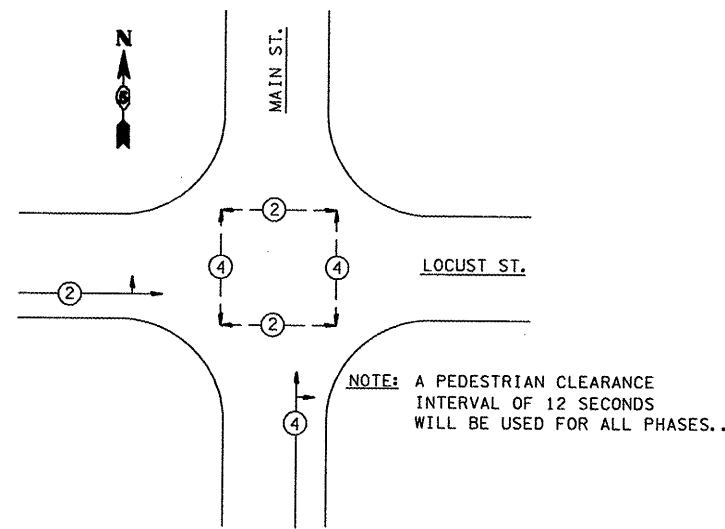

**ITEMS TO BE RETURNED TO THE CITY OF BLOOMINGTON
U.S. 51 BR (CENTER) & LOCUST ST.**

ITEM	QUANTITY
CONTROLLER CABINET & PERIPHERAL EQUIPMENT	1
CONTROLLER	1
MAST ARM ASSEMBLIES & POLES	3
TRAFFIC SIGNAL POSTS & BASES	3
TRAFFIC & PEDESTRIAN SIGNAL HEADS	16
SIGNAL HEAD BRACKETS	16

GENERAL NOTES

1. THE FINAL LOCATIONS OF ALL TRAFFIC CONTROL ITEMS SHALL BE VERIFIED BY THE ENGINEER IN THE FIELD.
2. ALL TRAFFIC SIGNAL MAST ARMS MUST BE DESIGNED FOR THE LOADINGS SHOWN ON THE HIGHWAY STANDARDS OR THESE SIGNAL PLANS, WHICHEVER IS GREATER.
3. SIGNAL FACES FOR THE NORTH APPROACH ARE NOTED AS "A", "B" FOR THE SOUTH APPROACH, "C" FOR THE WEST APPROACH, AND "D" FOR THE EAST APPROACH.
4. ITEMS REMOVED WILL BECOME THE PROPERTY OF THE CONTRACTOR UNLESS OTHERWISE NOTED ON THE PLANS. NOTED ITEMS TO BE RETURNED TO THE DEPARTMENT OF TRANSPORTATION SHALL BE STORED ON THE JOBSITE AS DIRECTED BY THE ENGINEER.
5. THE CONTRACTOR SHALL BE RESPONSIBLE FOR OBTAINING ELECTRICAL SERVICE FOR THE TRAFFIC SIGNALS. THE CONTRACTOR SHALL CONTACT THE UTILITY COMPANY PRIOR TO COMMENCEMENT OF WORK TO OBTAIN UTILITY COMPANY REQUIREMENTS FOR THE SERVICE INSTALLATION

BILL OF MATERIALS

U.S. 51 BR (MAIN ST.) & LOCUST ST.

ITEM	UNIT	QUANTITY
SERVICE INSTALLATION, TYPE A (MODIFIED)	EACH	1
CONDUIT IN TRENCH, 2" DIA., PVC	FOOT	32
CONDUIT IN TRENCH, 2 1/2" DIA., PVC	FOOT	6
CONDUIT IN TRENCH, 5" DIA., PVC	FOOT	7
CONDUIT, AUGERED 2" DIA., PVC	FOOT	54
CONDUIT, AUGERED 3" DIA., PVC	FOOT	243
CONDUIT SPLICE	EACH	1
HANDHOLE	EACH	4
DOUBLE HANDHOLE	EACH	1
TRENCH AND BACKFILL FOR ELECTRICAL WORK	FOOT	30
FULL-ACTUATED CONTROLLER AND TYPE IV CABINET	EACH	1
TRANSCIEVER	EACH	1
ELECTRIC CABLE IN CONDUIT, SIGNAL, NO. 14 4C	FOOT	515
ELECTRIC CABLE IN CONDUIT, SIGNAL, NO. 14 5C	FOOT	960
ELECTRIC CABLE IN CONDUIT, SIGNAL, NO. 14 7C	FOOT	458
ELECTRIC CABLE IN CONDUIT, COMMUNICATION, NO. 18 3 PAIR	FOOT	1365
TRAFFIC SIGNAL POST, GALVANIZED STEEL 10 FT.	EACH	3
STEEL MAST ARM ASSEMBLY AND POLE, 38 FT.	EACH	1
STEEL MAST ARM ASSEMBLY AND POLE, 44 FT.	EACH	1
CONCRETE FOUNDATION, TYPE A	FOOT	9.3
CONCRETE FOUNDATION, TYPE D	FOOT	3.5
CONCRETE FOUNDATION, TYPE E 36-INCH DIAMETER	FOOT	24
SIGNAL HEAD, POLYCARBONATE, LED, 1-FACE, 3-SECTION, BRACKET MOUNTED	EACH	1
SIGNAL HEAD, POLYCARBONATE, LED, 1-FACE, 3-SECTION, MAST ARM MOUNTED	EACH	6
PEDESTRIAN SIGNAL HEAD, POLYCARBONATE, LED, 1-FACE, BRACKET MOUNTED	EACH	1
PEDESTRIAN SIGNAL HEAD, POLYCARBONATE, LED, 2-FACE, BRACKET MOUNTED	EACH	3
PEDESTRIAN SIGNAL HEAD, POLYCARBONATE, LED, 3-FACE, BRACKET MOUNTED	EACH	1
TRAFFIC SIGNAL BACKPLATE	EACH	6
REMOVE ELECTRIC CABLE FROM CONDUIT	FOOT	2027
REMOVE AND REINSTALL ELECTRIC CABLE FROM CONDUIT	FOOT	55
REMOVE EXISTING TRAFFIC SIGNAL EQUIPMENT	EACH	1
REMOVE EXISTING HANDHOLE	EACH	3
REMOVE EXISTING CONCRETE FOUNDATION	EACH	5
CONCRETE ISLAND (SPECIAL)	SQ FT	56
ELECTRIC CABLE IN CONDUIT, GROUNDING, NO. 6 1C	FOOT	387

TRAFFIC SIGNAL PLAN NOTES

1. THE FOLLOWING SIGNAL HEADS SHALL BE WIRED IN PARALLEL AT THE MAST POLE HANDHOLE: (B1, B2), (C1, C2) - EACH MAST ARM MOUNTED SIGNAL HEAD SHALL HAVE ITS OWN INDIVIDUAL CABLE FROM THE MAST POLE HANDHOLE TO THE SIGNAL HEAD.
2. THE ACTUAL LOCATION OF ALL SIGNAL FOUNDATIONS, HANDHOLES, AND TRAFFIC CONTROLLER WILL BE DETERMINED IN THE FIELD BY THE ENGINEER.
3. POST MOUNTED SIGNALS SHALL BE INSTALLED SO THAT NO PART OF THE SIGNAL HEAD IS WITHIN 2 FT. OF THE FACE OF CURB.
4. ALL MAST ARM POLES SHALL BE A MINIMUM OF 6 FT. FROM THE CENTER OF THE POLE TO THE FACE OF CURB (ON THE MAST ARM SIDE) OR AS SHOWN ON THE PLANS.
5. ALIGN ADJACENT RED INDICATIONS TO SAME HEIGHT ABOVE PAVEMENT.
6. THE BASE FOR A TRAFFIC SIGNAL POST SHALL BE SITUATED SUCH THAT THE HANDHOLE IS LOCATED ON A SIDE AWAY FROM A TRAVELED LANE.

FILE NAME =	USER NAME = biggard	DESIGNED - RDB	REVISED -	STATE OF ILLINOIS DEPARTMENT OF TRANSPORTATION	F.A.P. RTE.	SECTION	COUNTY	TOTAL SHEETS	SHEET NO.
c:\projects\0506207 (v8)\locust_street.dgn		DRAWN - RDB	REVISED -		730	(61,62)TS	MCLEAN	13	12
PLOT SCALE = 40,0000' / IN.		CHECKED -	REVISED -		SCALE:		SHEET NO. OF SHEETS		STA. TO STA.
PLOT DATE = 3/26/2008		DATE -	REVISED -		FED. ROAD DIST. NO.		ILLINOIS FED. AID PROJECT		CONTRACT NO. 70682

MAST ARM DAMPENING DEVICE MOUNTING DETAIL

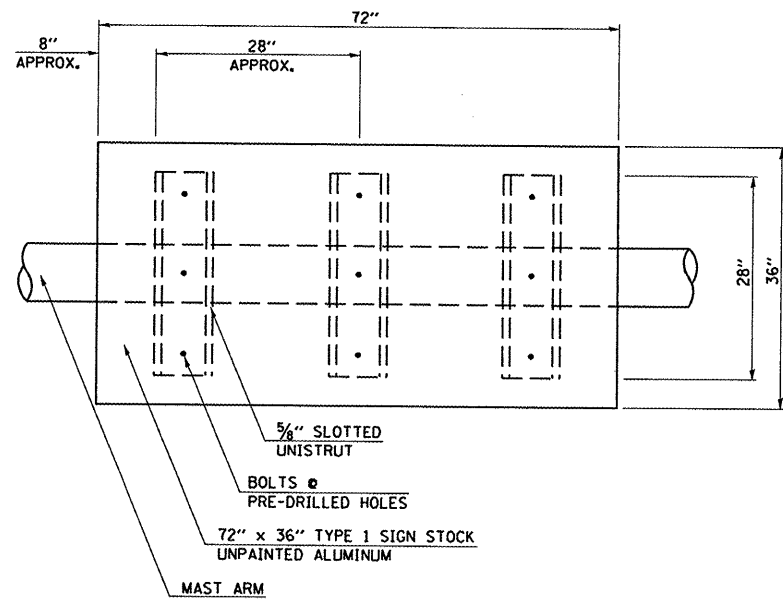

PLAN VIEW

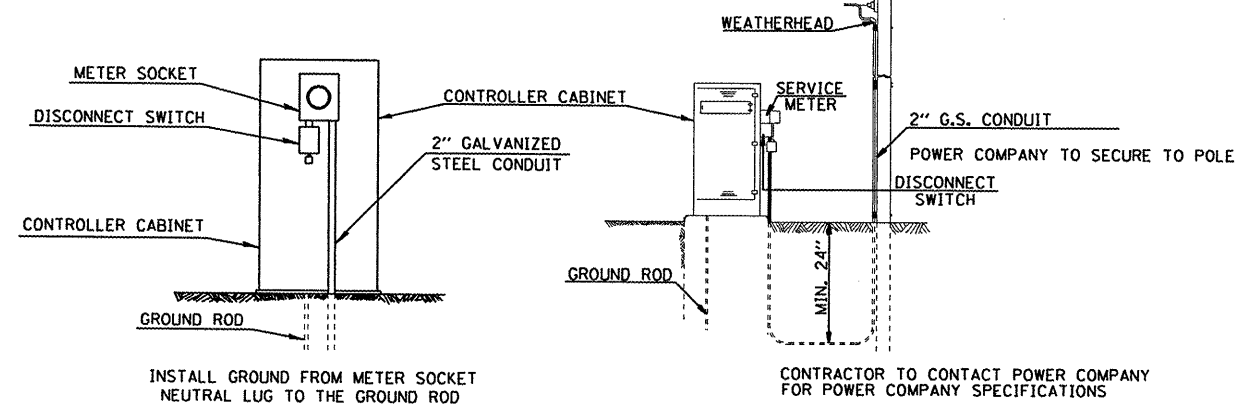

DETAIL OF SERVICE INSTALLATION, TYPE A (MODIFIED)

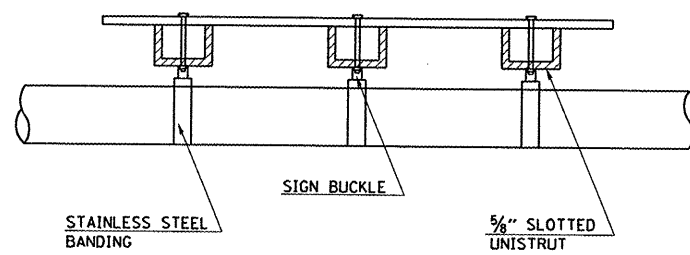

ELEVATION

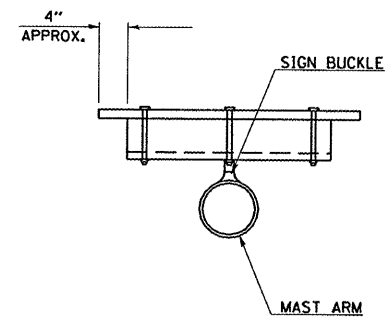

CROSS SECTION

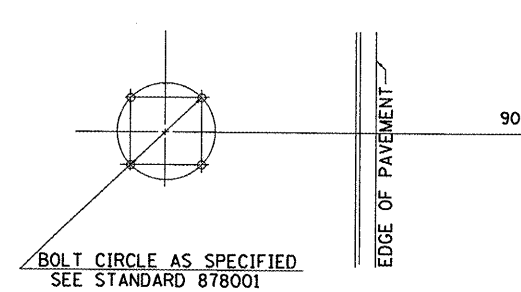

DETAIL OF MAST ARM FOUNDATION BOLT PATTERN

NOTE: PAINT ENDS OF UNISTRUT WITH SPRAY ON GALVANIZED PAINT

FILE NAME = c:\projects\4586207 (48)\locust_street.dwg
 USER NAME = collierbw
 PLOT SCALE = 40.0000' / IN.
 PLOT DATE = 3/14/2008

DESIGNED - RDB	REVISED -
DRAWN - RDB	REVISED -
CHECKED -	REVISED -
DATE -	REVISED -

**STATE OF ILLINOIS
 DEPARTMENT OF TRANSPORTATION**

SCALE: SHEET NO. OF SHEETS STA. TO STA.

F.A.P. RTE.	SECTION	COUNTY	TOTAL SHEETS	SHEET NO.
730	61.621TS	MCLEAN	13	13
FED. ROAD DIST. NO. ILLINOIS FED. AID PROJECT			CONTRACT NO. 70682	