

PROJECT ENGINEER: NANCY FASIG

LIAISON ENGINEER: JASON STULTS (217)465-4181

STATE OF ILLINOIS  
DEPARTMENT OF TRANSPORTATION  
DIVISION OF HIGHWAYS

**PROPOSED  
HIGHWAY PLANS**

FAI ROUTE 74  
PROJECT: ACBRI - 074 - 6(153)195  
SECTION (10,92-8 HB-1)BR  
CHAMPAIGN COUNTY  
C-95-074-07  
BRIDGE REPLACEMENT

ADT = 24,100 (FAI 74) (2005)  
6,400 (FAP 836) (2007)

% SU = 3.0 (FAS 518/836)  
% MU = 11.5 (FAS 518/836)  
TRAFFIC FACTOR = 3.805

DESIGN DESIGNATION:  
IL 49S FAP 836 - 600(20)ARTERIAL 3.805 FD-20

HIGHWAY CLASSIFICATION:  
RURAL MINOR ARTERIAL - IL 49  
INTERSTATE - F.A.I. ROUTE 74

PRINTED BY THE AUTHORITY  
OF THE STATE OF ILLINOIS

**SCALES**

- PLAN 1" = 20'
- PROFILE HORIZ. 1" = 20'
- PROFILE VERT. 1" = 5'
- CROSS SECTION HORIZ. 1" = 10'
- CROSS SECTION VERT. 1" = 5'
- REMOVAL SHEET 1" = 50'
- INTERSECTION DETAIL 1" = 10'

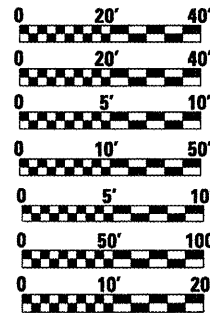

FULL SIZE PLANS HAVE BEEN PREPARED USING STANDARD  
ENGINEERING SCALES. REDUCED SIZED PLANS WILL NOT  
CONFORM TO STANDARD SCALES. IN MAKING MEASUREMENTS  
ON REDUCED PLANS, THE ABOVE SCALES MAY BE USED.

J.U.L.I.E.  
JOINT UTILITY LOCATION INFORMATION FOR EXCAVATION  
1-800-892-0123

(OGDEN TOWNSHIP)

CONTRACT NO. 70695

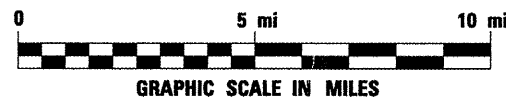
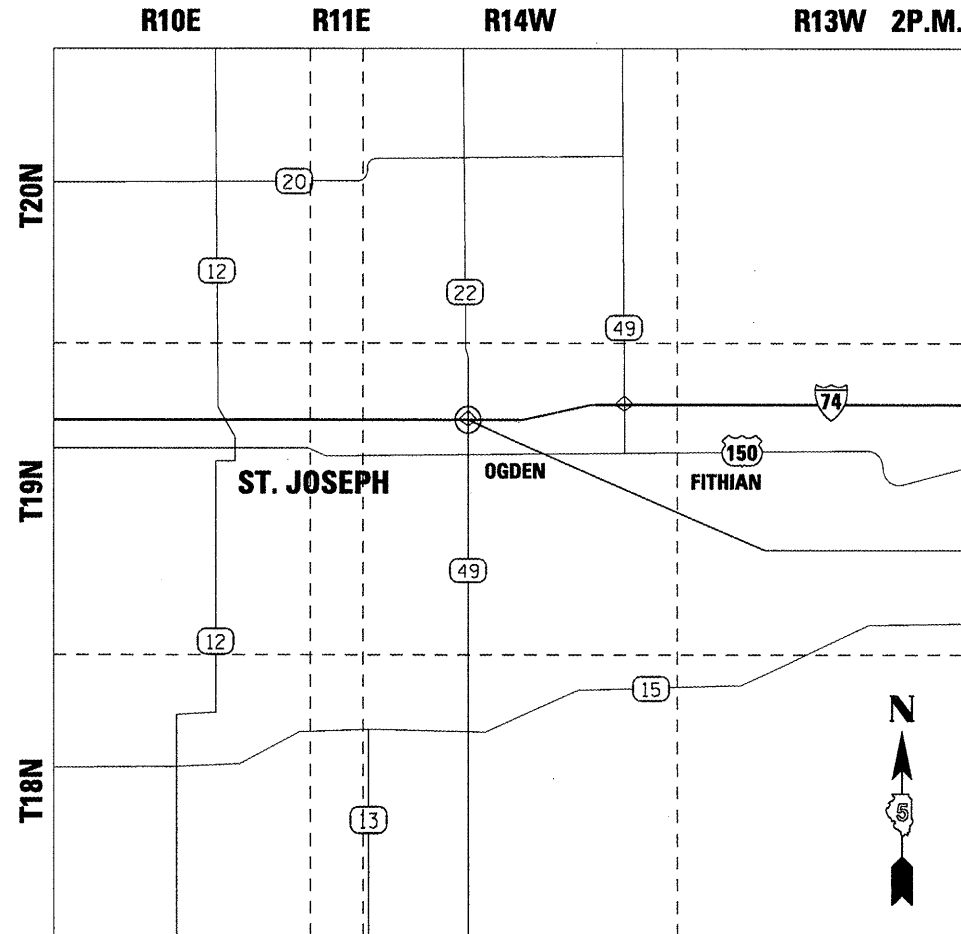

PROPOSED IMPROVEMENT  
FAP 836 (IL 49 S7/CH 22):  
STA. 306+23.50 TO STA. 326+81.50  
EQUATION: STA. 307+77.50 BK.  
=STA. 41+00.00 AH.  
STA. 59+00.00 BK.  
=STA. 325+79.80 AH.

FAI 74:  
STA. 2294+00.00 TO STA. 1003+85.00  
EQUATION: STA. 2297+21.00 BK  
=STA. 1000+88.67 AH.

PROPOSED STRUCTURE (S.N. 010-0277)  
CONSISTS OF TWO SPANS, 43'-2" O. TO O.  
R.C. DECK ON SIX 42" DEEP PLATE  
GIRDERS, 0°-10'-41" SKEW, ONE  
MULTIPLE-COLUMN GRADE SEPARATION PIER,  
AND 219' BK. TO BK. INTEGRAL ABUTMENTS.

F.A.I. RTE.	SECTION	COUNTY	TOTAL SHEETS	SHEET NO.
74	(10,92-8 HB-1)BR	CHAMPAIGN	93	1

CONTRACT NO. 70695

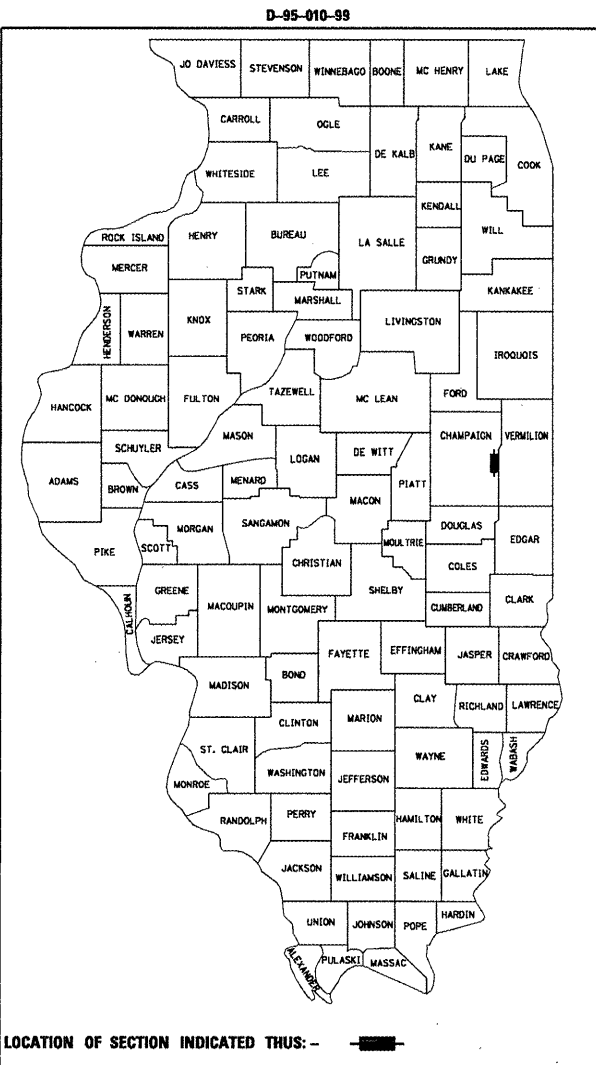

STATE OF ILLINOIS  
DEPARTMENT OF TRANSPORTATION  
DIVISION OF HIGHWAYS

SUBMITTED 3/10 20 08

Joseph E. Gavelin  
DEPUTY DIRECTOR OF HIGHWAYS, REGION THREE ENGINEER

May 9, 20 08  
Eric E. Harm  
ENGINEER OF DESIGN AND ENVIRONMENT

May 9, 20 08  
Christine M. Reed  
DIRECTOR OF HIGHWAYS, CHIEF ENGINEER

GROSS LENGTH OF IMPROVEMENT = 219.0 FT. (0.041 MI.)  
NET LENGTH OF IMPROVEMENT = 219.0 FT. (0.041 MI.)