

F.A.I. RTE.	SECTION	COUNTY	TOTAL SHEETS	SHEET NO.
74	.	CHAMPAIGN	93	36
STA.		TO STA.		
FED. ROAD DIST. NO.		ILLINOIS FED. AID PROJECT		
		* (10,92-8 HB-1)BR		
		CONTRACT NO. 70695		

- PR ISLAND RADIUS POINTS
- (L) 42+13.38, 15.00' LT
 - (M) 42+18.45, 18.42' LT
 - (N) 42+19.85, 16.00' LT

- PR 2CC RADIUS POINTS
- (A) 41+46.55, 13.00' RT
 - (B) 502+79.62, 10.16' LT
 - (C) 502+09.08, 0.00' LT

- PR 2CC RADIUS POINTS
- (D) 307+72.66, 13.00' LT
 - (E) 98+63.49, 36.06' LT
 - (F) 99+35.53, 0.00' LT

(I) SIGN POST
42+17.83, 16.28 LT

PR 2 - C.C.
90 ft - 250 ft
Ø = 6.5'

PR 2 - C.C.
90 ft - 300 ft
Ø = 7.32'

PR 2 - C.C.
65 ft - 250 ft
Ø = 8.0 ft

- PR 2CC RADIUS POINTS
- (G) 501+88.57, 14.00' RT
 - (H) 502+61.29, 24.81' RT
 - (I) 42+69.00, 13.00' RT

- PR 65.0 ft RADIUS POINTS
- (J) 42+86.75, 13.00' LT
 - (K) 99+39.52, 14.00' RT

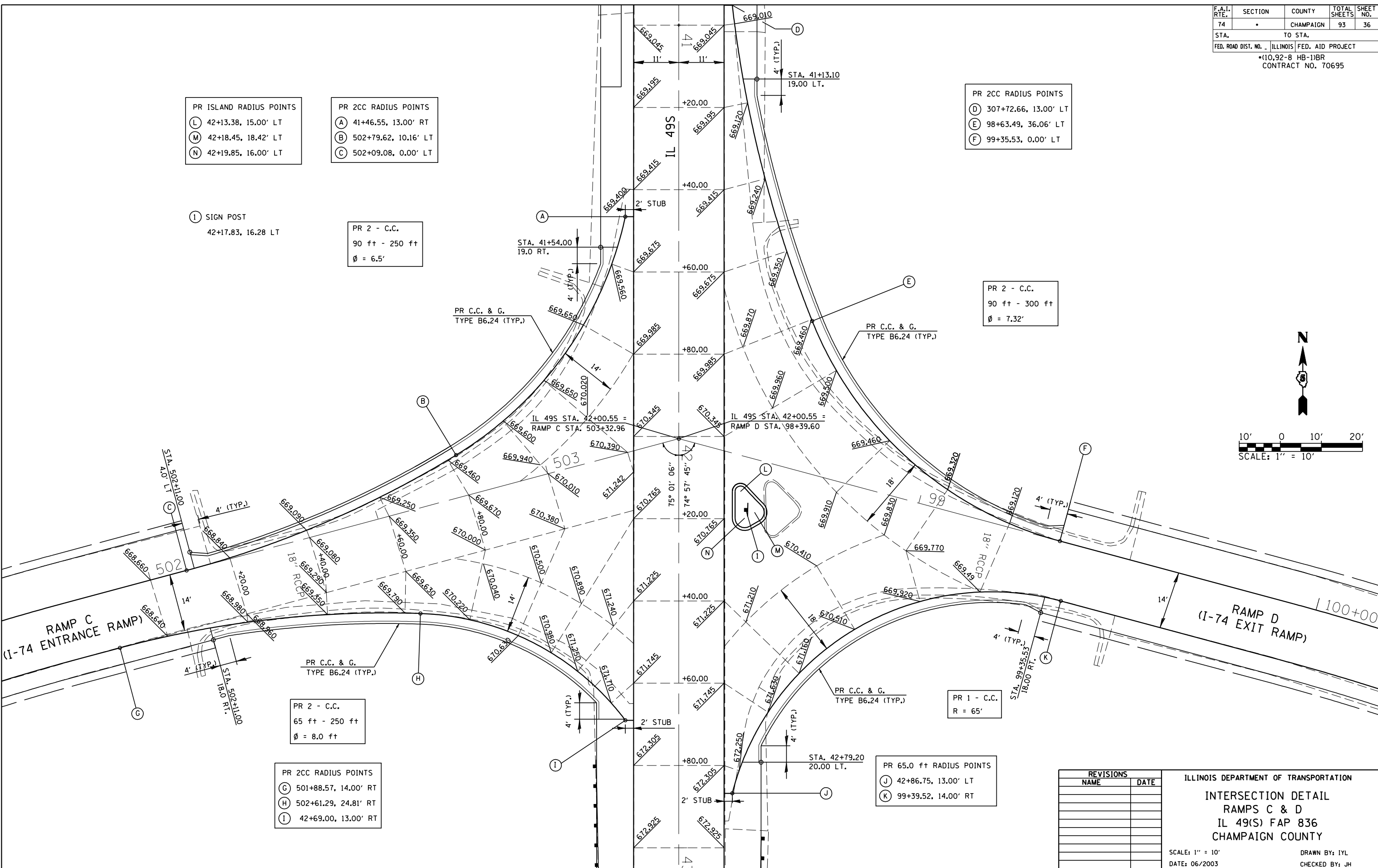

REVISIONS	
NAME	DATE

ILLINOIS DEPARTMENT OF TRANSPORTATION
INTERSECTION DETAIL
RAMPS C & D
 IL 49(S) FAP 836
 CHAMPAIGN COUNTY
 SCALE: 1" = 10'
 DATE: 06/2003
 DRAWN BY: IYL
 CHECKED BY: JH