

F.A.I. RTE.	SECTION	COUNTY	TOTAL SHEETS	SHEET NO.
74	(92-11)	VERMILION	17	1
FED. ROAD DIST. NO.	ILLINOIS	CONTRACT NO. 70705		

STATE OF ILLINOIS
DEPARTMENT OF TRANSPORTATION
DIVISION OF HIGHWAYS

**PROPOSED
HIGHWAY PLANS**

FAI ROUTE 74 (I-74)
SECTION (92-11)
VERMILION COUNTY

C-95-085-07

PATCHING FROM NS RR TO ILL 1 IN DANVILLE

FOR INDEX OF SHEETS, SEE SHEET NO. 2
FOR SUMMARY OF QUANTITIES, SEE SHEET NO. 4

CURRENT ADT = 22,900 (2005) I-74 WEST OF INTERCHANGE NO. 215
CURRENT ADT = 27,600 (2005) I-74 EAST OF INTERCHANGE NO. 215

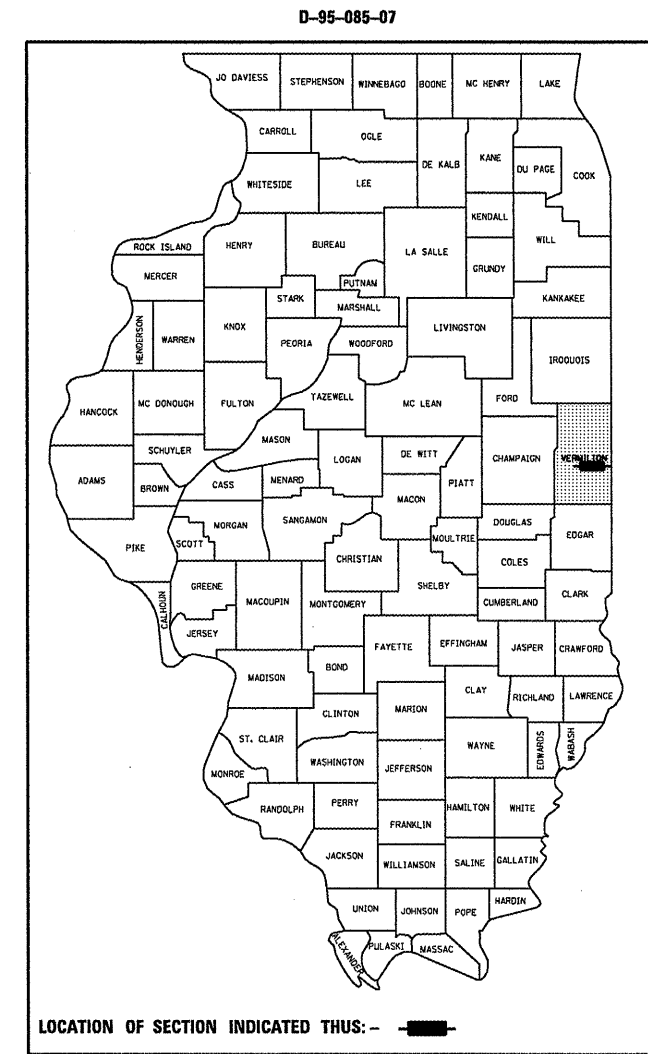

STATE OF ILLINOIS
DEPARTMENT OF TRANSPORTATION
DIVISION OF HIGHWAYS

SUBMITTED 3/13 20 08

Joseph E. Gowen
DEPUTY DIRECTOR OF HIGHWAYS, REGION ENGINEER

May 9, 20 08
Eric E. Harm
ENGINEER OF DESIGN AND ENVIRONMENT

Christine M. Reed
DIRECTOR OF HIGHWAYS, CHIEF ENGINEER

**PRINTED BY THE AUTHORITY
OF THE STATE OF ILLINOIS**

DESIGN DESIGNATION
NA

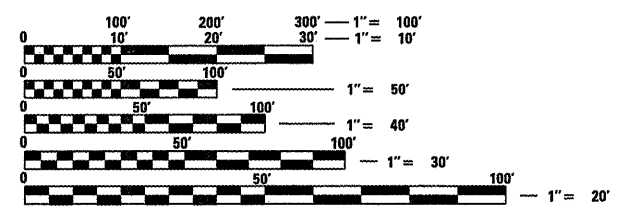

FULL SIZE PLANS HAVE BEEN PREPARED USING STANDARD ENGINEERING SCALES. REDUCED SIZED PLANS WILL NOT CONFORM TO STANDARD SCALES. IN MAKING MEASUREMENTS ON REDUCED PLANS, THE ABOVE SCALES MAY BE USED.

J.U.L.I.E.
JOINT UTILITY LOCATION INFORMATION FOR EXCAVATION
1-800-892-0123
OR 811

PROJECT ENGINEER: NANCY FASIG
PROJECT MANAGER: TODD BLACK
217-465-4181
CONTRACT NO. 70705

INTERCHANGE NO. 214
S.N. 092-0010 (EB)
S.N. 092-0011 (WB)
PROJECT BEGINS
STA. 1880+00.00

EBDL, EBPL, WBDL, WBPL

INTERCHANGE NO. 215
S.N. 092-0038
STA. 1929+29.04

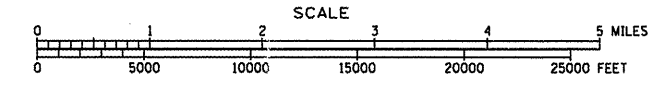
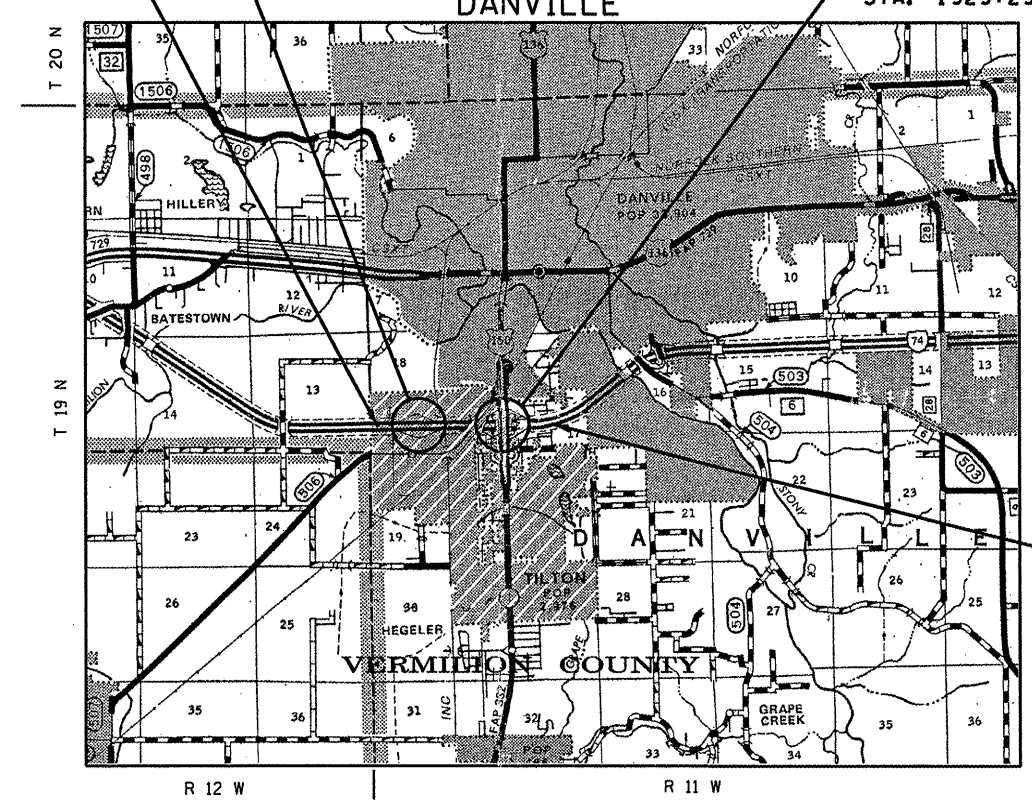

TOTAL LENGTH OF SECTION = 7,500.00 FEET = 1.420 MILES
NET LENGTH OF SECTION = 7,032.58 FEET = 1.332 MILES

INDEX OF SHEETS

<u>SHEET NO.</u>	<u>DESCRIPTION</u>
1	COVER SHEET
2	INDEX OF SHEETS
2	LIST OF HIGHWAY STANDARDS
3	GENERAL NOTES
4	SUMMARY OF QUANTITIES
5-6	EXISTING TYPICAL SECTIONS
7-12	SCHEDULES OF QUANTITIES
13-16	PLAN SHEETS
17	DETAIL OF PAVEMENT MARKING (INTERSTATE & MULTILANE APPLICATIONS)

LIST OF HIGHWAY STANDARDS

<u>STANDARD NUMBER</u>	<u>NAME OF STANDARD</u>
000001-05	STANDARD SYMBOLS, ABBREVIATIONS AND PATTERNS
001001-01	AREAS OF REINFORCEMENT REBARS
001006	DECIMAL OF AND INCH AND OF A FOOT
420001-07	PAVEMENT JOINTS
420601-05	24' (7.2m) PCC PAVEMENT
420701-02	PAVEMENT FABRIC
442101-07	CLASS B PATCHES
701101-01	OFF-ROAD OPERATIONS, MULTILANE, 15' TO 24" FROM PAVEMENT EDGE
701400-02	APPROACH TO LANE CLOSURE, FREEWAY/EXPRESSWAY
701401-04	LANE CLOSURE, FREEWAY/EXPRESSWAY
701411-04	LANE CLOSURE, MULTILANE AT ENTRANCE OR EXIT RAMP FOR SPEEDS \geq 45 MPH
701426-02	LANE CLOSURE, MULTILANE, INTERMITTENT OR MOVING OPER., FOR SPEEDS \geq 45 MPH
701901	TRAFFIC CONTROL DEVICES
780001-01	TYPICAL PAVEMENT MARKINGS

FILE NAME = c:\projects\4570705\70705plans.dgn	USER NAME = collierbw	DESIGNED - RTB	REVISED -	STATE OF ILLINOIS DEPARTMENT OF TRANSPORTATION	INDEX OF SHEETS AND LIST OF HIGHWAY STANDARDS	F.A.I. RTE. 74	SECTION (92-111)	COUNTY VERMILION	TOTAL SHEETS 17	SHEET NO. 2
PLOT SCALE = 100.0000' / IN.	CHECKED -	DRAWN - JRP	REVISED -	SCALE: NA	SHEET NO. 1 OF 1 SHEETS	STA.	TO STA.	CONTRACT NO. 70705		
PLOT DATE = 3/13/2008	DATE - 12-07	REVISOR -	REVISED -	FED. ROAD DIST. NO. ILLINOIS FED. AID PROJECT						

GENERAL NOTES

G.N.-100
 ENGLISH UNITS OF MEASUREMENT SHALL GOVERN OVER
 AND SUPERSEDE ANY METRIC UNITS SHOWN IN THIS CONTRACT.
 WHERE INCLUDED, METRIC UNITS ARE FOR INFORMATION ONLY.

G.N.-442B -- PATCHING SCHEDULES
 THE PATCHING SCHEDULES INCLUDED IN THE PLANS REPRESENT
 THE BEST INFORMATION AVAILABLE AT THE TIME OF COMPLETION
 OF THE PLANS FOR LETTING. VARIATIONS IN LOCATION AND SIZES
 OF THE FULL-DEPTH PATCHES MAY OCCUR.

G.N. -780 SPECIAL
 PAINT PAVEMENT MARKINGS SHALL BE APPLIED UPON COMPLETION
 OF THE PATCH WORK. PAINT PAVEMENT MARKINGS SHALL COINCIDE
 WITH THE EXISTING PAVEMENT MARKINGS. PAINT PAVEMENT MARKINGS
 SHALL BE LIMITED TO THE PATCH LENGTH AT EACH PATCH LOCATION.
 PAINT PAVEMENT MARKINGS SHALL NOT BE APPLIED CONTINUOUSLY
 THROUGH THE PROJECT BETWEEN PATCH LOCATIONS.

G.N.-1004.01
 COARSE AGGREGATE GRADATION CA-10 MAY BE USED WHENEVER
 COARSE AGGREGATE CA-6 IS SPECIFIED IN THE STANDARD
 SPECIFICATIONS.

NO COMMITMENTS

FILE NAME = c:\projects\4570705\70705plans.dgn	USER NAME = colle-bw	DESIGNED - RTB	REVISED -	STATE OF ILLINOIS DEPARTMENT OF TRANSPORTATION	GENERAL NOTES	F.A.I. RTE. 74	SECTION (92-1111)	COUNTY VERMILION	TOTAL SHEETS 17	SHEET NO. 3
PLOT SCALE = 100.0000' / IN.	CHECKED -	DRAWN - JRP	REVISED -	SCALE: NA	SHEET NO. 1 OF 1 SHEETS	STA.	TO STA.	CONTRACT NO. 70705 FED. ROAD DIST. NO. ILLINOIS FED. AID PROJECT		
PLOT DATE = 3/13/2008	DATE - 12-07	CHECKED -	REVISED -							

SUMMARY OF QUANTITIES

LOCATION OF WORK:

FAI - 74
VERMILION COUNTY

Sta. 1880+00.00 to 1955+00.00

Urban Multilane
100% STATE
J000-2A

CONSTRUCTION TYPE CODE:

<u>CODE NO.</u>	<u>ITEM</u>	<u>UNIT</u>	<u>TOTAL QUANTITY</u>
42001200	PAVEMENT FABRIC	SQ YD	65.0
44201007	CLASS B PATCHES, TYPE II, 13 INCH	SQ YD	400.0
44201011	CLASS B PATCHES, TYPE III, 13 INCH	SQ YD	32.0
44201013	CLASS B PATCHES, TYPE IV, 13 INCH	SQ YD	35.0
44213200	SAW CUTS	FOOT	2,500.0
67100100	MOBILIZATION	L SUM	1.0
70100420	TRAFFIC CONTROL AND PROTECTION, STANDARD 701411	EACH	8.0
70100800	TRAFFIC CONTROL AND PROTECTION, STANDARD 701401	L SUM	1.0
70103815	TRAFFIC CONTROL SURVEILLANCE	CAL DA	11.0
* 78001110	PAINT PAVEMENT MARKING - LINE 4"	FOOT	440.0
X7015005	CHANGEABLE MESSAGE SIGN	CAL DA	28.0
Z0017100	DOWEL BARS	EACH	1,000.0
Z0075300	TIE BARS	EACH	13.0

* SPECIALTY ITEMS

FILE NAME = c:\projects\4570705\70705plans.dgn	USER NAME = collierbw	DESIGNED - RTB	REVISED -	STATE OF ILLINOIS DEPARTMENT OF TRANSPORTATION	SUMMARY OF QUANTITIES	F.A.I. RTE. 74	SECTION (92-111)	COUNTY VERMILION	TOTAL SHEETS 17	SHEET NO. 4
	PLOT SCALE = 100.0000' / IN.	DRAWN - JRP	REVISED -		SCALE: NA					
	PLOT DATE = 3/13/2008	CHECKED -	REVISED -		SHEET NO. 1 OF 1 SHEETS	STA.	TO STA.	CONTRACT NO. 70705		
		DATE - 12-07	REVISED -			FED. ROAD DIST. NO. [ILLINOIS] FED. AID PROJECT				

EXISTING TYPICAL SECTION

F. A. I. ROUTE 74

STATION TO STATION

(WB) 1880+00.00	1899+61.79 (WB)
(EB) 1880+00.00	1899+74.81 (EB)
(WB) 1914+82.50	1943+47.50 (WB)
(EB) 1913+52.50	1940+97.50 (EB)

BRIDGE OMISSIONS	
STATION TO	STATION
1890+32.22	1892+08.94

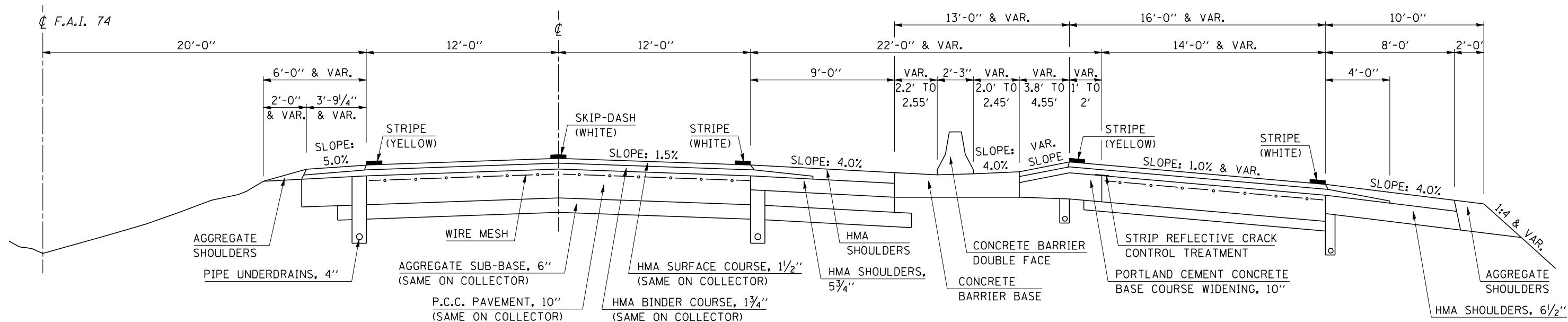

EXISTING TYPICAL SECTION

F. A. I. ROUTE 74

STATION TO STATION

(WB) 1899+61.79	1908+00.00 (WB)
(EB) 1899+74.81	1908+00.00 (EB)

BRIDGE OMISSIONS	
STATION TO	STATION
(WB) 1899+61.79	1902+53.00
(EB) 1899+74.81	1902+65.00

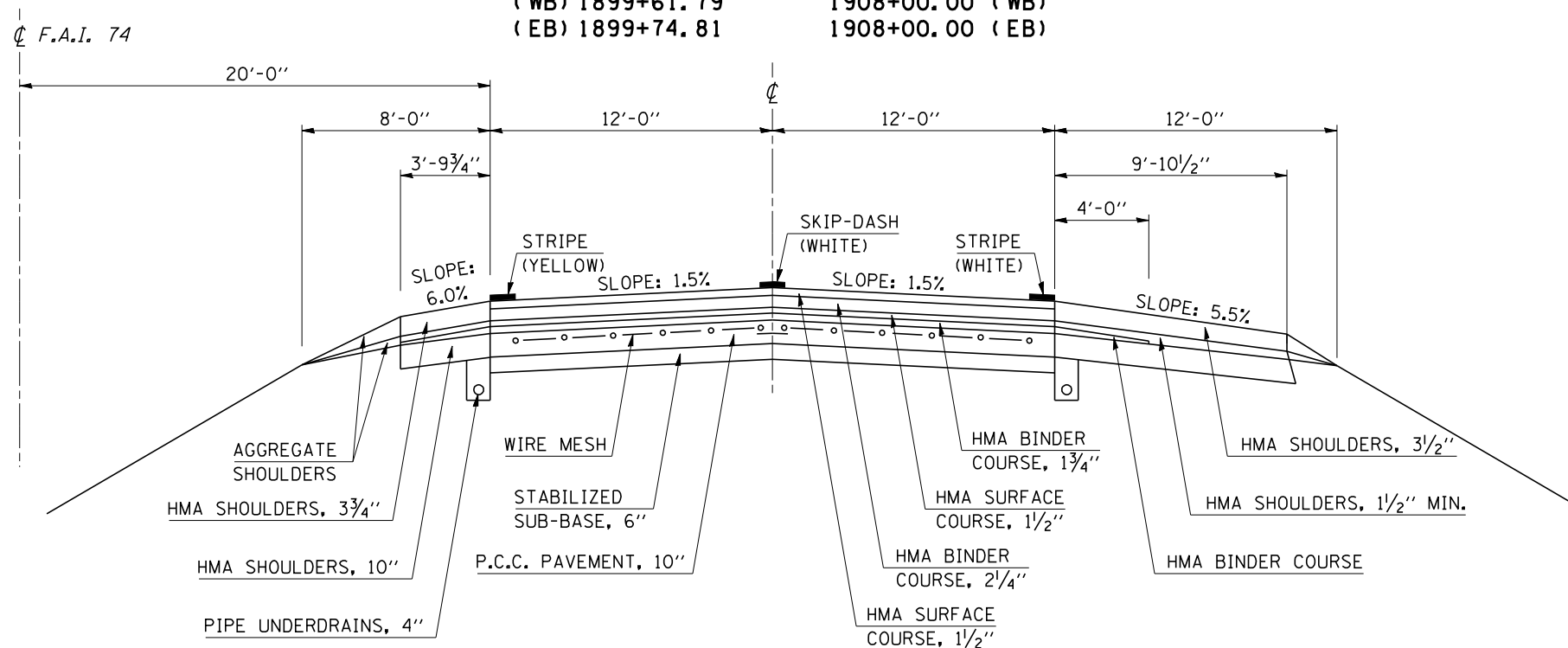

FILE NAME = c:\projects\d570705\70705plans.dgn

USER NAME = collierbw
 DRAWN - JRP
 CHECKED -
 PLOT SCALE = 100.0000' / IN.
 PLOT DATE = 3/13/2008

DESIGNED - RTB
 DATE - 12-07

REVISED -
 REVISED -
 REVISED -
 REVISED -

STATE OF ILLINOIS
 DEPARTMENT OF TRANSPORTATION

EXISTING TYPICAL SECTIONS

SCALE: NA SHEET NO. 1 OF 2 SHEETS STA. TO STA.

F.A.I. RTE.	SECTION	COUNTY	TOTAL SHEETS	SHEET NO.
74	(92-111)	VERMILION	17	5
CONTRACT NO. 70705				
FED. ROAD DIST. NO. ILLINOIS FED. AID PROJECT				

EXISTING TYPICAL SECTION

F. A. I. ROUTE 74

STATION TO STATION

(WB) 1908+00.00	1914+82.50 (WB)
(EB) 1908+00.00	1913+52.50 (EB)
(WB) 1943+47.50	1948+00.00 (WB)
(EB) 1940+97.50	1948+00.00 (EB)

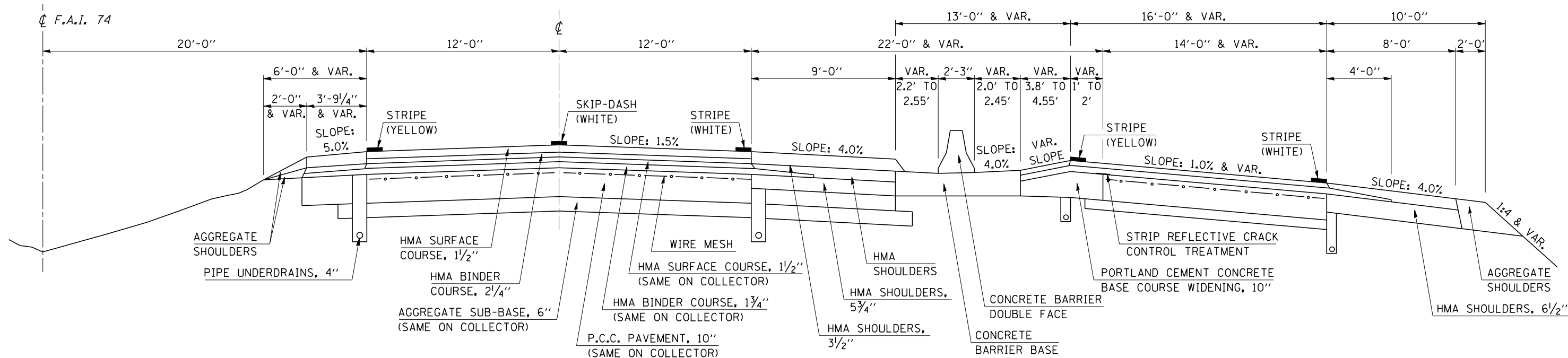

EXISTING TYPICAL SECTION

F. A. I. ROUTE 74

STATION TO STATION

1948+00.00	1955+00.00
------------	------------

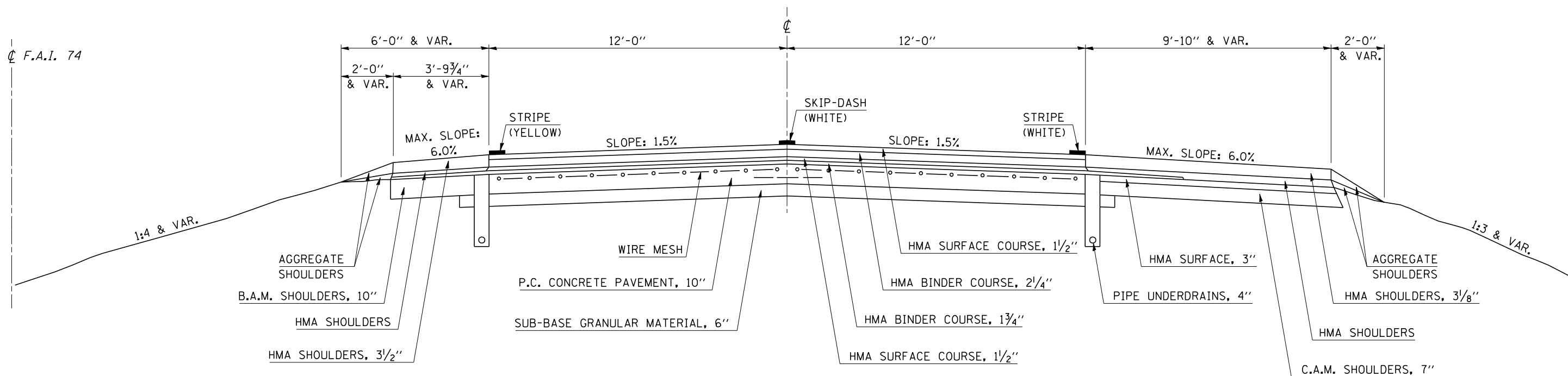

FILE NAME =	USER NAME = collierbw	DESIGNED - RTB	REVISED -	STATE OF ILLINOIS DEPARTMENT OF TRANSPORTATION	EXISTING TYPICAL SECTIONS			F.A.I. RTE. =	SECTION	COUNTY	TOTAL SHEETS	SHEET NO.
ct:\projects\d570705\70705plans.dgn		DRAWN - JRP	REVISED -					74	(92-111)	VERMILION	17	6
PLOT SCALE = 100.0000' / IN.		CHECKED -	REVISED -		SCALE: NA SHEET NO. 2 OF 2 SHEETS STA. TO STA.			CONTRACT NO. 70705				
PLOT DATE = 3/13/2008		DATE - 12-07	REVISED -		FED. ROAD DIST. NO. ILLINOIS FED. AID PROJECT							

SCHEDULE OF QUANTITIES

TABULATION OF CLASS B PATCH - 13 INCH (EASTBOUND)

STATION	LANE	LENGTH (FT)	WIDTH (FT)	TYPE 2	TYPE 3	TYPE 4	SAWCUTS	TIE BARS	DOWEL BARS	PAVEMENT FABRIC	
				44201007 (SQ. YD.)	44201011 (SQ. YD.)	44201013 (SQ. YD.)	44213200 (FT)	Z0075300 (EACH)	Z0017100 (EACH)	42001200 (SQ. YD.)	
1886+00.00	EBDL	6.0	12.0	8.0	-	-	48.0	0.0	20.0	0.0	
1886+22.00	EBDL	6.0	12.0	8.0	-	-	48.0	0.0	20.0	0.0	
1887+24.00	EBDL	6.0	12.0	8.0	-	-	48.0	0.0	20.0	0.0	
1889+06.00	EBDL	6.0	12.0	8.0	-	-	48.0	0.0	20.0	0.0	
1889+61.00	EBDL	6.0	12.0	8.0	-	-	48.0	0.0	20.0	0.0	
1892+02.00	EBDL	6.0	12.0	8.0	-	-	48.0	0.0	20.0	0.0	
1915+09.00	EBDL	6.0	12.0	8.0	-	-	48.0	0.0	20.0	0.0	
1915+84.00	EBDL	10.0	12.0	13.3	-	-	56.0	0.0	20.0	0.0	
1915+94.00	EBDL	6.0	12.0	8.0	-	-	48.0	0.0	20.0	0.0	
1916+14.00	EBDL	6.0	12.0	8.0	-	-	48.0	0.0	20.0	0.0	
1916+24.00	EBDL	6.0	12.0	8.0	-	-	48.0	0.0	20.0	0.0	
1916+35.00	EBDL	6.0	12.0	8.0	-	-	48.0	0.0	20.0	0.0	
1916+63.00	EBDL	6.0	12.0	8.0	-	-	48.0	0.0	20.0	0.0	
1916+74.00	EBDL	6.0	12.0	8.0	-	-	48.0	0.0	20.0	0.0	
1916+83.00	EBDL	6.0	12.0	8.0	-	-	48.0	0.0	20.0	0.0	
CLASS B PATCH - 13"				PAGE SUBTOTALS	125.3	0.0	0.0	728.0	0.0	300.0	0.0

SCHEDULE OF QUANTITIES

TABULATION OF CLASS B PATCH - 13 INCH (EASTBOUND)

STATION	LANE	LENGTH (FT)	WIDTH (FT)	TYPE 2 44201007 (SQ. YD.)	TYPE 3 44201011 (SQ. YD.)	TYPE 4 44201013 (SQ. YD.)	SAWCUTS 44213200 (FT)	TIE BARS Z0075300 (EACH)	DOWEL BARS Z0017100 (EACH)	PAVEMENT FABRIC 42001200 (SQ. YD.)
1917+67.00	EBDL	6.0	12.0	8.0	-	-	48.0	0.0	20.0	0.0
1917+89.00	EBDL	6.0	12.0	8.0	-	-	48.0	0.0	20.0	0.0
1918+26.00	EBDL	6.0	12.0	8.0	-	-	48.0	0.0	20.0	0.0
1918+63.00	EBDL	6.0	12.0	8.0	-	-	48.0	0.0	20.0	0.0
1918+82.00	EBDL	6.0	12.0	8.0	-	-	48.0	0.0	20.0	0.0
1918+84.00	*EBPL*	6.0	12.0	8.0	-	-	48.0	0.0	20.0	0.0
1918+95.00	*EBPL*	10.0	12.0	13.3	-	-	56.0	0.0	20.0	0.0
1919+17.00	EBDL	6.0	12.0	8.0	-	-	48.0	0.0	20.0	0.0
1929+61.00	EBDL	6.0	12.0	8.0	-	-	48.0	0.0	20.0	0.0
CLASS B PATCH - 13"		PAGE SUBTOTALS		77.3	0.0	0.0	440.0	0.0	180.0	0.0

SCHEDULE OF QUANTITIES

TABULATION OF CLASS B PATCH - 13 INCH (WESTBOUND)

STATION	LANE	LENGTH (FT)	WIDTH (FT)	TYPE 2	TYPE 3	TYPE 4	SAWCUTS	TIE BARS	DOWEL BARS	PAVEMENT FABRIC	
				44201007 (SQ. YD.)	44201011 (SQ. YD.)	44201013 (SQ. YD.)	44213200 (FT)	Z0075300 (EACH)	Z0017100 (EACH)	42001200 (SQ. YD.)	
1935+40.00	WBDL	6.0	12.0	8.0	-	-	48.0	0.0	20.0	0.0	
1935+62.00	WBDL	6.0	12.0	8.0	-	-	48.0	0.0	20.0	0.0	
1935+89.00	WBDL	6.0	12.0	8.0	-	-	48.0	0.0	20.0	0.0	
1936+00.00	WBDL	6.0	12.0	8.0	-	-	48.0	0.0	20.0	0.0	
1936+27.00	WBDL	10.0	12.0	13.3	-	-	56.0	0.0	20.0	0.0	
1936+72.00	WBDL	6.0	12.0	8.0	-	-	48.0	0.0	20.0	0.0	
1937+31.00	WBDL	10.0	12.0	13.3	-	-	56.0	0.0	20.0	0.0	
1937+95.00	WBDL	6.0	12.0	8.0	-	-	48.0	0.0	20.0	0.0	
1938+33.00	WBDL	6.0	12.0	8.0	-	-	48.0	0.0	20.0	0.0	
1939+29.00	WBDL	6.0	12.0	8.0	-	-	48.0	0.0	20.0	0.0	
1940+33.00	WBDL	6.0	12.0	8.0	-	-	48.0	0.0	20.0	0.0	
CLASS B PATCH - 13"				PAGE SUBTOTALS	98.6	0.0	0.0	544.0	0.0	220.0	0.0

SCHEDULE OF QUANTITIES
CLASS B PATCH - 13 INCH TOTALS

PATCH TOTALS CLASS B - 13 INCH	TYPE 2 44201007 (SQ. YD.)	TYPE 3 44201011 (SQ. YD.)	TYPE 4 44201013 (SQ. YD.)	SAWCUTS 44213200 (FT)	TIE BARS Z0075300 (EACH)	DOWEL BARS Z0017100 (EACH)	PAVEMENT FABRIC 42001200 (SQ. YD.)
CLASS B PATCH PAGE SUBTOTALS (SHEET 7)	125.3	-	-	728.0	-	300.0	-
CLASS B PATCH PAGE SUBTOTALS (SHEET 8)	77.3	-	-	440.0	-	180.0	-
CLASS B PATCH PAGE SUBTOTALS (SHEET 9)	96.0	32.0	33.3	782.0	13.0	300.0	65.3
CLASS B PATCH PAGE SUBTOTALS (SHEET 10)	98.6	-	-	544.0	-	220.0	-
CLASS B PATCH - 13" TOTALS	397.2	32.0	33.3	2494.0	13.0	1000.0	65.3
USE	400.0	32.0	35.0	2500.0	13.0	1000.0	65.0

SCHEDULE OF QUANTITIES

78001110 PAINT PAVEMENT MARKING - LINE 4 INCH

<u>STATION</u>	<u>TO</u>	<u>STATION</u>	<u>OFFSET (FT)</u>	<u>DESCRIPTION</u>	<u>LENGTH (FT)</u>
1886+00.00		1892+02.00	EBDL	WHITE SOLID EDGE LINE	36.00
1886+00.00		1892+02.00	EBDL	WHITE SKIP DASH CENTERLINE	10.00
1915+09.00		1929+61.00	EBDL	WHITE SOLID EDGE LINE	100.00
1915+09.00		1929+61.00	EBDL	WHITE SKIP DASH CENTERLINE	25.00
1882+97.00		1899+35.00	WBDL	WHITE SOLID EDGE LINE	80.00
1882+97.00		1899+35.00	WBDL	WHITE SKIP DASH CENTERLINE	20.00
1924+84.00		1940+33.00	WBDL	WHITE SOLID EDGE LINE	104.00
1924+84.00		1940+33.00	WBDL	WHITE SKIP DASH CENTERLINE	26.00
1918+84.00		1918+95.00	EBPL	WHITE SKIP DASH CENTERLINE	4.00
1882+97.00		1918+95.00	WBPL	WHITE SKIP DASH CENTERLINE	3.00
<u>WHITE - LINE 4 INCH SUBTOTAL =</u>					<u>408.00</u>
1918+84.00		1918+95.00	EBPL	YELLOW SOLID EDGE LINE	16.00
1882+97.00		1918+95.00	WBPL	YELLOW SOLID EDGE LINE	12.00
<u>YELLOW - LINE 4 INCH SUBTOTAL =</u>					<u>28.00</u>
<u>PAINT PAVEMENT MARKING - LINE 4 INCH TOTALS =</u>					<u>436.00</u>
<u>USE =</u>					<u>440.00</u>

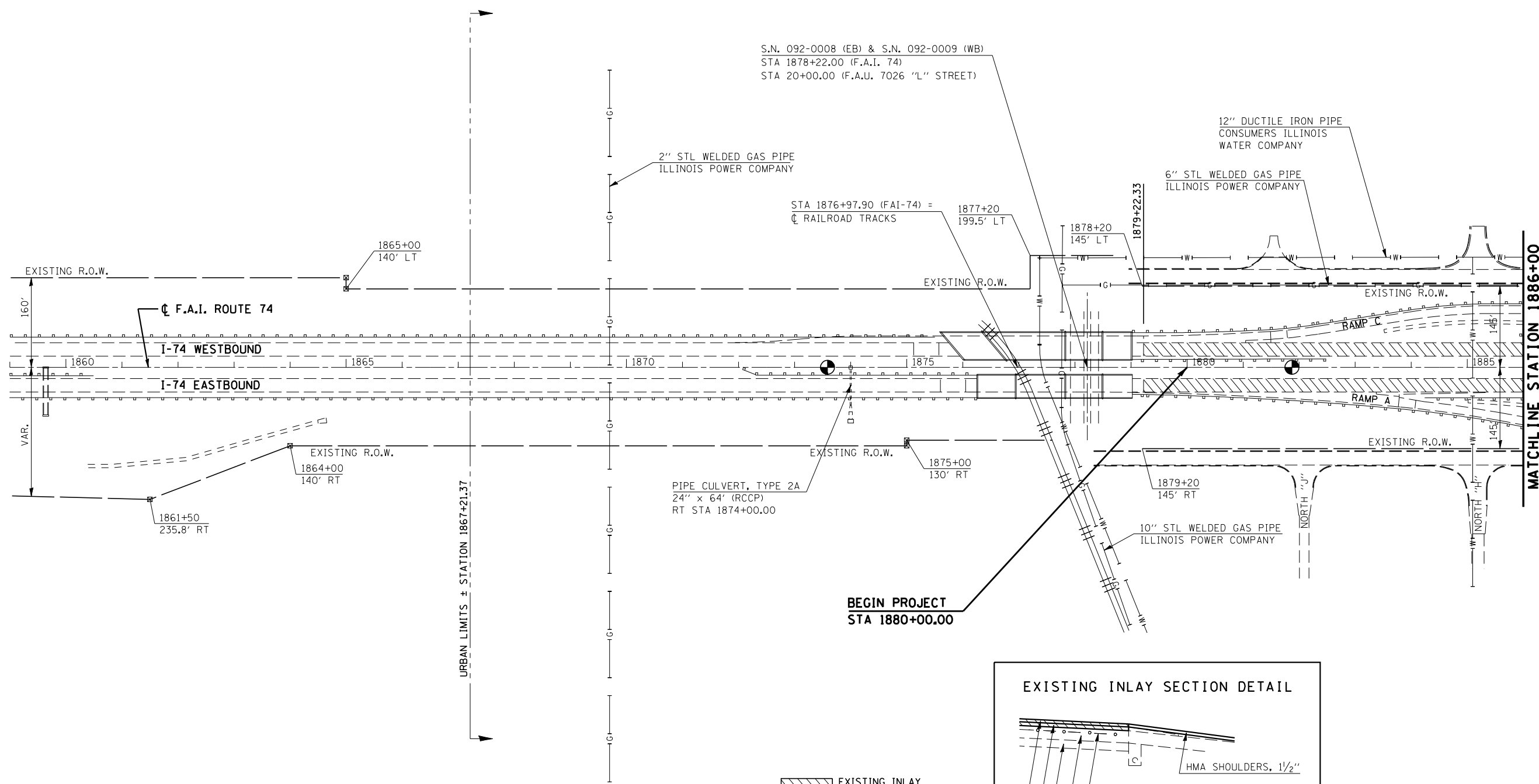

S.N. 092-0008 (EB) & S.N. 092-0009 (WB)
 STA 1878+22.00 (F.A.I. 74)
 STA 20+00.00 (F.A.U. 7026 "L" STREET)

2" STL WELDED GAS PIPE
 ILLINOIS POWER COMPANY

12" DUCTILE IRON PIPE
 CONSUMERS ILLINOIS
 WATER COMPANY

STA 1876+97.90 (FAI-74) = 1877+20
 199.5' LT
 RAILROAD TRACKS

6" STL WELDED GAS PIPE
 ILLINOIS POWER COMPANY

1865+00
 140' LT
 EXISTING R.O.W.

EXISTING R.O.W.

EXISTING R.O.W.

160'
 VAR.
 F.A.I. ROUTE 74
 I-74 WESTBOUND
 I-74 EASTBOUND

1861+50
 235.8' RT
 EXISTING R.O.W.
 1864+00
 140' RT

PIPE CULVERT, TYPE 2A
 24" x 64" (RCCP)
 RT STA 1874+00.00

EXISTING R.O.W.
 1875+00
 130' RT

1879+20
 145' RT

10" STL WELDED GAS PIPE
 ILLINOIS POWER COMPANY

BEGIN PROJECT
 STA 1880+00.00

URBAN LIMITS ± STATION 1867+21.37

MATCHLINE STATION 1886+00

EXISTING INLAY SECTIONS

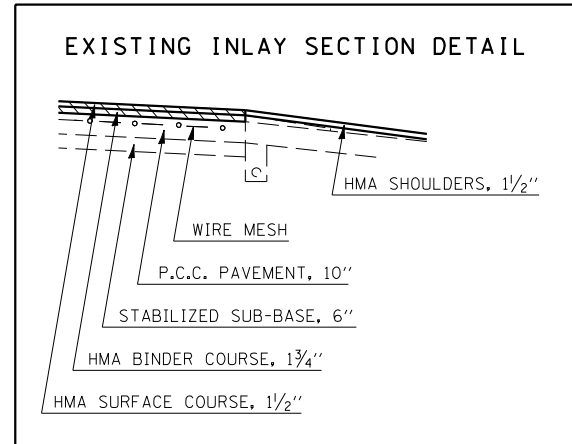

SEC. 18, T19N, R11W, 2ND P.M.

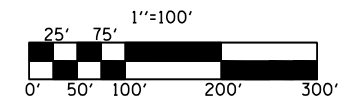

FILE NAME = c:\projects\d570705\70705plans.dgn	USER NAME = collierbw	DESIGNED - RTB	REVISED -	STATE OF ILLINOIS DEPARTMENT OF TRANSPORTATION	PLAN SHEETS			F.A.I. RTE. = 74	SECTION = (92-111)	COUNTY = VERMILION	TOTAL SHEETS = 17	SHEET NO. = 13
	PLOT SCALE = 200.0000' / IN.	CHECKED -	REVISED -		SCALE: NA	SHEET NO. 1 OF 4 SHEETS	STA. 1859+00 TO STA. 1886+00	CONTRACT NO. 70705				
PLOT DATE = 3/13/2008	DATE = 12-07	DATE = 12-07	REVISED -	FED. ROAD DIST. NO. ILLINOIS FED. AID PROJECT								

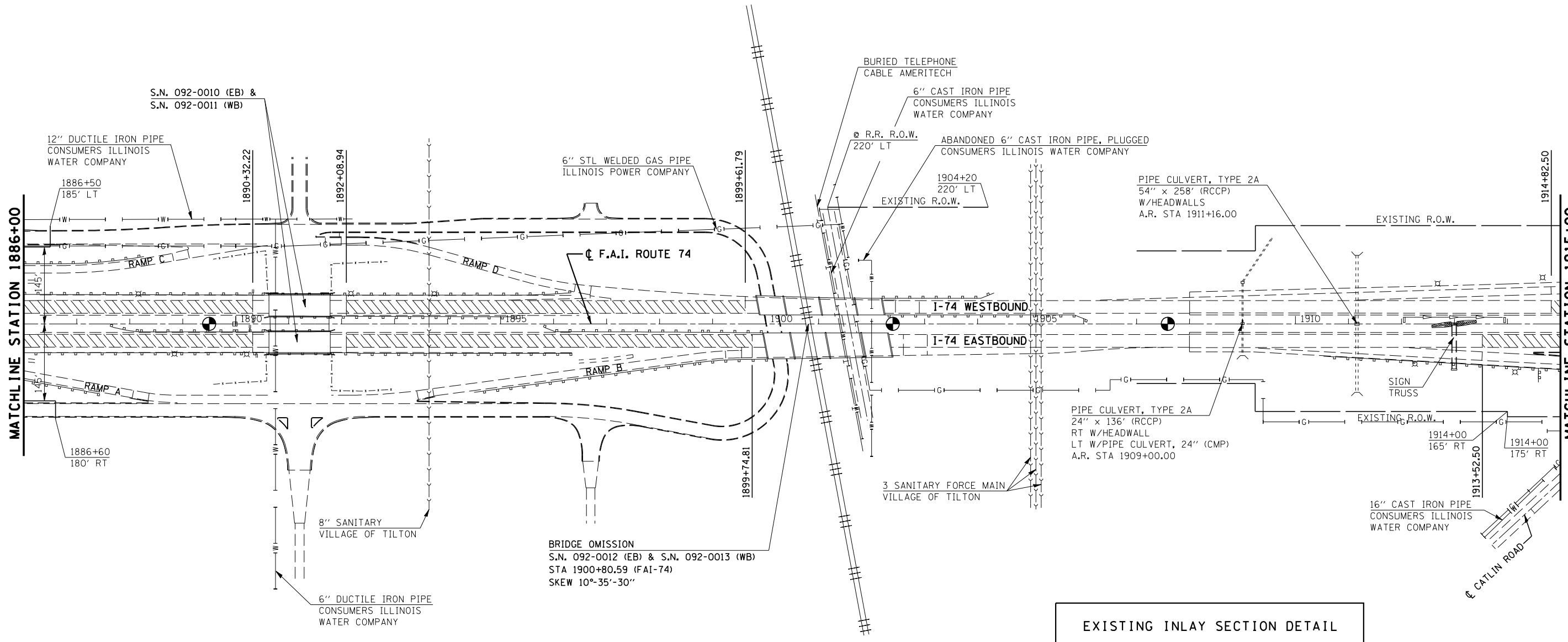

BRIDGE OMISSION
 S.N. 092-0012 (EB) & S.N. 092-0013 (WB)
 STA 1900+80.59 (FAI-74)
 SKEW 10°-35'-30"

EXISTING INLAY SECTIONS

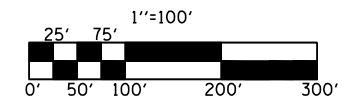
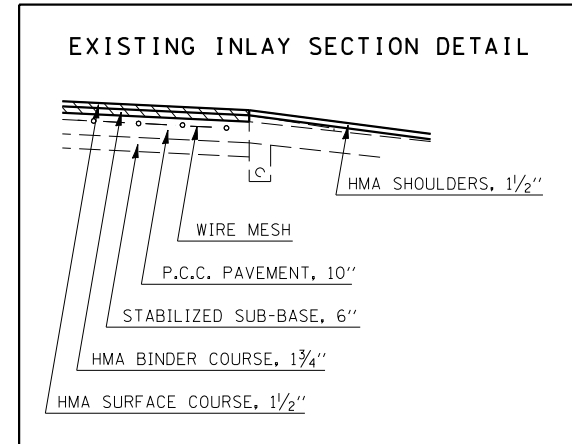

SEC. 18, T19N, R11W, 2ND P.M.

FILE NAME =
 c:\projects\d570705\70705plans.dgn

USER NAME = collierbw
 PLOT SCALE = 200.0000' / IN.
 PLOT DATE = 3/13/2008

DESIGNED - RTB
 DRAWN - JRP
 CHECKED -
 DATE - 12-07

REVISED -
 REVISED -
 REVISED -
 REVISED -

STATE OF ILLINOIS
 DEPARTMENT OF TRANSPORTATION

PLAN SHEETS
 SCALE: NA SHEET NO. 2 OF 4 SHEETS STA. 1886+00 TO STA. 1915+00

F.A.I. RTE.	SECTION	COUNTY	TOTAL SHEETS	SHEET NO.
74	(92-111)	VERMILION	17	14
CONTRACT NO. 70705				
FED. ROAD DIST. NO. ILLINOIS FED. AID PROJECT				

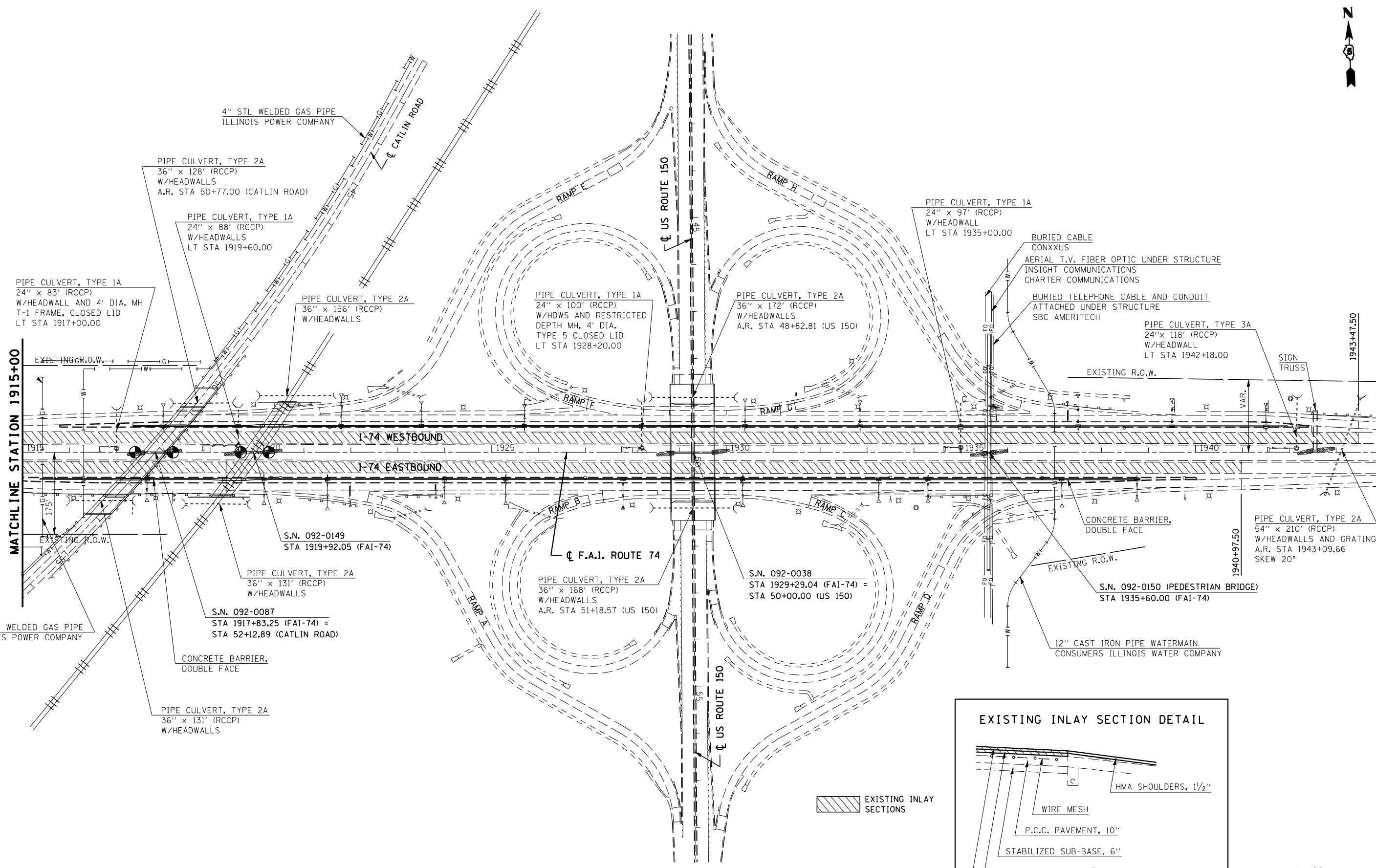

SEC. 17, T19N, R11W, 2ND P.M.

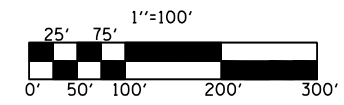
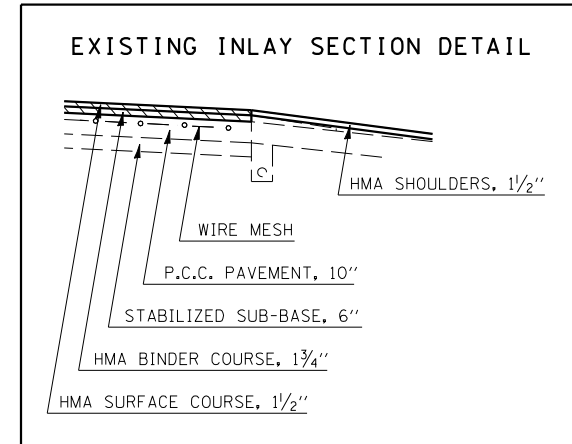

FILE NAME = c:\projects\d570705\70705plans.dgn	USER NAME = collierbw	DESIGNED - RTB	REVISED -
		DRAWN - JRP	REVISED -
		CHECKED -	REVISED -
		DATE - 12-07	REVISED -

**STATE OF ILLINOIS
DEPARTMENT OF TRANSPORTATION**

PLAN SHEETS	
SCALE: NA	SHEET NO. 3 OF 4 SHEETS
STA. 1915+00 TO STA. 1944+00	

F.A.I. RTE. 74	SECTION (92-111)	COUNTY VERMILION	TOTAL SHEETS 17	SHEET NO. 15
CONTRACT NO. 70705				
FED. ROAD DIST. NO. ILLINOIS FED. AID PROJECT				

MATCHLINE STATION 1944+00



S.N. 092-0129
 STA 1971+24.72 (F.A.I. ROUTE 74) =
 STA 50+00.00 (GREENWOOD CEMETERY RD)

PIPE CULVERT, TYPE 1A
 24" x 52' (RCCP)
 LT STA 1970+80

PIPE CULVERT, TYPE 3A
 42" x 212' (RCCP)
 W/HEADWALLS AND GRATES
 A.R. STA 1966+00.00

END PROJECT
 STA 1955+00.00

1958+50
 165' LT

1953+50
 215' LT

1953+50
 150' LT

PIPE CULVERT, TYPE 1A
 24" x 52' (RCCP)
 W/HEADWALL AND GRATING
 LT STA 1948+00.00

PIPE CULVERT, TYPE 1A
 24" x 68' (RCCP)
 W/HEADWALL
 RT STA 1961+00.00

12" HIGH PRESSURE GAS LINE
 ILLINOIS POWER COMPANY

PIPE CULVERT, TYPE 3A
 54" x 240' (RCCP)
 STA 1955+52.00
 SKEW 10°

EXISTING R.O.W.

I-74 WESTBOUND

I-74 EASTBOUND

☐ F.A.I. ROUTE 74

SEC. 17, T19N, R11W, 2ND P.M.

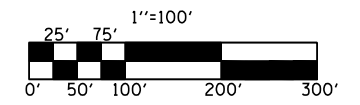

FILE NAME = c:\projects\d570705\70705plans.dgn	USER NAME = collierbw	DESIGNED - RTB	REVISED -	STATE OF ILLINOIS DEPARTMENT OF TRANSPORTATION	PLAN SHEETS			F.A.I. RTE. = 74	SECTION = (92-111)	COUNTY = VERMILION	TOTAL SHEETS = 17	SHEET NO. = 16
	PLOT SCALE = 200.0000' / IN.	CHECKED -	REVISED -		SCALE: NA	SHEET NO. 4 OF 4 SHEETS	STA. 1944+00 TO STA. 1975+00	CONTRACT NO. 70705				
PLOT DATE = 3/13/2008	DATE = 12-07	REVISED -	REVISED -	FED. ROAD DIST. NO. ILLINOIS FED. AID PROJECT								

CENTERLINE INTERSTATE OR MULTI-LANE TWO WAY DIVIDED HIGHWAY

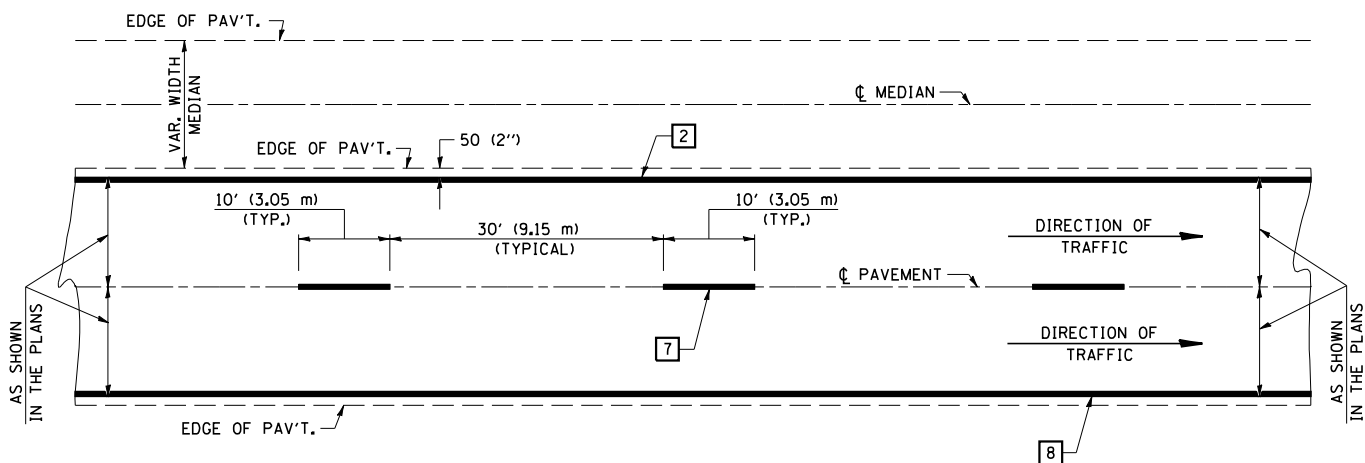

NOTE: PAVEMENT MARKINGS ARE TO BE EXTENDED THROUGH OMISSIONS WHEN APPLICABLE.

NOTE: SEE ARTICLES 780.04 & 781.03 FOR LOCATION OF STRIPES AND MARKERS RELATIVE TO EDGES OR JOINTS.

FOR RAISED REFLECTIVE PAVEMENT MARKERS, REFER TO STANDARD 781001.

TYPICAL EXIT RAMP TERMINAL

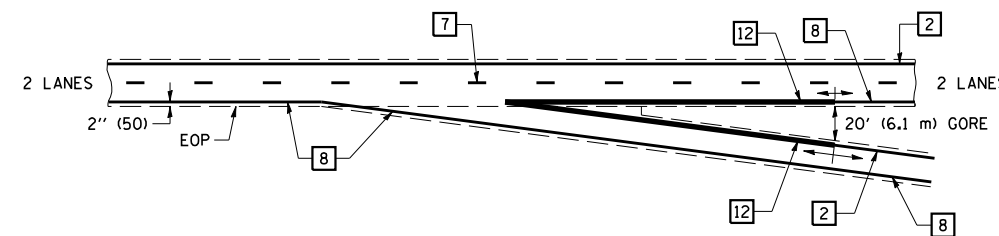

EXIT RAMP TERMINAL with EXCLUSIVE (auxiliary) LANE

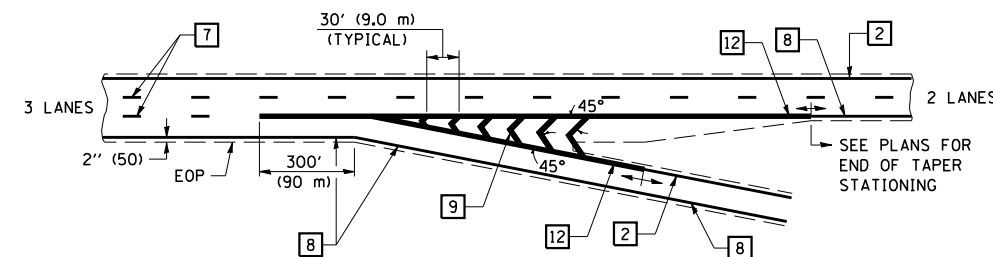

TYPICAL ENTRANCE RAMP TERMINAL

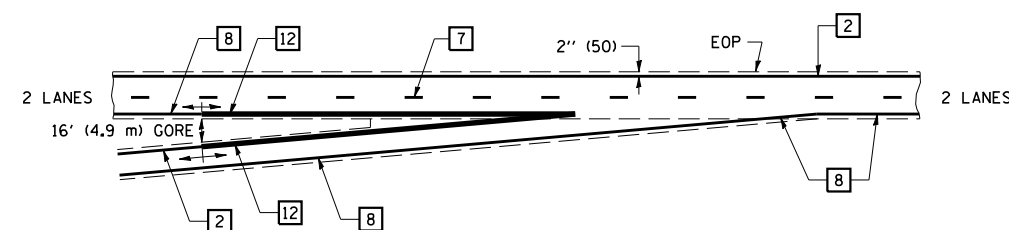

ENTRANCE RAMP TERMINAL with EXCLUSIVE LANE

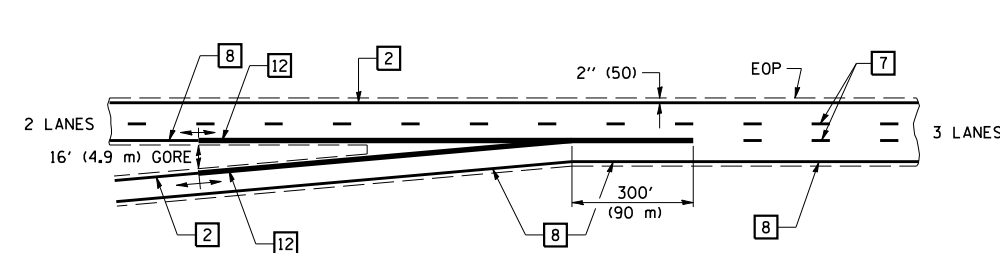

TYPICAL PAVEMENT MARKING LEGEND

- 1 4" (100) SKIP-DASH (YELLOW)
- 2 4" (100) SOLID (YELLOW)
- 3 12" (300) DIAGONAL (YELLOW)
- 4 4" (100) DOUBLE YELLOW (NARROW)
- 5 RESERVED
- 6 RESERVED
- 7 4" (100) SKIP-DASH (WHITE)
- 8 4" (100) SOLID (WHITE)
- 9 12" (300) DIAGONAL (WHITE)
- 10 6" (150) SOLID (WHITE)
- 11 24" (600) STOP BAR (WHITE)
- 12 8" (200) SOLID (WHITE)
- 13 4" (100) LANE LINE EXTENSIONS (WHITE)

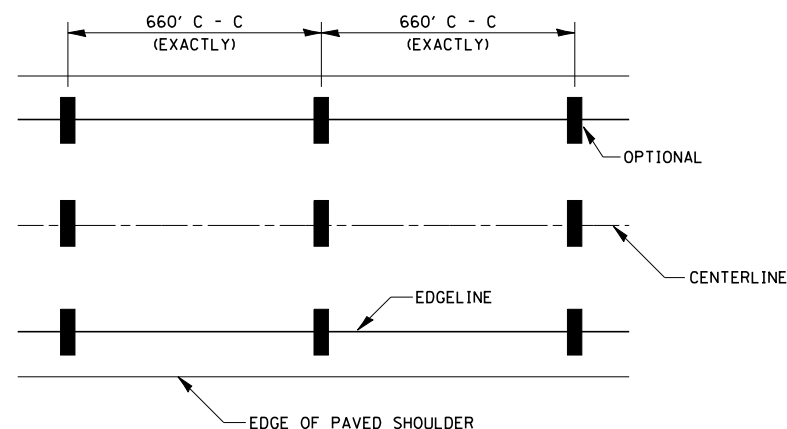
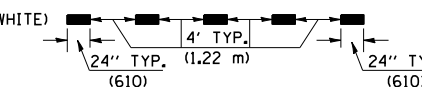
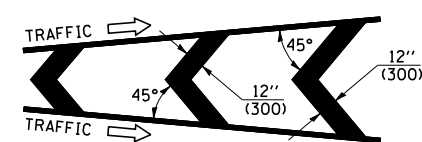
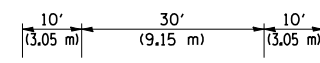
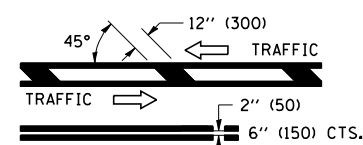
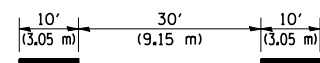

IT WILL BE NECESSARY TO HAVE A REPRESENTATIVE OF THE STATE POLICE PRESENT SO THAT THE ACCURACY OF MEASUREMENT CAN BE ATTESTED TO IN COURT.

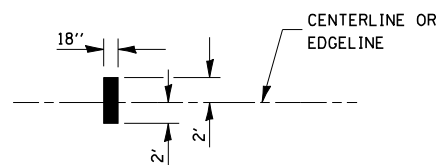

AERIAL SPEED CHECK ZONES

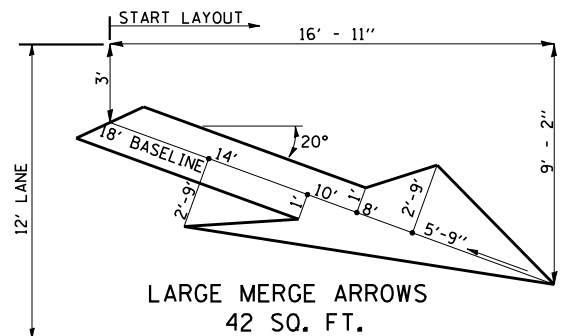

Note: All dimensions are in INCHES (millimeters) unless otherwise shown.

DISTRICT 5 DETAIL NO. 7800BBBB

FILE NAME =	USER NAME = collierbw	DESIGNED -	REVISED - 11/06
ct:\projects\d570705\70705plans.dgn		DRAWN -	REVISED -
		CHECKED -	REVISED -
		DATE -	REVISED -

**STATE OF ILLINOIS
DEPARTMENT OF TRANSPORTATION**

PAVEMENT MARKING (INTERSTATE & MULTI-LANE APPLICATIONS)

SCALE: NA SHEET NO. 1 OF 1 SHEETS STA. TO STA.

F.A.I. RTE.	SECTION	COUNTY	TOTAL SHEETS	SHEET NO.
74	(92-111)	VERMILION	17	17
CONTRACT NO. 70705				
FED. ROAD DIST. NO. ILLINOIS FED. AID PROJECT				