

STATE OF ILLINOIS
 DEPARTMENT OF TRANSPORTATION
 DIVISION OF HIGHWAYS

**PROPOSED
 HIGHWAY PLANS**

F.A.U. ROUTE 7123 (IL 10)
 F.A.S. ROUTE 1514 (IL 10)
 SECTION 09PPP
 CHAMPAIGN COUNTY

C-95-009-08

**MICROSURFACING
 ILL 47 TO STALEY ROAD**

F.A. RTE.	SECTION	COUNTY	TOTAL SHEETS	SHEET NO.
*	OSPPP	CHAMPAIGN	13	1
FED. ROAD DIST. NO.		ILLINOIS	CONTRACT NO. 70722	

* FAU 7123 (IL 10)
 FAS 1514 (IL 10)

D-95-009-08

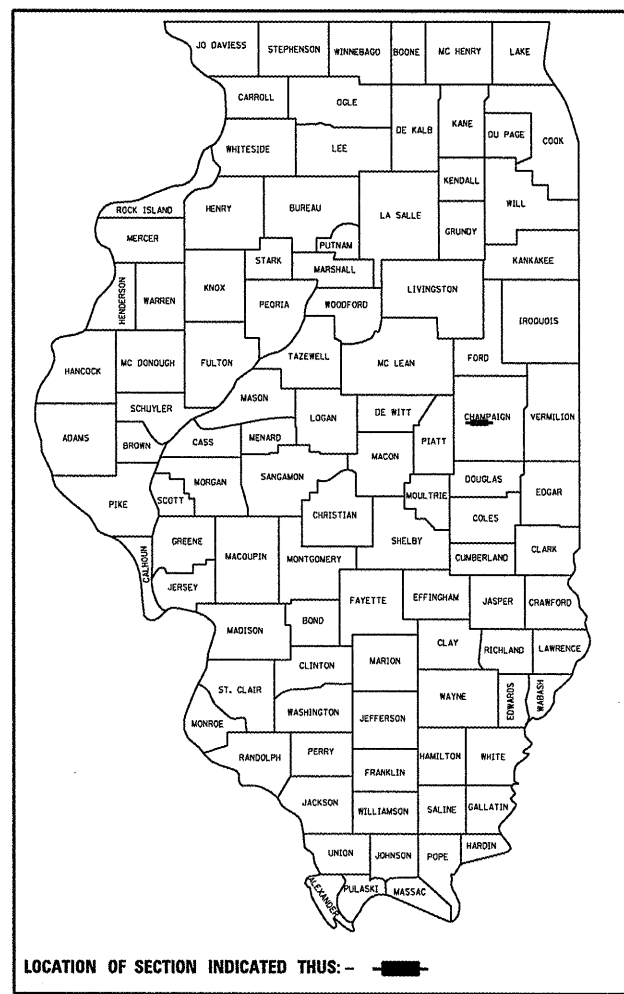

LOCATION OF SECTION INDICATED THUS: - [thick black line] -

FOR INDEX OF SHEETS, SEE SHEET NO. 2
 FOR SUMMARY OF QUANTITIES, SEE SHEET NO. 3

END F.A.U. 7123 STATION 300+19.00
 BEGIN F.A.S. 1514 STATION 300+19.00

END PROJECT (F.A.S. 1514)
 STATION 381+99.11

OMISSION S.N. 010-0248
 STATION 169+49.17 TO
 STATION 170+50.83

BEGIN PROJECT (F.A.U. 7123)
 STATION 143+33.80

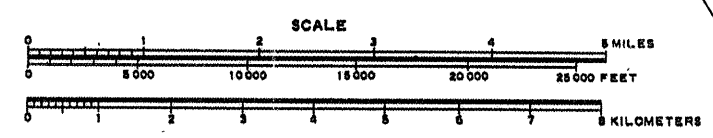
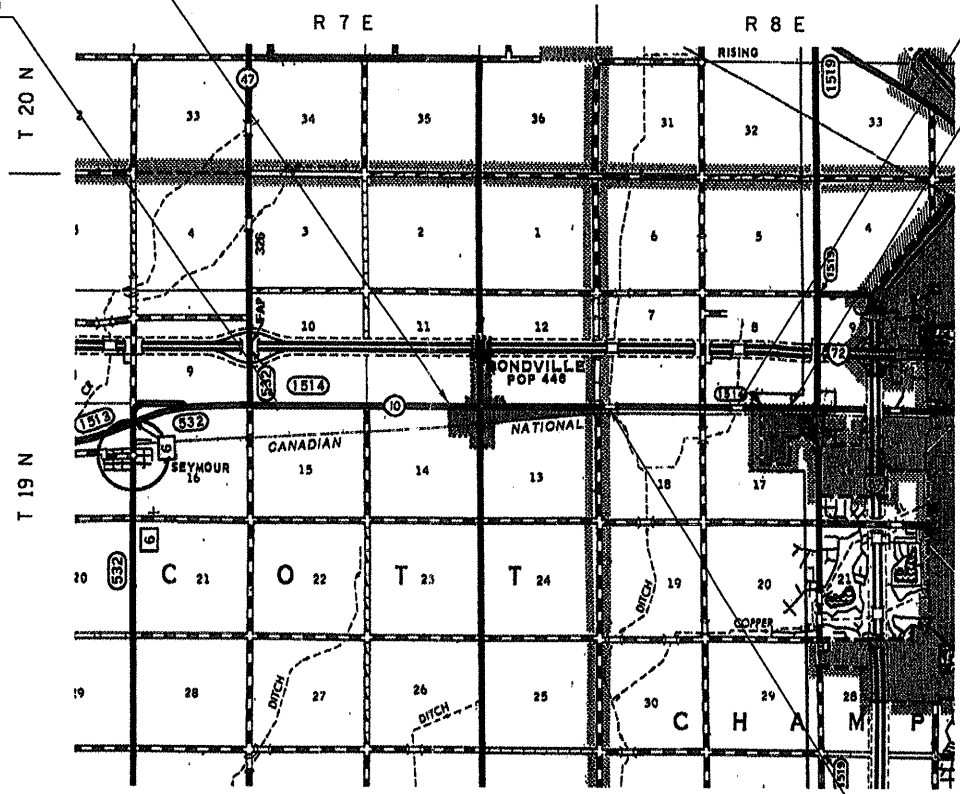

OMISSION S.N. 010-0267
 STATION 226+65.50 TO
 STATION 227+90.50

TOTAL LENGTH OF SECTION & PROJECT = 23,865.31 FEET = 4.520 MILES
 NET LENGTH OF SECTION & PROJECT = 23,638.65 FEET = 4.477 MILES

CURRENT ADT
 3000

DESIGN DESIGNATION
 FAU 7123 - URBAN MINOR COLLECTOR
 FAS 1514 - MAJOR COLLECTOR

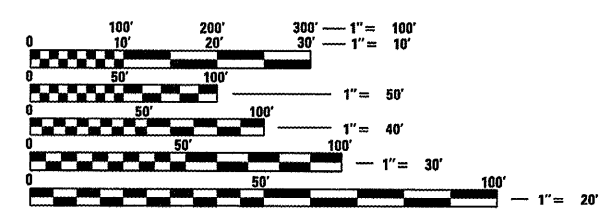

FULL SIZE PLANS HAVE BEEN PREPARED USING STANDARD ENGINEERING SCALES. REDUCED SIZED PLANS WILL NOT CONFORM TO STANDARD SCALES. IN MAKING MEASUREMENTS ON REDUCED PLANS, THE ABOVE SCALES MAY BE USED.

J.U.L.I.E.
 JOINT UTILITY LOCATION INFORMATION FOR EXCAVATION
 1-800-892-0123
 OR 811

PROJECT ENGINEER: KEVIN TRAPP (217)465-4181
 SENIOR SQUAD LEADER: CHRISTOPHER GREESON (217)465-4181

CONTRACT NO. 70722

STATE OF ILLINOIS
 DEPARTMENT OF TRANSPORTATION
 DIVISION OF HIGHWAYS

SUBMITTED MARCH 24 2008

Joseph E. Cooney
 DEPUTY DIRECTOR OF HIGHWAYS, REGION ENGINEER

May 9 2008
Erol E. Harn
 INTERIM ENGINEER OF DESIGN AND ENVIRONMENT

May 9 2008
Christine M. Reed
 DIRECTOR OF HIGHWAYS, CHIEF ENGINEER

**PRINTED BY THE AUTHORITY
 OF THE STATE OF ILLINOIS**