

F.A.I. RTE.	SECTION	COUNTY	TOTAL SHEETS	SHEET NO.
72	(84-9)RS-6; (G)Z	SANGAMON	425	28
STA.		TO STA.		
FED. ROAD DIST. NO.	ILLINOIS	FED. AID PROJECT		

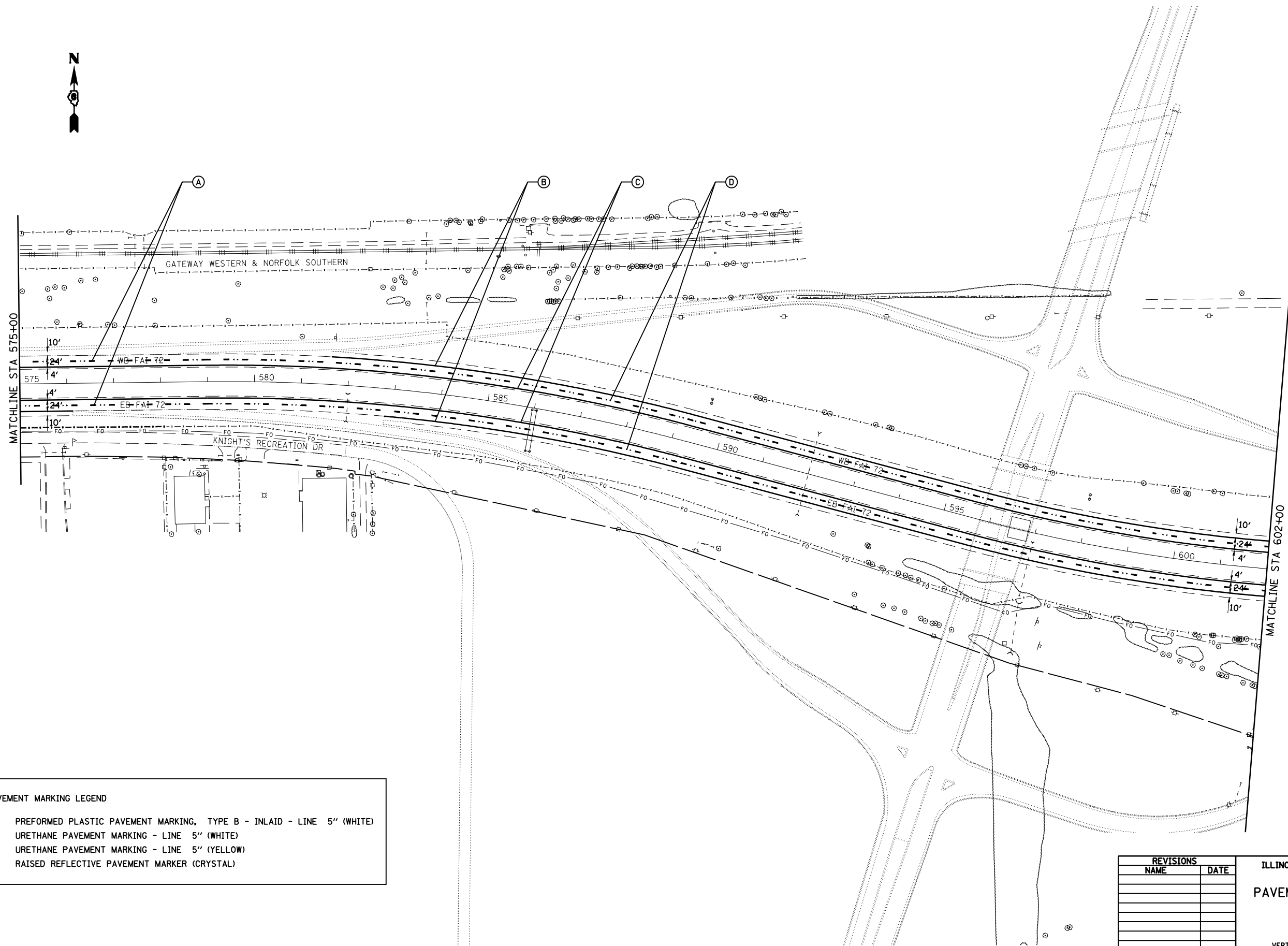

**PAVEMENT MARKING LEGEND**

(A)	PREFORMED PLASTIC PAVEMENT MARKING, TYPE B - INLAID - LINE 5" (WHITE)
(B)	URETHANE PAVEMENT MARKING - LINE 5" (WHITE)
(C)	URETHANE PAVEMENT MARKING - LINE 5" (YELLOW)
(D)	RAISED REFLECTIVE PAVEMENT MARKER (CRYSTAL)

REVISIONS	
NAME	DATE

ILLINOIS DEPARTMENT OF TRANSPORTATION  
**PAVEMENT MARKING PLAN SHEET**  
 FAI 72 (I-72)  
 SECTION (84-9)RS-6; (G)Z  
 SANGAMON COUNTY

SCALE: VERT. \_\_\_\_\_  
 HORIZ. \_\_\_\_\_

DATE \_\_\_\_\_ DRAWN BY \_\_\_\_\_  
 CHECKED BY \_\_\_\_\_

PLOT DATE = Mar-19-2008 11:27:27AM  
 FILE NAME = C:\Projects\48555802\pavmark.dgn  
 PLOT SCALE = 211.7643 / IN.  
 USER NAME = laughlinr1