

FAU ROUTE	SECTION	COUNTY	TOTAL SHEETS	SHEET NO.
8071	*	SANGAMON	425	109
STA.		TO STA.		
FED. ROAD DIST. NO.	ILLINOIS	FED. AID PROJECT		
(84-9) RS-6; (G)Z *				

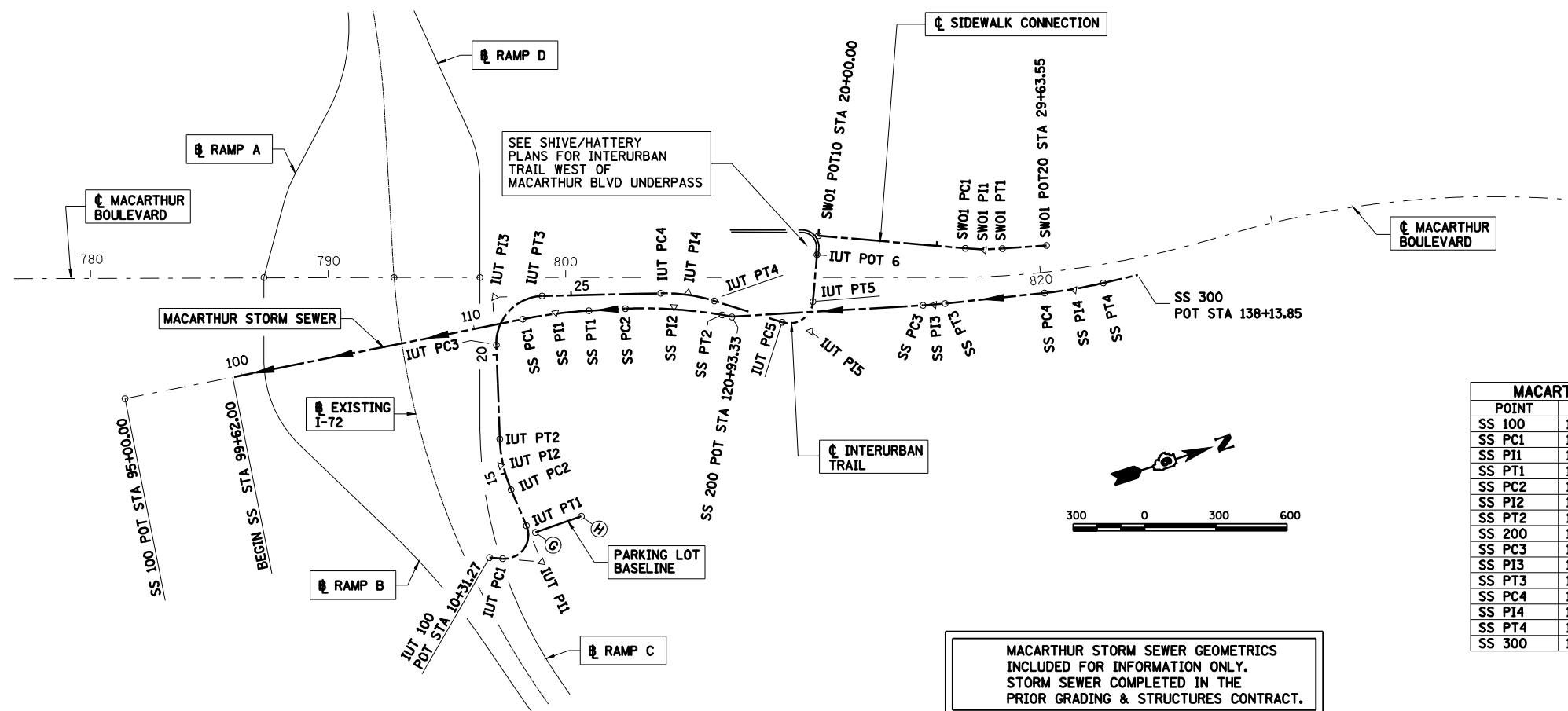

SIDEWALK CONNECTION

PROP. CURVE SW01

SW01 PI1	PI STA. = 26+99.45
	$\Delta = 8^\circ 55' 23''$ (LT)
	D = 5° 42' 35"
	R = 1,003.50'
	T = 78.30'
	L = 156.28'
	E = 3.05'
SW01 PC1	P.C. STA. = 26+21.15
SW01 PT1	P.T. STA. = 27+77.44

MACARTHUR STORM SEWER

POINT	NORTHING	EASTING
SS 100	1118695.205	2435735.762
SS PC1	1120391.132	2435939.851
SS PI1	1120530.614	2435956.636
SS PT1	1120666.379	2435992.756
SS PC2	1120815.009	2436032.298
SS PI2	1121012.217	2436088.973
SS PT2	1121193.808	2436184.512
SS 200	1121230.888	2436204.020
SS PC3	1122010.215	2436409.782
SS PI3	1122055.442	2436421.723
SS PT3	1122101.178	2436431.537
SS PC4	1122512.773	2436519.854
SS PI4	1122635.695	2436546.229
SS PT4	1122760.952	2436557.004
SS 300	1122909.290	2436569.765

SIDEWALK CONNECTION

POINT	NORTHING	EASTING
SW01 POT10	1121682.869	2435993.692
SW01 PC1	1122254.346	2436237.094
SW01 PI1	1122326.384	2436267.776
SW01 PT1	1122402.309	2436286.914
SW01 POT20	1122582.780	2436332.402

INTERURBAN TRAIL

POINT	NORTHING	EASTING
IUT 100	1119944.742	2436850.155
IUT PC1	1119995.596	2436871.688
IUT PI1	1120148.406	2436936.390
IUT PT1	1120134.221	2436771.054
IUT PC2	1120120.117	2436606.665
IUT PI2	1120110.625	2436496.028
IUT PT2	1120141.357	2436389.322
IUT PC3	1120250.882	2436009.034
IUT PI3	1120307.022	2435814.109
IUT PT3	1120501.134	2435872.999
IUT PC4	1120976.531	2436017.227
IUT PI4	1121087.062	2436050.760
IUT PT4	1121180.960	2436118.026
IUT PC5	1121424.443	2436292.449
IUT PI5	1121525.642	2436364.945
IUT PT5	1121574.616	2436250.497
IUT POT 6	1121652.650	2436068.137

MACARTHUR STORM SEWER GEOMETRICS INCLUDED FOR INFORMATION ONLY. STORM SEWER COMPLETED IN THE PRIOR GRADING & STRUCTURES CONTRACT.

PROP. CURVE IUT-1

IUT PI1	PI STA. = 12+52.44
	$\Delta = 117^\circ 51' 09''$ (LT)
	D = 57° 17' 45"
	R = 100.00'
	T = 165.94'
	L = 205.69'
	E = 93.75'
IUT PC1	P.C. STA. = 10+86.50
IUT PT1	P.T. STA. = 12+92.19

PROP. CURVE IUT-2

IUT PI2	PI STA. = 15+68.22
	$\Delta = 20^\circ 58' 14''$ (RT)
	D = 9° 32' 57"
	R = 600.00'
	T = 111.04'
	L = 219.60'
	E = 10.19'
IUT PC2	P.C. STA. = 14+57.18
IUT PT2	P.T. STA. = 16+76.78

PROP. CURVE IUT-3

IUT PI3	PI STA. = 22+75.38
	$\Delta = 90^\circ 48' 37''$ (RT)
	D = 28° 38' 52"
	R = 200.00'
	T = 202.85'
	L = 316.99'
	E = 84.86'
IUT PC3	P.C. STA. = 20+72.53
IUT PT3	P.T. STA. = 23+89.51

PROP. CURVE IUT-4

IUT PI4	PI STA. = 30+01.81
	$\Delta = 18^\circ 44' 23''$ (RT)
	D = 8° 11' 06"
	R = 700.00'
	T = 115.51'
	L = 228.95'
	E = 9.47'
IUT PC4	P.C. STA. = 28+86.31
IUT PT4	P.T. STA. = 31+15.26

PROP. CURVE IUT-5

IUT PI5	PI STA. = 35+39.26
	$\Delta = 102^\circ 27' 00''$ (LT)
	D = 57° 17' 45"
	R = 100.00'
	T = 124.49'
	L = 178.81'
	E = 59.68'
IUT PC5	P.C. STA. = 34+14.77
IUT PT5	P.T. STA. = 35+93.58

PROP. CURVE SS 1

SS PI1	PI STA. = 113+48.65
	$\Delta = 8^\circ 02' 10''$ (RT)
	D = 2° 51' 53"
	R = 2,000.00'
	T = 140.49'
	L = 280.52'
	E = 4.93'
SS PC1	P.C. STA. = 112+08.16
SS PT1	P.T. STA. = 114+88.68

PROP. CURVE SS 2

SS PI2	PI STA. = 118+47.67
	$\Delta = 11^\circ 42' 56''$ (RT)
	D = 2° 51' 53"
	R = 2,000.00'
	T = 205.19'
	L = 408.95'
	E = 10.50'
SS PC2	P.C. STA. = 116+42.48
SS PT2	P.T. STA. = 120+51.43

PROP. CURVE SS 3

SS PI3	PI STA. = 129+46.14
	$\Delta = 2^\circ 40' 47''$ (LT)
	D = 2° 51' 53"
	R = 2,000.00'
	T = 46.78'
	L = 93.54'
	E = 0.55'
SS PC3	P.C. STA. = 128+99.36
SS PT3	P.T. STA. = 129+92.90

PROP. CURVE SS 4

SS PI4	PI STA. = 135+39.58
	$\Delta = 7^\circ 11' 37''$ (LT)
	D = 2° 51' 53"
	R = 2,000.00'
	T = 125.72'
	L = 251.11'
	E = 3.95'
SS PC4	P.C. STA. = 134+13.86
SS PT4	P.T. STA. = 136+64.97

PARKING LOT

POINT	NORTHING	EASTING
G	1120161.498	2436809.815
H	1120366.451	2436805.423

REVISIONS

NAME	DATE

ILLINOIS DEPARTMENT OF TRANSPORTATION
 CENTERLINE GEOMETRICS MISC.
 FAI-72, MACARTHUR BLVD
 SECTION
 (84-9) RS-6; (G)Z
 SANGAMON COUNTY, ILLINOIS

SCALE: VERT. _____
 HORIZ. _____
 DATE: Mar-20-2008 08:25:52AM
 DRAWN BY: CLG
 CHECKED BY: SKM