

FAU ROUTE	SECTION	COUNTY	TOTAL SHEETS	SHEET NO.
8071	*	SANGAMON	425	143

STA. TO STA.
FED. ROAD DIST. NO. ILLINOIS FED. AID PROJECT
(84-9) RS-6; IGIZ *

STA 58+00.63
RAMP C =
STA. 796+39.03
MACARTHUR BLVD

PLAN	DATE	BY



PROFILE	DATE	BY

LAYOUT	DATE	BY

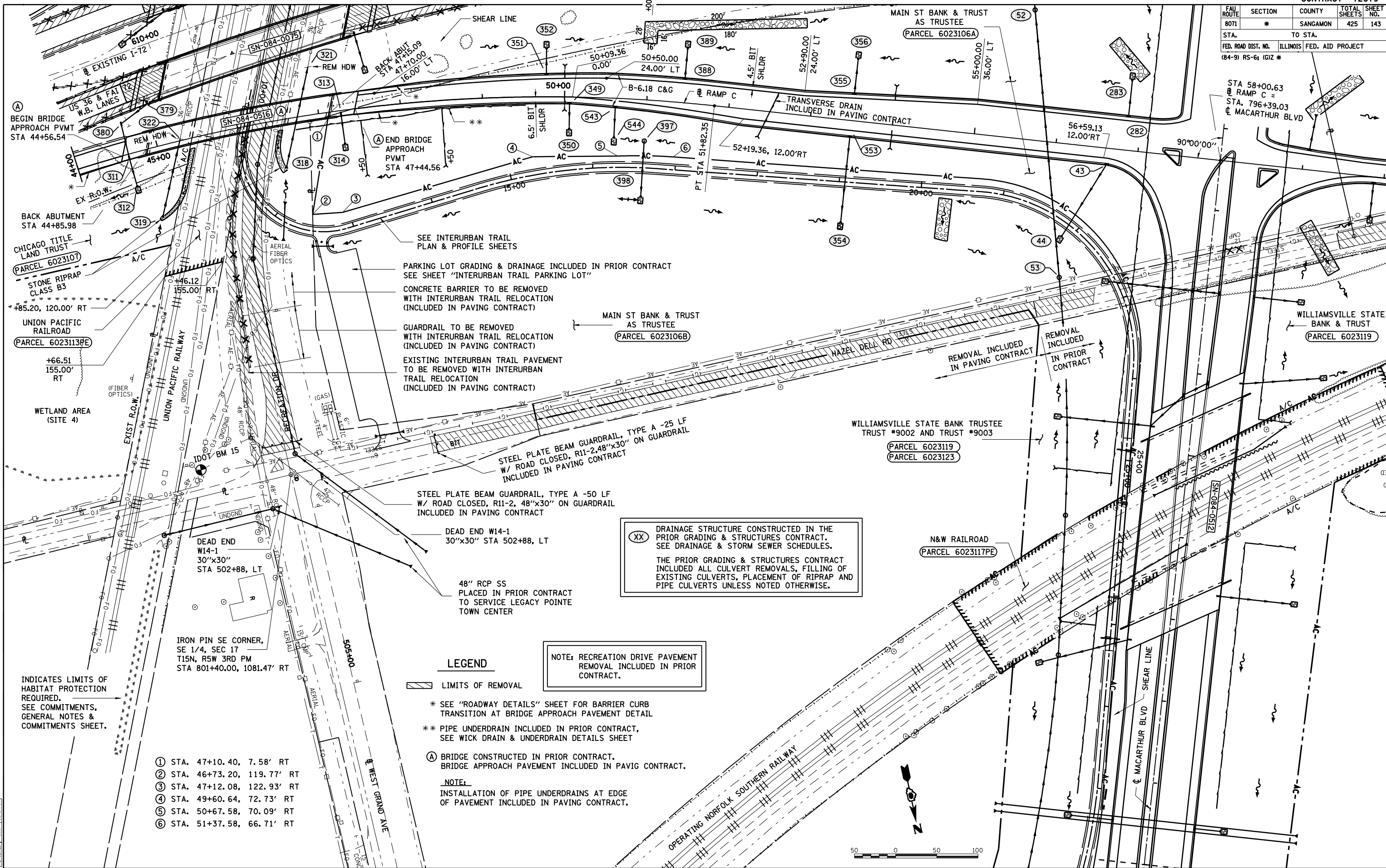

SEE INTERURBAN TRAIL PLAN & PROFILE SHEETS

PARKING LOT GRADING & DRAINAGE INCLUDED IN PRIOR CONTRACT SEE SHEET "INTERURBAN TRAIL PARKING LOT"

CONCRETE BARRIER TO BE REMOVED WITH INTERURBAN TRAIL RELOCATION (INCLUDED IN PAVING CONTRACT)

GUARDRAIL TO BE REMOVED WITH INTERURBAN TRAIL RELOCATION (INCLUDED IN PAVING CONTRACT)

EXISTING INTERURBAN TRAIL PAVEMENT TO BE REMOVED WITH INTERURBAN TRAIL RELOCATION (INCLUDED IN PAVING CONTRACT)

STEEL PLATE BEAM GUARDRAIL, TYPE A -25 LF W/ ROAD CLOSED, R11-2.48"x30" ON GUARDRAIL INCLUDED IN PAVING CONTRACT

STEEL PLATE BEAM GUARDRAIL, TYPE A -50 LF W/ ROAD CLOSED, R11-2.48"x30" ON GUARDRAIL INCLUDED IN PAVING CONTRACT

DEAD END W14-1 30"x30" STA 502+88, LT

48" RCP SS PLACED IN PRIOR CONTRACT TO SERVICE LEGACY POINTE TOWN CENTER

(XX) DRAINAGE STRUCTURE CONSTRUCTED IN THE PRIOR GRADING & STRUCTURES CONTRACT. SEE DRAINAGE & STORM SEWER SCHEDULES.

THE PRIOR GRADING & STRUCTURES CONTRACT INCLUDED ALL CULVERT REMOVALS, FILLING OF EXISTING CULVERTS, PLACEMENT OF RIPRAP AND PIPE CULVERTS UNLESS NOTED OTHERWISE.

NOTE: RECREATION DRIVE PAVEMENT REMOVAL INCLUDED IN PRIOR CONTRACT.

LEGEND

- LIMITS OF REMOVAL
- * SEE "ROADWAY DETAILS" SHEET FOR BARRIER CURB TRANSITION AT BRIDGE APPROACH PAVEMENT DETAIL
- ** PIPE UNDERDRAIN INCLUDED IN PRIOR CONTRACT, SEE WICK DRAIN & UNDERDRAIN DETAILS SHEET
- (A) BRIDGE CONSTRUCTED IN PRIOR CONTRACT. BRIDGE APPROACH PAVEMENT INCLUDED IN PAVING CONTRACT.

NOTE: INSTALLATION OF PIPE UNDERDRAINS AT EDGE OF PAVEMENT INCLUDED IN PAVING CONTRACT.

- ① STA. 47+10.40, 7.58' RT
- ② STA. 46+73.20, 119.77' RT
- ③ STA. 47+12.08, 122.93' RT
- ④ STA. 49+60.64, 72.73' RT
- ⑤ STA. 50+67.58, 70.09' RT
- ⑥ STA. 51+37.58, 66.71' RT

INDICATES LIMITS OF HABITAT PROTECTION REQUIRED. SEE COMMITMENTS, GENERAL NOTES & COMMITMENTS SHEET.

