

FAU ROUTE	SECTION	COUNTY	TOTAL SHEETS	SHEET NO.
8071	*	SANGAMON	425	184
STA.		TO STA.		
FED. ROAD DIST. NO.		ILLINOIS FED. AID PROJECT		
(84-9) RS-6; (G)Z *				

CENTER ACCESS AT MACARTHUR BLVD						
	STATION	OFFSET	CL OR B	NORTHING	EASTING	ELEVATION
AA	701+73.00	-42.00	CA	1123815.465	2436398.680	605.61
AB	701+54.77	-42.00	CA	1123812.615	2436416.682	605.67
AC	701+36.77	-42.00	CA	1123809.801	2436434.465	605.79
AD	701+19.71	-42.00	CA	1123807.134	2436451.312	605.97
AE	701+19.71	-43.97	CA	1123805.193	2436451.004	605.93
AF	701+03.77	-49.65	CA	1123797.088	2436465.860	606.27
AG	700+90.61	-57.89	CA	1123786.895	2436477.570	606.70
AH	832+50.60	-81.51	MAC	1123776.797	2436485.493	606.95
AI	832+29.94	-68.45	MAC	1123754.117	2436495.449	607.26
AJ	832+01.71	-58.85	MAC	1123724.399	2436501.080	607.36
AK	831+72.00	-52.94	MAC	1123693.763	2436503.082	607.37
AL	831+42.20	-51.00	MAC	1123663.565	2436501.368	607.31
AM	700+90.23	-22.00	CA	1123822.279	2436483.561	606.93
AN	832+83.89	-68.01	MAC	1123808.334	2436503.857	607.43
AO	832+73.78	-55.00	MAC	1123796.223	2436515.172	607.66
AP	832+39.71	-39.00	MAC	1123759.800	2436525.993	607.88
AQ	832+01.71	-27.00	MAC	1123720.203	2436532.653	607.99
BA	701+73.00	37.23	CA	1123893.724	2436411.067	605.91
BB	701+54.78	36.00	CA	1123889.656	2436428.875	606.00
BC	701+54.78	39.57	CA	1123893.182	2436429.433	605.93
BD	701+36.77	36.00	CA	1123886.842	2436446.658	606.12
BE	701+36.77	43.24	CA	1123893.989	2436447.790	605.98
BF	701+19.71	36.00	CA	1123884.175	2436463.505	606.30
BG	834+40.08	-51.00	MAC	1123961.586	2436547.771	608.32
BH	700+98.54	36.00	CA	1123880.866	2436484.415	606.82
BI	700+71.92	36.00	CA	1123876.704	2436510.712	607.55
BJ	700+65.15	36.00	CA	1123875.645	2436517.402	607.74
BK	833+51.55	-51.00	MAC	1123873.387	2436531.664	608.02
BL	700+71.92	44.00	CA	1123884.605	2436511.963	607.55
BM	700+65.15	44.00	CA	1123883.546	2436518.652	607.76
BN	833+59.45	-51.00	MAC	1123881.272	2436533.022	608.05
BO	700+71.92	48.00	CA	1123888.556	2436512.589	607.55
BP	833+72.67	-64.53	MAC	1123896.810	2436522.003	607.77
BQ	833+90.78	-55.00	MAC	1123913.226	2436534.624	608.03
BR	833+90.78	-51.00	MAC	1123912.512	2436538.560	608.15
BS	701+19.71	48.01	CA	1123896.042	2436465.384	606.18
BT	701+07.20	53.13	CA	1123899.140	2436478.544	606.50
BU	833+80.52	-89.14	MAC	1123908.995	2436499.171	607.20
BV	833+88.29	-81.77	MAC	1123915.498	2436507.827	607.42
BW	834+00.67	-73.27	MAC	1123926.392	2436518.457	607.70
BX	834+40.08	-63.00	MAC	1123963.873	2436535.991	608.08
CA	701+73.00	-18.00	CA	1123839.169	2436402.432	606.09
CB	701+73.00	-6.00	CA	1123851.022	2436404.308	606.33
CC	701+54.77	-18.00	CA	1123836.320	2436420.434	606.15
CD	701+54.78	-6.00	CA	1123848.173	2436422.309	606.39
CE	701+36.77	-18.00	CA	1123833.506	2436438.216	606.27
CF	701+36.77	-6.00	CA	1123845.358	2436440.092	606.51
CG	701+19.71	-18.00	CA	1123830.839	2436455.063	606.45
CH	701+19.71	-6.00	CA	1123842.692	2436456.939	606.69
CI	700+90.23	-18.00	CA	1123826.230	2436484.186	607.02
CJ	700+90.23	-6.00	CA	1123838.082	2436486.062	607.17
CK	700+65.15	-6.00	CA	1123834.161	2436510.836	607.62
CL	700+65.15	-18.00	CA	1123822.309	2436508.960	607.56
CM	832+73.78	-51.00	MAC	1123795.625	2436519.127	607.76
CN	832+98.23	-51.00	MAC	1123820.101	2436522.906	607.84
CO	833+10.08	-51.00	MAC	1123831.952	2436524.791	607.88
DA	701+73.00	6.00	CA	1123862.874	2436406.184	606.51
DB	701+73.00	12.00	CA	1123868.801	2436407.122	606.42
DC	701+73.00	24.00	CA	1123880.653	2436408.998	606.18
DD	701+54.78	6.00	CA	1123860.025	2436424.185	606.57
DE	701+54.78	24.00	CA	1123877.804	2436426.999	606.24
DF	701+36.77	6.00	CA	1123857.211	2436441.968	606.69
DG	701+36.77	24.00	CA	1123874.989	2436444.782	606.36
DH	701+19.71	6.00	CA	1123854.544	2436458.815	606.87
DI	701+19.71	12.00	CA	1123860.470	2436459.753	606.78
DJ	701+19.71	24.00	CA	1123872.323	2436461.629	606.54
DK	700+98.54	6.00	CA	1123851.235	2436479.725	607.15
DL	700+98.54	12.00	CA	1123857.161	2436480.663	607.10
DM	700+98.54	24.00	CA	1123869.013	2436482.539	606.95
DN	700+65.15	6.00	CA	1123846.014	2436512.712	607.69
DO	700+65.15	12.00	CA	1123851.940	2436513.650	607.69
DP	700+65.15	24.00	CA	1123863.792	2436515.526	607.70
DR	833+27.86	-51.00	MAC	1123849.719	2436527.684	607.94
DS	833+21.93	-51.00	MAC	1123843.798	2436526.711	607.92
DT	833+39.70	-51.00	MAC	1123861.556	2436529.656	607.98

CENTER ACCESS AT MACARTHUR BLVD						
	STATION	OFFSET	CL OR B	NORTHING	EASTING	ELEVATION
DU	700+79.89	6.00	CA	1123848.318	2436498.150	607.45
DV	700+79.47	9.95	CA	1123852.158	2436499.187	607.44
EA	832+39.71	-15.00	MAC	1123756.413	2436549.753	608.36
EB	832+39.71	-9.00	MAC	1123755.565	2436555.693	608.45
EC	833+55.97	-15.00	MAC	1123871.678	2436567.897	608.76
ED	833+52.72	-6.20	MAC	1123866.982	2436576.019	608.88
EE	834+40.08	-15.00	MAC	1123954.727	2436583.112	609.04
EF	834+40.08	15.00	MAC	1123949.011	2436612.562	609.04
EG	834+10.17	15.00	MAC	1123919.729	2436606.993	608.94
EI	833+16.20	0.00	MAC	1123829.903	2436576.120	608.85

OFFSET (-00.00) = LEFT & (00.00) = RIGHT
 MAC = MACARTHUR BLVD
 CA = CENTER ACCESS

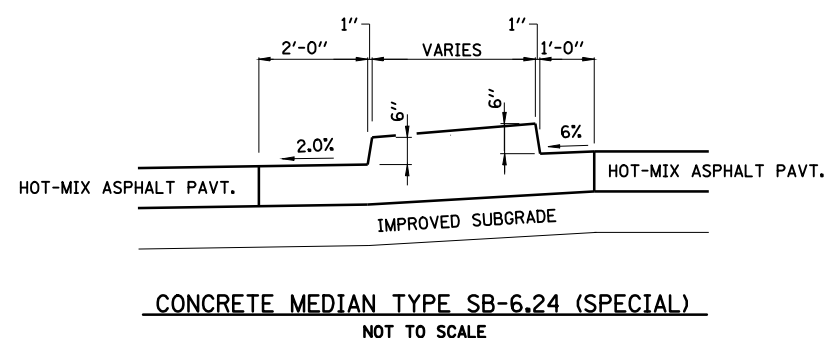
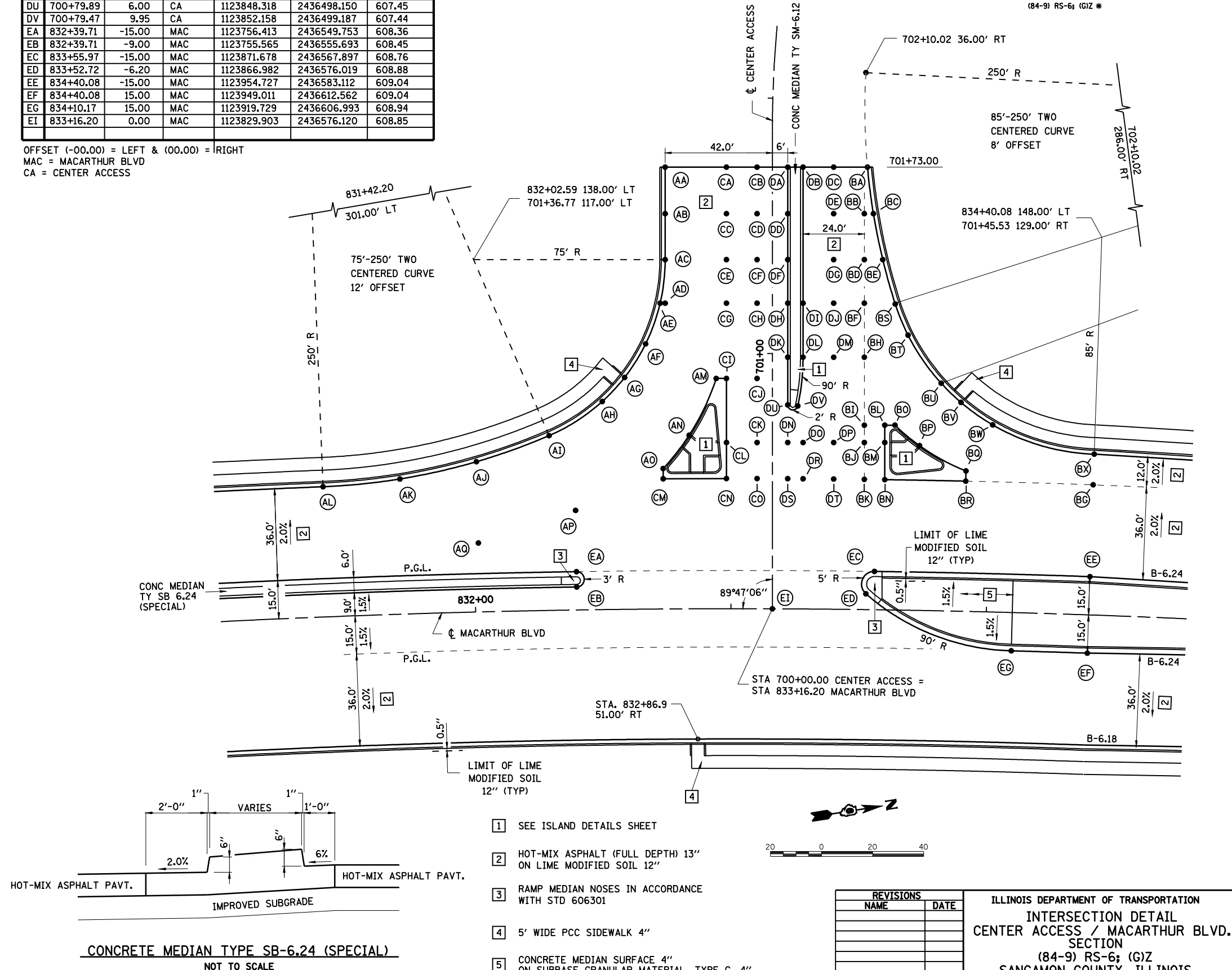

- 1 SEE ISLAND DETAILS SHEET
- 2 HOT-MIX ASPHALT (FULL DEPTH) 13" ON LIME MODIFIED SOIL 12"
- 3 RAMP MEDIAN NOSES IN ACCORDANCE WITH STD 606301
- 4 5' WIDE PCC SIDEWALK 4"
- 5 CONCRETE MEDIAN SURFACE 4" ON SUBBASE GRANULAR MATERIAL, TYPE C, 4"

REVISIONS	
NAME	DATE

ILLINOIS DEPARTMENT OF TRANSPORTATION
 INTERSECTION DETAIL
 CENTER ACCESS / MACARTHUR BLVD.
 SECTION
 (84-9) RS-6; (G)Z
 SANGAMON COUNTY, ILLINOIS
 SCALE: VERT. _____
 HORIZ. _____
 DATE Mar-20-2008 09:34:47AM
 DRAWN BY CLG
 CHECKED BY JAD

LAYOUT: CLG 09/17/07
 DRAWN: CLG 09/17/07
 REVIEWED: JMM 03/12/08
 Mar-20-2008 09:34:47AM
 #FILES