

FAU ROUTE	SECTION	COUNTY	TOTAL SHEETS	SHEET NO.
8071	*	SANGAMON	425	186
STA. 8071		TO STA. 8072		
FED. ROAD DIST. NO.		ILLINOIS FED. AID PROJECT		
(84-9) RS-6; (G)Z *				

WESTCHESTER BLVD AT MACARTHUR BLVD						
STATION	OFFSET	CL OR B	NORTHING	EASTING	ELEVATION	
AA	850+66.64	-45.00	MAC	1125516.822	2437014.941	606.38
AB	850+89.56	-45.96	MAC	1125539.296	2437018.019	606.29
AC	851+12.72	-48.92	MAC	1125562.344	2437019.047	606.16
AD	851+35.55	-53.84	MAC	1125585.389	2437017.946	606.00
AE	851+57.53	-60.56	MAC	1125607.854	2437014.797	605.70
AF	504+15.98	59.37	WC	1125629.164	2437006.363	605.15
AG	504+09.12	50.01	WC	1125638.285	2436999.199	604.92
AH	504+01.18	42.60	WC	1125645.431	2436991.010	604.62
AI	503+83.83	33.24	WC	1125654.213	2436973.364	604.35
AJ	503+64.39	30.00	WC	1125656.803	2436953.824	604.21
AK	851+63.16	-45.00	MAC	1125610.887	2437031.033	606.09
AL	851+98.27	-49.00	MAC	1125645.797	2437032.368	605.87
AM	504+31.72	31.40	WC	1125657.642	2437021.170	605.54
AN	504+17.16	22.00	WC	1125666.551	2437006.305	605.12
AO	504+01.18	18.00	WC	1125670.018	2436990.193	604.90
AP	503+83.83	18.00	WC	1125669.442	2436972.858	604.65
AQ	503+64.39	18.00	WC	1125668.796	2436953.426	604.45
BA	503+25.00	-26.80	WC	1125712.263	2436912.572	604.48
BB	503+44.50	-29.14	WC	1125715.246	2436931.984	604.40
BC	503+64.39	-33.15	WC	1125719.918	2436951.727	604.36
BD	503+83.83	-38.75	WC	1125726.156	2436970.973	604.40
BE	503+97.29	-43.65	WC	1125731.502	2436984.259	604.50
BG	504+15.27	-53.63	WC	1125742.079	2437001.901	604.72
BH	504+27.21	-64.46	WC	1125753.299	2437013.473	604.90
BI	853+28.41	-69.44	MAC	1125775.579	2437029.021	605.11
BJ	853+58.78	-60.14	MAC	1125804.229	2437041.612	605.20
BK	853+90.38	-57.00	MAC	1125834.868	2437047.984	605.17
BL	504+28.28	-36.00	WC	1125724.886	2437015.494	605.16
BM	504+43.44	-49.43	WC	1125738.819	2437030.199	605.34
BN	853+19.60	-49.00	MAC	1125764.571	2437048.310	605.54
BO	853+55.66	-45.00	MAC	1125799.521	2437056.329	605.51
BP	853+90.38	-45.00	MAC	1125833.663	2437059.924	605.41
CA	503+05.32	30.00	WC	1125654.842	2436894.786	604.30
CB	503+05.32	18.00	WC	1125666.835	2436894.388	604.54
CC	503+83.83	-6.00	WC	1125693.429	2436972.061	604.96
CD	503+05.32	6.00	WC	1125678.828	2436893.989	604.78
CE	503+05.32	-6.00	WC	1125690.822	2436893.591	604.96
CF	503+05.32	-12.00	WC	1125696.818	2436893.391	604.87
CG	503+05.03	-26.00	WC	1125710.801	2436892.635	604.59
CH	503+25.00	30.00	WC	1125655.495	2436914.458	604.21
CI	503+25.00	18.00	WC	1125667.488	2436914.060	604.45
CJ	503+25.00	6.00	WC	1125679.482	2436913.661	604.69
CK	503+25.00	-6.00	WC	1125691.475	2436913.263	604.87
CL	503+25.00	-12.00	WC	1125697.472	2436913.063	604.78
CM	503+44.50	30.00	WC	1125656.143	2436933.947	604.17
CN	503+44.50	18.00	WC	1125668.136	2436933.549	604.41
CO	503+44.50	6.00	WC	1125680.129	2436933.150	604.65
CP	503+44.50	-6.00	WC	1125692.123	2436932.752	604.83
CQ	503+44.50	-12.00	WC	1125698.119	2436932.553	604.74
CR	503+44.50	-26.00	WC	1125712.112	2436932.088	604.46
CS	503+64.39	6.00	WC	1125680.790	2436953.027	604.69
CT	503+64.39	-6.00	WC	1125692.783	2436952.629	604.87
CU	503+64.39	-12.00	WC	1125698.780	2436952.430	604.78
CV	503+64.39	-26.00	WC	1125712.772	2436951.965	604.50
DA	851+84.93	-9.00	MAC	1125626.712	2437069.935	606.75
DB	851+84.93	-3.00	MAC	1125625.803	2437075.866	606.93
DC	851+98.27	-45.00	MAC	1125645.205	2437036.324	605.99
DD	852+25.34	-45.00	MAC	1125671.680	2437040.196	605.90
DE	852+37.66	-45.00	MAC	1125683.743	2437041.899	605.87
DF	852+49.97	-45.00	MAC	1125695.805	2437043.565	605.83
DG	852+56.13	-45.00	MAC	1125701.835	2437044.383	605.81
DH	852+70.48	-45.00	MAC	1125715.905	2437046.256	605.77
DI	852+76.63	-45.00	MAC	1125721.932	2437047.042	605.75
DJ	853+00.35	-9.00	MAC	1125740.781	2437085.718	606.40
DK	852+98.25	0.54	MAC	1125737.529	2437094.927	606.53
DL	853+19.60	-45.00	MAC	1125764.099	2437052.282	605.62
DM	853+36.71	9.00	MAC	1125774.757	2437107.892	606.29
DN	852+08.13	-9.00	MAC	1125649.601	2437073.371	606.68
DO	852+08.14	0.00	MAC	1125648.305	2437082.277	606.81
DP	852+08.16	9.00	MAC	1125647.008	2437091.184	606.68
EA	503+83.83	6.00	WC	1125681.435	2436972.459	604.83
EB	503+83.83	-12.00	WC	1125699.426	2436971.861	604.90
EC	503+83.83	-26.00	WC	1125713.418	2436971.397	604.66
ED	504+01.18	-6.00	WC	1125694.005	2436989.396	605.11
EE	503+94.04	-12.00	WC	1125699.765	2436982.070	604.99
EF	504+01.17	6.00	WC	1125682.011	2436989.794	605.02

WESTCHESTER BLVD AT MACARTHUR BLVD						
STATION	OFFSET	CL OR B	NORTHING	EASTING	ELEVATION	
EJ	504+17.16	18.00	WC	1125670.549	2437006.172	605.18
EK	504+11.19	-6.00	WC	1125694.338	2436999.406	605.23
EL	504+11.48	-10.98	WC	1125699.327	2436999.531	605.20
EM	504+01.18	-26.00	WC	1125713.994	2436988.732	604.87
EN	504+19.99	-26.00	WC	1125714.619	2437007.536	605.16
EO	504+19.99	6.00	WC	1125682.636	2437008.599	605.30
EP	504+19.99	-6.00	WC	1125694.630	2437008.201	605.34
EQ	504+19.99	-12.00	WC	1125700.626	2437008.001	605.31
ES	504+35.22	18.00	WC	1125671.149	2437024.221	605.59
ET	504+39.43	-12.00	WC	1125701.272	2437027.432	605.60
EU	504+28.28	-32.00	WC	1125720.888	2437015.627	605.22
EV	504+36.91	6.00	WC	1125683.198	2437025.506	605.58
EX	504+38.59	-6.00	WC	1125695.247	2437026.790	605.61
EY	504+41.40	-26.00	WC	1125715.329	2437028.930	605.54
EZ	504+42.24	-32.00	WC	1125721.351	2437029.573	605.44

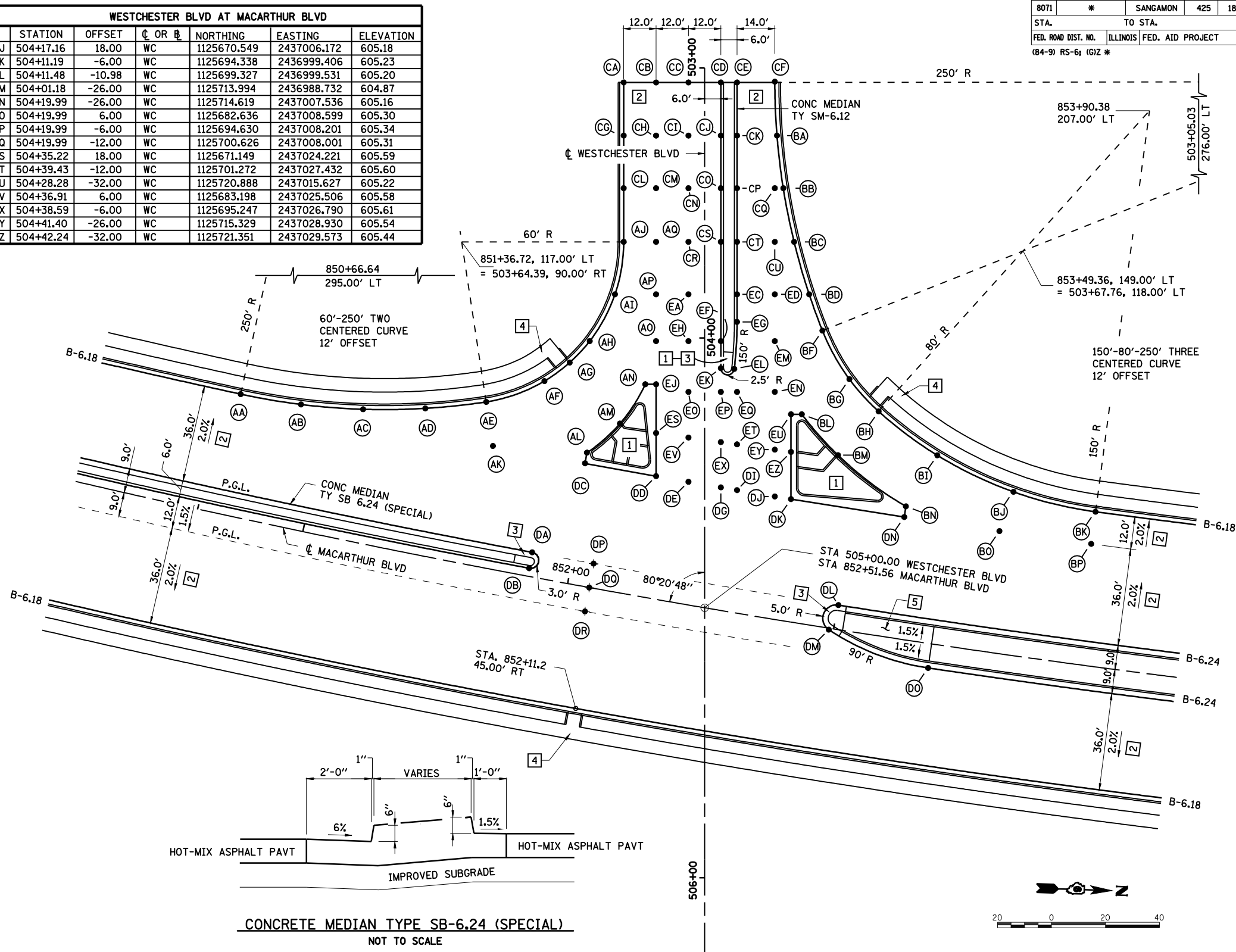

- 1 SEE ISLAND DETAILS SHEET
- 2 HOT-MIX ASPHALT (FULL DEPTH) 13" ON LIME MODIFIED SOIL 12"
- 3 RAMP MEDIAN NOSES IN ACCORDANCE WITH STD 606301
- 4 5' WIDE PCC SIDEWALK 4"
- 5 CONCRETE MEDIAN SURFACE 4" ON SUBBASE GRANULAR MATERIAL, TYPE C, 4"

REVISIONS	
NAME	DATE

ILLINOIS DEPARTMENT OF TRANSPORTATION
INTERSECTION DETAIL
WESTCHESTER / MACARTHUR BLVD.
SECTION
(84-9) RS-6; (G)Z
SANGAMON COUNTY, ILLINOIS

SCALE: VERT. _____
 HORIZ. _____
 DATE: Mar-20-2008 09:34:57AM
 DRAWN BY: CLG
 CHECKED BY: JAD

LAYOUT: CLG 09/17/07
 DRAWN: CLG 09/17/07
 REVIEWED: JMW 03/12/08
 Mar-20-2008 09:34:57AM
 #FILES