

FAU ROUTE	SECTION	COUNTY	TOTAL SHEETS	SHEET NO.
8071	*	SANGAMON	425	187
STA.		TO STA.		
FED. ROAD DIST. NO.	ILLINOIS	FED. AID PROJECT		
(84-9) RS-6; (G)Z *				

CENTER ST AT MACARTHUR BLVD						
	STATION	OFFSET	CL OR B	NORTHING	EASTING	ELEVATION
A	13+61.18	116.65	CENTER	1126953.024	2437086.409	605.37
B	13+61.99	50.98	CENTER	1127018.693	2437085.899	605.17
C	13+62.28	27.00	CENTER	1127042.678	2437085.712	605.10
D	13+62.45	13.50	CENTER	1127056.178	2437085.607	605.06
E	13+62.62	0.00	CENTER	1127069.678	2437085.502	605.02
F	13+62.78	-13.50	CENTER	1127083.179	2437085.397	604.98
G	13+62.96	-27.50	CENTER	1127097.182	2437085.289	604.93
H	13+63.11	-40.18	CENTER	1127109.857	2437085.190	604.90
I	13+63.48	-69.88	CENTER	1127139.565	2437084.959	604.81
J	13+53.24	50.98	CENTER	1127018.517	2437077.150	604.89
K	13+53.24	27.00	CENTER	1127042.496	2437076.668	604.91
L	13+53.24	13.50	CENTER	1127055.993	2437076.396	604.92
M	13+53.24	-13.50	CENTER	1127082.987	2437075.854	604.83
N	13+53.24	-40.18	CENTER	1127109.659	2437075.318	604.63
O	13+39.00	27.00	CENTER	1127042.210	2437062.434	604.61
P	13+39.00	13.50	CENTER	1127055.707	2437062.163	604.70
Q	13+39.00	-13.50	CENTER	1127082.701	2437061.620	604.59
R	13+39.00	-27.50	CENTER	1127096.701	2437061.339	604.39
S	13+26.59	18.49	CENTER	1127050.473	2437049.859	604.45
T	13+26.59	13.50	CENTER	1127055.457	2437049.759	604.51
U	13+26.59	-13.50	CENTER	1127082.452	2437049.216	604.39
V	13+26.59	-22.25	CENTER	1127091.200	2437049.040	604.21
W	13+04.83	13.50	CENTER	1127055.020	2437027.998	604.17
X	13+04.83	-13.50	CENTER	1127082.014	2437027.456	604.17
Y	13+04.83	-17.37	CENTER	1127085.880	2437027.378	604.09
Z	12+61.03	13.50	CENTER	1127054.140	2436984.210	603.75
AZ	12+61.03	-13.50	CENTER	1127081.134	2436983.667	603.75

OFFSET (-00.00) = LEFT & (00.00) = RIGHT

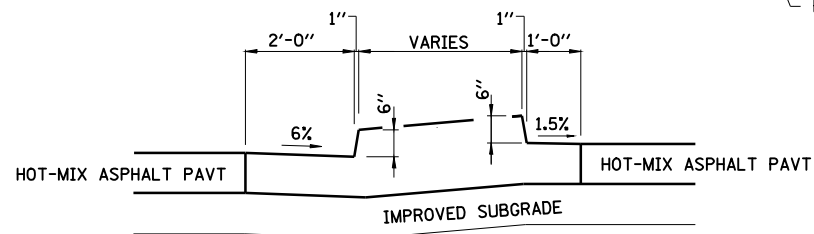
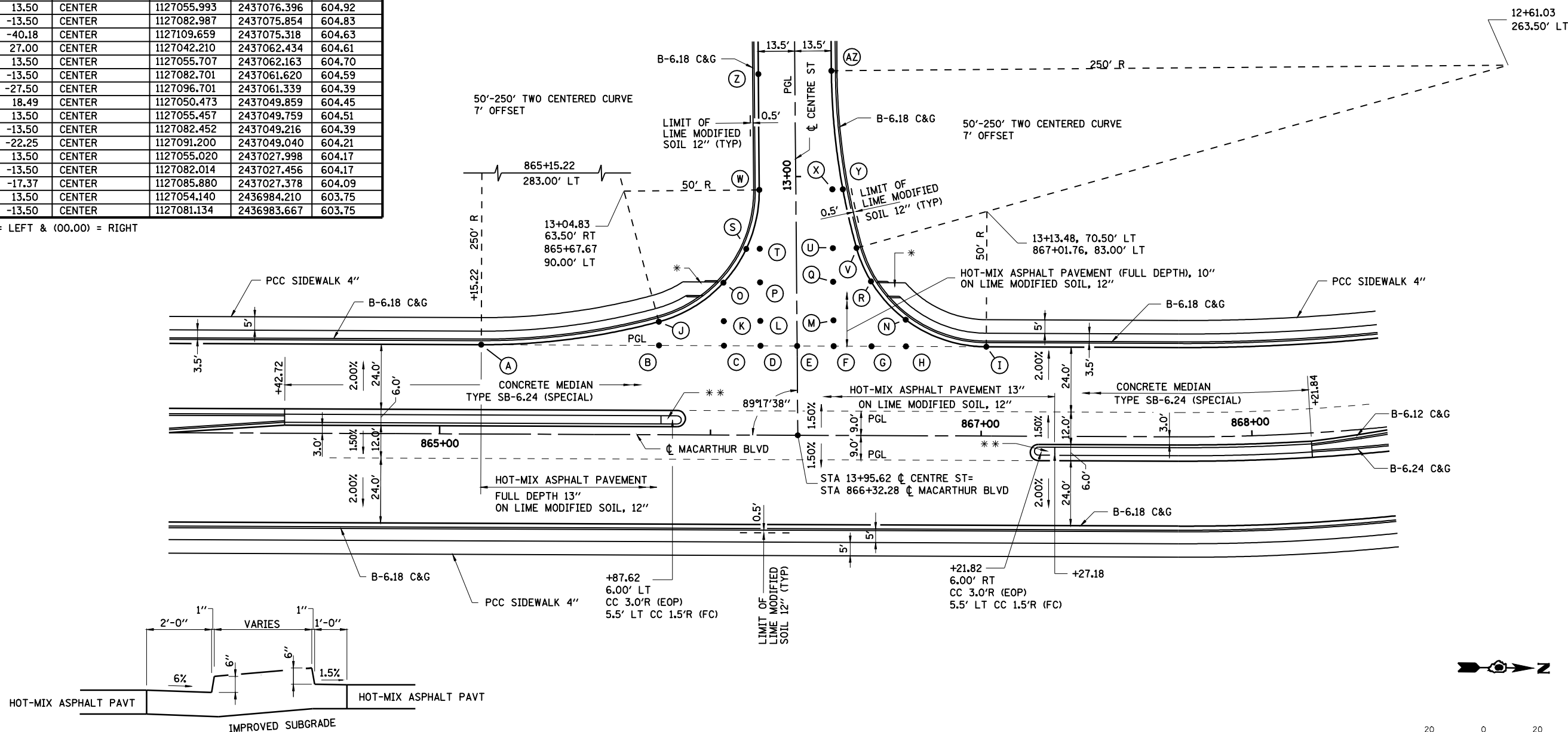

SOUTH OF CENTRE STREET INTERSECTION SHOWN  
NORTH OF INTERSECTION OPPOSITE HAND

**CONCRETE MEDIAN TYPE SB-6.24 (SPECIAL)**  
NOT TO SCALE

\* ADJUST SIDEWALK ELEVATION TO ATTAIN CURB RAMP, STD 424001.  
MAXIMUM LONGITUDINAL GRADE FOR SIDEWALK PROFILE ADJUSTMENT = 2.0%

\*\* RAMP MEDIAN NOSE  
IN ACCORDANCE WITH STD. 606301

\*\* RAMP MEDIAN NOSE  
IN ACCORDANCE WITH STD. 606301

REVISIONS	
NAME	DATE

ILLINOIS DEPARTMENT OF TRANSPORTATION  
**INTERSECTION DETAIL**  
CENTRE / MACARTHUR BLVD.  
SECTION  
(84-9) RS-6; (G)Z  
SANGAMON COUNTY, ILLINOIS

SCALE: VERT. \_\_\_\_\_  
HORIZ. \_\_\_\_\_  
DATE: Mar-20-2008 09:35:03AM  
DRAWN BY: CLG  
CHECKED BY: JAD

LAYOUT: CLG 09/17/07  
 DRAWN: CLG 09/17/07  
 REVIEWED: JMM 03/12/08  
 Mar-20-2008 09:35:03AM  
 \$FILES\$