

FAU ROUTE	SECTION	COUNTY	TOTAL SHEETS	SHEET NO.
8071	*	SANGAMON	425	192
STA.		TO STA.		
FED. ROAD DIST. NO.	ILLINOIS	FED. AID PROJECT		
(84-9) RS-6; (G)Z *				

**CENTER ACCESS MEDIAN**

- [A] 700+79.89, 6.00' RT
- [B] 700+79.47, 9.95' RT
- [C] 700+79.89, 8.00' RT
- [D] 700+98.54, 12.00' RT

**SOUTHWEST ISLAND**

- [A] 832+94.35, 90.21' LT
- [B] 832+98.26, 90.20' LT
- [C] 832+92.37, 78.36' LT
- [D] 832+87.02, 65.14' LT
- [E] 832+84.44, 60.77' LT
- [F] 832+77.13, 55.00' LT
- [G] 832+73.78, 55.00' LT
- [H] 832+73.78, 51.00' LT
- [I] 832+89.37, 60.14' LT
- [J] 832+98.23, 51.00' LT
- [K] 832+93.31, 56.00' LT
- [L] 832+56.62, 89.89' LT

**NORTHWEST ISLAND**

- [A] 833+63.08, 72.38' LT
- [B] 833+59.15, 72.32' LT
- [C] 833+63.13, 68.95' LT
- [D] 833+64.31, 56.00' LT
- [E] 833+80.25, 57.00' LT
- [F] 833+69.18, 60.71' LT
- [G] 833+67.00, 65.67' LT
- [H] 833+87.39, 84.47' LT
- [I] 833+90.78, 55.00' LT
- [J] 833+90.78, 51.00' LT
- [K] 833+59.45, 51.00' LT

© Copyright Hanson Professional Services Inc. \$MS\_YEARS  
**HANSON**

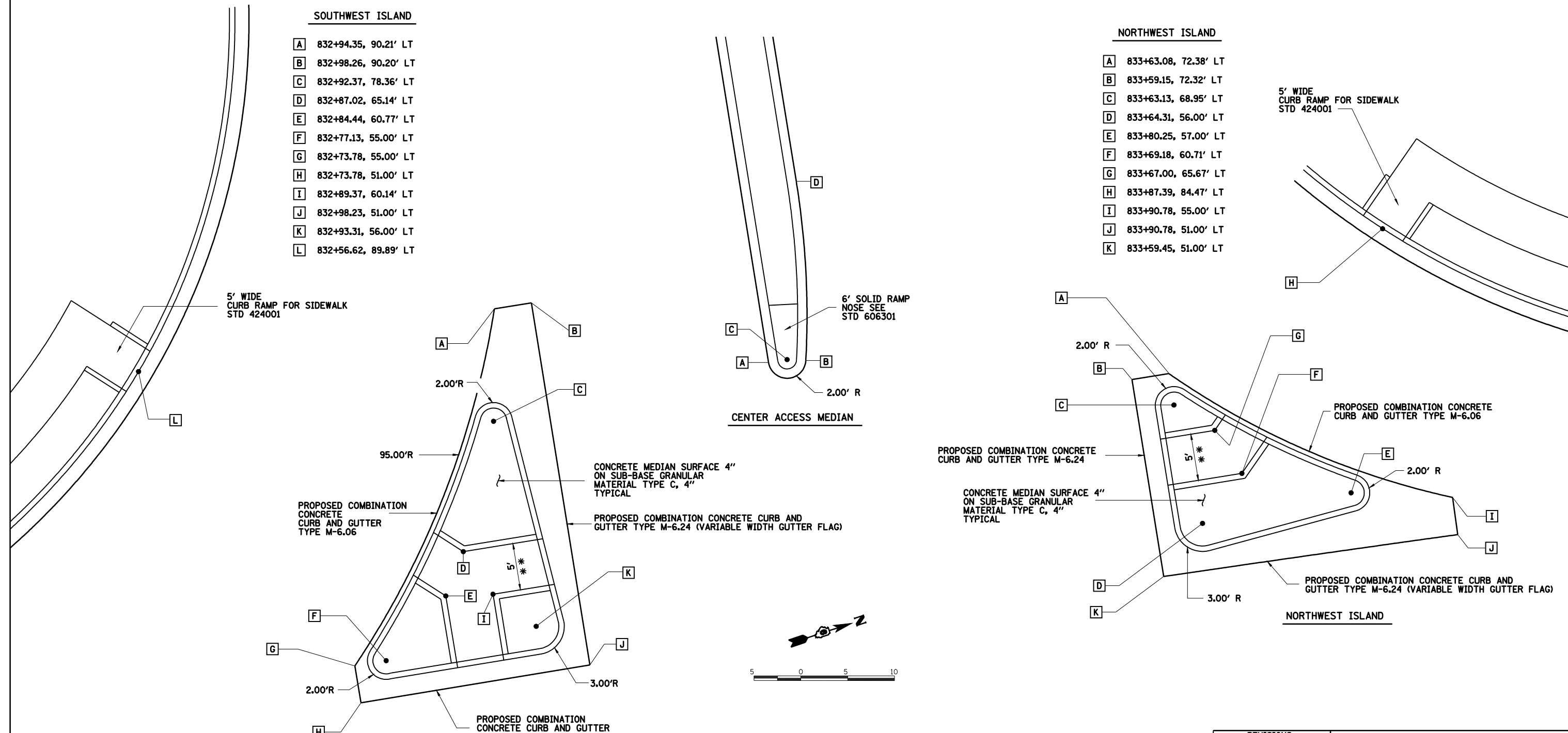

\*\* 5' WIDE SIDEWALK WITH SIDE CURBS. SEE CURB RAMPS FOR SIDEWALKS STD 424001

REVISIONS	
NAME	DATE

ILLINOIS DEPARTMENT OF TRANSPORTATION  
 ISLAND DETAILS  
 CENTER ACCESS / MACARTHUR BLVD SECTION  
 (84-9) RS-6; (G)Z  
 SANGAMON COUNTY, ILLINOIS

SCALE: VERT. \_\_\_\_\_  
 HORIZ. \_\_\_\_\_  
 DATE: Mar-20-2008 09:35:29AM  
 DRAWN BY: CLG  
 CHECKED BY: JAD

Mar-20-2008 09:35:29AM  
 \$FILES\*  
 LAYOUT CLG 09/17/07  
 DRAWN CLG 09/17/07  
 REVIEWED JMM 09/17/07