

FAU ROUTE	SECTION	COUNTY	TOTAL SHEETS	SHEET NO.
8071	*		425	272
STA.		TO STA.		
FED. ROAD DIST. NO.		ILLINOIS	FED. AID PROJECT	
(84-9) RS-6; IGIZ *				

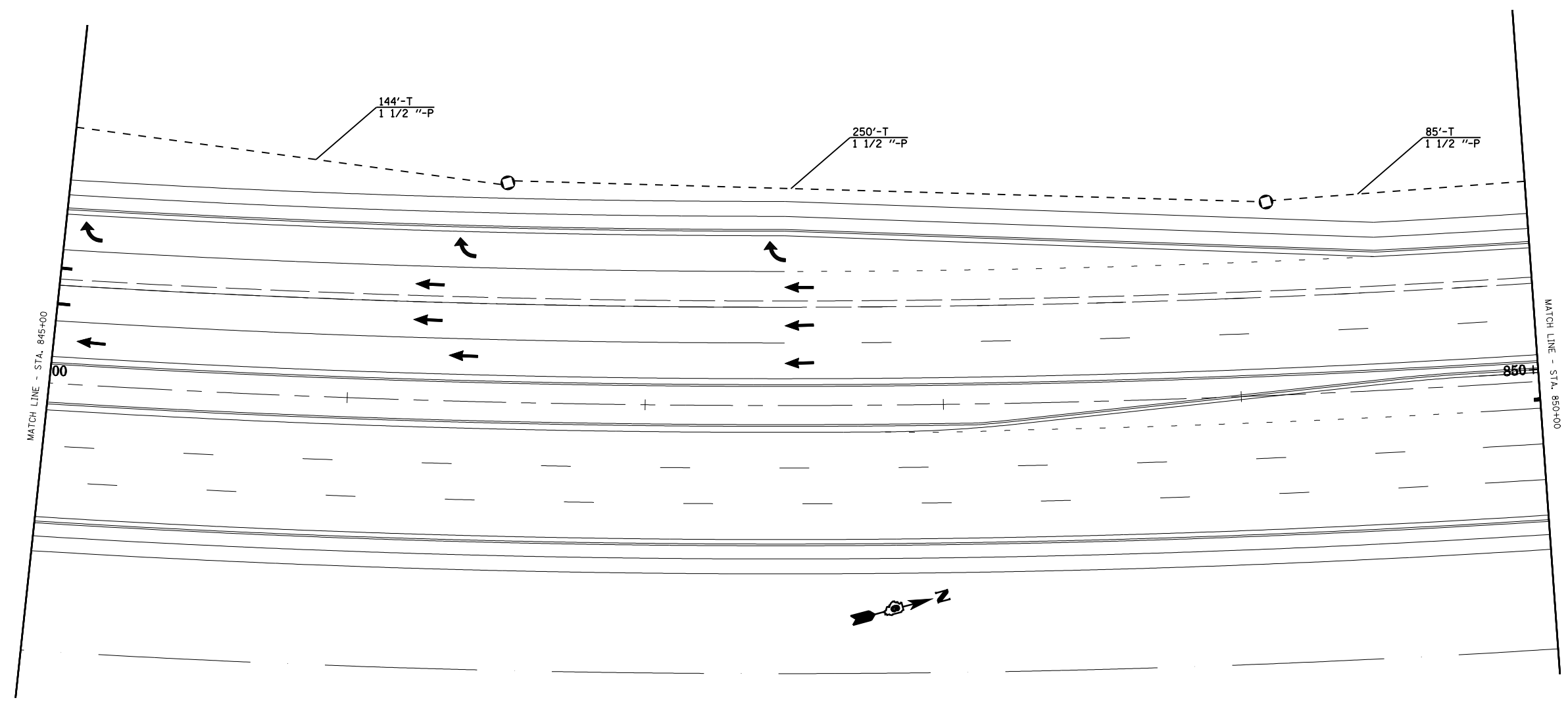

TRAFFIC SIGNAL QUANTITIES

QUANTITY	UNIT	ITEM
479.0	FOOT	CONDUIT IN TRENCH, 1 1/2" DIA., PVC
479.0	FOOT	TRENCH AND BACKFILL FOR ELECTRICAL WORK
482.0	FOOT	FIBER OPTIC CABLE IN CONDUIT, NO. 62.5/125, 24F
2	EACH	JUNCTION BOX (SPECIAL)



REVISIONS	
NAME	DATE

ILLINOIS DEPARTMENT OF TRANSPORTATION  
**PROPOSED TRAFFIC SIGNALS**  
 MACARTHUR BLVD  
 SANGAMON COUNTY

SCALE: VERT. \_\_\_\_\_  
 HORIZ. \_\_\_\_\_  
 DATE \_\_\_\_\_

DRAWN BY IDOT  
 CHECKED BY IDOT

PLOT DATE = Mar-28-2008 09:42:24M  
 FILE NAME = C:\Projeas\6855802\hanson.fma\plot.plt file for seffro signal.plt.mxd  
 PLOT SCALE = 42.3529' / IN.  
 USER NAME = laughlinr1