

FAU ROUTE	SECTION	COUNTY	TOTAL SHEETS	SHEET NO.
8071	*	SANGAMON	425	278
STA.		TO STA.		
FED. ROAD DIST. NO.	ILLINOIS	FED. AID PROJECT		
(84-9) RS-6; (G)Z *				

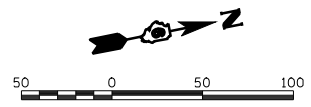
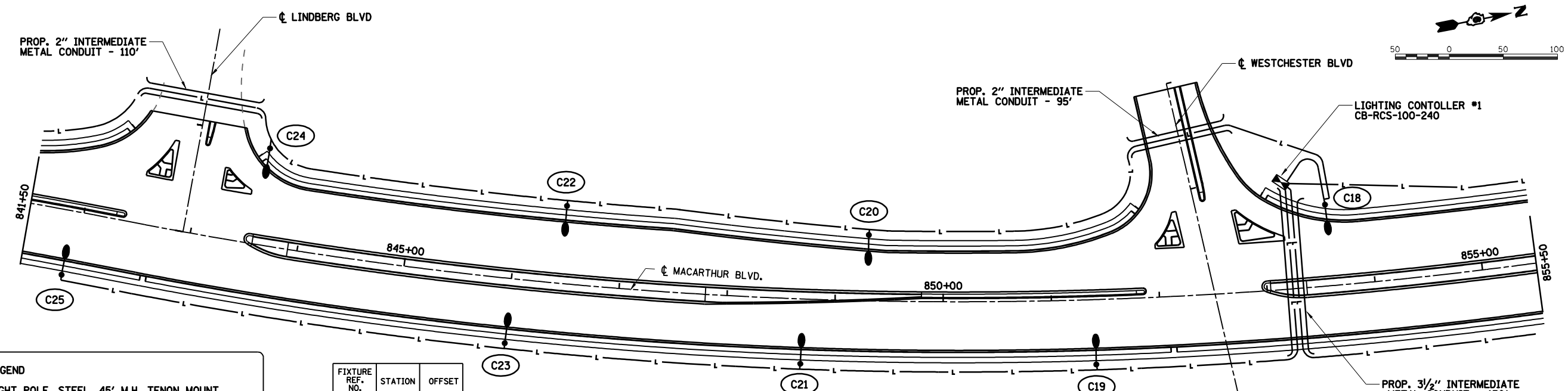
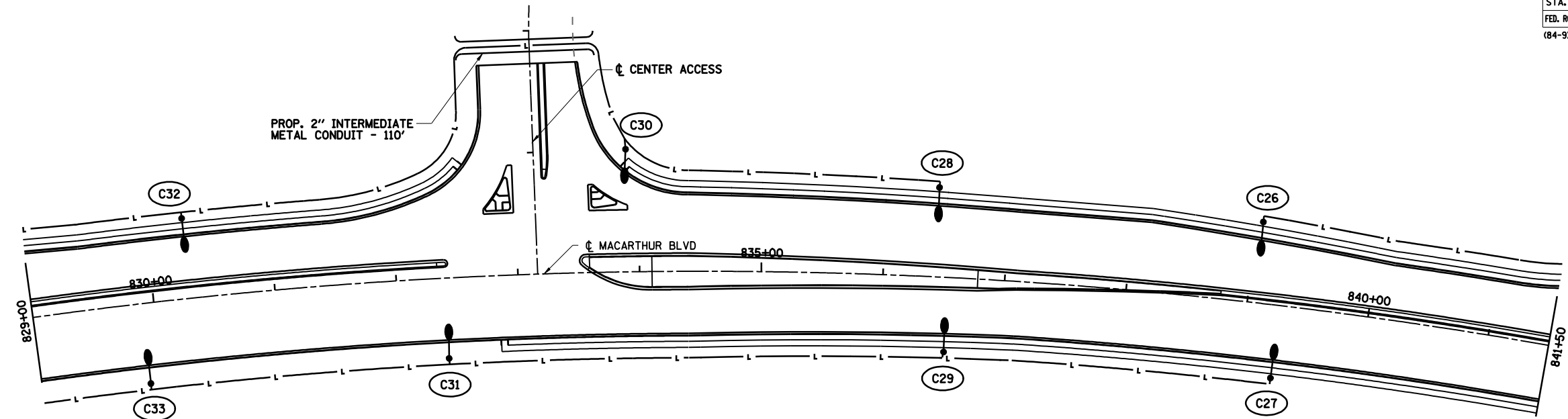

LEGEND

- LIGHT POLE, STEEL, 45' M.H. TENON MOUNT
- CONDUIT PUSHED, INTERMEDIATE METAL (LENGTH AS SHOWN)
- UNIT DUCT (SIZE AS NOTED)
- LIGHTING CONTROLLER
- CITY FIXTURE REFERENCE NUMBER (SEE TABLE)
- STATE FIXTURE REFERENCE NUMBER (SEE TABLE)
- CONCRETE SPECIAL FOUNDATION - 8' DEPTH

FIXTURE REF. NO.	STATION	OFFSET
C18	853+60	75.2' LT
C19	851+40	60.0' RT
C20	849+30	61.0' LT
C21	848+70	60.0' RT
C22	846+45	72.0' LT
C23	846+00	60.0' RT
C24	843+60	89.8' LT
C25	841+90	60.0' RT
C26	839+06	66.6' LT
C27	839+26	60.0' RT
C28	836+43	73.4' LT
C29	836+53	61.2' RT
C30	833+90	100.7' LT
C31	832+40	66.0' RT
C33	829+90	66.0' RT
C32	830+30	66.0' LT

- NOTES:**
- SEE LIGHTING DETAIL SHEET 1 FOR CIRCUIT DESIGNATION, UNIT DUCT SIZE AND FIXTURE WATTAGE
 - ALL PROPOSED LIGHT POLE FOUNDATIONS ARE 6' METAL - UNLESS OTHERWISE INDICATED.
 - CITY TO INSTALL POLE NUMBERS ON CITY OWNED POLES AFTER CONSTRUCTION.

REVISIONS	
NAME	DATE

ILLINOIS DEPARTMENT OF TRANSPORTATION
LIGHTING PLAN
MACARTHUR BOULEVARD - 3
SECTION
(84-9) RS-6; (G)Z
SANGAMON COUNTY, ILLINOIS

SCALE: VERT. _____
 HORIZ. _____
 DATE: Apr-30-2008 01:57:01PM

DRAWN BY: JAP
 CHECKED BY: JWM

Copyright Hanson Professional Services Inc. \$MS_YEARS\$
HANSON
 APR-30-2008 01:57:01PM
 \$FILE\$
 LAYOUT: CLG 09/17/07
 DRAWN: CLG 09/17/07
 REVIEWED: JMM 09/17/07