

F.A. RTE.	SECTION	COUNTY	TOTAL SHEETS	SHEET NO.
*	**	SANGAMON	425	382
STA.		TO STA.		
FED. ROAD DIST. NO. - ILLINOIS		FED. AID PROJECT		
		7 OF 50		

• FAI 72 (I-72) AND FAU 8071 (MACARTHUR BOULEVARD)
 ** SECTION (84-9) RS-6; (G)Z

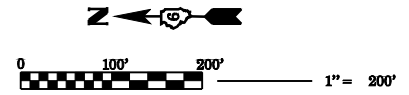

PLAN	REVISION	DATE
NOTED	BY	
NOTED	BY	
NOTED	BY	

PROFILE	REVISION	DATE
NOTED	BY	
NOTED	BY	
NOTED	BY	

PLOT DATE = Mar-01-2008 08:16:48PM
 FILE NAME = C:\Project\680007\shive-hattery\01-sh-pe.dwg
 PLOT SCALE = 3/16" = 1' = 1/8"
 USER NAME = janghlim

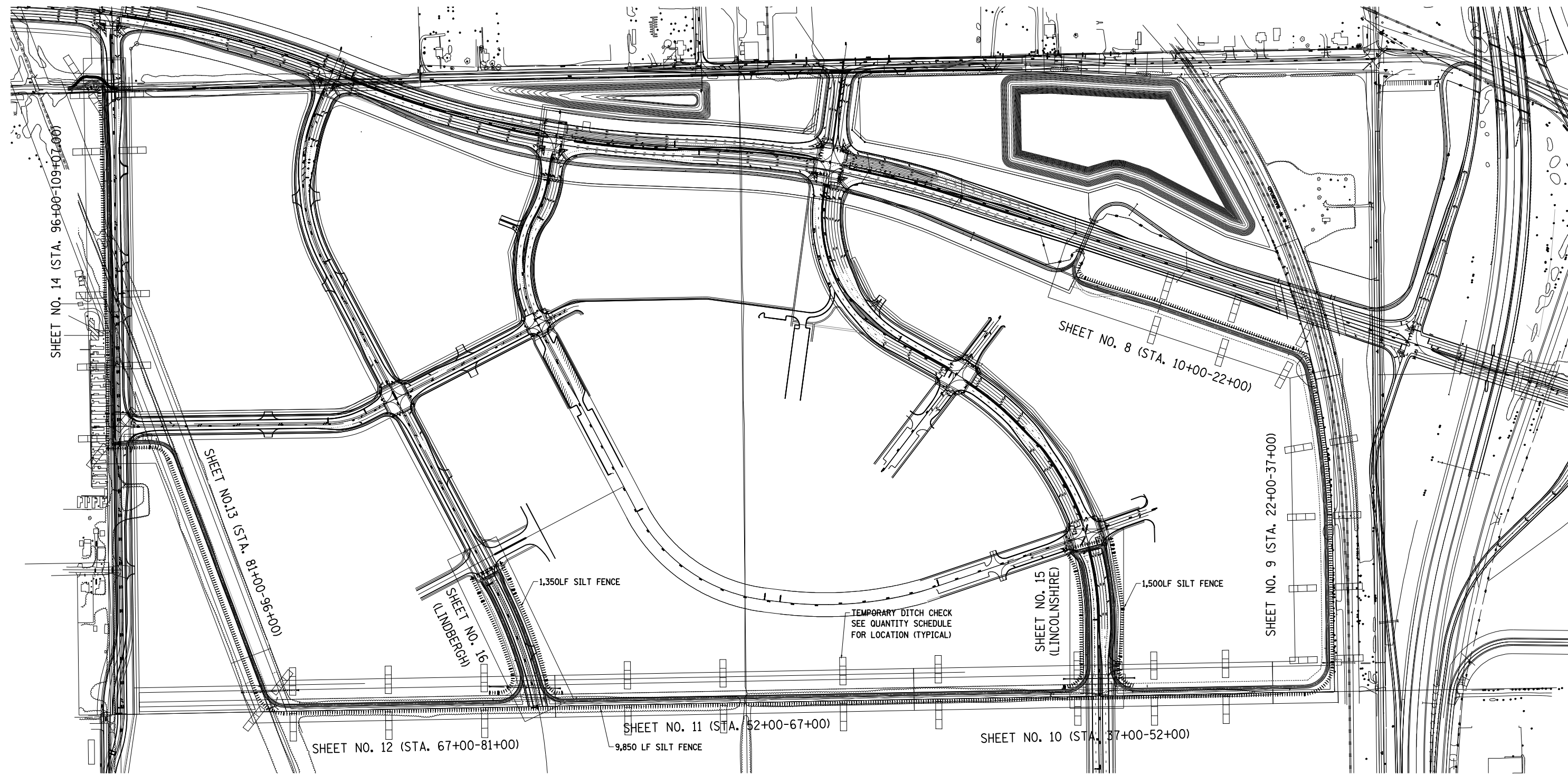

FOR INFORMATION - PLAN & PROFILE LOCATIONS

REVISIONS	
NAME	DATE

SHIVE HATTERY
 Cedar Rapids, IA • Iowa City, IA • Des Moines, IA
 Moline, IL • Bloomington, IL • Chicago, IL
SHIVE-HATTERY, INC. 200 HARTLAND DRIVE BLOOMINGTON, ILLINOIS 61708
 PHONE (309) 898-8900 FAX (309) 898-8900
 http://www.shive-hattery.com
 ILLINOIS FIRM NUMBER: 184-00084

ILLINOIS DEPARTMENT OF TRANSPORTATION
 LEGACY POINTE SHARED USE PATH
 OVERALL VIEW
 FUTURE SHARED USE PATH
 SCALE: VERT. DRAWN BY: JAB
 HORIZ. CHECKED BY: DWS
 DATE: 3/6/08