

F.A. RTE.	SECTION	COUNTY	TOTAL SHEETS	SHEET NO.
*	**	SANGAMON	425	383
STA. 10+22		TO STA. 22+00		
FED. ROAD DIST. NO. -		ILLINOIS	FED. AID PROJECT	

- FAI 72 (I-72) AND FAU 8071 (MACARTHUR BOULEVARD)
- SECTION (84-9) RS-6; (G)Z

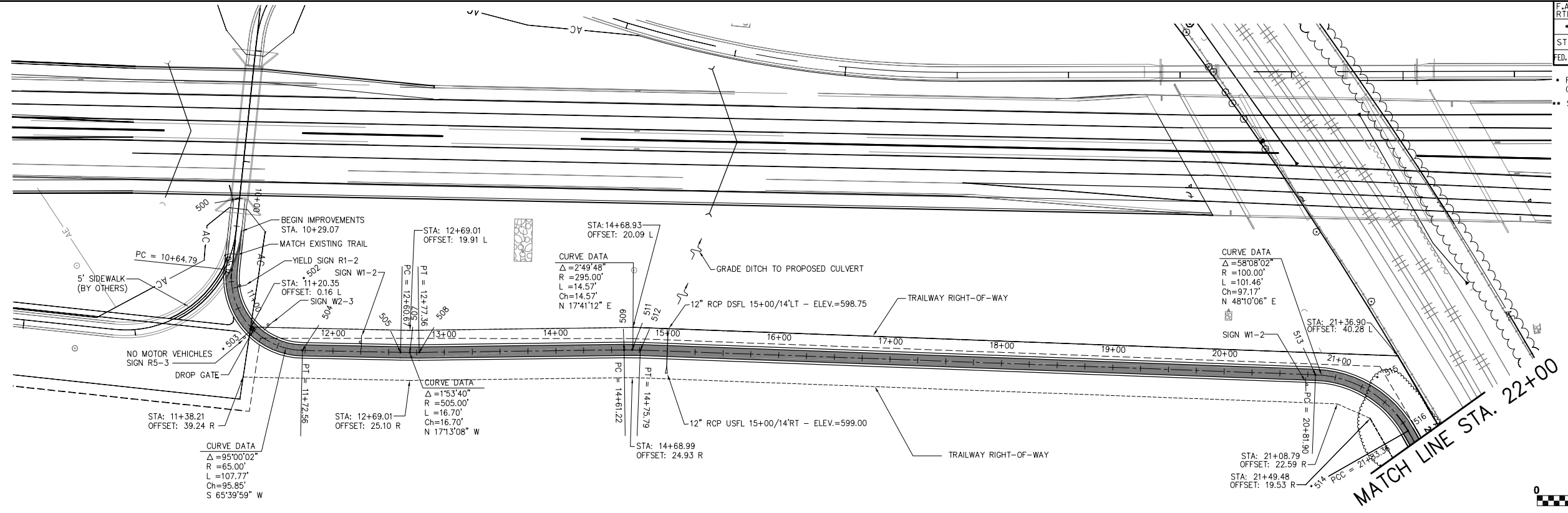

**PLAN VIEW BIKE TRAIL**  
HORIZONTAL SCALE : 1"=50'

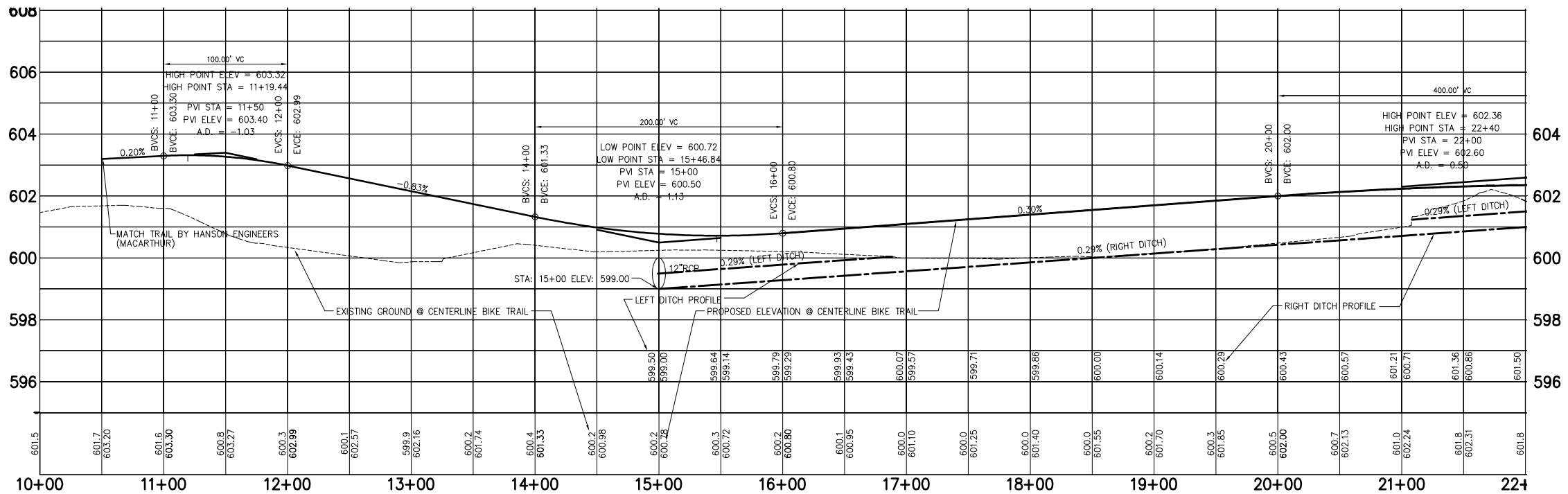

**PROFILE VIEW BIKE TRAIL**  
VERTICAL SCALE : 1"=2'

PLAN	DATE	BY
SURVEYED		
PLOTTED		
CHECKED		
NO. _____		

PROFILE	DATE	BY
SURVEYED		
PLOTTED		
CHECKED		
NO. _____		

PLOT DATE = #DATE\*  
FILE NAME = #FILE\*  
PLOT SCALE = #SCALE\*  
USER NAME = #USER\*

REVISIONS	
NAME	DATE

**SHIVE HATTERY**  
Cedar Rapids, IA • Iowa City, IA • Des Moines, IA  
Moline, IL • Bloomington, IL • Chicago, IL

SHIVE-HATTERY, INC. 2103 EASTLAND DRIVE BLOOMINGTON, ILLINOIS 61702  
PHONE (309) 662-8992 FAX (309) 662-5808  
http://www.shive-hattery.com  
ILLINOIS FIRM NUMBER: 184-000214

ILLINOIS DEPARTMENT OF TRANSPORTATION  
LEGACY POINT SHARED USE PATH  
**PLAN & PROFILE**  
STA. 10+00 to STA. 22+00

SCALE: VERT. \_\_\_\_\_  
HORIZ. \_\_\_\_\_  
DATE: 3/6/08

DRAWN BY: JAB  
CHECKED BY: DWS