

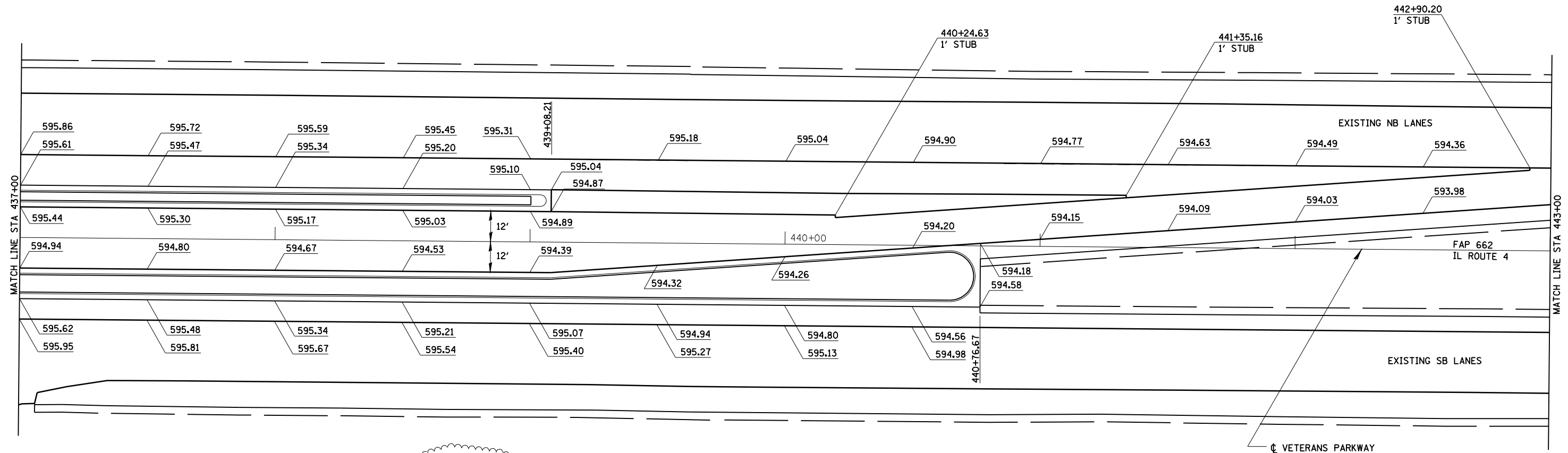

STA	OFFSET-W. EDGE LT TURN LANE
439+08.21	12.00'
439+25	10.71'
439+50	8.79'
439+75	6.86'
440+00	4.94'
440+25	3.02'
440+50	1.09'
440+75	-0.83'
441+00	-2.75'
441+25	-4.68'
441+50	-6.60'
441+75	-8.52'
442+00	-10.45'
442+25	-12.37'
442+50	-14.29'
442+75	-16.21'
443+00	-18.14'



LEGEND	
	TIE BARS
	596.27 PROPOSED EDGE OF PAVEMENT ELEVATION

CUMMINS ENGINEERING CORPORATION		JOB - 2200
FILE NAME =	USER NAME = laughlin1	FILE - sht-elev.dgn
C:\Projects\652204\cummins_final\67289-sht-elev.dgn	DESIGNED - NAK	REVISED -
	DRAWN - AJH	REVISED -
	CHECKED - PLK	REVISED -
	DATE - 3/15/2008	REVISED -
	PLOT SCALE = 40.0000' / IN.	
	PLOT DATE = Mar-18-2008 11:41:56AM	

**STATE OF ILLINOIS
DEPARTMENT OF TRANSPORTATION**

SOUTHWEST PLAZA DR. ELEVATIONS

SCALE: SHEET NO. OF SHEETS STA. TO STA.

F.A.P. RTE.	SECTION	COUNTY	TOTAL SHEETS	SHEET NO.
662	2-2(RS) & 3-1, 2(RS-10, TS-5)	SANGAMON	181	91
FED. ROAD DIST. NO. ILLINOIS FED. AID PROJECT			CONTRACT NO. 72889	