

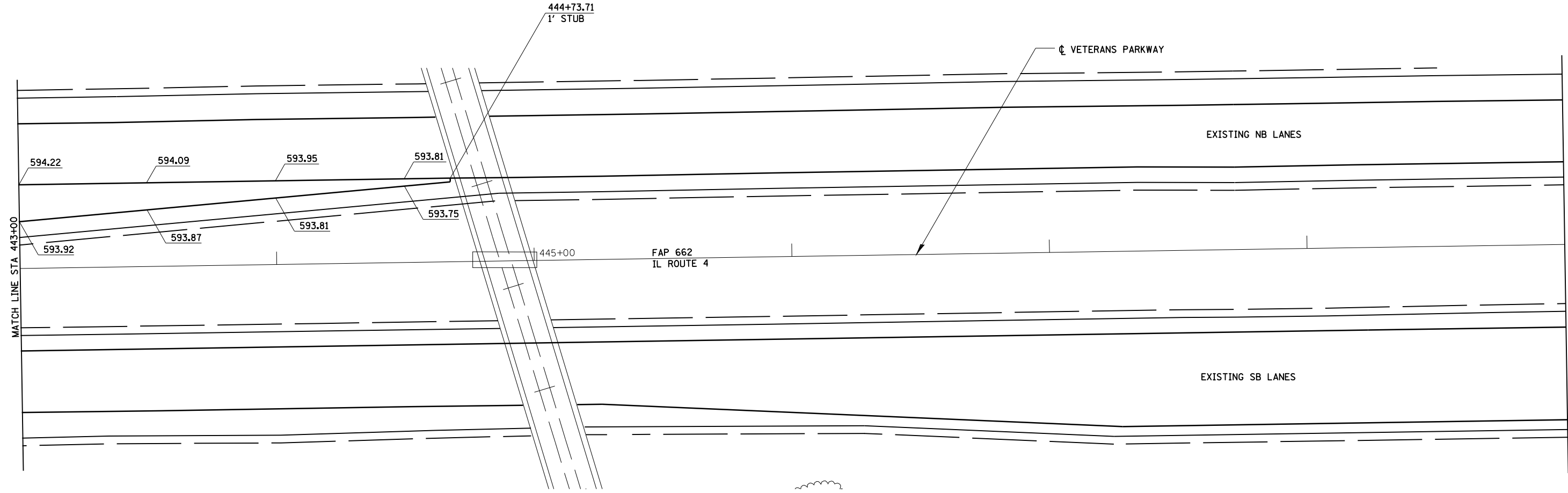

STA	OFFSET-W. EDGE LT TURN LANE
443+00	-18.14'
443+25	-20.06'
443+50	-21.98'
443+75	-23.91'
444+00	-25.83'
444+25	-27.75'
444+50	-29.68'
444+73.71	-31.50'



LEGEND	
	TIE BARS
	596.27 PROPOSED EDGE OF PAVEMENT ELEVATION

CUMMINS ENGINEERING CORPORATION		JOB - 2200
FILE NAME =	USER NAME = laughlinr1	FILE - sht-elev.dgn
C:\Projects\d652204\cummins_final\d67289-sht-elev.dgn	DESIGNED - NAK	REVISIONS
PLOT SCALE = 40.0000' / IN.	DRAWN - AJH	REVISIONS
PLOT DATE = Mar-18-2008 11:41:18AM	CHECKED - PLK	REVISIONS
	DATE - 3/15/2008	REVISIONS

**STATE OF ILLINOIS
DEPARTMENT OF TRANSPORTATION**

SOUTHWEST PLAZA DR. ELEVATIONS

SCALE: SHEET NO. OF SHEETS STA. TO STA.

F.A.P. RTE.	SECTION	COUNTY	TOTAL SHEETS	SHEET NO.
662	2-2(RS) & 3-1, 2(RS-10, TS-5)	SANGAMON	181	92
CONTRACT NO. 72889				
FED. ROAD DIST. NO. ILLINOIS FED. AID PROJECT				