

F.A.P. RTE.	SECTION	COUNTY	TOTAL SHEETS	SHEET NO.
67	(W)BR	SANGAMON	29	1
FED. ROAD DIST. NO.		ILLINOIS	CONTRACT NO. 72B70	

29+1=30

D-96-030-08

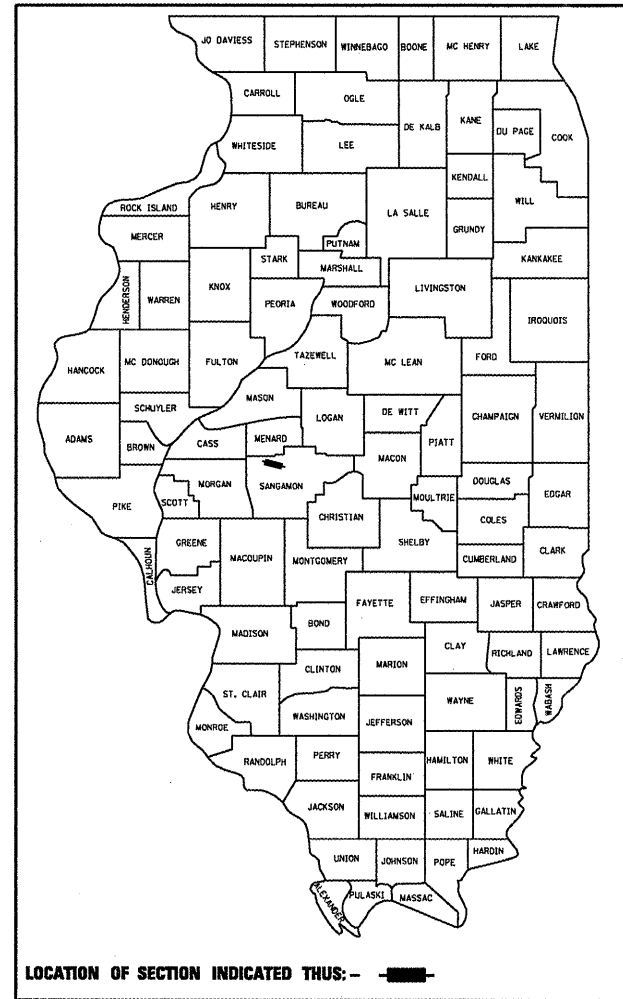

## INDEX OF SHEETS

- 1 COVER SHEET
- 2 GENERAL NOTES
- 3-5 SUMMARY OF QUANTITIES
- 6 TYPICAL CROSS SECTION & EXISTING RIGHT OF WAY LAYOUT
- 7 SCHEDULES OF QUANTITIES
- 8, 9 PLAN LAYOUT
- 10 - 13 TRAFFIC CONTROL PLAN SHEETS
- 14 - 21 SUPERSTRUCTUE PLANS
- 22-29 CROSS SECTIONS

## STANDARDS

000001-05	701201-02
001001-01	701301-02
515001-01	701306-01
630001-07	701311-02
630301-04	701321-09
631032-03	701362-02
635006-02	701901
635011-01	704001-04
701001-01	780001-01
701006-02	805001

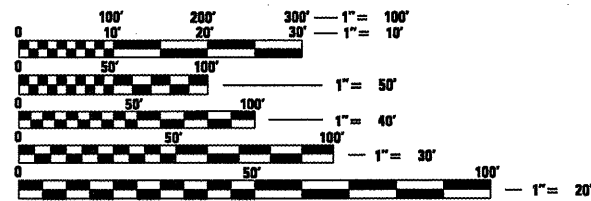

FULL SIZE PLANS HAVE BEEN PREPARED USING STANDARD ENGINEERING SCALES. REDUCED SIZED PLANS WILL NOT CONFORM TO STANDARD SCALES. IN MAKING MEASUREMENTS ON REDUCED PLANS, THE ABOVE SCALES MAY BE USED.

J.U.L.I.E.  
JOINT UTILITY LOCATION INFORMATION FOR EXCAVATION  
1-800-892-0123  
OR 811

PROJECT ENGINEER Sal Madonia 217-782-4761  
PROJECT MANAGER Marcus Bruce 217-524-0946

CONTRACT NO. 72B70

# STATE OF ILLINOIS DEPARTMENT OF TRANSPORTATION DIVISION OF HIGHWAYS

## PROPOSED HIGHWAY PLANS

FAP 67 (IL RTE. 97)  
SECTION (W)BR  
PROJECT: ACBHF-0067(078)  
SANGAMON COUNTY  
C-96-030-08

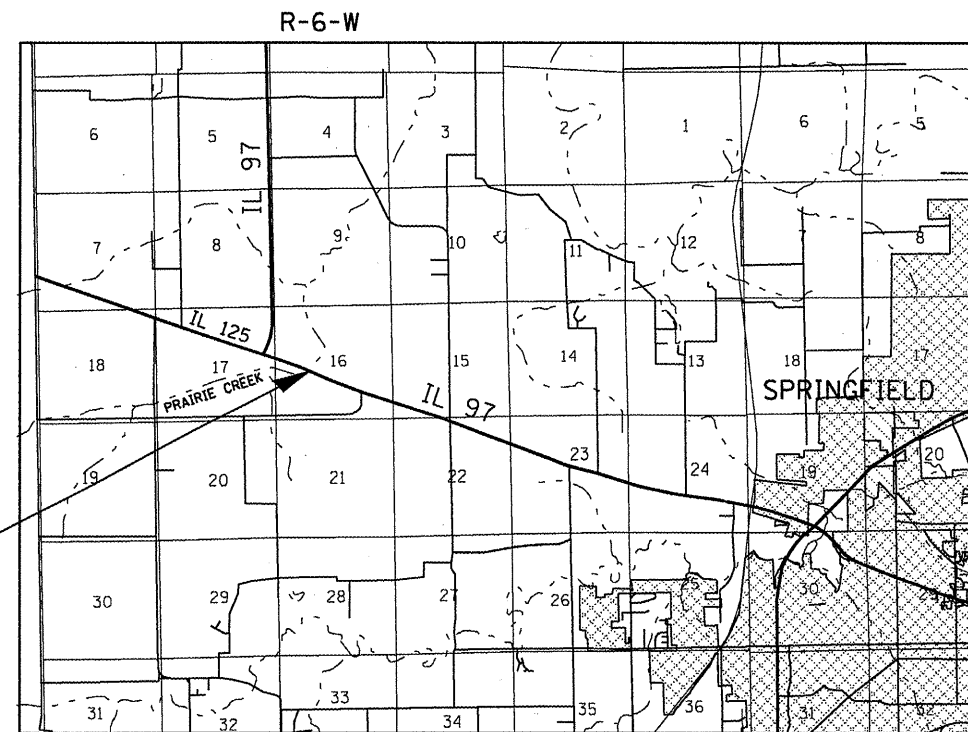

SUPERSTRUCTURE REPLACEMENT AND ASSOCIATED  
ROADWAY WORK FOR S.N. 084-0046

## LOCATION MAP

NET LENGTH OF PROJECT = 722.59 FT. (0.137 MILES)  
AVERAGE DAILY TRAFFIC = 15,000 (2007)  
ROAD CLASSIFICATION = MINOR ARTERIAL

STATE OF ILLINOIS  
DEPARTMENT OF TRANSPORTATION  
DIVISION OF HIGHWAYS

SUBMITTED March 24, 2008

*CO-1 M Reed*  
DEPUTY DIRECTOR OF HIGHWAYS, REGION ENGINEER

May 9, 2008  
*Eric E. Harn*  
INTERIM ENGINEER OF DESIGN AND ENVIRONMENT

May 9, 2008  
*Christine M. Reed*  
DIRECTOR OF HIGHWAYS, CHIEF ENGINEER

PRINTED BY THE AUTHORITY  
OF THE STATE OF ILLINOIS