

FOR INDEX OF SHEETS AND HIGHWAY  
STANDARDS, SEE SHEET 2.

STATE OF ILLINOIS  
DEPARTMENT OF TRANSPORTATION  
DIVISION OF HIGHWAYS

CONTRACT: 72B96  
SHEET 1 OF 8

**PLANS FOR PROPOSED  
CONTRACT MAINTENANCE  
FAP ROUTE 566 (IL 106)  
SECTION (1-NRHM,2)RS-4  
SCOTT COUNTY  
C96-061-08 / D96-061-08**

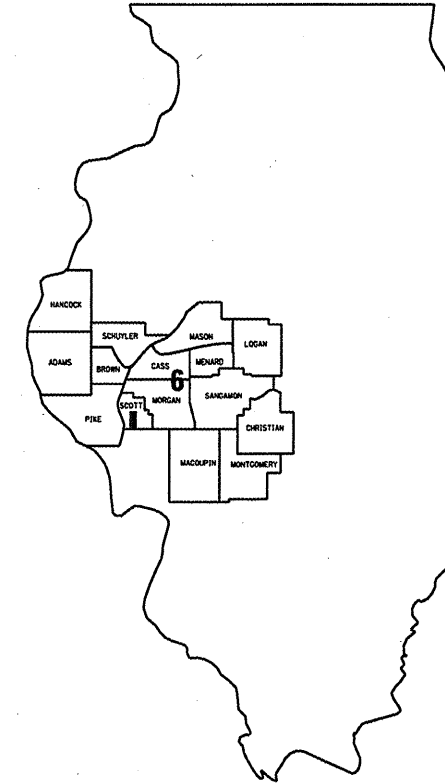

LOCATION OF SECTION INDICATED THUS: ■

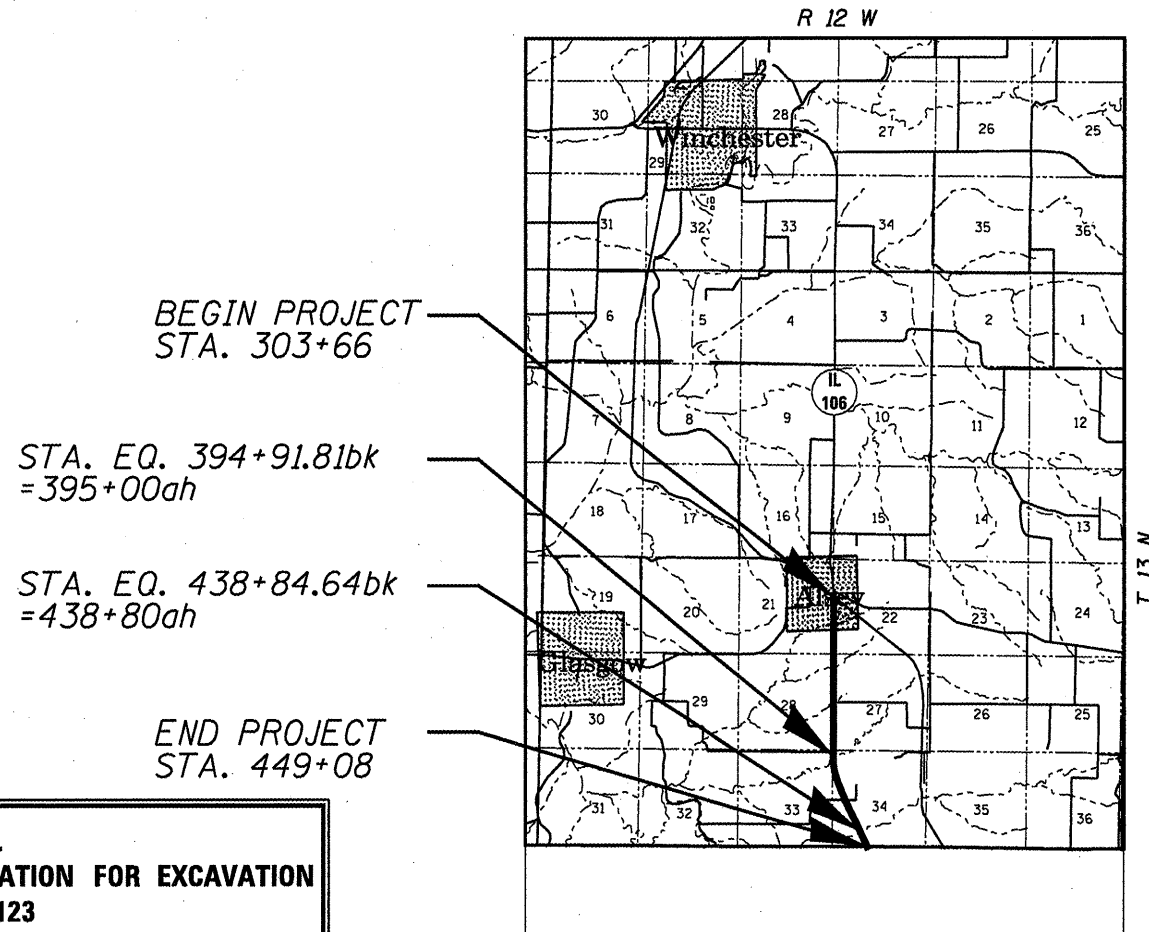

BEGIN PROJECT  
STA. 303+66

STA. EQ. 394+91.81bk  
=395+00ah

STA. EQ. 438+84.64bk  
=438+80ah

END PROJECT  
STA. 449+08

J. U. L. I. E.  
JOINT UTILITY LOCATION INFORMATION FOR EXCAVATION  
1-800-892-0123

PLANS & CONTRACT TECHNICIAN: TIMOTHY SHARP  
PHONE: (217) 782-7743

NET LTH OF SEC 14,538.45 FT = 2.753 MILE

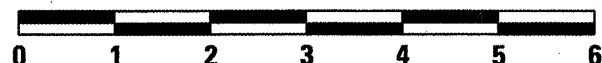

SCALE: 1" = 2 MILES

STATE OF ILLINOIS  
DEPARTMENT OF TRANSPORTATION  
DIVISION OF HIGHWAYS

SUBMITTED March 19 20 08

CO. J. M. Reed  
DEPUTY DIRECTOR OF HIGHWAYS, REGION FOUR ENGINEER

May 9, 20 08  
Eric E. Harn  
Interim ENGINEER OF DESIGN AND ENVIRONMENT

May 9, 20 08  
Christine M. Reed  
DIRECTOR, DIVISION OF HIGHWAYS

PRINTED BY AUTHORITY OF THE STATE OF ILLINOIS

**CONTRACT NO. 72B96**

INDEX

- 1 COVER
- 2 INDEX/STANDARDS/SIGNATURES
- 3 QUANTITIES
- 4-5 TYPICAL SECTIONS
- 6 SCHEDULES
- 7 BUTT JOINT DETAIL

STANDARDS

- 701001-01
- 701006-02
- 701011-01
- 701201-02
- 701301-02
- 701306-01
- 701311-02
- 701501-04
- 701901
- 780001-02

NOTES:

NO PASSING ZONES TO BE FIELD VERIFIED BY THE BUREAU OF OPERATIONS.  
THE RESIDENT ENGINEER SHALL NOTIFY THE BUREAU OF OPERATIONS 14 DAYS  
PRIOR TO PERMANENT PAVEMENT MARKING.

<b>STATE OF ILLINOIS DEPARTMENT OF TRANSPORTATION DIVISION OF HIGHWAYS DISTRICT 6</b>
EXAMINED <u>March 17</u> 20 <u>08</u> <u>[Signature]</u> ENGINEER OF OPERATIONS
EXAMINED <u>MARCH 12</u> 20 <u>08</u> <u>[Signature]</u> ENGINEER OF PROGRAM IMPLEMENTATION
EXAMINED <u>March 17</u> 20 <u>08</u> <u>[Signature]</u> ENGINEER OF PROGRAM DEVELOPMENT

INDEX/STANDARDS/SIGNATURES  
FAP 566 (IL 106)  
SECTION (1-NRHM,2)RS-4  
SCOTT COUNTY

S U M M A R Y O F Q U A N T I T I E S

CODE NO.	ITEM	UNIT	100% STATE
			1000
			TOTAL QTY
40600200	BITUMINOUS MATERIALS (PRIME COAT)	TON	15.7
40600300	AGGREGATE (PRIME COAT)	TON	82.4
40600895	CONSTRUCTING TEST STRIP	EACH	1
40600990	TEMPORARY RAMP	SQ YD	87
40603310	HOT-MIX ASPHALT SURFACE COURSE, MIX C, N50	TON	3,459
44000155	HOT-MIX ASPHALT SURFACE REMOVAL, 1 1/2"	SQ YD	41,168
67100100	MOBILIZATION	L SUM	1
70100450	TRAFFIC CONTROL AND PROTECTION, STANDARD 701201	L SUM	1
70100460	TRAFFIC CONTROL AND PROTECTION, STANDARD 701306	L SUM	1

QUANTITIES  
FAP 566 (IL 106)  
SECTION (1-NRHM,2)RS-4  
SCOTT COUNTY

S U M M A R Y O F Q U A N T I T I E S

CODE NO.	ITEM	UNIT	100% STATE
			TOTAL QTY
70102620	TRAFFIC CONTROL AND PROTECTION, STANDARD 701501	L SUM	1
70300100	SHORT-TERM PAVEMENT MARKING	FOOT	2,856
70300230	TEMPORARY PAVEMENT MARKING - LINE 5"	FOOT	48,797
70301000	WORK ZONE PAVEMENT MARKING REMOVAL	SQ FT	476
* 78001120	PAINT PAVEMENT MARKING - LINE 5"	FOOT	48,797
* 78100100	RAISED REFLECTIVE PAVEMENT MARKER	EACH	178
78300200	RAISED REFLECTIVE PAVEMENT MARKER REMOVAL	EACH	178

\* SPECIALTY ITEMS

QUANTITIES  
FAP 566 (IL 106)  
SECTION (1-NRHM,2)RS-4  
SCOTT COUNTY

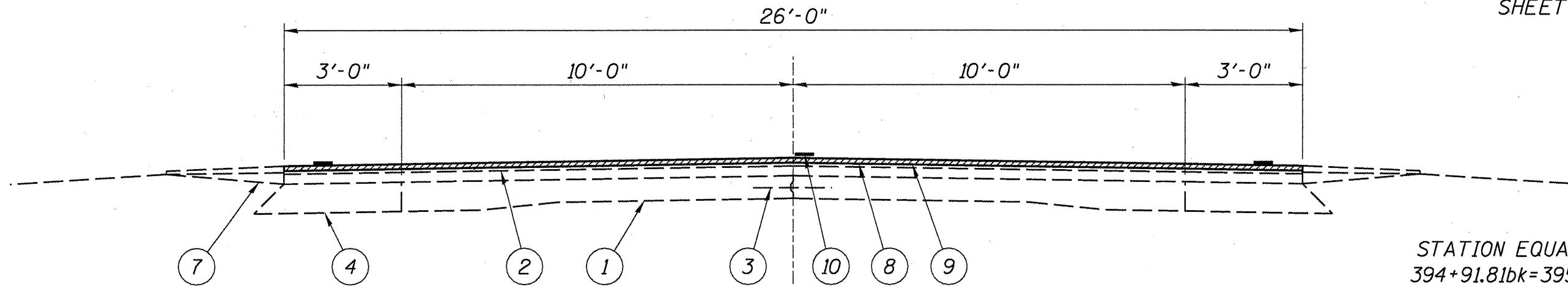

RT. STA. 303+66 TO 304+26  
LT. STA. 303+66 TO 304+78  
RT. STA. 308+32 TO 315+61  
RT. STA. 327+37 TO 333+94  
LT. STA. 328+00 TO 333+94

RT. STA. 353+25 TO 378+00  
LT. STA. 353+25 TO 377+35  
RT. STA. 417+80 TO 426+37

STATION EQUATIONS  
394+91.81bk=395+00ah  
438+84.64bk=438+80ah

BRIDGE OMISSIONS  
394+21.31 TO 395+70.5  
437+46.5 TO 438+88.86

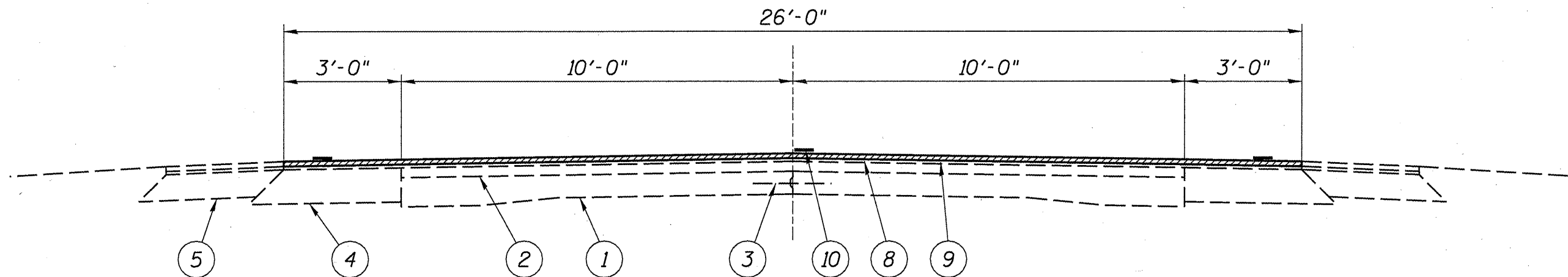

RT. STA. 319+10 TO 321+40  
LT. STA. 318+60 TO 322+80  
RT. STA. 339+96 TO 341+50  
LT. STA. 333+94 TO 346+20  
RT. STA. 343+75 TO 346+70  
RT. STA. 395+14.27 TO 400+20

LT STA. 395+14.40 TO 401+43  
RT. STA. 405+62 TO 408+80  
LT. STA. 408+24 TO 410+70  
STA. 432+80 TO 438+62.89  
RT. STA. 438+95 TO 448+18  
LT STA. 445+12 TO 445+63

LEGEND

- |  |  |
|--|--|
| 1 - EXIST. P.C.C. PAVEMENT 9-7-9               | 6 - EXIST. CONCRETE GUTTER, TYPE A                   |
| 2 - EXIST. H.M.A. SURFACE                      | 7 - EXIST. AGGREGATE SHOULDER                        |
| 3 - EXIST. 1/2" DEFORMED BAR & METAL JOINT     | 8 - PROP. H.M.A. SURFACE REMOVAL 1 1/2"              |
| 4 - EXIST. H.M.A. BASE COURSE WIDENING 10 1/2" | 9 - PROP. H.M.A. SURFACE COURSE, MIX "C", N50 1 1/2" |
| 5 - EXIST. H.M.A. SHOULDER 8"                  | 10 - PROP. PAINT PAVEMENT MARKING - LINE 5"          |

INDEX/STANDARDS/SIGNATURES  
FAP 566 (IL 106)  
SECTION (1-NRHM,2)RS-4  
SCOTT COUNTY

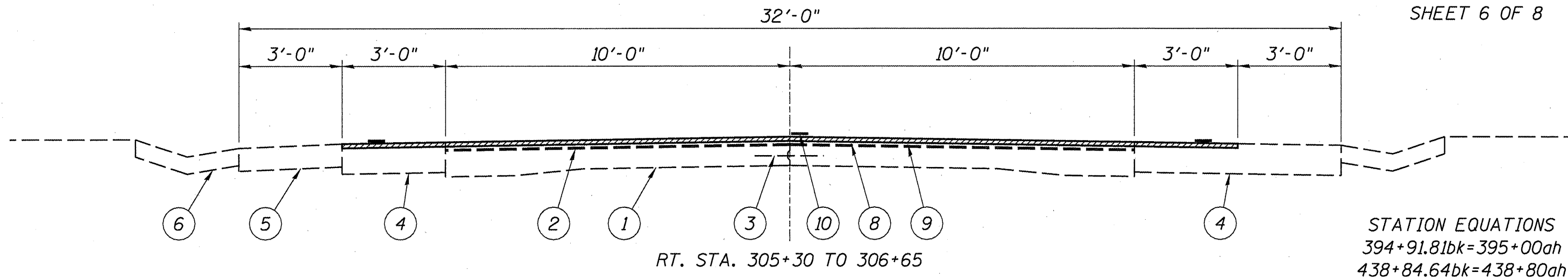

RT. STA. 305+30 TO 306+65

STATION EQUATIONS  
394+91.81bk=395+00ah  
438+84.64bk=438+80ah

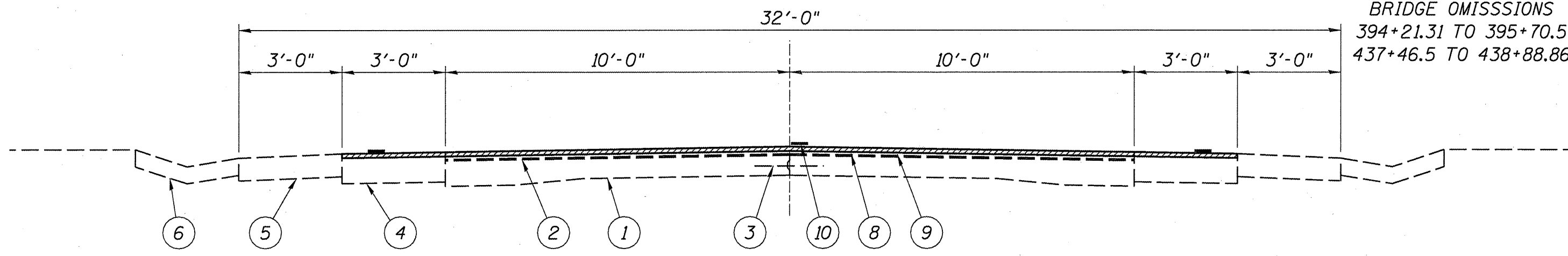

RT. STA. 304+26 TO 305+30  
RT. STA. 306+65 TO 308+32  
RT. STA. 315+61 TO 319+10  
LT. STA. 304+78 TO 318+60  
RT. STA. 321+40 TO 327+37  
LT. STA. 322+80 TO 328+00  
RT. STA. 333+94 TO 339+96  
RT. STA. 341+50 TO 343+75  
RT. STA. 346+70 TO 353+25  
LT. STA. 346+20 TO 353+25

RT. STA. 378+00 TO 394+90  
LT. STA. 377+35 TO 394+77.41  
RT. STA. 400+20 TO 405+62  
LT. STA. 401+43 TO 408+24  
RT. STA. 426+37 TO 432+80  
LT. STA. 423+00 TO 432+80  
LT. STA. 439+01.75 TO 445+12  
LT. STA. 445+63 TO 448+58  
RT. STA. 448+18 TO 449+08  
LT. STA. 448+58 TO 449+08

BRIDGE OMISSIONS  
394+21.31 TO 395+70.5  
437+46.5 TO 438+88.86

LEGEND

- |  |  |
|--|--|
| 1 - EXIST. P.C.C. PAVEMENT 9-7-9               | 6 - EXIST. CONCRETE GUTTER, TYPE A                   |
| 2 - EXIST. H.M.A. SURFACE                      | 7 - EXIST. AGGREGATE SHOULDER                        |
| 3 - EXIST. 1/2" DEFORMED BAR & METAL JOINT     | 8 - PROP. H.M.A. SURFACE REMOVAL 1 1/2"              |
| 4 - EXIST. H.M.A. BASE COURSE WIDENING 10 1/2" | 9 - PROP. H.M.A. SURFACE COURSE, MIX "C", N50 1 1/2" |
| 5 - EXIST. H.M.A. SHOULDER 8"                  | 10 - PROP. PAINT PAVEMENT MARKING - LINE 5"          |

INDEX/STANDARDS/SIGNATURES  
FAP 566 (IL 106)  
SECTION (1-NRHM,2)RS-4  
SCOTT COUNTY

PAVEMENT MARKING SCHEDULE			
STATION	TYPE	PAINT PAV,T MARKING	
		LINE 5"	
		WHITE	YELLOW
LT & RT 303+66 TO 449+08	EDGE LINE	28,501 FT	
303+66 TO 307+10	SKIP DASH		90 FT
LT 307+10 TO 317+00	SKIP DASH		250 FT
RT 307+10 TO 334+10	NO PASS		2,700 FT
LT 317+00 TO 343+00	NO PASS		2,600 FT
RT 334+10 TO 342+80	SKIP DASH		220 FT
RT 342+80 TO 352+45	NO PASS		965 FT
LT 343+00 TO 348+22	SKIP DASH		130 FT
LT 348+22 TO 364+86	NO PASS		1,664 FT
RT 352+45 TO 364+86	SKIP DASH		310 FT
364+86 TO 371+26	SKIP DASH		160 FT
LT 371+26 TO 378+80	SKIP DASH		190 FT
RT 371+26 TO 378+80	NO PASS		754 FT
378+80 TO 379+60	SKIP DASH		20 FT
LT 379+60 TO 388+75	NO PASS		915 FT
RT 379+60 TO 388+75	SKIP DASH		230 FT
388+75 TO 389+55	SKIP DASH		20 FT
LT 389+55 TO 400+55	SKIP DASH		240 FT
STA. EQ. 394+91.81bk=395+00ah			
RT 389+55 TO 400+65	NO PASS		951 FT
STA. EQ. 438+84.64bk=438+80ah			
LT 400+55 TO 440+44	NO PASS		3,994 FT
RT 400+65 TO 407+06	SKIP DASH		160 FT
RT 407+06 TO 427+96	NO PASS		2,090 FT
RT 427+96 TO 437+30	SKIP DASH		240 FT
RT 437+30 TO 449+08	NO PASS		1,183 FT
LT 440+44 TO 449+08	SKIP DASH		220 FT
<b>TOTALS</b>		28,501 FT	20,296 FT

NOTES:

STATIONS ARE APPROXIMATE.

MIXTURE REQUIREMENTS	
THE FOLLOWING MIXTURE REQUIREMENTS ARE APPLICABLE FOR THIS PROJECT	
MIXTURE USE(S):	H.M.A. S.C., MIX C, N50
AC/PG	PG 64-22
DESIGN AIR VOIDS:	4.0% @ N DESIGN = 50
MIXTURE COMP:	IL 9.5 OR 12.5
FRICITION AGG:	MIX "C"

NOTE:

THE STRIPPING ON THIS PROJECT WILL CONTINUE THROUGH THE BRIDGE OMISSION.

SCHEDULES  
FAP 566 (IL 106)  
SECTION (1-NRHM,2)RS-4  
SCOTT COUNTY

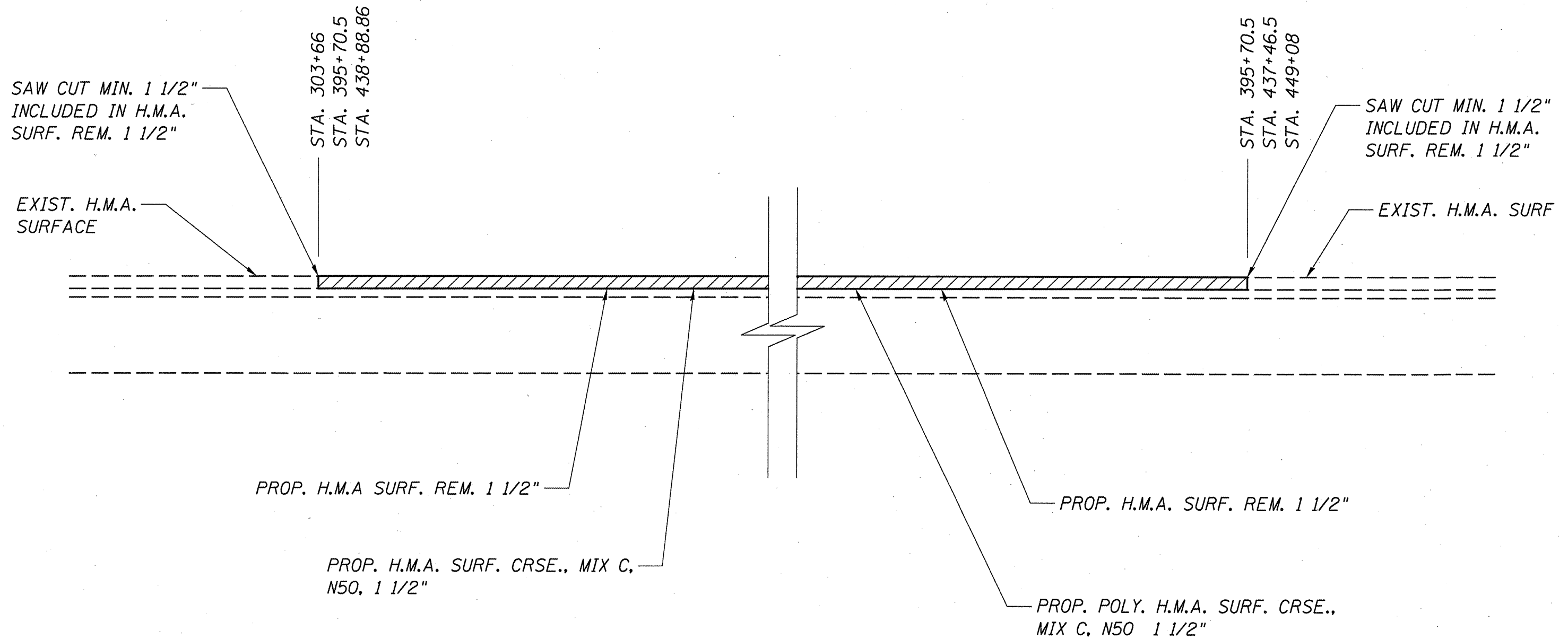

BUTT JOINT  
FAP 566 (IL 106)  
SECTION (1-NRHM,2)RS-4  
SCOTT COUNTY