

SEC 15, T7N, R6W, 3RD PM

CONTRACT 72C03

F.A.I. RTE.	SECTION	COUNTY	TOTAL SHEETS	SHEET NO.
55	*	MACOUPIN	18	13
STA. 702+00.00		TO STA. 762+00.00		
FED. ROAD DIST. NO.		ILLINOIS FED. AID PROJECT		

* SECTION D6 INTERMITTENT RS 2009

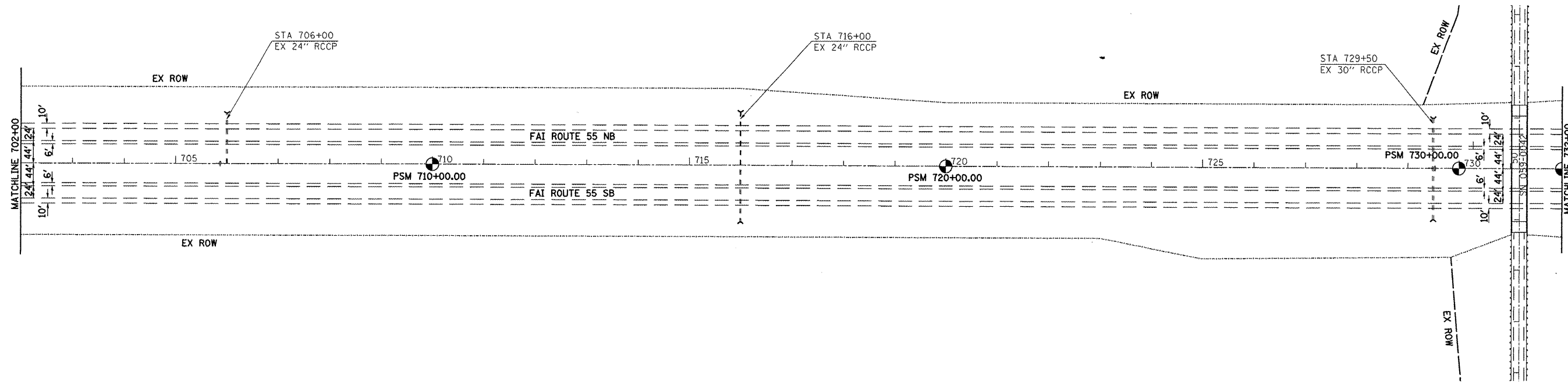

SEC 22, T7N, R6W, 3RD PM

EXIST. CURVE I55N-5
 PI STA. = 755+56.46
 $\Delta = 21^\circ 48' 40''$ (LT)
 $D = 1^\circ 00' 00''$
 $R = 5,729.58'$
 $T = 1,103.92'$
 $L = 2,181.11'$
 $E = 105.38'$
 $\theta = 2.8\%$
 P.C. STA. = 744+52.54
 P.T. STA. = 766+33.65

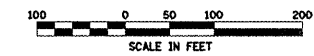
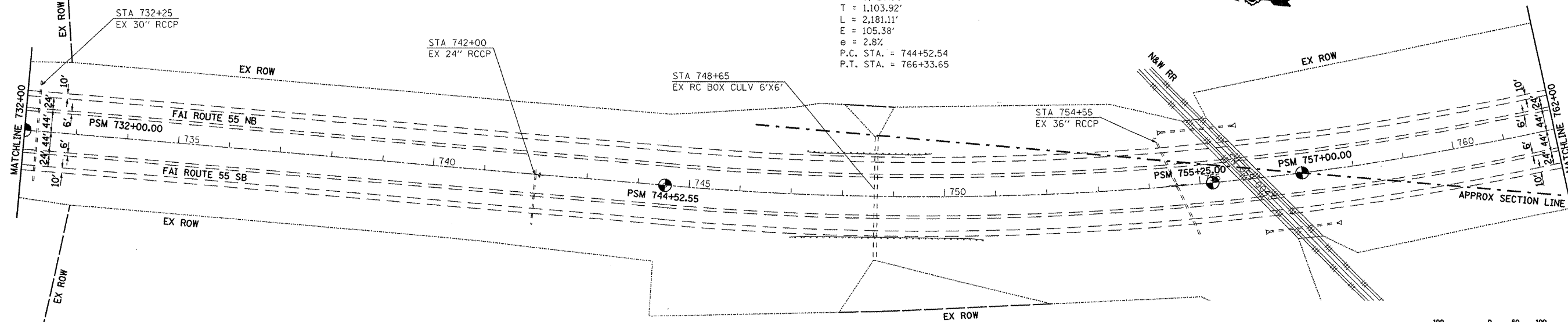

REVISIONS	
NAME	DATE

ILLINOIS DEPARTMENT OF TRANSPORTATION
 PLAN SHEETS
 FAI 55
 SECTION D6 INTERMITTENT RS 2009
 MACOUPIN COUNTY

SCALE: _____ DRAWN BY _____
 DATE: _____ CHECKED BY _____

C:\Projects\ts1\6572c03\sheet13.dgn
 Apr-01-2008 07:56:09AM
 *REF01