

F.A.P. RTE.	SECTION	COUNTY	TOTAL SHEETS	SHEET NO.
776	(101)RS-1	WAYNE	21	1

STATE OF ILLINOIS
DEPARTMENT OF TRANSPORTATION
DIVISION OF HIGHWAYS

**PROPOSED
HIGHWAY PLANS**

FAP ROUTE 776 (IL RTE 242)
SECTION (101)RS-1
WAYNE COUNTY

PROJECT NO. ACF-0776(025)

D-97-006-05

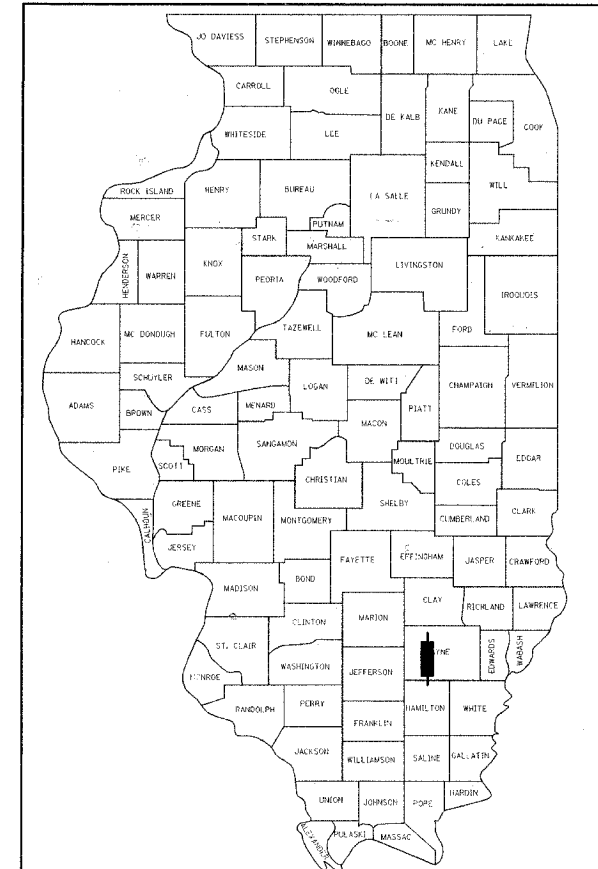

LOCATION OF SECTION INDICATED THUS: - ■ -

C-97-012-05

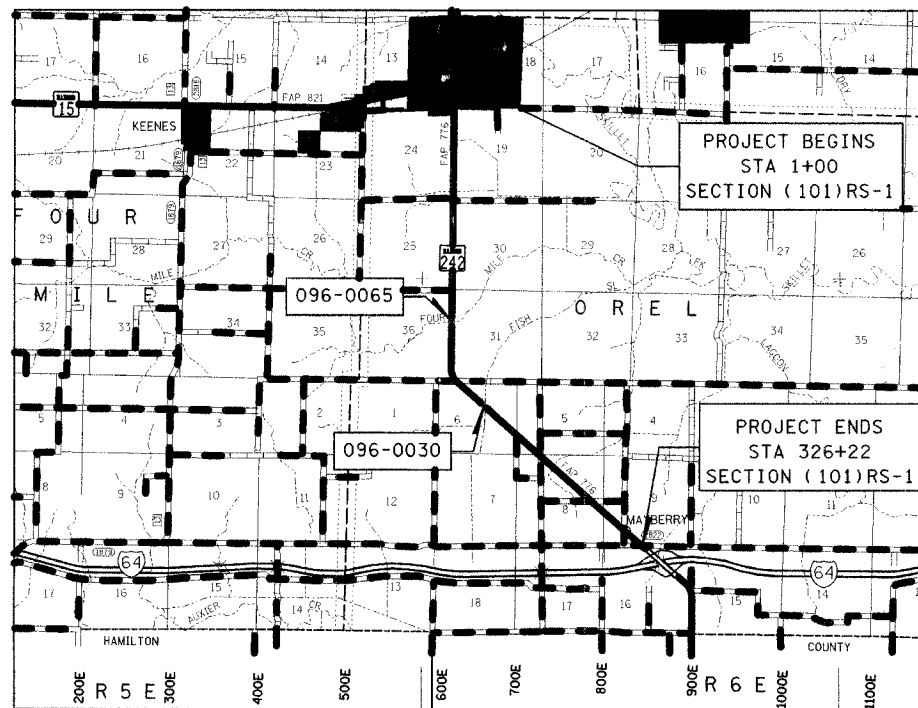

GROSS LENGTH = 32463.8 FEET = 6.200 MILES
NET LENGTH = 32274.8 FEET = 6.100 MILES

FOR INDEX OF SHEETS, SEE SHEET NO. 2

STATION EQUATIONS

STATION 180+50.7 BACK TO STATION 191+08.9 AHEAD

BRIDGE OMISSION

STATION 142+05.5 TO STATION 143+74.5

ADT (2003) = 1058

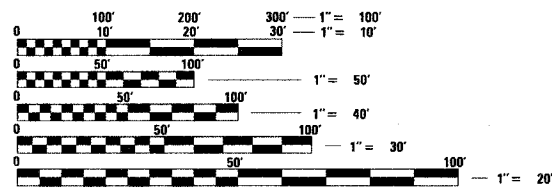

FULL SIZE PLANS HAVE BEEN PREPARED USING STANDARD ENGINEERING SCALES. REDUCED SIZED PLANS WILL NOT CONFORM TO STANDARD SCALES. IN MAKING MEASUREMENTS ON REDUCED PLANS, THE ABOVE SCALES MAY BE USED.

J.U.L.I.E.
JOINT UTILITY LOCATION INFORMATION FOR EXCAVATION
1-800-892-0123

CONTRACT NO. 74081 TOWNSHIP : OREL

teaslejack
1/17/2008
c:\projects\74081\d00605pa.dgn

PROJECT ENGINEER : BILL STANLEY
SQUAD LEADER : JEFF DAVISON
DESIGNER :
TELEPHONE : 217/342-3951 EX 314

STATE OF ILLINOIS
DEPARTMENT OF TRANSPORTATION
DIVISION OF HIGHWAYS

SUBMITTED January 30, 2008

Christine M. Reed
DEPUTY DIRECTOR OF HIGHWAYS, REGION ENGINEER

March 21, 2008
Eric E. Harold
ENGINEER OF DESIGN AND ENVIRONMENT

March 21, 2008
Christine M. Reed
DIRECTOR OF HIGHWAYS, CHIEF ENGINEER

PRINTED BY THE AUTHORITY
OF THE STATE OF ILLINOIS

GENERAL NOTES

THIS SECTION SHALL BE CONSTRUCTED IN ACCORDANCE WITH THE PLANS; THE "STANDARD SPECIFICATIONS FOR ROAD AND BRIDGE CONSTRUCTION" ADOPTED JANUARY 1, 2007; THE "SUPPLEMENTAL SPECIFICATIONS AND RECURRING SPECIAL PROVISIONS" ADOPTED JANUARY 1, 2007; AND THE SPECIAL PROVISIONS INCLUDED IN THE PROPOSAL.

THIS PROJECT IS LOCATED ON ILLINOIS ROUTE 242 IN WAYNE COUNTY, BEGINNING JUST SOUTH OF THE RAILROAD, SOUTH OF ILLINOIS ROUTE 15 IN WAYNE CITY, SOUTH TO FAI ROUTE 64. THE WORK INCLUDED IN SECTION (101)RS-1 CONSISTS OF THE PAVEMENT PATCHING, MILLING, 1 1/2" OF HOT MIX ASPHALT RESURFACING, AGGREGATE SHOULDER WEDGE AND ALL OTHER WORK NECESSARY TO COMPLETE THIS SECTION. STAGE CONSTRUCTION WILL BE UTILIZED.

STRUCTURE 096-0030 IS RESTRICTED TO LEGAL LOADS ONLY. THE VEHICLES AND EQUIPMENT USED ON THE STRUCTURE FOR MILLING OR APPLYING THE HOT MIX ASPHALT CONCRETE OVERLAY MUST CONFORM TO THE WEIGHT REQUIREMENTS AS OUTLINED IN THE ILLINOIS VEHICLE CODE.

THE CONTRACTOR WILL PROVIDE INTERNET ACCESSIBILITY TO THE HOT MIX ASPHALT PLANT QUALITY CONTROL LAB SO THAT HOT MIX ASPHALT PLANT REPORTS CAN BE E-MAILED TO THE DISTRICT HEADQUARTERS. THIS WORK SHALL BE INCLUDED IN THE COST OF ALL HOT MIX ASPHALT ITEMS.

THE REMOVAL OF THE EXISTING RESURFACING IN THE GUTTER FLAG SHALL BE (PAID FOR AS) INCLUDED IN THE COST OF HOT MIX ASPHALT SURFACE REMOVAL 1 1/2".

PAVEMENT MARKING SHALL BE APPLIED IN ACCORDANCE WITH SECTION 780 OF THE STANDARD SPECIFICATIONS. SHORT TERM PAVEMENT MARKING SHALL BE APPLIED TO THE MILLED SURFACE, BITUMINOUS MATERIALS (PRIME COAT), AND BITUMINOUS SURFACE COURSE AS SPECIFIED IN SECTION 703 OF THE STANDARD SPECIFICATIONS. TEMPORARY TAPE SHALL BE USED ON THE SURFACE COURSE AND PAINT SHALL BE USED ON MILLED SURFACES.

THE TOTAL QUANTITY OF PAINT PAVEMENT MARKING-LINE 4" CONSISTS OF 14,659 FEET OF YELLOW AND 61,526 FEET OF WHITE.

THE TOTAL QUANTITY OF RAISED REFLECTIVE PAVEMENT MARKERS IS 406 TWO-WAY AMBER.

THE EXISTING PAVEMENT SHALL BE PATCHED IN ACCORDANCE WITH SECTION 442 OF THE STANDARD SPECIFICATIONS AND THE SPECIAL PROVISIONS. THE QUANTITY OF PATCHING SHOWN ON THE PLANS IS AN ESTIMATE ONLY AND THE FINAL LOCATIONS AND QUANTITY SHALL BE DETERMINED BY THE ENGINEER IN THE FIELD.

THE THICKNESS OF THE PAVEMENT THAT IS TO BE PATCHED IS 8" & 16".

THE MATERIAL USED FOR AGGREGATE SHOULDERS, TYPE B AND AGGREGATE SURFACE COURSE, TYPE B SHALL BE CRUSHED STONE, CRUSHED CONCRETE OR R. A. P.

BITUMINOUS MATERIALS (PRIME COAT), THE CONTRACTOR SHALL USE EITHER RC-70 OR AN EMULSIFIED POLYMER PRIME SS-1HP.

THE PAY ITEM TEMPORARY RAMP HAS BEEN INCLUDED FOR THE CONSTRUCTION OF TEMPORARY RAMPS IN ACCORDANCE WITH ARTICLE 406.18 OF THE STANDARD SPECIFICATIONS. THE COST SHALL INCLUDE BOTH THE INSTALLATION AND THE REMOVAL OF THE TEMPORARY RAMPS.

THE RESIDENT ENGINEER SHALL BE THE SOLE JUDGE CONCERNING THE CURING TIME FOR THE VARIOUS HOT MIX ASPHALT LIFTS.

THE FOLLOWING MIXTURE REQUIREMENTS ARE APPLICABLE TO THIS PROJECT:

MIXTURE USE: SURFACE COURSE
APPLICATION: HOT MIX ASPHALT SURFACE COURSE, SUPERPAVE, MIX C, N70
PG GRADE: PG 64-22
DESIGN AIR VOIDS: 4.0% @ N=70
MIXTURE COMPOSITION: IL-9.5
FRICTION AGGREGATE: C SURFACE

MIXTURE USE: PAVEMENT PATCHING
APPLICATION: HOT MIX ASPHALT BINDER COURSE, SUPERPAVE, IL-19.0, N70
PG GRADE: PG 64-22
DESIGN AIR VOIDS: 4.0% @ N=70
MIXTURE COMPOSITION: IL-19.0
FRICTION AGGREGATE: N/A

MIXTURE USE: INCIDENTAL HOT MIX ASPHALT SURFACING
APPLICATION: HOT MIX ASPHALT SURFACE COURSE, SUPERPAVE, MIX C, N50
PG GRADE: 64-22
DESIGN AIR VOIDS: 4% @ N=50
MIXTURE COMPOSITION: IL-9.5
FRICTION AGGREGATE: MIX C

THE FOLLOWING RATES OF APPLICATION HAVE BEEN USED IN THE CALCULATING PLAN QUANTITIES:

AGGREGATE SURFACE COURSE 2.05 TONS/CU. YD.
AGGREGATE SHOULDERS 2.05 TONS/CU. YD.
BITUMINOUS MATERIALS (PRIME COAT) 0.10 GAL/SQ. YD
AGGREGATE (PRIME COAT) 4 LBS./SQ. YD
BITUMINOUS CONCRETE 112 LBS./SQ. YD/INCH

INDEX OF SHEETS

SHEET NO.	ITEM
1	COVER SHEET
2	INDEX OF SHEETS AND GENERAL NOTES
3	SUMMARY OF QUANTITIES
4	TYPICAL SECTIONS
5-6	SCHEDULES
7-18	PLAN SHEETS
19-20	PAVEMENT MARKING DETAIL
21	BUTT JOINT TRANSITION DETAIL

THE FOLLOWING STANDARDS ARE A PART OF THESE PLANS AND ARE INCLUDED AFTER SHEET NO. 20:

STD. NO.	DESCRIPTION
000001-05	STANDARD SYMBOLS, ABBREVIATIONS AND PATTERNS
442201-03	CLASS C AND D PATCHES
667101	PERMANENT SURVEY MARKERS
701001-01	OFF ROAD OPERATIONS, 2L, 2W, MORE THAN 4.5m (15') AWAY
701011-01	OFF ROAD MOVING OPERATIONS, 2L, 2W, DAY ONLY
701301-02	LANE CLOSURE, 2L, 2W, SHORT TIME OPERATIONS
701306-01	LANE CLOSURE, 2L, 2W, SLOW MOVING OPERATIONS, DAY ONLY FOR SPEEDS > 45 MPH
701311-02	LANE CLOSURE, 2L, 2W MOVING OPERATIONS - DAY ONLY
701336-04	LANE CLOSURE, 2L, 2W, WORK AREAS IN SERIES, FOR SPEEDS > 45 MPH
701901	TRAFFIC CONTROL DEVICES
780001-01	TYPICAL PAVEMENT MARKINGS
781001-02	TYPICAL APPLICATIONS RAISED REFLECTIVE PAVEMENT MARKERS

CONTRACT NO. 74081				
F.A.P. RTE.	SECTION	COUNTY	TOTAL SHEETS	SHEET NO.
776	(101)RS-1	WAYNE	21	2
STA.		TO STA.		
FED. ROAD DIST. NO.		ILLINOIS	FED. AID PROJECT	

REVISIONS		ILLINOIS DEPARTMENT OF TRANSPORTATION
NAME	DATE	
		<p align="center">GENERAL NOTES & INDEX OF SHEETS</p> <p>SCALE: VERT. _____ DATE: _____</p> <p align="right">DRAWN BY _____ CHECKED BY _____</p>

teaslejuick
1/17/2008
c:\projects\74081\d00605pa.dgn

PLOT DATE = 1/17/2008
FILE NAME = c:\projects\74081\d00605pa.dgn
PLOT SCALE = 50.0000 / IN.
USER NAME = teaslejuick

teaslejack
1/17/2008
c:\projects\74081\d00605pa.dgn

CONTRACT NO. 74081

F.A.P. RTE.	SECTION	COUNTY	TOTAL SHEETS	SHEET NO.
776	(10)RS-1	WAYNE	21	3
STA.		TO STA.		
FED. ROAD DIST. NO.	ILLINOIS	FED. AID PROJECT		

SUMMARY OF QUANTITIES			TOTAL QUANTITIES	CONSTRUCTION TYPE CODE		
CODE NO	ITEM	UNIT		1000 80% FED. / 20% STATE	1000 50%/50% CITY/STATE	Y025 100% CITY
40200800	AGGREGATE SURFACE COURSE, TYPE B	TON	126	126		
40600100	BITUMINOUS MATERIALS (PRIME COAT)	GALLON	9522	9296	226	
40600300	AGGREGATE (PRIME COAT)	TON	190	186	4	
40600895	CONSTRUCTING TEST STRIP	EACH	1	1		
40600982	HOT-MIX ASPHALT SURFACE REMOVAL - BUTT JOINT	SQ YD	360	340	20	
40600990	TEMPORARY RAMP	SQ YD	65	56	9	
40603315	HOT-MIX ASPHALT SURFACE COURSE, MIX "C", N70	TON	7998	7808	190	
40800050	INCIDENTAL HOT-MIX ASPHALT SURFACING	TON	90	90		
44000155	HOT-MIX ASPHALT SURFACE REMOVAL, 1 1/2"	SQ YD	3372	3372		
44000198	HOT-MIX ASPHALT SURFACE REMOVAL, VARIABLE DEPTH	SQ YD	91486	89245		2241
44200094	PAVEMENT PATCHING, TYPE II, 8 INCH	SQ YD	53			53
44200099	PAVEMENT PATCHING, TYPE III, 8 INCH	SQ YD	49			49
44200101	PAVEMENT PATCHING, TYPE IV, 8 INCH	SQ YD	26			26
44200192	PAVEMENT PATCHING, TYPE II, 16 INCH	SQ YD	89	89		
48101200	AGGREGATE SHOULDERS, TYPE B	TON	2355	2355		
66700095	PERMANENT SURVEY MARKERS	EACH	2	2		
67000500	ENGINEER'S FIELD OFFICE, TYPE B	CAL MO	4	4		
67100100	MOBILIZATION	L SUM	1	1		
70100460	TRAFFIC CONTROL AND PROTECTION, STANDARD 701306	L SUM	1	1		
70100600	TRAFFIC CONTROL AND PROTECTION, STANDARD 701336	L SUM	1	1		
70300100	SHORT-TERM PAVEMENT MARKING	FOOT	9683	9683		
70300220	TEMPORARY PAVEMENT MARKING - LINE 4"	FOOT	75216	75216		
70301000	WORK ZONE PAVEMENT MARKING REMOVAL	SQ FT	1076	1076		
* 78001110	PAINT PAVEMENT MARKING - LINE 4"	FOOT	76185	75641		544
* 78100100	RAISED REFLECTIVE PAVEMENT MARKER	EACH	406	406		
Z0048665	RAILROAD PROTECTIVE LIABILITY INSURANCE	L SUM	1	1		

* SPECIALTY ITEMS

REVISIONS	
NAME	DATE

ILLINOIS DEPARTMENT OF TRANSPORTATION
SUMMARY OF QUANTITIES
SCALE: VERT. DATE
HORIZ. DATE
DRAWN BY
CHECKED BY

PLOT DATE = 1/17/2008
PLOT NAME = c:\projects\74081\d00605pa.dgn
PLOT SCALE = 5/8" = 1' IN.
USER NAME = teaslejack

F.A.P. RTE.	SECTION	COUNTY	TOTAL SHEETS	SHEET NO.
776	(10)RS-1	WAYNE	21	4
STA.		TO STA.		
FED. ROAD DIST. NO.		ILLINOIS FED. AID PROJECT		

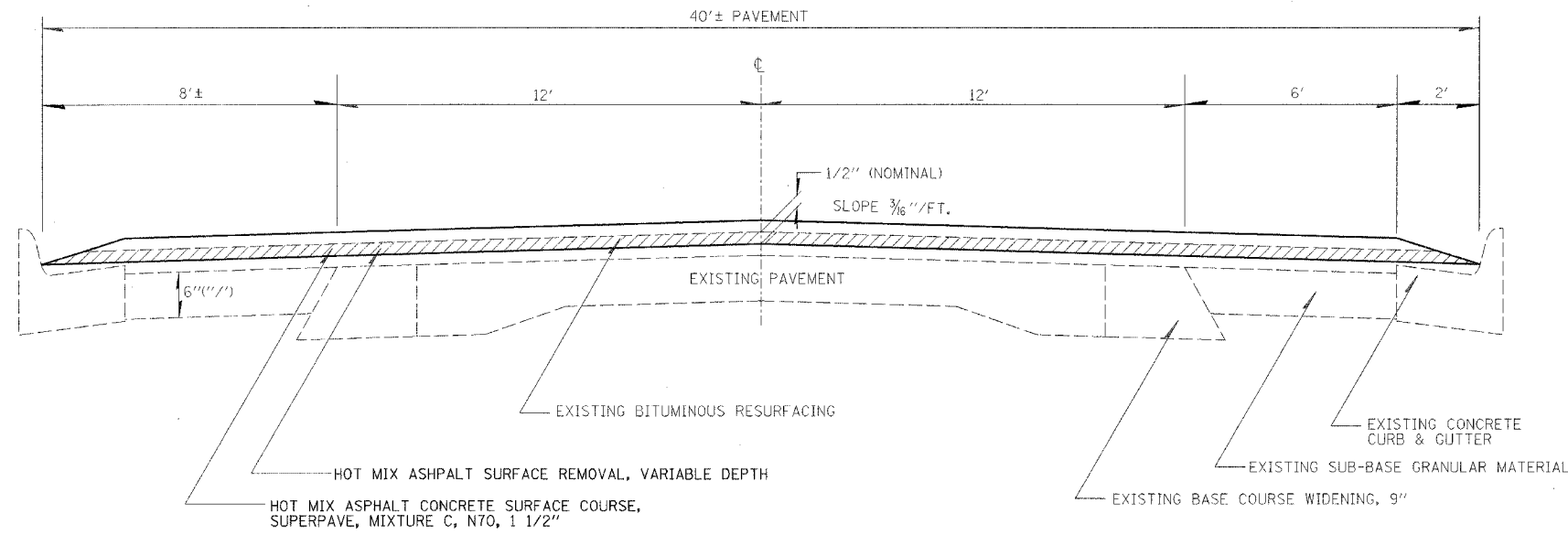

STA. 1+00 TO STA. 13+72

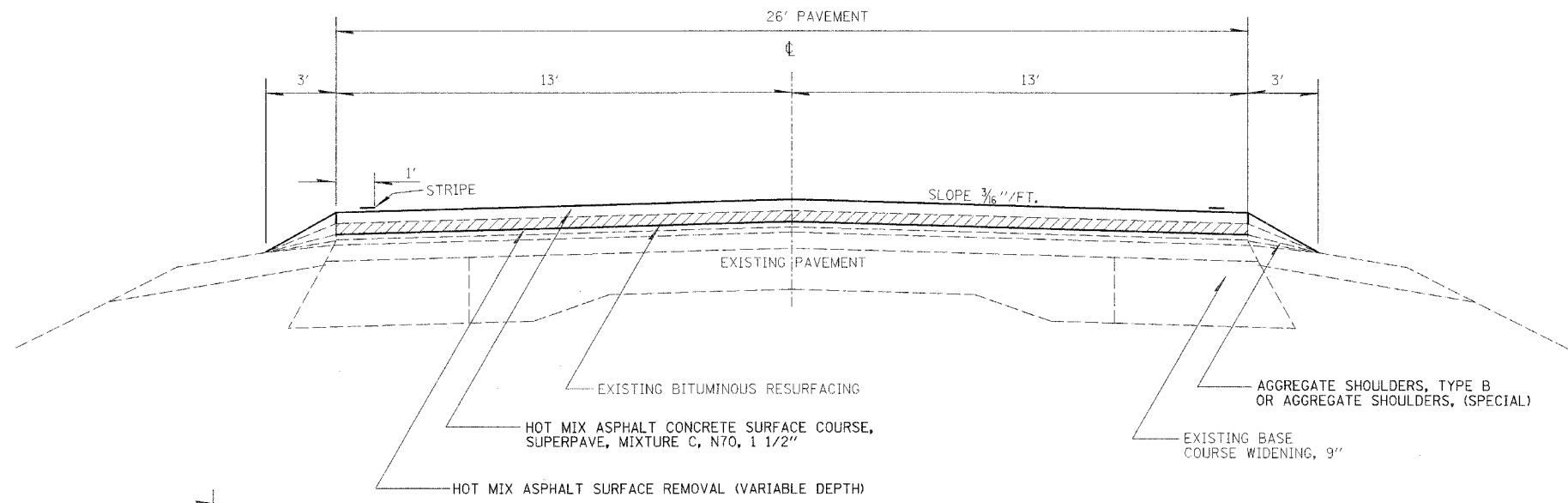

STA 13+72 TO STA 326+22

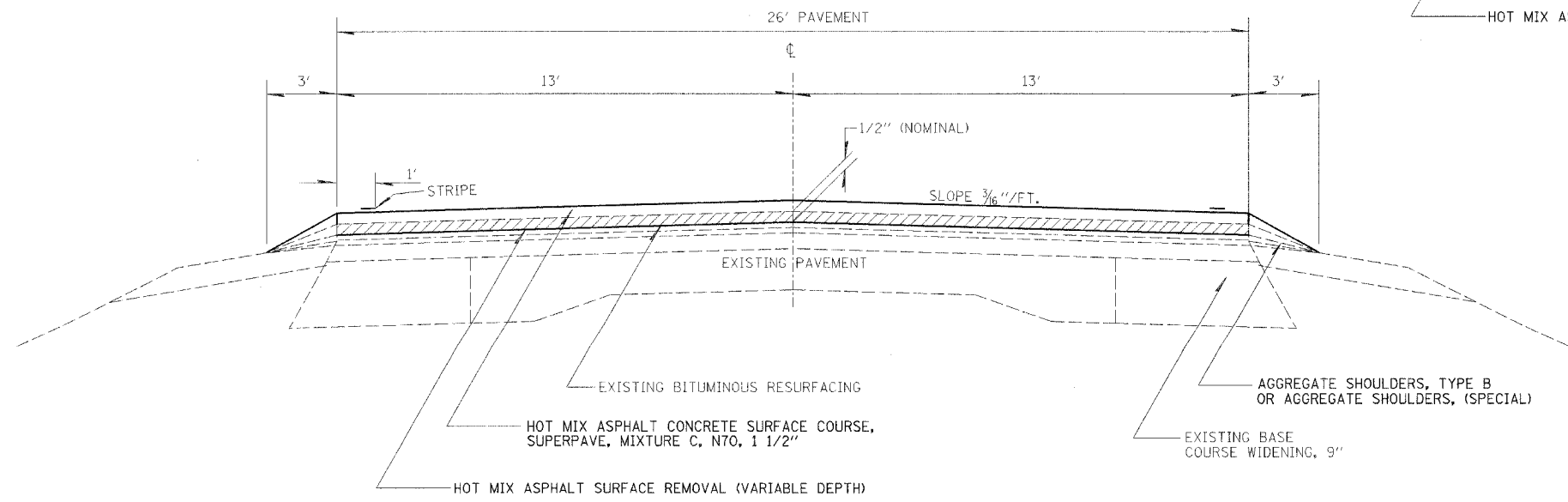

STA 13+72 TO STA 326+22

REVISIONS	
NAME	DATE

ILLINOIS DEPARTMENT OF TRANSPORTATION

TYPICAL SECTIONS

SCALE: VERT. _____
 HORIZ. _____

DATE _____ DRAWN BY _____
 CHECKED BY _____

teesleyck
 1/17/2008
 c:\projects\74081d\00605pa.dgn

PLOT DATE = 1/17/2008
 FILE NAME = 74081d\00605pa.dgn
 PLOT SCALE = 50.0000 / IN.
 USER NAME = teesleyck

F.A.P. RITE.	SECTION	COUNTY	TOTAL SHEETS	SHEET NO.
776	(01)RS-1	WAYNE	21	6
STA.	TO STA.			
FED. ROAD DIST. NO.	ILLINOIS	FED. AID PROJECT		

PAVING SCHEDULE

STATION TO STATION		LENGTH	EXISTING PAVEMENT WIDTH	AREA	BITUMINOUS MATERIALS (PRIME COAT)	AGGREGATE (PRIME COAT)	BITUMINOUS SURFACE COURSE, SUPERPAVE, MIX "C", N70, 1 1/2"	LEVELING BINDER, MACHINE METHOD SUPERPAVE, N70, 3/4"	HOT MIX ASPHALT SURFACE REMOVAL - BUTT JOINT	HOT MIX ASPHALT SURFACE REMOVAL - 1 1/2"	HOT MIX ASPHALT SURFACE REMOVAL (VARIABLE DEPTH)	AGGREGATE SHOULDERS, TYPE B	TEMPORARY RAMP
		LIN FT	FEET	SQ YD	GALLON	TON	TON	TON	SQ YD	SQ YD	SQ YD	TON	SQ YD
1+00.00 TO 13+72.00	13+72.00	1,272.0	40.0	5,653.3	565.3	11.3	474.9			100	5,553.3		22.2
13+72.00 TO 14+02.00	14+02.00	30.0	26.0	86.7	8.7	0.2	7.3				86.7	2.4	
14+02.00 TO 29+53.00	29+53.00	1,551.0	26.0	4,480.7	448.1	9.0	376.4				4,480.7	125.4	
29+53.00 TO 29+83.00	29+83.00	30.0	26.0	86.7	8.7	0.2	7.3				86.7	2.4	
29+83.00 TO 30+83.00	30+83.00	100.0	26.0	288.9	28.9	0.6	24.3			288.9		8.1	
30+83.00 TO 31+13.00	31+13.00	30.0	26.0	86.7	8.7	0.2	7.3				86.7	2.4	
31+13.00 TO 65+10.00	65+10.00	3,397.0	26.0	9,813.6	981.4	19.6	824.3				9,813.6	274.7	14.4
65+10.00 TO 65+40.00	65+40.00	30.0	26.0	86.7	8.7	0.2	7.3				86.7	2.4	
65+40.00 TO 69+76.00	69+76.00	436.0	26.0	1,259.6	126.0	2.5	105.8			1259.6		35.3	14.4
69+76.00 TO 70+06.00	70+06.00	30.0	26.0	86.7	8.7	0.2	7.3				86.7	2.4	
70+06.00 TO 141+75.50	141+75.50	7,169.5	26.0	20,711.9	2,071.2	41.4	1,739.8				20,711.9	579.7	
141+75.50 TO 142+05.50	142+05.50	30.0	26.0	86.7	8.7	0.2	7.3	87				2.4	
142+05.50 TO 143+94.50	143+94.50	189.0											
143+94.50 TO 144+24.50	144+24.50	30.0	26.0	86.7	8.7	0.2	7.3	87				2.4	
144+24.50 TO 158+30.00	158+30.00	1,405.5	26.0	4,060.3	406.0	8.1	341.1				4,060.3	113.7	
158+30.00 TO 158+60.00	158+60.00	30.0	26.0	86.7	8.7	0.2	7.3				86.7	2.4	
158+60.00 TO 159+60.00	159+60.00	100.0	26.0	288.9	28.9	0.6	24.3			288.9		8.1	
159+60.00 TO 159+90.00	159+90.00	30.0	26.0	86.7	8.7	0.2	7.3				86.7	2.4	
159+90.00 TO 180+50.70	180+50.70	2,060.7	26.0	5,953.1	595.3	11.9	500.1				5,953.1	166.6	
180+50.70 = 181+08.90	181+08.90												
181+08.90 TO 203+72.50	203+72.50	2,263.6	26.0	6,539.3	653.9	13.1	549.3				6,539.3	183.0	
203+72.50 TO 204+02.50	204+02.50	30.0	26.0	86.7	8.7	0.2	7.3				86.7	2.4	
204+02.50 TO 204+52.50	204+52.50	50.0	26.0	144.4	14.4	0.3	12.1			144.4		4.0	
204+52.50 TO 204+83.50	204+83.50	31.0	26.0	89.6	9.0	0.2	7.5			89.6		2.4	
204+83.50 TO 205+33.50	205+33.50	50.0	26.0	144.4	14.4	0.3	12.1			144.4		4.0	
205+33.50 TO 205+63.50	205+63.50	30.0	26.0	86.7	8.7	0.2	7.3				86.7	2.4	
205+63.50 TO 210+61.00	210+61.00	497.5	26.0	1,437.2	143.7	2.9	120.7				1,437.2	40.2	14.4
210+61.00 TO 210+91.00	210+91.00	30.0	26.0	86.7	8.7	0.2	7.3				86.7	2.4	
210+91.00 TO 211+91.00	211+91.00	100.0	26.0	288.9	28.9	0.6	24.3			288.9		8.1	
211+91.00 TO 212+21.00	212+21.00	30.0	26.0	86.7	8.7	0.2	7.3				86.7	2.4	
212+21.00 TO 256+41.00	256+41.00	4,420.0	26.0	12,768.9	1,276.9	25.5	1,072.6				12,768.9	357.4	
256+41.00 TO 256+71.00	256+71.00	30.0	26.0	86.7	8.7	0.2	7.3				86.7	2.4	
256+71.00 TO 257+71.00	257+71.00	100.0	26.0	288.9	28.9	0.6	24.3			288.9		8.1	
257+71.00 TO 258+01.00	258+01.00	30.0	26.0	86.7	8.7	0.2	7.3				86.7	2.4	
258+01.00 TO 284+86.00	284+86.00	2,685.0	26.0	7,756.7	775.7	15.5	651.6				7,756.7	217.1	
284+86.00 TO 285+16.00	285+16.00	30.0	26.0	86.7	8.7	0.2	7.3				86.7	2.4	
285+16.00 TO 286+16.00	286+16.00	100.0	26.0	288.9	28.9	0.6	24.3			288.9		8.1	
286+16.00 TO 286+46.00	286+46.00	30.0	26.0	86.7	8.7	0.2	7.3				86.7	2.4	
286+46.00 TO 321+10.00	321+10.00	3,464.0	26.0	10,007.1	1,000.7	20.0	840.6				10,007.1	280.1	
321+10.00 TO 321+40.00	321+40.00	30.0	26.0	86.7	8.7	0.2	7.3				86.7	2.4	
321+40.00 TO 322+40.00	322+40.00	100.0	26.0	288.9	28.9	0.6	24.3			288.9		8.1	
322+40.00 TO 322+70.00	322+70.00	30.0	26.0	86.7	8.7	0.2	7.3				86.7	2.4	
322+70.00 TO 325+92.00	325+92.00	322.0	26.0	930.2	93.0	1.9	78.1				930.2	26.0	
325+92.00 TO 326+22.00	326+22.00	30.0	26.0	86.7	8.7	0.2	7.3	86.7				2.4	
PROJECT TOTALS		32,464		95,217	9,522	190	7,998		360	3371	91486	2504	65
ADJUSTED TOTALS												2355	

PAVEMENT MARKING SCHEDULE

STATION TO STATION	LENGTH	SHORT TERM PAVEMENT MARKING	WORK ZONE PAVEMENT MARKING REMOVAL	PAINT PAVEMENT MARKING - LINE 4"	RAISED REFLECTIVE PAVEMENT MARKER	TEMPORARY PAINT PAVEMENT MARKING LINE 4"	PAINT PAVEMENT MARKING - LINE 6"	TEMPORARY PAINT PAVEMENT MARKING - LINE 6"	TEMPORARY PAVEMENT MARKING - LETTERS & SYMBOLS	PAINT PAVEMENT MARKING - LETTERS & SYMBOLS
	FEET	FT.	SQ. FT.	FT.	EACH	FT.	FT.	FT.	SQ. FT.	SQ. FT.
1+00.00 TO 13+72.00	1,272.0	381.6	42.4	318.0	16	318.0	0	0	0	0
13+72.00 TO 142+05.50	12,833.5	3,850.1	427.8	28,682.4	160	28,682.4	0	0	0	0
142+05.50 TO 143+94.50	BRIDGE			425.3	2					
143+94.50 TO 180+50.70	3,656.2	1,096.9	121.9	7,986.5	46	7,986.5	0	0	0	0
180+50.70 = 181+08.90	STATION EQUATION									
181+08.90 TO 326+22.00	14,513.1	4,353.9	483.8	38,229.0	181	38,229.0	0	0	0	0
DOWNTOWN PARKING LANES				544						
PROJECT TOTALS	32,275	9,683	1,076	76,185	406	75,216	0	0	0	0

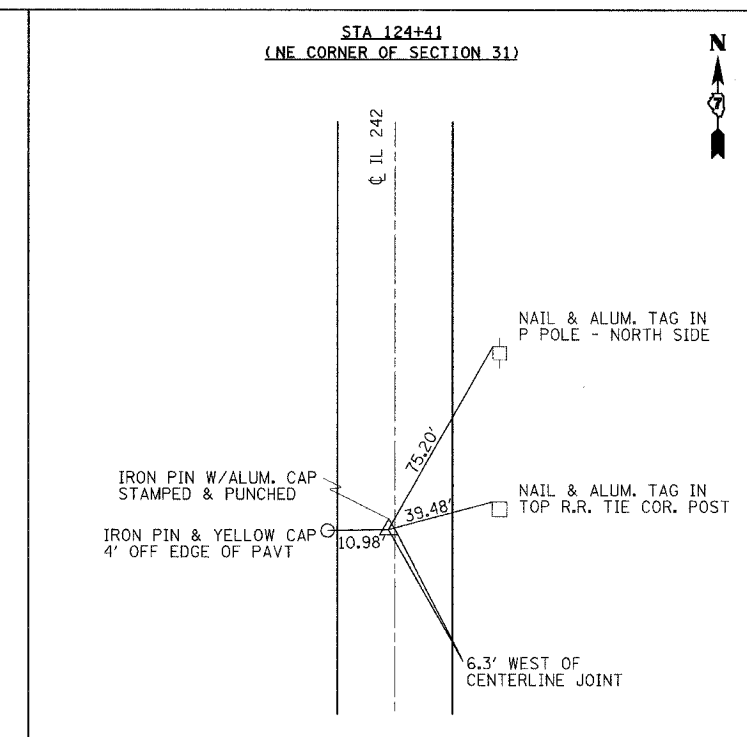
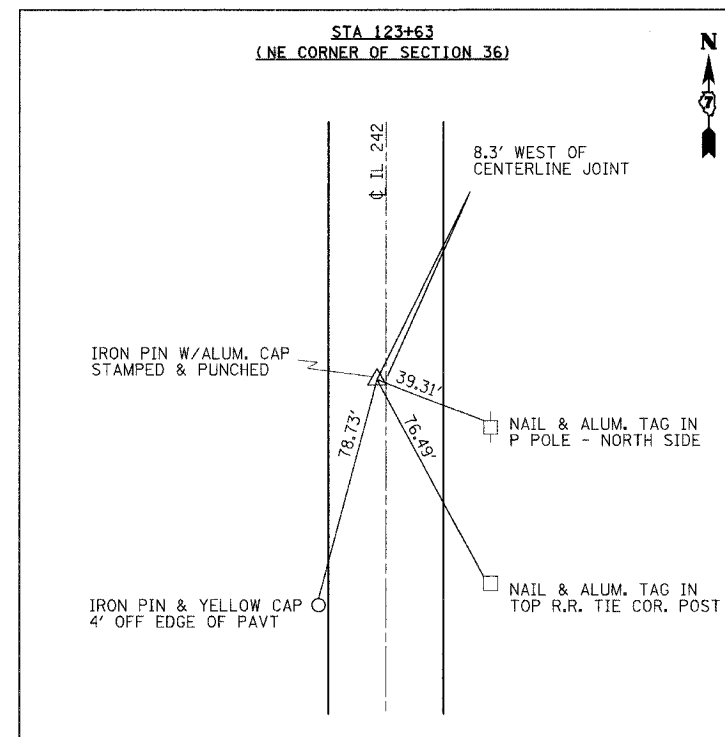

PATCHING SCHEDULE

DIRECTION	TYPE II SQ YD	TYPE III SQ YD	TYPE IV SQ YD
NBL	113.0	49.0	26.0
SBL	29.3	0.0	0.0
TOTAL	142.3	49.0	26.0

REVISIONS	
NAME	DATE

ILLINOIS DEPARTMENT OF TRANSPORTATION

SCHEDULES & TIES

SCALE: VERT. HORIZ. DATE

DRAWN BY CHECKED BY

F.A.P. RTE.	SECTION	COUNTY	TOTAL SHEETS	SHEET NO.
776	(10)RS-1	WAYNE	21	7
STA.		TO STA.		
FED. ROAD DIST. NO.		ILLINOIS FED. AID PROJECT		

teesleyck
1/17/2008
c:\projects\74081d\400605p.dgn
PS 1

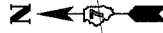

PROJECT BEGINS STA 1+00

POT STA 0+55.00

+80 PRA

+00

+30

+33 PRA MARKET ST.

+14 PRA MILL ST.

+44 PRA MEADOW ST.

+31 PRA CENTER ST.

+74 PRA CENTER ALLEY

+48 PE

+54 PE

+72

+02

+30 PRA SECTION LINE RD

+64 PE

15+00

110+00

115+00

+33 PRA

+14 PRA

+44 PRA

+44 PE

+45 PE

+15 PE

+84 PE

+30 PRA



+64 PE

+46 MBT

+58 PE

+04 PE

+84 MBT

+02 PE

+58 PE

+91 MBT

+07 PE

+19 PE

+30 PE

+38 FE

+78 PE

+36 PE

+53

+83

+90 FE

115+00

120+00

125+00

130+00

+90 PE

+92 PE

+43 PE

+66 PE

+30 PE

HOT MIX ASPHALT SURFACE REMOVAL 1 1/2"

PAVEMENT TRANSITION (See Detail Sheet #)



REVISIONS	
NAME	DATE

ILLINOIS DEPARTMENT OF TRANSPORTATION
**STA 0+55
TO
STA 30+00**
SCALE: VERT. / HORIZ.
DATE / DRAWN BY / CHECKED BY

PLOT DATE = 1/17/2008
FILE NAME = c:\projects\74081d\400605p.dgn
PLOT SCALE = 5/8" = 1' IN.
USER NAME = teesleyck

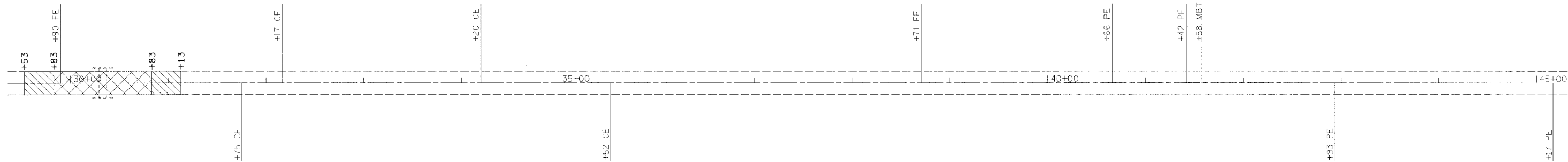
F.A.P. RTE.	SECTION	COUNTY	TOTAL SHEETS	SHEET NO.
776	(10)RS-1	WAYNE	21	8
STA.		TO STA.		
FED. ROAD DIST. NO.		ILLINOIS FED. AID PROJECT		



 HOT MIX ASPHALT SURFACE REMOVAL 1 1/2"
 PAVEMENT TRANSITION (See Detail Sheet #)

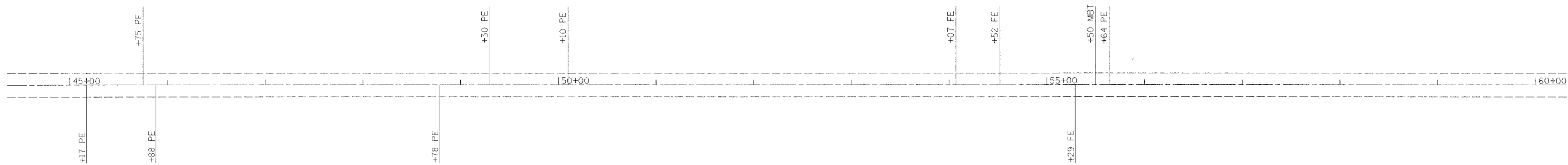
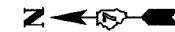

REVISIONS	
NAME	DATE

ILLINOIS DEPARTMENT OF TRANSPORTATION

STA 30 + 00
TO
STA 60 + 00

SCALE: VERT. / HORIZ.
DATE / DRAWN BY / CHECKED BY

teesleyck
1/17/2008
c:\projects\74081\d\0605pa.dgn
PS 2

PLOT DATE = 1/17/2008
PLOT SCALE = 50.0000 / IN.
USER NAME = teesleyck

F.A.P. RTE.	SECTION	COUNTY	TOTAL SHEETS	SHEET NO.
776	(10)RS-1	WAYNE	21	9
STA.		TO STA.		
FED. ROAD DIST. NO.		ILLINOIS FED. AID PROJECT		

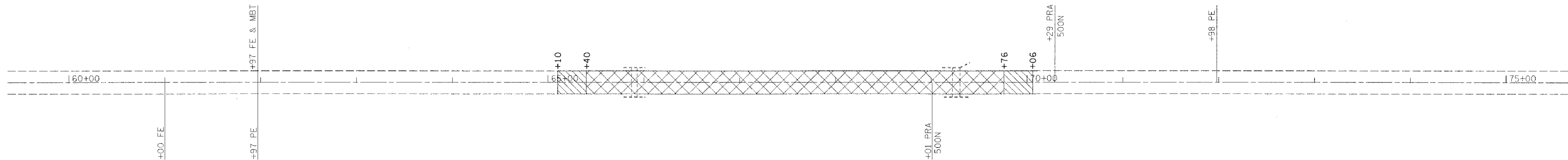

- HOT MIX ASPHALT SURFACE REMOVAL 1 1/2"
- PAVEMENT TRANSITION

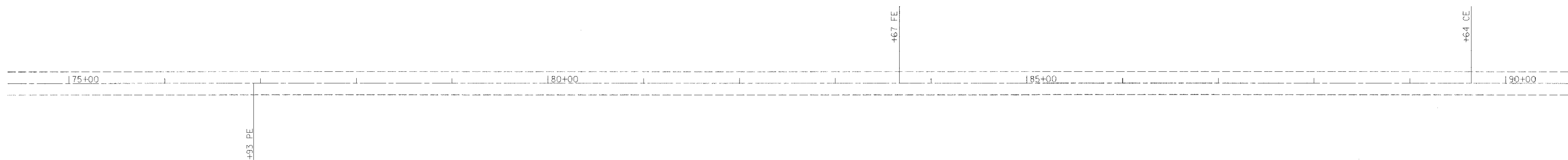

REVISIONS	
NAME	DATE

ILLINOIS DEPARTMENT OF TRANSPORTATION
STA 60+00
TO
STA 90+00

SCALE: VERT. / HORIZ.
 DATE / DRAWN BY / CHECKED BY

teaslejack
 1/17/2008
 c:\projects\74081d\400605pa.dgn
 PS 3

PLOT DATE = 1/17/2008
 PLOT NAME = 74081d\400605pa.dgn
 PLOT SCALE = 5/8" = 1' / IN.
 USER NAME = teaslejack

F.A.P. RTE.	SECTION	COUNTY	TOTAL SHEETS	SHEET NO.
776	(101)RS-1	WAYNE	21	10
STA.		TO STA.		
FED. ROAD DIST. NO.		ILLINOIS FED. AID PROJECT		

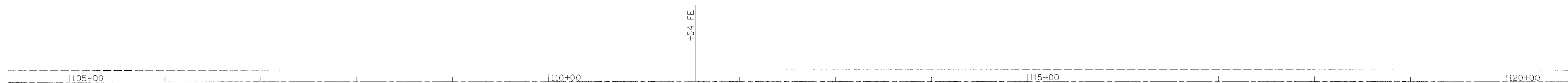
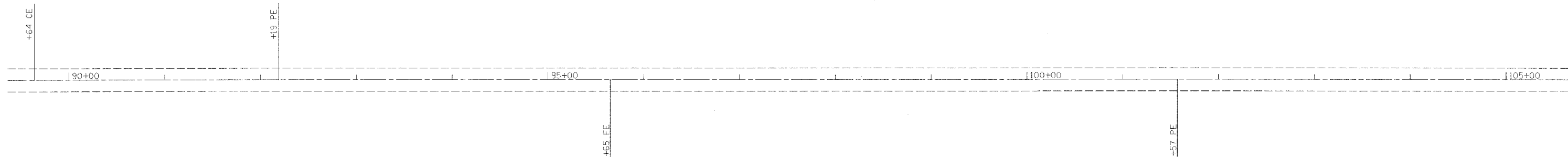
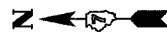

REVISIONS	
NAME	DATE

ILLINOIS DEPARTMENT OF TRANSPORTATION
STA 90 + 00
TO
STA 120 + 00

SCALE: VERT. DRAWN BY
 HORIZ. CHECKED BY
 DATE

teesleyck
 1/17/2008
 c:\projects\74081d\00605pa.dgn
 PS 4

PLOT DATE = 1/17/2008
 PLOT SCALE = 3/32" = 1' IN.
 USER NAME = teesleyck

F.A.P. RTE.	SECTION	COUNTY	TOTAL SHEETS	SHEET NO.
776	101RS-1	WAYNE	21	11
STA.		TO STA.		
FED. ROAD DIST. NO.		ILLINOIS FED. AID PROJECT		

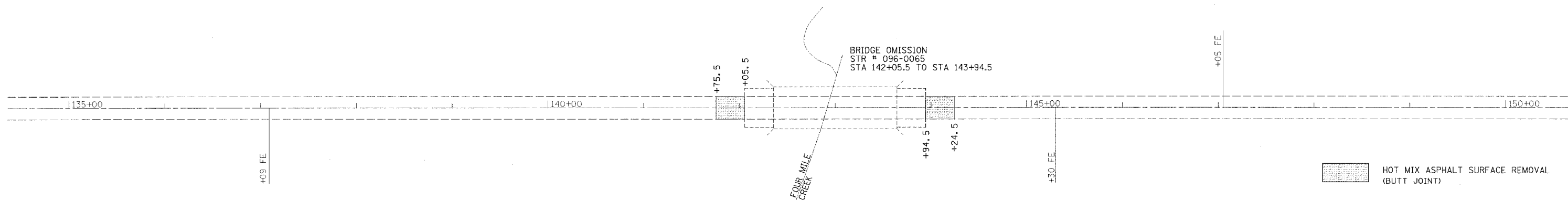
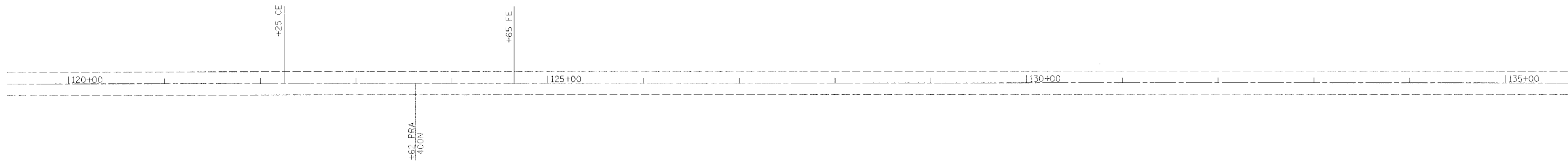
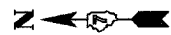

REVISIONS	
NAME	DATE

ILLINOIS DEPARTMENT OF TRANSPORTATION
STA 120 + 00
TO
STA 150 + 00
 SCALE: VERT. _____
 HORIZ. _____
 DATE _____ DRAWN BY _____
 CHECKED BY _____

teaslejack
 1/17/2008
 c:\projects\74081\d00605p0.dgn
 PS 5

PLOT DATE = 1/17/2008
 PLOT SCALE = 1/4"=100'
 USER NAME = teaslejack

F.A.P. RTE.	SECTION	COUNTY	TOTAL SHEETS	SHEET NO.
776	(10)RS-1	WAYNE	21	12
STA.		TO STA.		
FED. ROAD DIST. NO.		ILLINOIS FED. AID PROJECT		

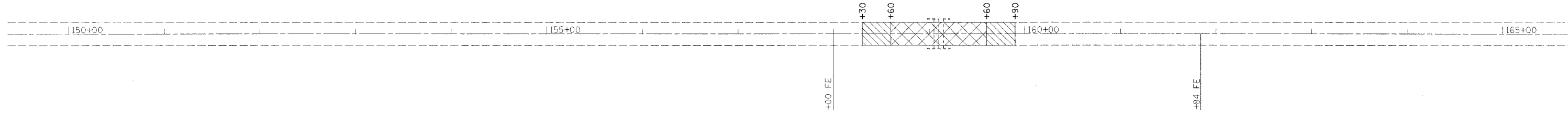

HOT MIX ASPHALT SURFACE REMOVAL 1 1/2"
 PAVEMENT TRANSITION

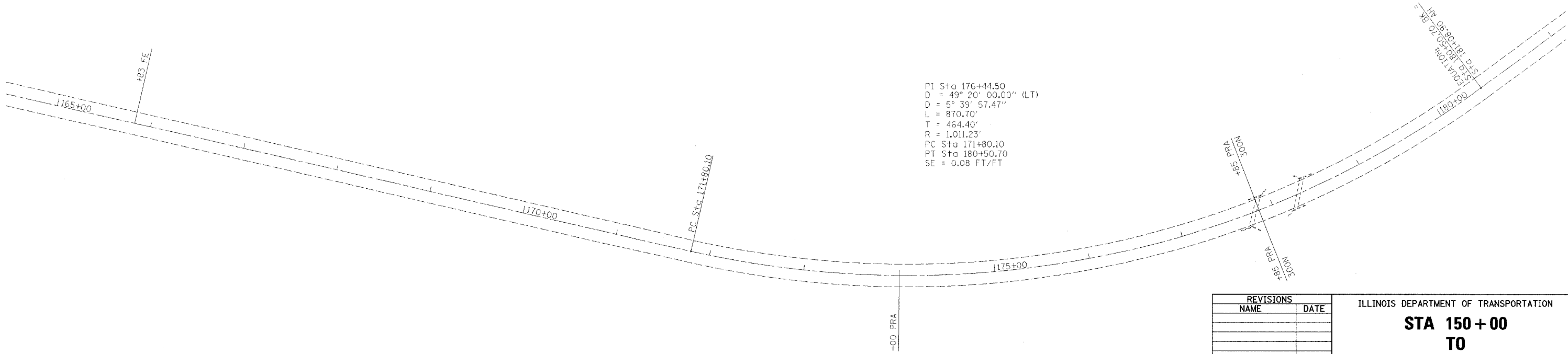

PI Sta 176+44.50
 D = 49° 20' 00.00" (LT)
 D = 5° 39' 57.47"
 L = 870.70'
 T = 464.40'
 R = 1,011.23'
 PC Sta 171+80.10
 PT Sta 180+50.70
 SE = 0.08 FT/FT

REVISIONS	
NAME	DATE

ILLINOIS DEPARTMENT OF TRANSPORTATION

STA 150 + 00
TO
STA 180 + 00

SCALE: VERT. _____
HORIZ. _____

DATE _____ DRAWN BY _____
CHECKED BY _____

F.A.P. RTE.	SECTION	COUNTY	TOTAL SHEETS	SHEET NO.
776	(10)RS-1	WAYNE	21	15
STA.		TO STA.		
FED. ROAD DIST. NO.		ILLINOIS FED. AID PROJECT		

teesleyck
1/17/2008
c:\projects\74081d\00605pe.dgn
PS 7

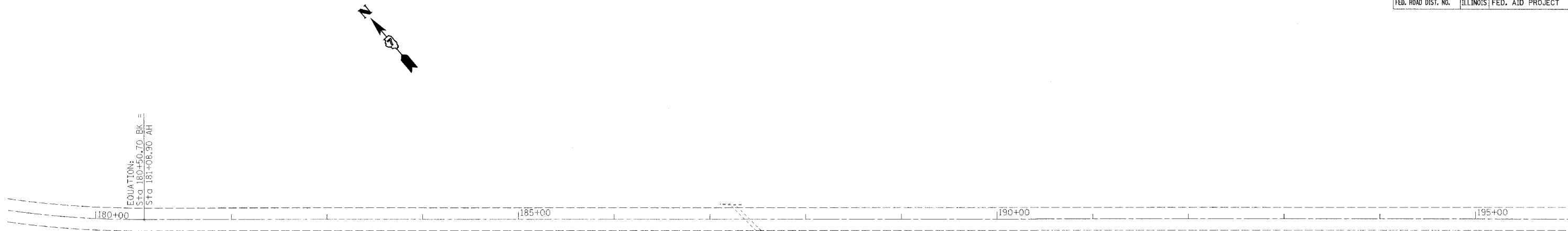

EQUATION:
Sta 180+50.70 BK =
Sta 181+08.90 AH

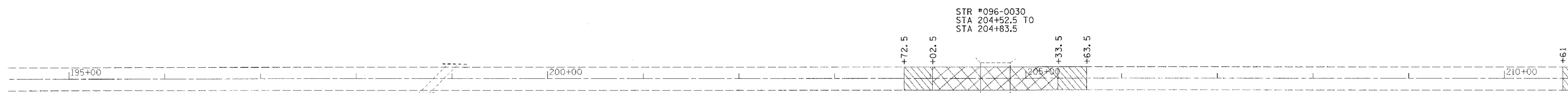
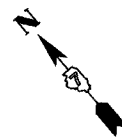

STR *096-0030
STA 204+52.5 TO
STA 204+83.5

- HOT MIX ASPHALT SURFACE REMOVAL 1 1/2"
- PAVEMENT TRANSITION

REVISIONS	
NAME	DATE

ILLINOIS DEPARTMENT OF TRANSPORTATION

**STA 180 + 00
TO
STA 210 + 00**

SCALE: VERT.
HORIZ.
DATE

DRAWN BY
CHECKED BY

PLT DATE = 1/17/2008
PLT TIME = 10:00:00 AM
PLT SCALE = 50.0000' / IN.
USER NAME = teesleyck

F.A.P. RTE.	SECTION	COUNTY	TOTAL SHEETS	SHEET NO.
776	(10)RS-1	WAYNE	21	14
STA.		TO STA.		
FED. ROAD DIST. NO.	ILLINOIS	FED. AID PROJECT		

teosleyck
1/17/2008
c:\projects\74081\400605pa.dgn
PS 8

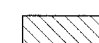

 HOT MIX ASPHALT SURFACE REMOVAL 1 1/2"
 PAVEMENT TRANSITION



REVISIONS	
NAME	DATE

ILLINOIS DEPARTMENT OF TRANSPORTATION
**STA 210 + 00
TO
STA 240 + 00**
SCALE: VERT. / HORIZ. / DATE
DRAWN BY / CHECKED BY

PLOT DATE = 1/17/2008
PLOT SCALE = 50.0000' / IN.
USER NAME = teosleyck

F.A.P. RTE.	SECTION	COUNTY	TOTAL SHEETS	SHEET NO.
776	(10)RS-1	WAYNE	21	15
STA.		TO STA.		
FED. ROAD DIST. NO.		ILLINOIS FED. AID PROJECT		

teosleyck
1/17/2008
ct:\projects\74081\00605\pa.dgn

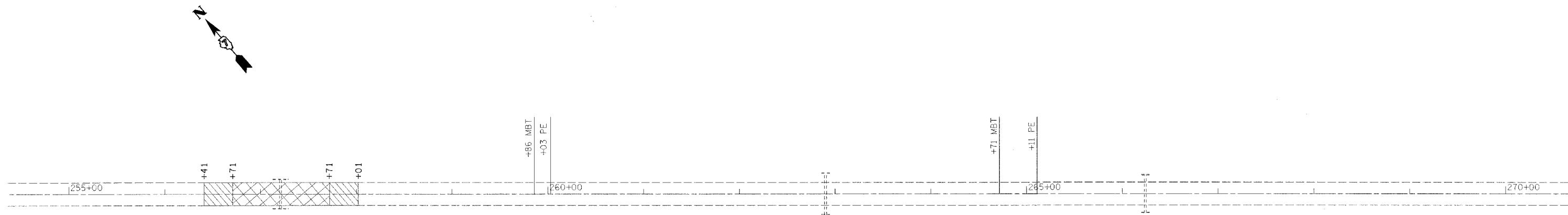

- HOT MIX ASPHALT SURFACE REMOVAL 1 1/2"
- PAVEMENT TRANSITION

REVISIONS	
NAME	DATE

ILLINOIS DEPARTMENT OF TRANSPORTATION
STA 240 + 00
TO
STA 270 + 00

SCALE: VERT. _____
HORIZ. _____

DATE _____ DRAWN BY _____
CHECKED BY _____

PLOT DATE = 1/17/2008
PLOT SCALE = 8/3200 / IN.
USER NAME = teosleyck

F.A.P. RTE.	SECTION	COUNTY	TOTAL SHEETS	SHEET NO.
776	(10)DRS-1	WAYNE	21	16
STA.		TO STA.		
FED. ROAD DIST. NO.		ILLINOIS FED. AID PROJECT		

teasleyck
1/17/2008
c:\projects\74081\d\00605pa.dgn
PS 10

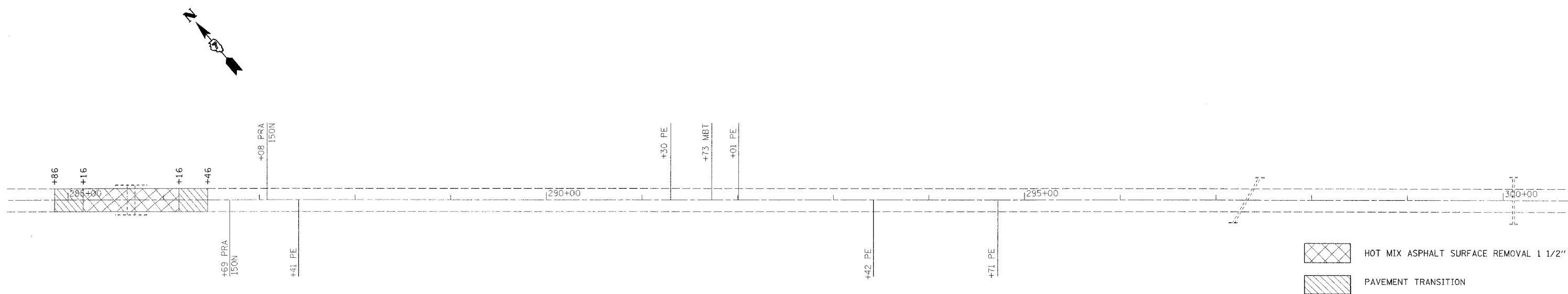
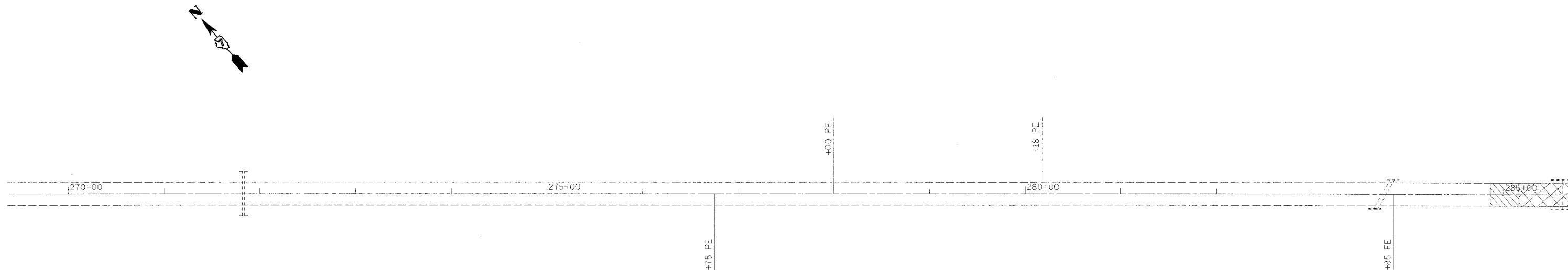

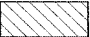
 HOT MIX ASPHALT SURFACE REMOVAL 1 1/2"
 PAVEMENT TRANSITION

REVISIONS	
NAME	DATE

ILLINOIS DEPARTMENT OF TRANSPORTATION

**STA 270 + 00
TO
STA 300 + 00**

SCALE: VERT.
HORIZ.
DATE

DRAWN BY
CHECKED BY

PLOT DATE = 1/17/2008
FILE NAME = c:\projects\74081\d\00605pa.dgn
PLOT SCALE = 5/8" = 1' / IN.
USER NAME = teasleyck

F.A.P. RTE.	SECTION	COUNTY	TOTAL SHEETS	SHEET NO.
776	(10)RS-1	WAYNE	21	17
STA.		TO STA.		
FED. ROAD DIST. NO.		ILLINOIS FED. AID PROJECT		

teaslejack
1/17/2008
c:\projects\74081\d\0605pa.dgn
PS 11

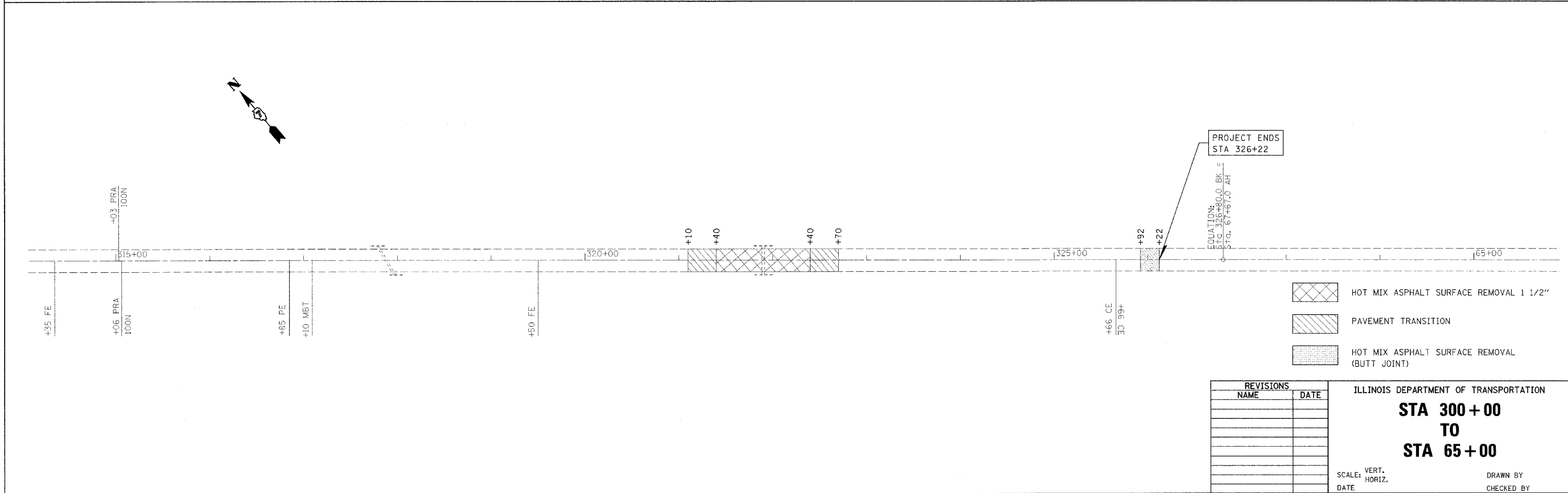
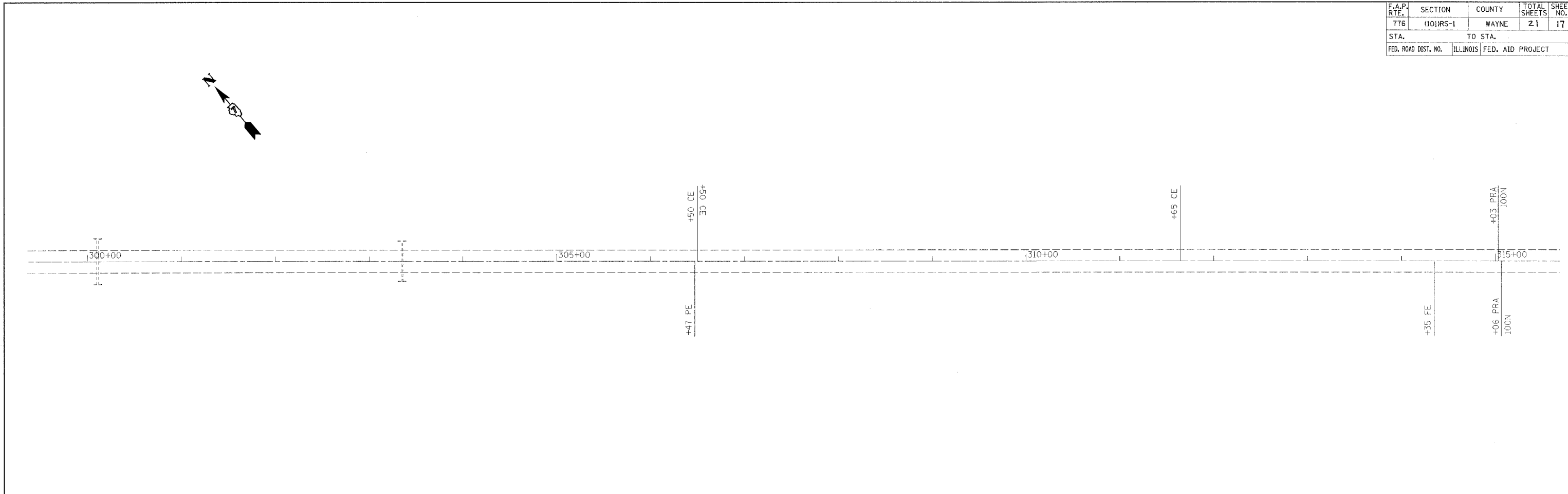

REVISIONS	
NAME	DATE

ILLINOIS DEPARTMENT OF TRANSPORTATION
**STA 300 + 00
TO
STA 65 + 00**
SCALE: VERT. _____
HORIZ. _____
DATE _____ DRAWN BY _____
CHECKED BY _____

PLOT DATE = 1/17/2008
PLOT SCALE = 50/800
USER NAME = teaslejack

F.A.P. RTE.	SECTION	COUNTY	TOTAL SHEETS	SHEET NO.
776	101RS-1	WAYNE	21	18
STA.		TO STA.		
FED. ROAD DIST. NO.	ILLINOIS	FED. AID PROJECT		

teasleyck
 1/17/2008
 c:\projects\74081\d00605pa.dgn
 PS 12

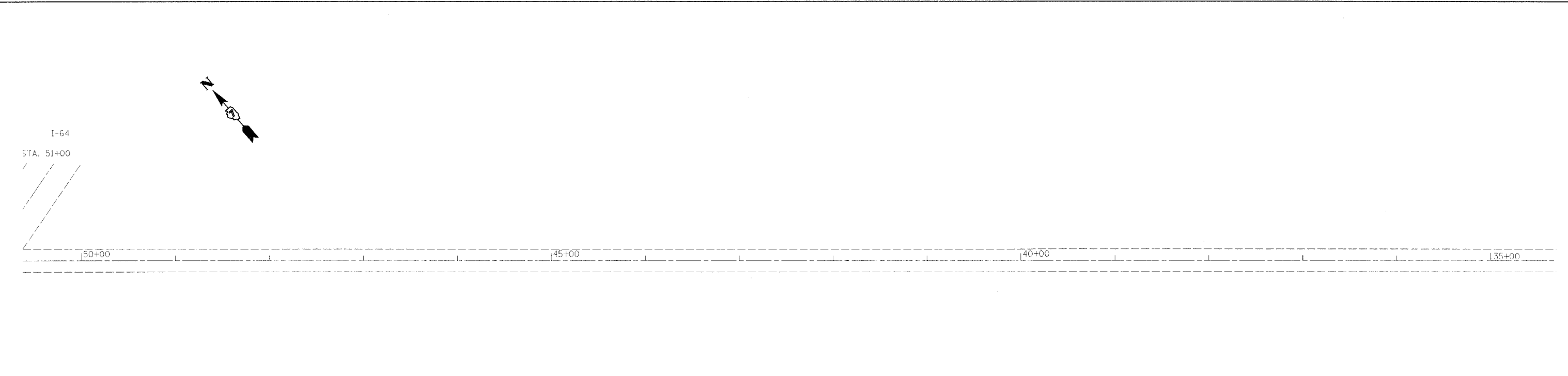

PLOT DATE = 1/17/2008
 FILE NAME = c:\projects\74081\d00605pa.dgn
 PLOT SCALE = 500000 / 1" = 1000' / 1" = 1000'
 USER NAME = teasleyck

REVISIONS	
NAME	DATE

ILLINOIS DEPARTMENT OF TRANSPORTATION

**STA 65 + 00
TO
STA 35 + 00**

SCALE: VERT. _____
 HORIZ. _____

DATE _____ DRAWN BY _____
 CHECKED BY _____

F.A.P. RTE.	SECTION	COUNTY	TOTAL SHEETS	SHEET NO.
776	(10)RS-1	WAYNE	21	19
STA.		TO STA.		
FED. ROAD DIST. NO.	ILLINOIS	FED. AID PROJECT		

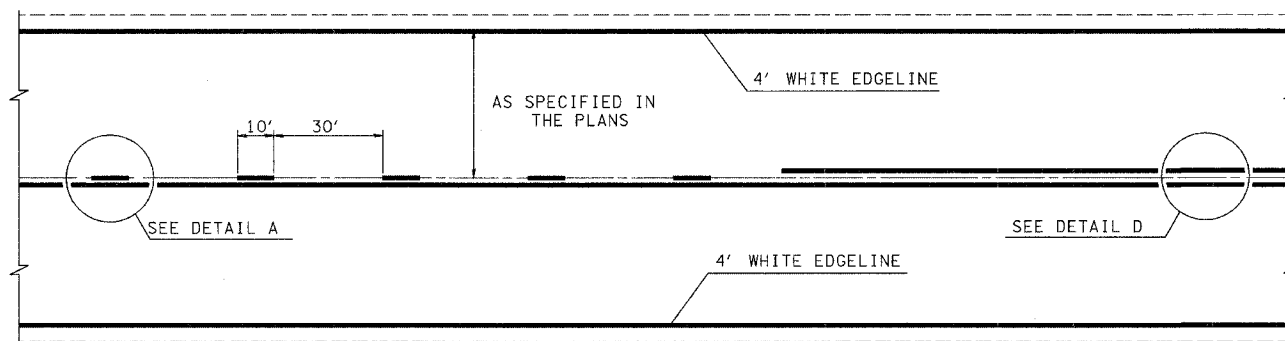

TYPICAL CENTERLINE, NO PASSING ZONE LINE (NPZ) & EDGELINE MARKINGS
2-LANE PAVEMENT

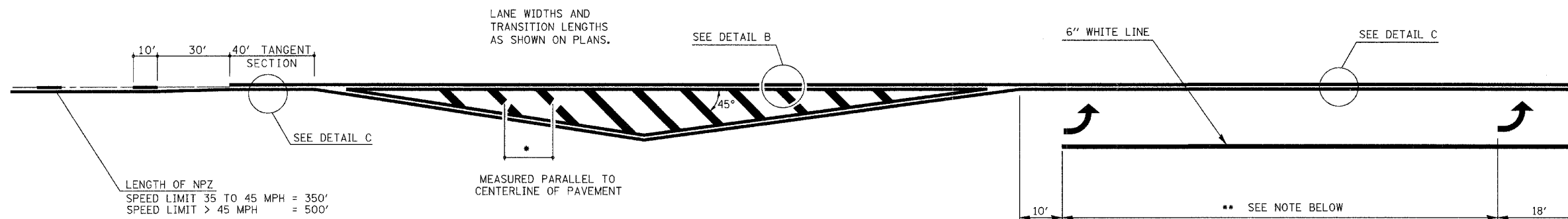

LENGTH OF NPZ
SPEED LIMIT 35 TO 45 MPH = 350'
SPEED LIMIT > 45 MPH = 500'

***DIAGONAL SPACING**

SPEED LIMIT	< 30 MPH	= 15'
SPEED LIMIT	30 TO 45 MPH	= 20'
SPEED LIMIT	> 45 MPH	= 30'

** PLACE THE FIRST ARROW EVEN WITH THE BEGINNING OF THE TURN BAY.
PLACE ANOTHER ARROW 18' BACK FROM THE STOP BAR, IF REQUIRED,
ADD ADDITIONAL ARROWS TO MAINTAIN A MAXIMUM OF 80' SPACING.

NOTES:

1. OMIT EDGELINE THRU SIDE ROADS.
2. TAPER RATES, LANE WIDTHS, AND STORAGE LENGTHS AS SHOWN ON THE PLANS.
3. WHEN MEDIANS ARE PRESENT, PLACE A SINGLE YELLOW STRIPE AROUND ITS PERIMETER.

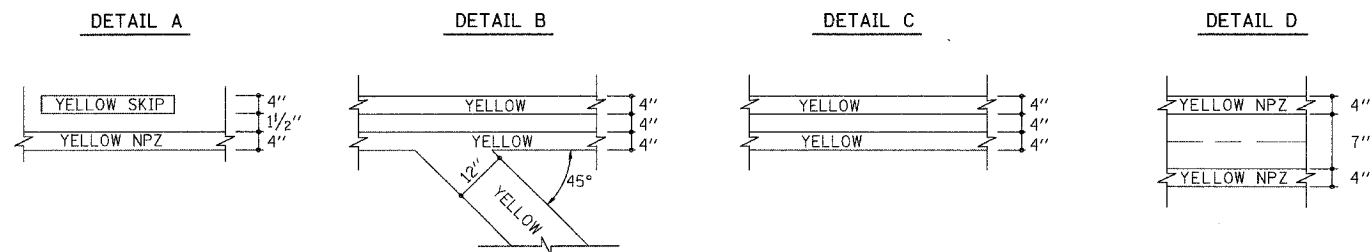

NOT TO SCALE

REVISIONS	
NAME	DATE
MMO	12-99
DRM	08-04

ILLINOIS DEPARTMENT OF TRANSPORTATION
TYPICAL APPLICATION OF PAVEMENT MARKINGS
SHEET 1 OF 2

SCALE: VERT. HORIZ.
DATE

DRAWN BY
CHECKED BY

F.A.P. RTE.	SECTION	COUNTY	TOTAL SHEETS	SHEET NO.
776	(10)RS-1	WAYNE	21	20
STA.		TO STA.		
FED. ROAD DIST. NO.	ILLINOIS	FED. AID PROJECT		

** PLACE THE FIRST ARROW EVEN WITH THE BEGINNING OF THE TURN BAY.
 PLACE ANOTHER ARROW 18' BACK FROM THE STOP BAR. IF REQUIRED,
 ADD ADDITIONAL ARROWS TO MAINTAIN A MAXIMUM OF 80' SPACING.

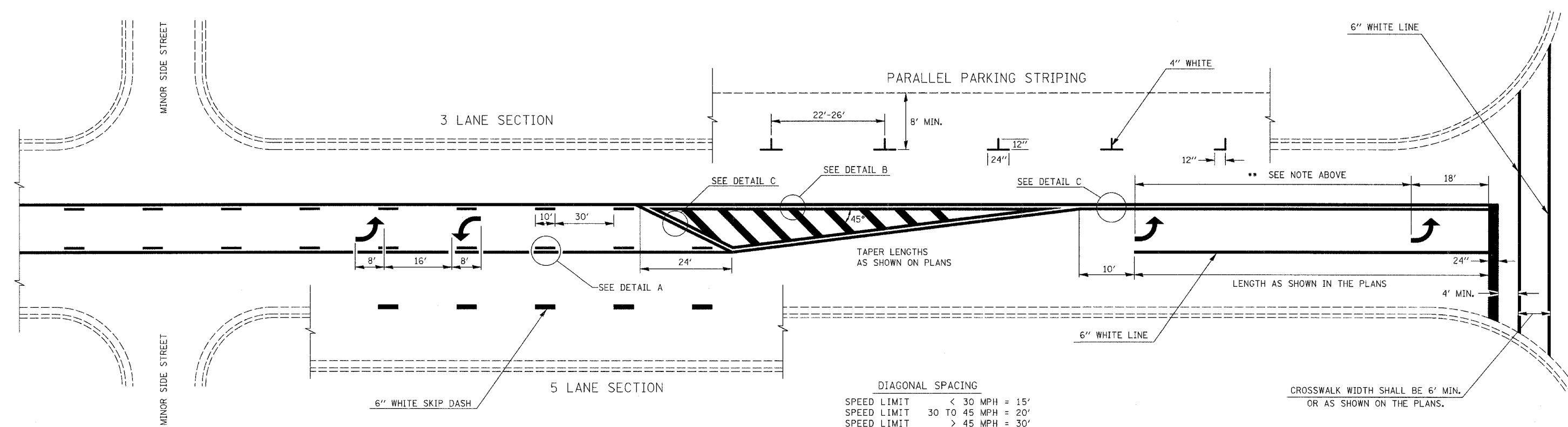

DIAGONAL SPACING

SPEED LIMIT	< 30 MPH	= 15'
SPEED LIMIT	30 TO 45 MPH	= 20'
SPEED LIMIT	> 45 MPH	= 30'

CROSSWALK WIDTH SHALL BE 6' MIN.
 OR AS SHOWN ON THE PLANS.

TYPICAL BI-DIRECTIONAL TURN LANE MARKINGS
 (SHOWING TRANSITION TO EXCLUSIVE LEFT TURN LANE)

- NOTES:
- NO LESS THAN 2 ARROWS SHALL BE USED.
 - TAPER RATES, LANE WIDTHS, AND STORAGE LENGTHS AS SHOWN ON THE PLANS.
 - AVOID PLACING BI-DIRECTIONAL ARROWS IN INTERSECTIONS.
 - BI-DIRECTIONAL ARROWS SHALL BE SPACED A MAXIMUM OF 250'.

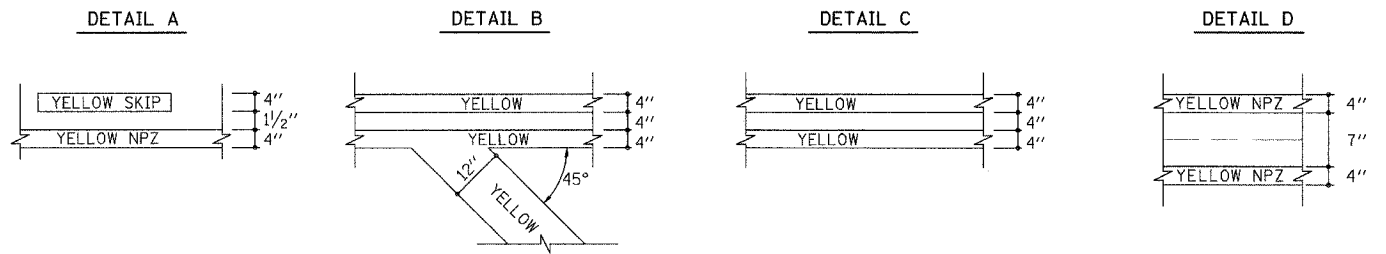

NOT TO SCALE

REVISIONS	
NAME	DATE
MMO	12-99
DRM	08-04

ILLINOIS DEPARTMENT OF TRANSPORTATION
TYPICAL APPLICATION OF PAVEMENT MARKINGS
SHEET 2 OF 2

SCALE: VERT. _____
 HORIZ. _____
 DATE _____
 DRAWN BY _____
 CHECKED BY _____

teasleujck
 1/17/2008
 c:\projects\74081\400605pa.dgn

PLOT DATE = 1/17/2008
 PLOT SCALE = 50/2000 = 1/40
 USER NAME = teasleujck

F.A.P. RTE.	SECTION	COUNTY	TOTAL SHEETS	SHEET NO.
776	(10)RS-1	WAYNE	21	21
STA.		TO STA.		
FED. ROAD DIST. NO.		ILLINOIS FED. AID PROJECT		

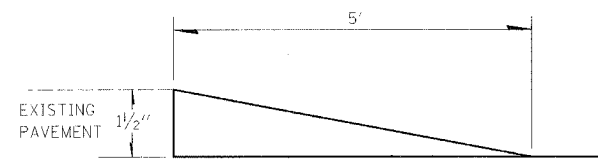

TEMPORARY RAMP DETAIL

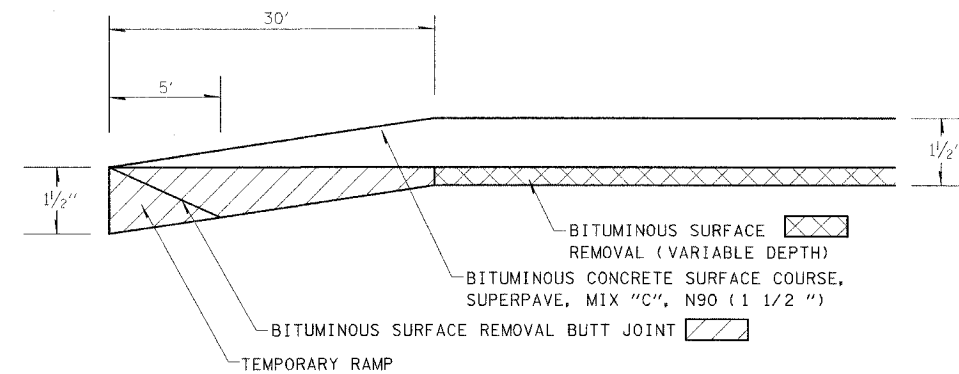

BUTT JOINT DETAIL

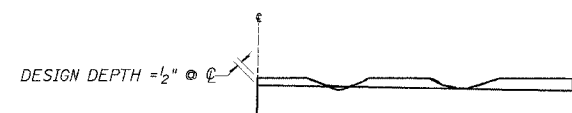

NOTES:

- MILLING SHALL BE DONE TO ATTAIN A 3/16" SLOPE IN CROWN SECTIONS
- EXISTING S.E. AND S.E. TRANSITIONS SHALL BE MAINTAINED UNLESS OTHERWISE SHOWN ON THE PLANS.
- MILLING TO THE BOTTOM OF WHEEL RUTS SHALL NOT BE NECESSARY UNLESS REQUIRED TO OBTAIN SLOPE OR THE DESIGN DEPTH AT CENTERLINE.
- THE AVERAGE DEPTH OF MILLING IS ESTIMATED TO BE 1/2" BUT MAY VARY IN ISOLATED LOCATIONS.

BITUMINOUS SURFACE REMOVAL (VARIABLE DEPTH) DETAIL

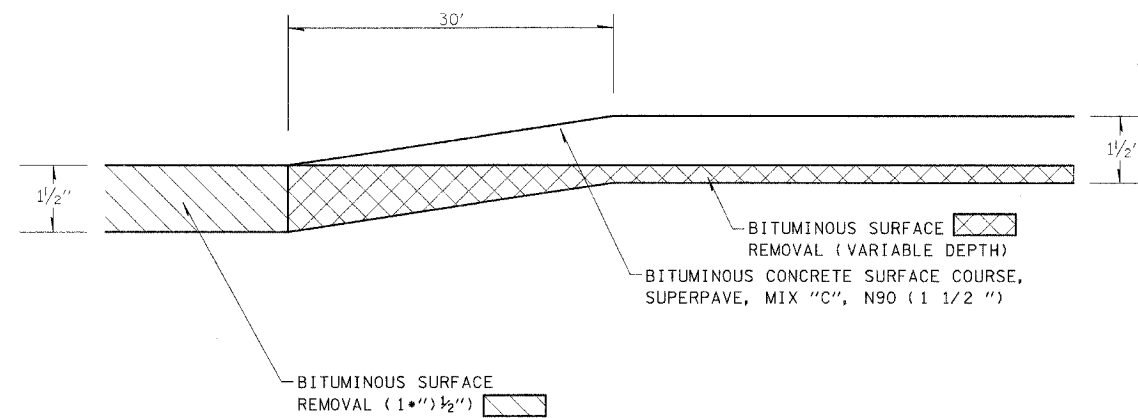

BITUMINOUS SURFACE REMOVAL TRANSITION DETAIL

REVISIONS	
NAME	DATE

ILLINOIS DEPARTMENT OF TRANSPORTATION
RESURFACING & PAVEMENT MARKING SCHEDULE
BUTT JOINT, MILLING & BITUMINOUS TRANSITION DETAIL
 VERT. SCALE: DRAWN BY
 HORIZ. SCALE: CHECKED BY
 DATE

teasleyck
 1/17/2008
 c:\projects\74081\00605pa.dgn
 PLOT DATE = 1/17/2008
 PLOT SCALE = 50.0000 / 1" = 100.0000 / 1" IN.
 USER NAME = teasleyck