

**PIER #1 - WEST FACE**  
SN 058-0094 (WB)

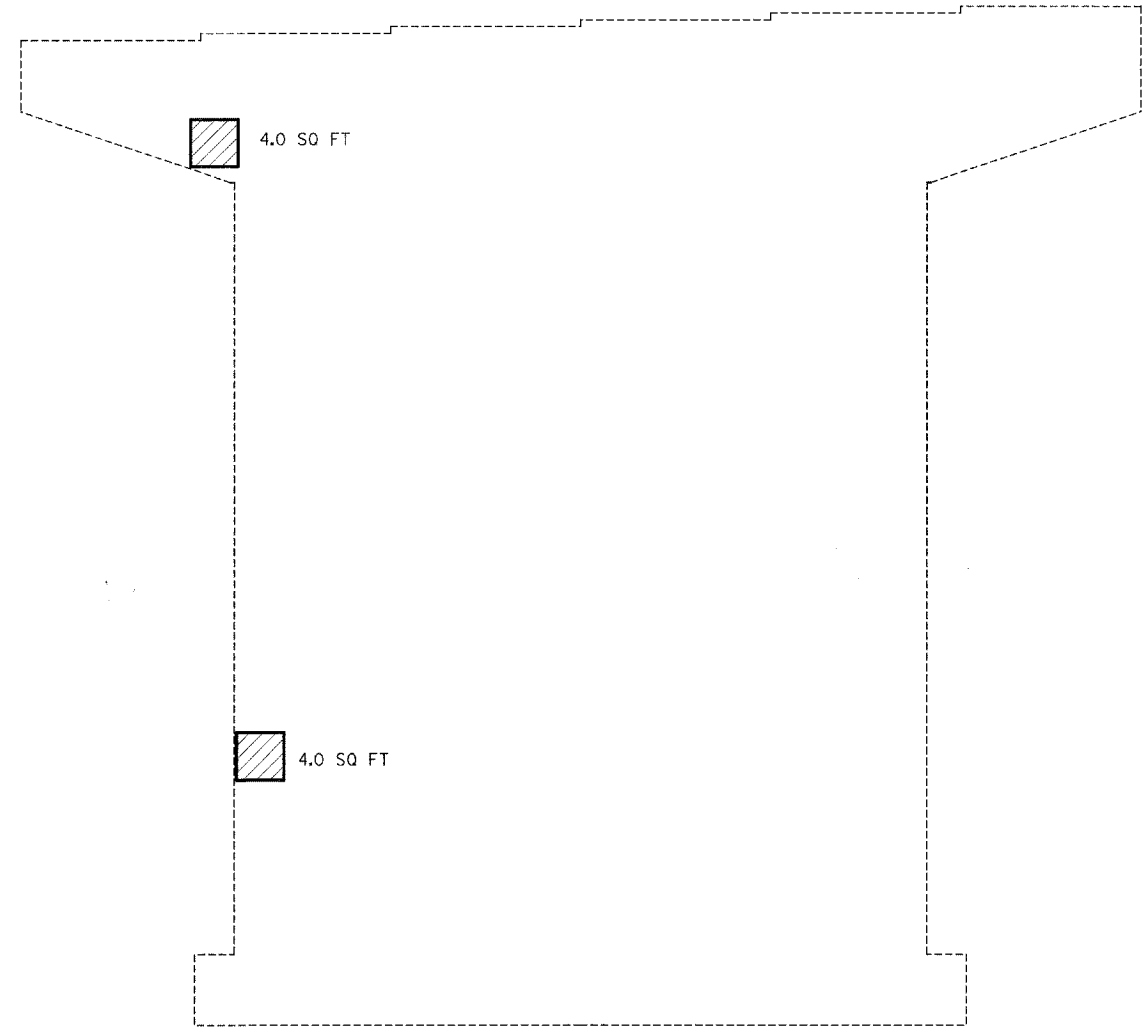

**PIER #1 - WEST FACE**  
SN 058-0093 (EB)

NOTE: QUANTITIES ARE ESTIMATED. ACTUAL QUANTITIES TO BE DETERMINED BY THE RESIDENT ENGINEER.



Structural Repair of Concrete (Depth < 5")

FILE NAME = c:\projects\74171d\karenbr\sdge.dgn	USER NAME = swartzrw	DESIGNED -	REVISED -
		DRAWN -	REVISED -
	PLOT SCALE = 20.0000' / IN.	CHECKED -	REVISED -
	PLOT DATE = 3/20/2008	DATE -	REVISED -

**STATE OF ILLINOIS  
DEPARTMENT OF TRANSPORTATION**

**STRUCTURAL REPAIR - SUBSTRUCTURE  
SN 058-0093 (EB) & SN 058-0094 (WB)**

SCALE: N/A SHEET NO. 12 OF 52 SHEETS STA. TO STA.

F.A.I. RTE. 72	SECTION (58,74X66,67)RS-1	COUNTY MACON	TOTAL SHEETS 88	SHEETS NO. 31
FED. ROAD DIST. NO. ILLINOIS FED. AID PROJECT			CONTRACT NO. 741	

SHEET NO.  
52 SHEET