

**ELEVATION**

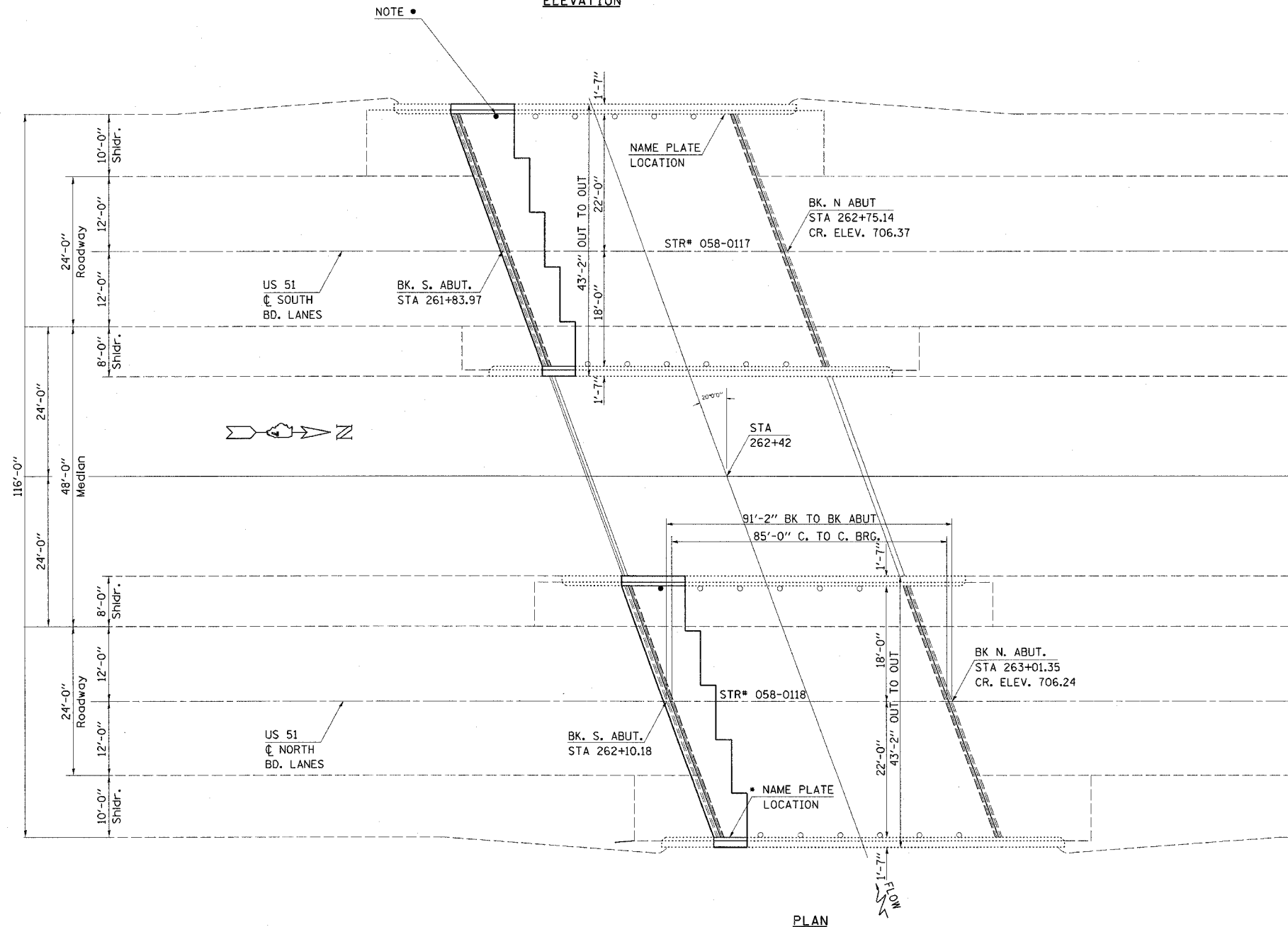

**PLAN**

**GENERAL NOTES**

Reinforcement bars shall conform to the requirements of ASTM A 706 Gr 60 (IL Modified). See Special Provisions.

Reinforcement bars designated (E) shall be epoxy coated.

Plan dimensions and details relative to existing plans are subject to routine variations. The Contractor shall field verify existing dimensions and details affecting new construction and make necessary approved adjustments prior to construction or ordering of materials. Such variations shall not be cause for additional compensations for a change in scope of the work; however, the Contractor will be paid for the quantity actually furnished based upon the unit price bid for the work.

Existing reinforcement bars shall be cleaned, straightened and incorporated into the new construction. Any reinforcement bars that are damaged during concrete removal operations shall be repaired or replaced using an approved bar splicer or anchorage system (cost included in concrete removal).

Joint openings shall be adjusted according to Article 520.04(c) of the Standard Specifications when the deck is poured at an ambient temperature other than 50 F.

Prior to pouring concrete on the new concrete deck, all loose potentially detrimental foreign material shall be removed from the surfaces in contact with concrete. Removal shall be accomplished by methods that will not damage the existing PPC I-Beams and the cost will be included in the pay item covering removal of the existing concrete.

Strip Seal Joint Assembly will run straight through soffit. See detail on Page 12.

**BILL OF MATERIALS**

ITEM DESCRIPTION	UNIT	058-0117	058-0118
Concrete Removal	CU YD	17.7	14.9
Concrete Superstructure	CU YD	17.7	14.9
Preformed Joint Strip Seal	FOOT	45	45
Reinforcement Bars, Epoxy Coated	POUND	3030	2880
Bar Splicers	EACH	31	29

• Cost of Removal and Reinstallation of Name Plate is included with concrete superstructure.

• Cost of removal and reinstallation of Floor Drains is included with Concrete Superstructures.