

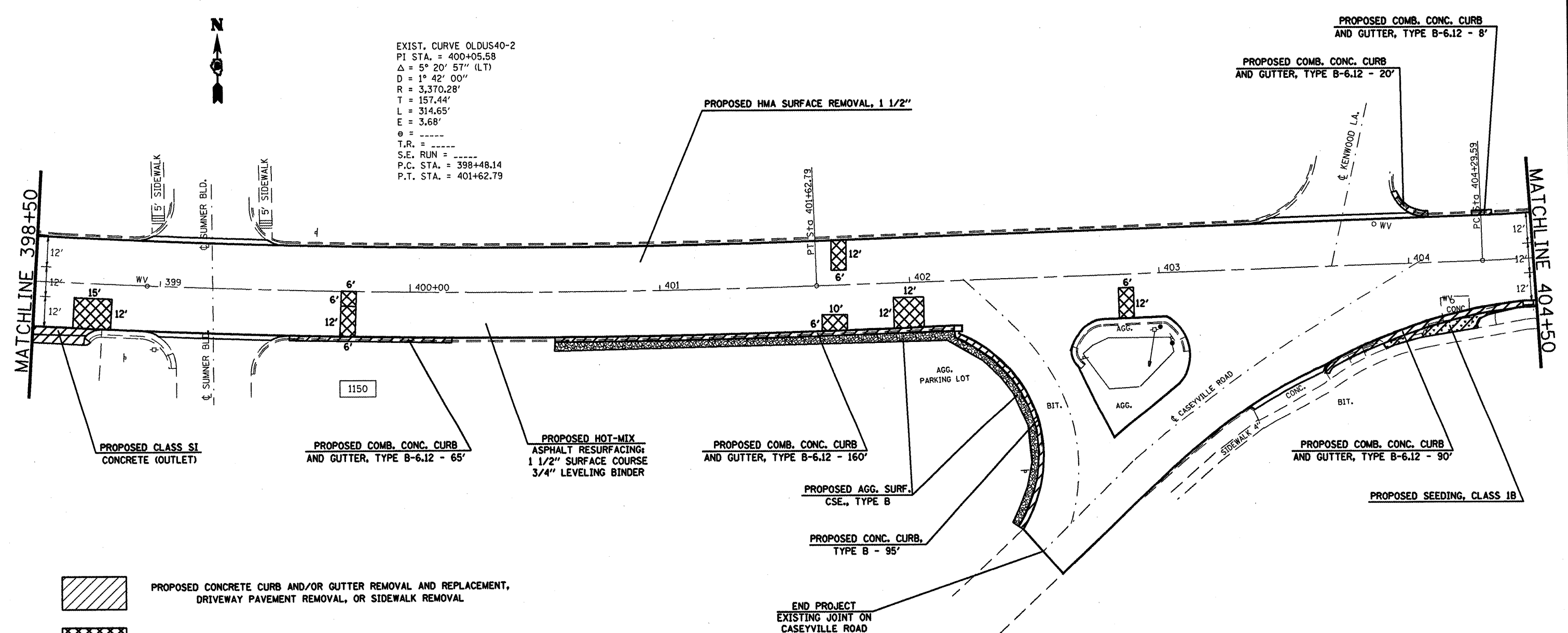



EXIST. CURVE OLDUS40-2
 PI STA. = 400+05.58
 $\Delta = 5^\circ 20' 57''$ (LT)
 $D = 1^\circ 42' 00''$
 $R = 3,370.28'$
 $T = 157.44'$
 $L = 314.65'$
 $E = 3.68'$
 $\theta = \text{-----}$
 T.R. = -----
 S.E. RUN = -----
 P.C. STA. = 398+48.14
 P.T. STA. = 401+62.79

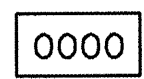

-  PROPOSED CONCRETE CURB AND/OR GUTTER REMOVAL AND REPLACEMENT, DRIVEWAY PAVEMENT REMOVAL, OR SIDEWALK REMOVAL
-  PROPOSED PAVEMENT PATCHING, 12"
-  PROPERTY STREET NUMBER - APPROXIMATE LOCATION

FILE NAME =	USER NAME = #USER#	DESIGNED -	REVISED -	STATE OF ILLINOIS DEPARTMENT OF TRANSPORTATION	PLAN VIEW	F.A.U. RTE.	SECTION	COUNTY	TOTAL SHEETS	SHEET NO.	
#FILE#		DRAWN -	REVISED -			9128	38-1RS-3	MADISON	33	11	
	PLOT SCALE = #SCALE#	CHECKED -	REVISED -			CONTRACT NO. 76A85					
	PLOT DATE = #DATE#	DATE -	REVISED -			ILLINOIS FED. AID PROJECT					
					SCALE:	SHEET NO. OF SHEETS		STA. 398+50 TO STA. 404+50			