

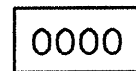

PROPOSED CONCRETE CURB AND/OR GUTTER REMOVAL AND REPLACEMENT,  
DRIVEWAY PAVEMENT REMOVAL, OR SIDEWALK REMOVAL



PROPOSED PAVEMENT PATCHING, 12"



PROPERTY STREET NUMBER - APPROXIMATE LOCATION

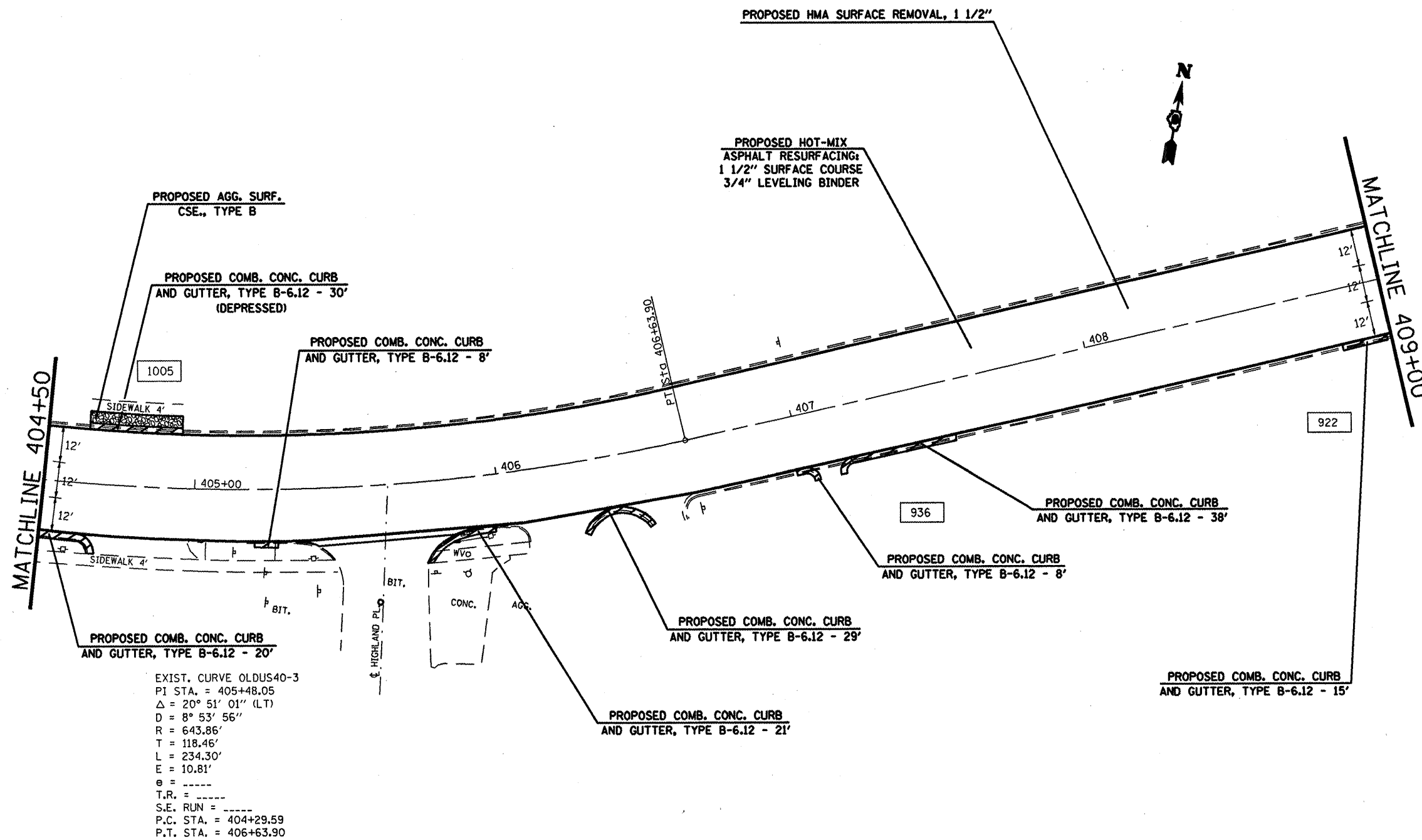

EXIST. CURVE OLDUS40-3  
 PI STA. = 405+48.05  
 $\Delta = 20^\circ 51' 01''$  (LT)  
 $D = 8^\circ 53' 56''$   
 $R = 643.86'$   
 $T = 118.46'$   
 $L = 234.30'$   
 $E = 10.81'$   
 $\theta = \text{-----}$   
 $T.R. = \text{-----}$   
 $S.E. RUN = \text{-----}$   
 $P.C. STA. = 404+29.59$   
 $P.T. STA. = 406+63.90$

FILE NAME =	USER NAME = #USER#	DESIGNED -	REVISED -
#FILEL#		DRAWN -	REVISED -
	PLOT SCALE = #SCALE#	CHECKED -	REVISED -
	PLOT DATE = #DATE#	DATE -	REVISED -

**STATE OF ILLINOIS  
DEPARTMENT OF TRANSPORTATION**

**PLAN VIEW**

SCALE: SHEET NO. OF SHEETS STA. 404+50 TO STA. 409+00

F.A.I. RTE.	SECTION	COUNTY	TOTAL SHEETS	SHEET NO.
9128	38-IRS-3	MADISON	33	12
CONTRACT NO. 76A85				
FED. ROAD DIST. NO. (ILLINOIS) FED. AID PROJECT				