

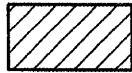

-  PROPOSED CONCRETE CURB AND/OR GUTTER REMOVAL AND REPLACEMENT, DRIVEWAY PAVEMENT REMOVAL, OR SIDEWALK REMOVAL
-  PROPOSED PAVEMENT PATCHING, 12"
-  PROPERTY STREET NUMBER - APPROXIMATE LOCATION



EXIST. CURVE OLDUS40-4
 PI STA. = 417+60.69
 $\Delta = 23^\circ 35' 59''$ (LT)
 $D = 12^\circ 36' 00''$
 $R = 454.72'$
 $T = 95.00'$
 $L = 187.30'$
 $E = 9.82'$
 $\theta = \text{-----}$
 $T.R. = \text{-----}$
 $S.E. \text{ RUN} = \text{-----}$
 $P.C. \text{ STA.} = 416+65.70$
 $P.T. \text{ STA.} = 418+53.00$

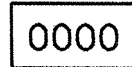
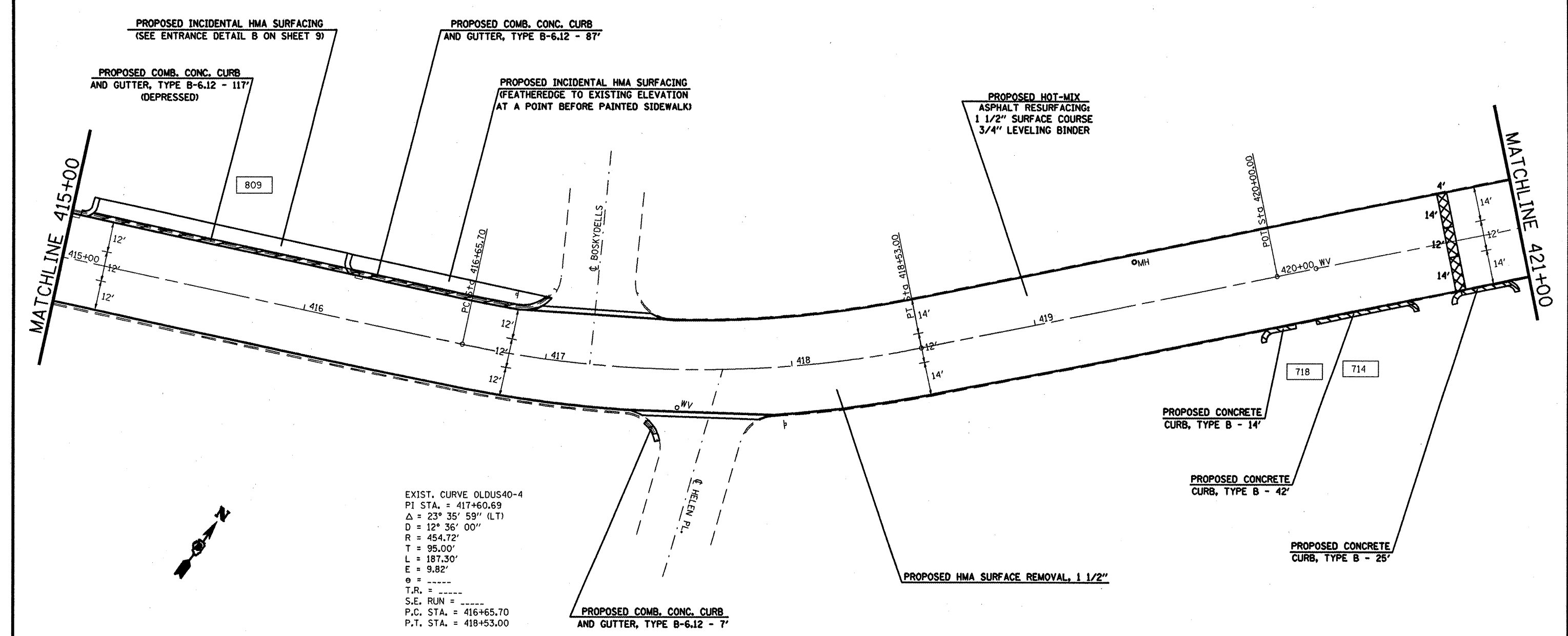

FILE NAME =	USER NAME = #USER#	DESIGNED -	REVISED -	STATE OF ILLINOIS DEPARTMENT OF TRANSPORTATION	PLAN VIEW	F.A.J. RTE.	SECTION	COUNTY	TOTAL SHEETS	SHEET NO.	
#FILE#		DRAWN -	REVISED -			9128	38-IRS-3	MADISON	33	14	
		CHECKED -	REVISED -			CONTRACT NO. 76A85					
		DATE -	REVISED -			FED. ROAD DIST. NO. ILLINOIS FED. AID PROJECT					
				SCALE: SHEET NO. OF SHEETS STA. 415+00 TO STA. 421+00							