

F.A.P. RTE.	SECTION	COUNTY	TOTAL SHEETS	SHEET NO.
329	(125,126)RS-2	RANDOLPH	34	3
FED. ROAD DIST. NO.	ILLINOIS	CONTRACT NO. 76B38		

STATE OF ILLINOIS  
DEPARTMENT OF TRANSPORTATION  
DIVISION OF HIGHWAYS

**PROPOSED  
HIGHWAY PLANS**

FAP ROUTE 329 (IL 154)  
SECTION (125,126)RS-2

RANDOLPH COUNTY  
C-98-008-08  
RESURFACING

FOR INDEX OF SHEETS, SEE SHEET NO. 2

D-89-015-08

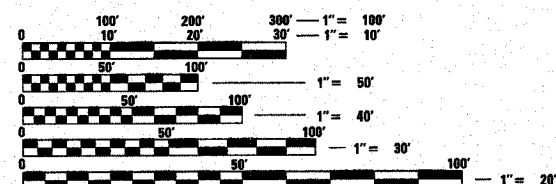
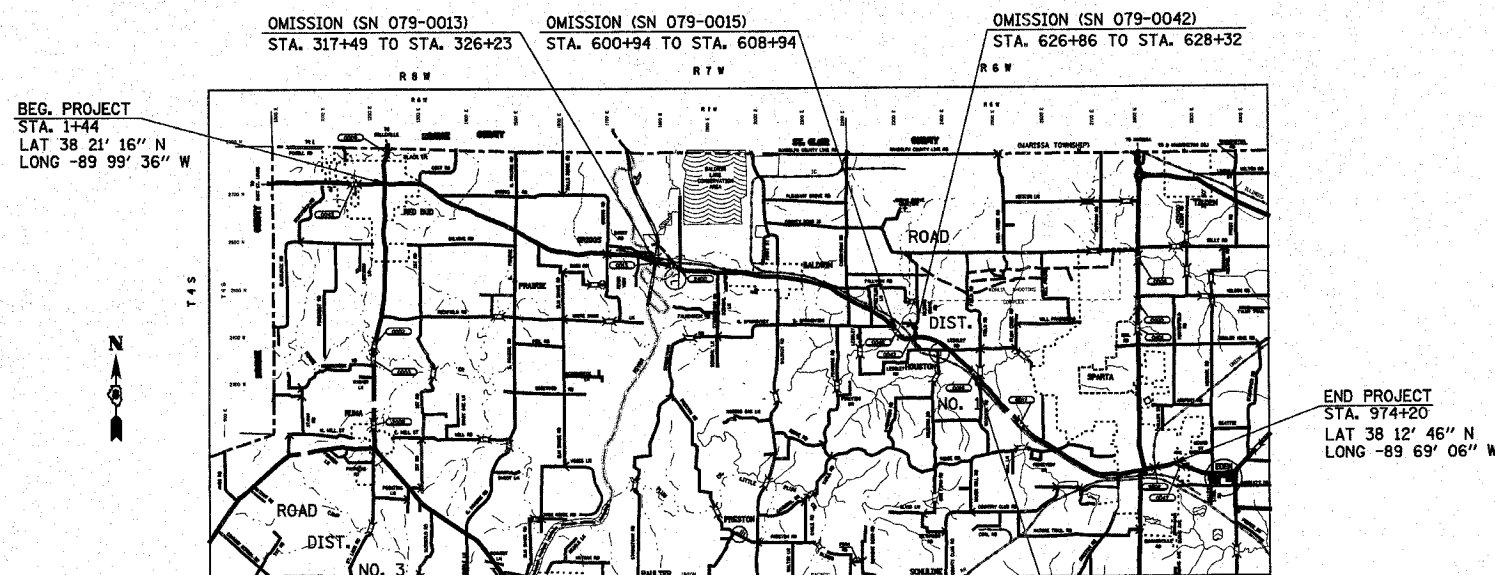
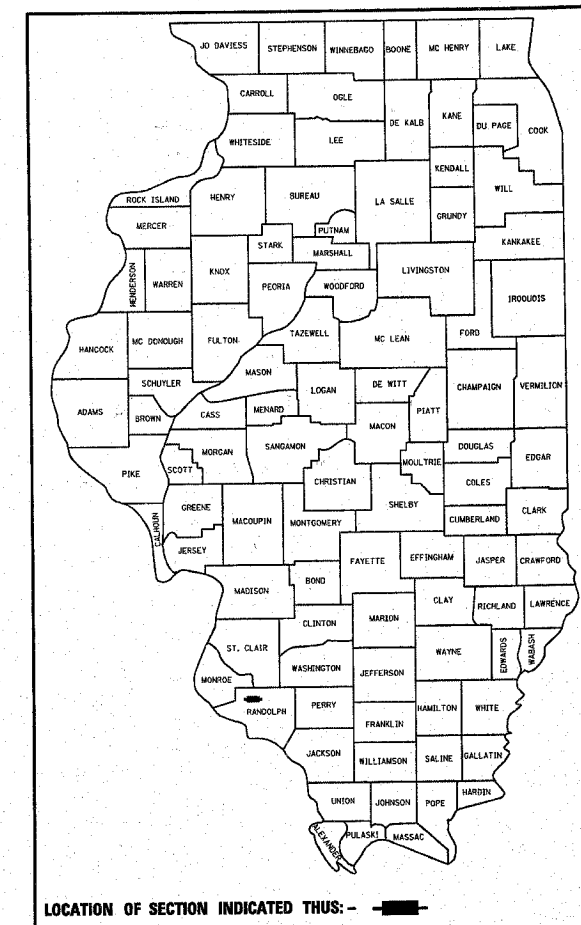

FULL SIZE PLANS HAVE BEEN PREPARED USING STANDARD ENGINEERING SCALES. REDUCED SIZED PLANS WILL NOT CONFORM TO STANDARD SCALES. IN MAKING MEASUREMENTS ON REDUCED PLANS, THE ABOVE SCALES MAY BE USED.

J.U.L.I.E.  
JOINT UTILITY LOCATION INFORMATION FOR EXCAVATION  
1-800-892-0123  
OR 811

PROJECT ENGINEER: PATTI LEBEAU: (618) 346-3179  
PROJECT MANAGER: CHERYL KEPLAR (618) 346-3186

CONTRACT NO. 76B38

2007 ADT = 7100 (ACTUAL)  
2008 ADT = 7200 (ESTIMATED)  
2028 ADT = 9100 (ESTIMATED)  
SU = 5.3% MU = 3.2%

PROJECT LENGTH  
GROSS LENGTH = 18.42 MI = 97,276 FT  
NET LENGTH = 18.03 MI = 95,191 FT

STATE OF ILLINOIS  
DEPARTMENT OF TRANSPORTATION  
DIVISION OF HIGHWAYS

SUBMITTED March 27, 2008

Mary C. Jamel  
DEPUTY DIRECTOR OF HIGHWAYS, REGION 5 ENGINEER

May 9, 2008  
Eric E. Haran  
ENGINEER OF DESIGN AND ENVIRONMENT

May 9, 2008  
Christina M. Reed  
DIRECTOR OF HIGHWAYS, CHIEF ENGINEER

**PRINTED BY THE AUTHORITY  
OF THE STATE OF ILLINOIS**

## INDEX OF SHEETS

- 1. COVER SHEET
- 2. INDEX OF SHEETS, STANDARDS, GENERAL NOTES AND COMMITMENTS
- 3.-4. SUMMARY OF QUANTITIES
- 5. LOCATION MAPS
- 6.-12. TYPICALS
- 13.-18. SCHEDULES
- 19.-24. PLAN SHEETS
- 25.-34. DETAILS

## GENERAL NOTES

1. THE STANDARDS AND REVISIONS LISTED APPLY TO THIS PROJECT.
2. ILLINOIS STATE LAW REQUIRES A 48-HOUR NOTICE TO BE GIVEN TO UTILITIES BEFORE DIGGING. FIELD MARKING OF FACILITIES MAYBE OBTAINED BY CONTACTING J.U.L.I.E. OR FOR NON-MEMBERS, THE UTILITY COMPANY DIRECTLY. AGENCIES KNOWN TO HAVE FACILITIES WITHIN THE PROJECT AREA ARE AS FOLLOWS:
  - AMEREN IP
  - VILLAGE OF BALDWIN
  - EGYPTIAN ELECTRIC COOPERATIVE ASSOCIATION
  - EGYPTIAN TELEPHONE COOP. ASSN.
  - EGYPTIAN WATER COMPANY
  - EXXONMOBIL PIPELINE COMPANY
  - HARRISONVILLE TELEPHONE CO.
  - MEDIACOM
  - MONROE COUNTY ELECTRIC CO-OPERATIVE, INC.
  - NEW WAVE COMMUNICATONS
  - CITY OF RED BUD
  - CITY OF SPARTA
  - VERIZON NORTH, INC.
  - WASHINGTON COUNTY

(MEMBERS OF J.U.L.I.E. (800) 892-0123 ARE INDICATED BY \*. NON J.U.L.I.E. MEMBERS MUST BE NOTIFIED INDIVIDUALLY.)
3. THE THICKNESS OF HMA MIXTURES SHOWN IN THE PLANS IS THE NOMINAL THICKNESS. DEVIATIONS FROM THE NOMINAL WILL BE PERMITTED WHEN SUCH DEVIATIONS OCCUR DUE TO IRREGULARITIES IN THE EXISTING BASE OR SURFACE ON WHICH THE HMA MIXTURE IS PLACED.
4. THE FOLLOWING MIXTURE REQUIREMENTS ARE APPLICABLE TO THIS PROJECT:

MIXTURE USE	SURFACE	LEVEL BINDER	BINDER/PATCHING	INCIDENTAL SURF	SHOULDERS
AC/PG	PG 64-22	PG 64-22	PG 64-22	PG 64-22	PG 58-22
RAP % (MAX)	10%	10%	10%	10%	30%
DESIGN AIR VOIDS	4.0% @ Ndes=90	4.0% @ Ndes=90	4.0% @ Ndes=90	4.0% @ Ndes=90	2.0% @ Ndes=30
MIX COMPOSITION (GRADATION MIXTURE)					
FRICITION AGG	MIXTURE "D"	MIXTURE "C"	MIXTURE "B"	MIXTURE "D"	BAM

MIXTURE USE	TOP LIFT SHOULDER
AC/PG	PG 58-22
RAP % (MAX)	30%
DESIGN AIR VOIDS	1.5% @ Ndes=30
MIX COMPOSITION (GRADATION MIXTURE)	
FRICITION AGG	BAM

•• Top Lift Shoulders - Design this mix at 2.0% voids and add asphalt to reduce voids to 1.5%.

Plan quantities for Bituminous Concrete Surface Course Items are calculated using a unit weight of 112 lb/sq yd/ln (59.8 kg/sq m/25 mm thickness).

5. THE CONTRACTOR AND THE ENGINEER SHALL BE AWARE THAT NO SURVEY WAS PERFORMED FOR THIS PROJECT. THE STATIONING AND TOPO SHOWN IN THE PLANS WERE CREATED USING MICROFILM AND FIELD MEASUREMENTS MADE BY DESIGN PERSONNEL. BOTH SHALL BE ASSUMED TO BE APPROXIMATE.

6. FLAGMEN SHALL BE PRESENT DURING ALL CLOSURE HOURS WHEN WORKERS ARE PRESENT, INCLUDING LUNCH HOUR AND NO ADDITIONAL COMPENSATION WILL BE ALLOWED.
7. ALL CONSTRUCTION SIGNS SHALL BE FLUORESCENT ORANGE IN COLOR, NO ADDITIONAL COMPENSATION SHALL BE ALLOWED. ALL SIGNS SHALL BE SKID MOUNTED.
8. THE CONTRACTOR SHALL VERIFY ALL DIMENSIONS AND CONDITIONS IN THE FIELD PRIOR TO CONSTRUCTION AND ORDERING OF MATERIAL.
9. SHORT-TERM PAVEMENT MARKING SHALL BE APPLIED TO THE MILLED, LEVELING BINDER, AND FINAL BITUMINOUS SURFACE. A QUANTITY FOR TEMPORARY PAVEMENT MARKING EQUAL TO THE AMOUNT OF PERMANENT PAVEMENT MARKING HAS BEEN ADDED TO THE PLANS. ONLY REMOVAL OF SHORT-TERM PAVEMENT MARKING REMOVAL FROM FINAL SURFACE TO BE PAID AS 'WORK ZONE PAVEMENT MARKING REMOVAL'.
10. THE CONTACTOR SHALL BE AWARE THAT THERE MAY BE VALVES LOCATED WITHIN THE RESURFACING LIMITS. CARE SHALL BE TAKEN IN THESE LOCATIONS DURING MILLING OPERATIONS. ANY DAMAGE SHALL BE REPAIRED AT THE CONTRACTOR'S EXPENSE.
11. PRIOR THE SURFACE REMOVAL OPERATIONS THE RESIDENT ENGINEER SHALL RECORD THE LOCATION OF THE EXISTING PAVEMENT MARKING. THE PROPOSED PAVEMENT MARKING SHALL BE INSTALLED IN THE SAME LOCATIONS AS THE EXISTING PAVEMENT MARKING.
12. THE REMOVED GUARDRAIL SHALL BE DELIVERED TO THE STEELEVILLE IDOT YARD. CONTACT MARK GARD AT 618-965-9611.
13. THE CONTRACTOR SHALL NOT BEGIN ANY WORK WITHIN THE SPARTA CITY LIMITS UNTIL AFTER SEPTEMBER 15, 2008. CONTACT JASON SCHLIMME AT 618-317-6752 FOR COORDINATION.

## COMMITMENTS

## HIGHWAY STANDARDS

- 000001-05
- 001001-01
- 406201-01
- 442001-04
- 630101-07
- 630301-04
- 635006-02
- 635011-01
- 701006-02
- 701201-02
- 701301-02
- 701306-01
- 701311-02
- 701326-02
- 701336-04
- 701501-04
- 701901

# SUMMARY OF QUANTITIES

SUMMARY OF QUANTITIES			TOTAL QUANTITIES	CONSTRUCTION TYPE CODE			
				I000	Y025		
CODE NO	ITEM	UNIT		100% STATE	50% STATE 50% RED BUD	50% STATE 50% BALDWIN	50% STATE 50% SPARTA
20201400	SUB-BASE GRANULAR MATERIAL, TYPE A	TON	298	298			
28101200	DUMPED RIPRAP	TON	18	18			
40200800	AGGREGATE SURFACE COURSE, TYPE B	TON	740	740			
40600200	BITUMINOUS MATERIALS (PRIME COAT)	TON	165.8	164.2	0.7	0.2	0.7
40600300	AGGREGATE (PRIME COAT)	TON	795	786	4	1	4
40600645	LEVELING BINDER (MACHINE METHOD), N90	TON	10861	10852			9
40600895	CONSTRUCTING TEST STRIP	EACH	1	1			
40600982	HOT-MIX ASPHALT SURFACE REMOVAL - BUTT JOINT	SQ YD	5302	5302			
40600985	PORTLAND CEMENT CONCRETE SURFACE REMOVAL - BUTT JOINT	SQ YD	1704	1704			
40600990	TEMPORARY RAMP	SQ YD	324	324			
40603345	HOT-MIX ASPHALT SURFACE COURSE, MIX "D", N90	TON	24190	23803	186	34	167
40701961	HOT-MIX ASPHALT PAVEMENT (FULL-DEPTH), 14"	SQ YD	425	425			
40800050	INCIDENTAL HOT-MIX ASPHALT SURFACING	TON	591	591			
44000100	PAVEMENT REMOVAL	SQ YD	425	425			
44000153	HOT-MIX ASPHALT SURFACE REMOVAL, 1"	SQ YD	40426	15955	22078	400	1993
44000155	HOT-MIX ASPHALT SURFACE REMOVAL, 1 1/2"	SQ YD	643	643			
44000161	HOT-MIX ASPHALT SURFACE REMOVAL, 3"	SQ YD	2206	2101			105
44004250	PAVED SHOULDER REMOVAL	SQ YD	1081	1081			
44200144	PAVEMENT PATCHING, TYPE II, 12 INCH	SQ YD	1102	1102			
44200148	PAVEMENT PATCHING, TYPE III, 12 INCH	SQ YD	266	266			
44200150	PAVEMENT PATCHING, TYPE IV, 12 INCH	SQ YD	997	997			
44300200	STRIP REFLECTIVE CRACK CONTROL TREATMENT	FOOT	175186	175186			
48102100	AGGREGATE WEDGE SHOULDER, TYPE B	TON	4252	4252			
48203039	HOT-MIX ASPHALT SHOULDERS, 10 1/2"	SQ YD	1441	1441			
*63000000	STEEL PLATE BEAM GUARD RAIL, TYPE A	FOOT	2223	2223			
*63000025	STEEL PLATE BEAM GUARD RAIL, ATTACHED TO STRUCTURES	FOOT	100	100			
*63100070	TRAFFIC BARRIER TERMINAL, TYPE 5	EACH	4	4			
*63100085	TRAFFIC BARRIER TERMINAL, TYPE 6	EACH	4	4			
*63100167	TRAFFIC BARRIER TERMINAL, TYPE 1 (SPECIAL) TANGENT	EACH	16	16			
63200310	GUARDRAIL REMOVAL	FOOT	1555	1555			
67000400	ENGINEER'S FIELD OFFICE, TYPE A	CAL MO	16	16			
67100100	MOBILIZATION	L SUM	1	1			

\*SPECIALTY ITEMS

FILE NAME =	USER NAME = dinstelmarjn	DESIGNED -	REVISED -	<b>STATE OF ILLINOIS DEPARTMENT OF TRANSPORTATION</b>	<b>SUMMARY OF QUANTITIES</b>	F.A.P. RTE.	SECTION	COUNTY	TOTAL SHEETS	SHEET NO.
cr:\proj\jeots\ad01508\plan\p1n01508a.dgn		DRAWN -	REVISED -			329	(125,126)RS-2	RANDOLPH	34	3
PLOT SCALE = 50.0000' / IN.		CHECKED -	REVISED -			CONTRACT NO. 76B38				
PLOT DATE = 3/21/2008		DATE -	REVISED -			FED. ROAD DIST. NO. ILLINOIS FED. AID PROJECT				

SCALE: \_\_\_\_\_ SHEET NO. \_\_\_ OF \_\_\_ SHEETS STA. \_\_\_\_\_ TO STA. \_\_\_\_\_

# SUMMARY OF QUANTITIES

SUMMARY OF QUANTITIES			TOTAL QUANTITIES	CONSTRUCTION TYPE CODE			
CODE NO	ITEM	UNIT		I000	Y025		
				100% STATE	50% STATE 50% RED BUD	50% STATE 50% BALDWIN	50% STATE 50% SPARTA
70100450	TRAFFIC CONTROL AND PROTECTION, STANDARD 701201	L SUM	1	1			
70100460	TRAFFIC CONTROL AND PROTECTION, STANDARD 701306	L SUM	1	1			
70100600	TRAFFIC CONTROL AND PROTECTION, STANDARD 701336	L SUM	1	1			
70102620	TRAFFIC CONTROL AND PROTECTION, STANDARD 701501	L SUM	1	1			
70300100	SHORT-TERM PAVEMENT MARKING	FOOT	19040	19040			
70300210	TEMPORARY PAVEMENT MARKING - LETTERS AND SYMBOLS	SQ FT	165	165			
70300220	TEMPORARY PAVEMENT MARKING - LINE 4"	FOOT	265031	265031			
70300260	TEMPORARY PAVEMENT MARKING - LINE 12"	FOOT	586	586			
70300280	TEMPORARY PAVEMENT MARKING - LINE 24"	FOOT	84	84			
70301000	WORK ZONE PAVEMENT MARKING REMOVAL	SQ FT	6347	6347			
* 78000100	THERMOPLASTIC PAVEMENT MARKING - LETTERS AND SYMBOLS	SQ FT	165	165			
* 78000200	THERMOPLASTIC PAVEMENT MARKING - LINE 4"	FOOT	265013	265013			
* 78000600	THERMOPLASTIC PAVEMENT MARKING - LINE 12"	FOOT	586	586			
* 78000650	THERMOPLASTIC PAVEMENT MARKING - LINE 24"	FOOT	160	160			
* 78100100	RAISED REFLECTIVE PAVEMENT MARKER	EACH	1198	1198			
* 78200410	GUARDRAIL MARKERS, TYPE A	EACH	58	58			
* 78201000	TERMINAL MARKER - DIRECT APPLIED	EACH	16	16			
78300200	RAISED REFLECTIVE PAVEMENT MARKER REMOVAL	EACH	1198	1198			
20048665	RAILROAD PROTECTIVE LIABILITY INSURANCE	L SUM	1	1			

\*SPECIALTY ITEMS

FILE NAME = c:\projects\ed81588\plan\p1n81588a.dgn	USER NAME = dntolmanjn	DESIGNED - ---	REVISED - ---	<b>STATE OF ILLINOIS DEPARTMENT OF TRANSPORTATION</b>	<b>SUMMARY OF QUANTITIES</b>	F.A.P. RTE. 329	SECTION (125,126)RS-2	COUNTY RANDOLPH	TOTAL SHEETS 34	SHEET NO. 4	
PLOT SCALE = 58.8000' / IN.						SCALE: _____ SHEET NO. ___ OF ___ SHEETS STA. _____ TO STA. _____					
PLOT DATE = 3/21/2008						FED. ROAD DIST. NO. _____ ILLINOIS FED. AID PROJECT					
DRAWN - --- CHECKED - --- DATE - ---						CONTRACT NO. 76B38					

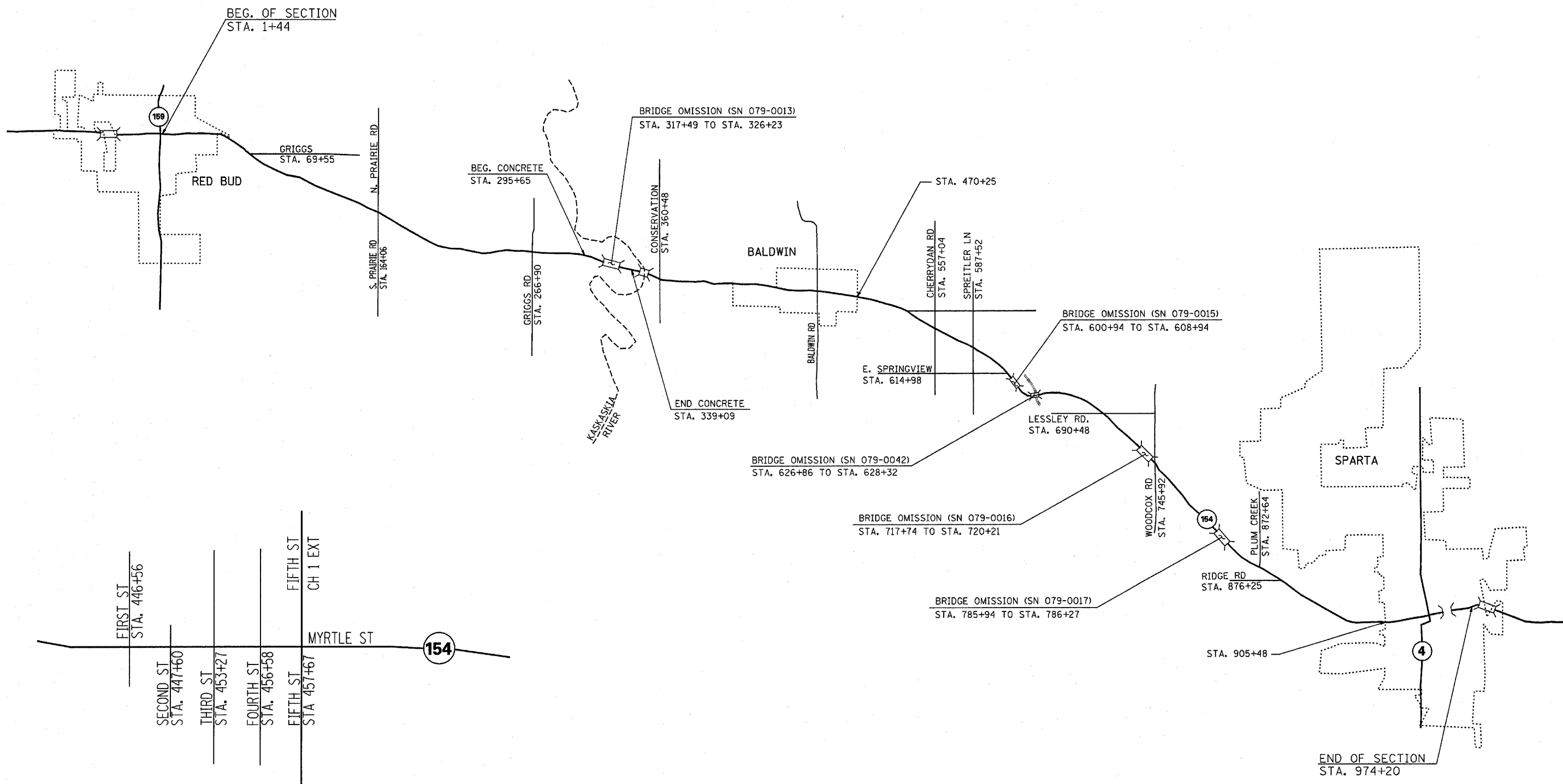

**VILLAGE OF BALDWIN**

FILE NAME = c:\projects\vd01508\plan\p1n01508a.dgn	USER NAME = dntelmenjn	DESIGNED - ---	REVISED - ---
		DRAWN - ---	REVISED - ---
		CHECKED - ---	REVISED - ---
		DATE - ---	REVISED - ---
PLOT SCALE = 50.0000' / IN.			
PLOT DATE = 3/21/2008			

**STATE OF ILLINOIS  
DEPARTMENT OF TRANSPORTATION**

**LOCATION MAP**  
SCALE: \_\_\_\_\_ SHEET NO. \_\_\_ OF \_\_\_ SHEETS STA. \_\_\_\_\_ TO STA. \_\_\_\_\_

F.A.P. RTE. 329	SECTION (125,126)RS-2	COUNTY RANDOLPH	TOTAL SHEETS 34	SHEET NO. 5
FED. ROAD DIST. NO. _____ ILLINOIS FED. AID PROJECT				
CONTRACT NO. 76B38				

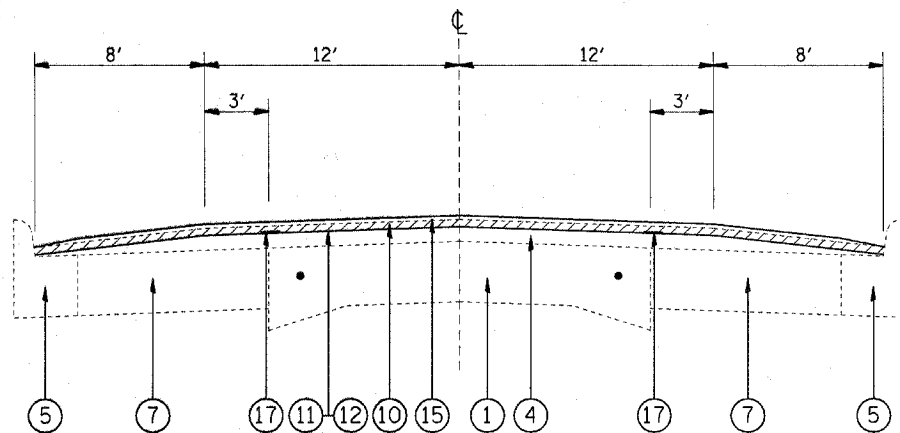

PROPOSED IL 154  
STA. 1+44 TO STA. 26+27

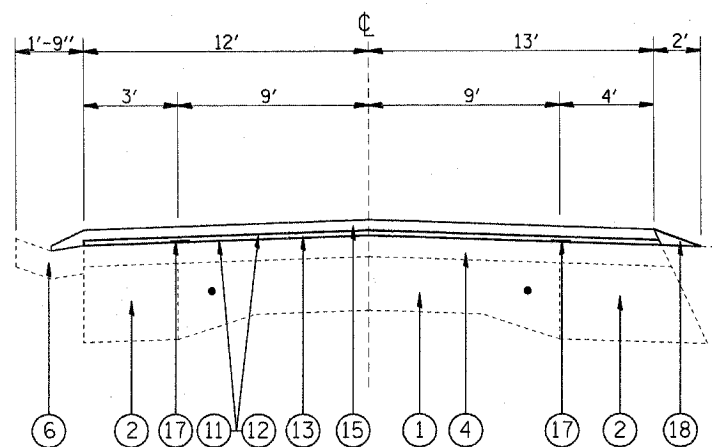

PROPOSED IL 154  
STA. 27+27 TO STA. 35+41  
STA. 196+55 TO STA. 208+00

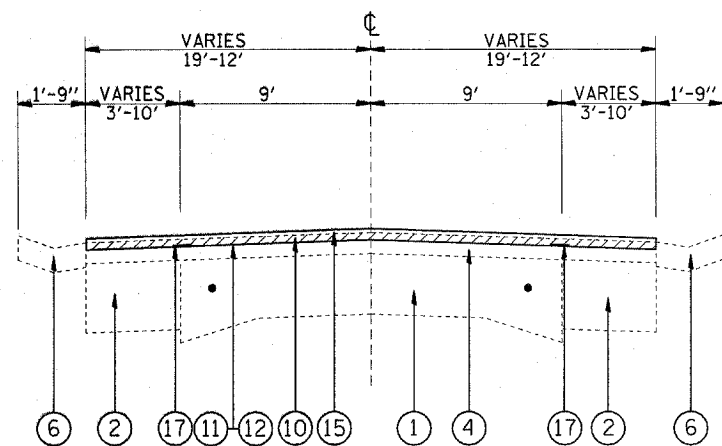

PROPOSED IL 154  
STA. 26+27 TO STA. 27+27

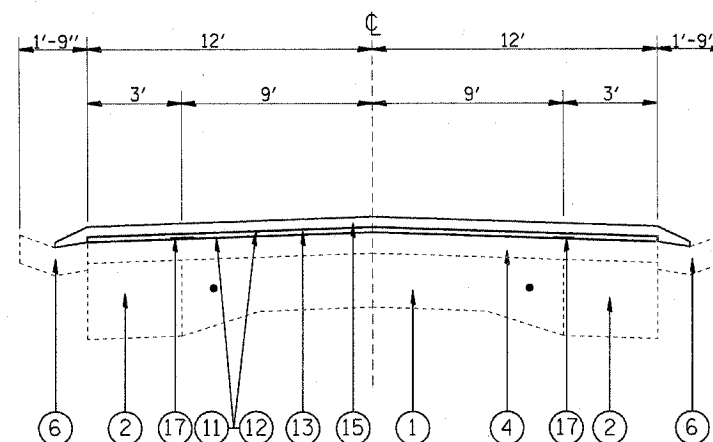

PROPOSED IL 154  
STA. 221+00 TO STA. 224+73  
STA. 229+25 TO STA. 239+70  
STA. 245+10 TO STA. 252+04  
STA. 278+23 TO STA. 284+73  
STA. 352+54 TO STA. 355+47  
STA. 376+13 TO STA. 398+36

LEGEND

- ① EXISTING P.C.C. PAVEMENT (9''-6''-9'')
- ② EXISTING HOT-MIX ASPHALT BASE COURSE WIDENING, 9''
- ③ EXISTING CONCRETE WIDENING, 8''
- ④ EXISTING HOT-MIX ASPHALT RESURFACING, 3''
- ⑤ EXISTING CONCRETE CURB AND GUTTER
- ⑥ EXISTING CONCRETE GUTTER
- ⑦ EXISTING HOT-MIX ASPHALT PARKING LANE
- ⑧ EXISTING P.C.C. PAVEMENT, 8''
- ⑨ EXISTING STABILIZED SHOULDER, 8'', TO BE REMOVED
- ⑩ PROPOSED HOT-MIX ASPHALT SURFACE REMOVAL, 1''
- ⑪ PROPOSED AGGREGATE (PRIME COAT)
- ⑫ PROPOSED BITUMINOUS MATERIALS (PRIME COAT)
- ⑬ PROPOSED LEVELING BINDER (MACHINE METHOD), N90, 3/4''
- ⑭ PROPOSED LEVELING BINDER (MACHINE METHOD), N90, 1''
- ⑮ PROPOSED HOT-MIX ASPHALT SURFACE COURSE, 1 1/2''
- ⑯ PROPOSED HOT-MIX ASPHALT SHOULDERS, 10 1/2''
- ⑰ PROPOSED STRIP REFLECTIVE CRACK CONTROL
- ⑱ PROPOSED AGGREGATE WEDGE SHOULDER, TYPE B

FILE NAME = c:\projects\ed01508\plan\pln01508a.dgn	USER NAME = duntelmanjn	DESIGNED - ---	REVISED - ---
		DRAWN - ---	REVISED - ---
	PLOT SCALE = 50.0000' / IN.	CHECKED - ---	REVISED - ---
	PLOT DATE = 3/21/2008	DATE - ---	REVISED - ---

STATE OF ILLINOIS  
DEPARTMENT OF TRANSPORTATION

TYPICAL SECTIONS

SCALE: \_\_\_\_\_ SHEET NO. \_\_\_ OF \_\_\_ SHEETS STA. \_\_\_\_\_ TO STA. \_\_\_\_\_

F.A.P. RTE. 329	SECTION (125,126)RS-2	COUNTY RANDOLPH	TOTAL SHEETS 34	SHEET NO. 6
CONTRACT NO. 76B38				
FED. ROAD DIST. NO. _____ ILLINOIS FED. AID PROJECT				

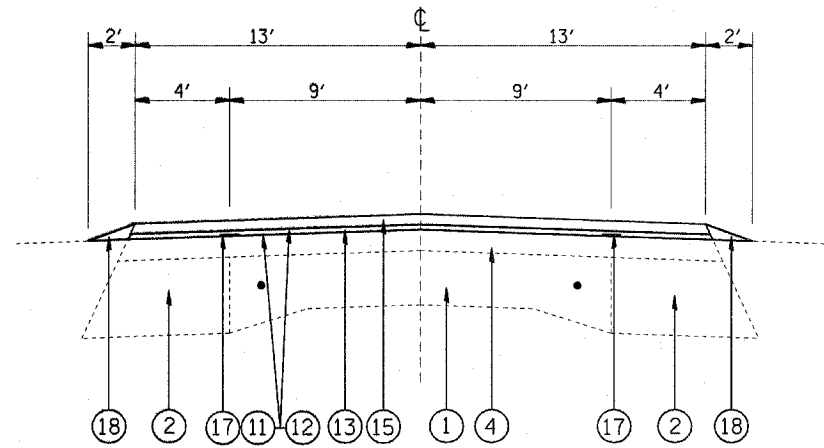

PROPOSED IL 154

STA. 35+41 TO STA. 196+55	STA. 284+73 TO STA. 295+65
STA. 208+00 TO STA. 214+06	STA. 339+09 TO STA. 352+54
STA. 217+50 TO STA. 220+00	STA. 335+47 TO STA. 376+13
STA. 224+73 TO STA. 229+25	STA. 371+20 TO STA. 376+13
STA. 239+70 TO STA. 245+10	STA. 398+36 TO STA. 446+56
STA. 252+04 TO STA. 278+23	STA. 457+50 TO STA. 470+25

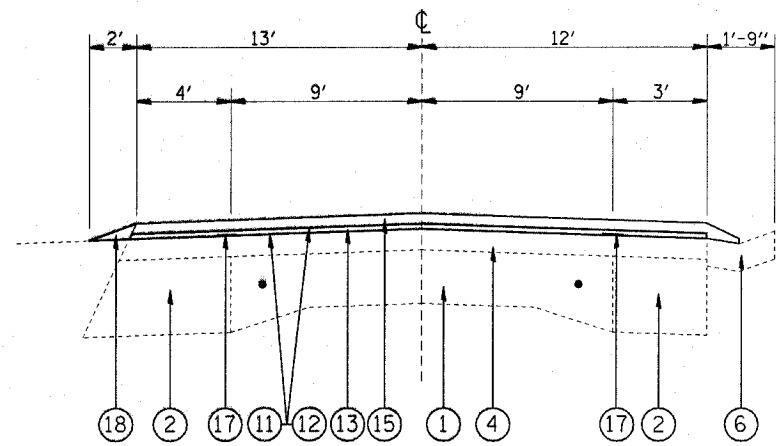

PROPOSED IL 154

STA. 214+06 TO STA. 217+50  
 STA. 220+00 TO STA. 221+00

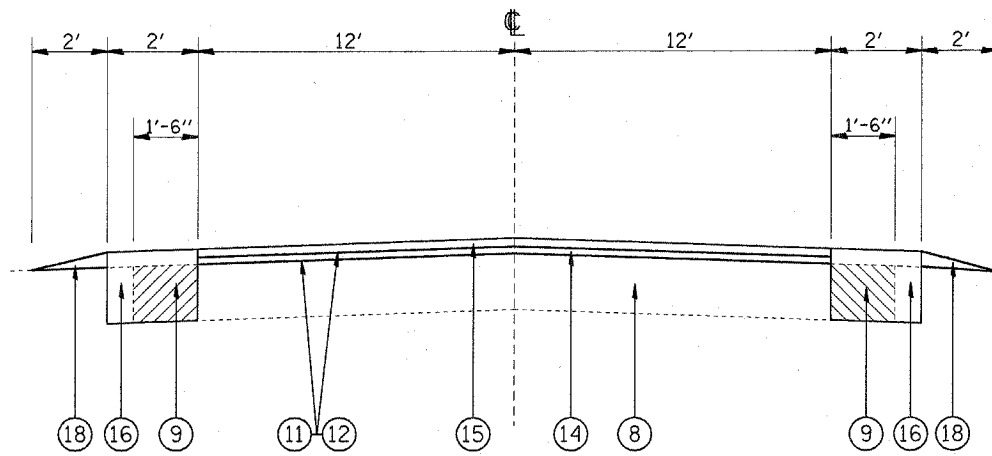

PROPOSED IL 154

STA. 295+65 TO STA. 339+09

LEGEND

- ① EXISTING P.C.C. PAVEMENT (9''-6''-9'')
- ② EXISTING HOT-MIX ASPHALT BASE COURSE WIDENING, 9''
- ③ EXISTING CONCRETE WIDENING, 8''
- ④ EXISTING HOT-MIX ASPHALT RESURFACING, 3''
- ⑤ EXISTING CONCRETE CURB AND GUTTER
- ⑥ EXISTING CONCRETE GUTTER
- ⑦ EXISTING HOT-MIX ASPHALT PARKING LANE
- ⑧ EXISTING P.C.C. PAVEMENT, 8''
- ⑨ EXISTING STABILIZED SHOULDER, 8'', TO BE REMOVED
- ⑩ PROPOSED HOT-MIX ASPHALT SURFACE REMOVAL, 1''
- ⑪ PROPOSED AGGREGATE (PRIME COAT)
- ⑫ PROPOSED BITUMINOUS MATERIALS (PRIME COAT)
- ⑬ PROPOSED LEVELING BINDER (MACHINE METHOD), N90, 3/4''
- ⑭ PROPOSED LEVELING BINDER (MACHINE METHOD), N90, 1''
- ⑮ PROPOSED HOT-MIX ASPHALT SURFACE COURSE, 1 1/2''
- ⑯ PROPOSED HOT-MIX ASPHALT SHOULDERS, 10 1/2''
- ⑰ PROPOSED STRIP REFLECTIVE CRACK CONTROL
- ⑱ PROPOSED AGGREGATE WEDGE SHOULDER, TYPE B

FILE NAME =	USER NAME = dintelmarjn	DESIGNED -	REVISED -
ca:\projects\ed81588\plan\pin81588a.dgn		DRAWN -	REVISED -
		CHECKED -	REVISED -
		DATE -	REVISED -

STATE OF ILLINOIS  
 DEPARTMENT OF TRANSPORTATION

TYPICAL SECTIONS

SCALE: \_\_\_\_\_ SHEET NO. \_\_\_\_ OF \_\_\_\_ SHEETS STA. \_\_\_\_\_ TO STA. \_\_\_\_\_

F.A.P. RTE.	SECTION	COUNTY	TOTAL SHEETS	SHEET NO.
329	(125,126)RS-2	RANDOLPH	34	7
CONTRACT NO. 76B38				
FED. ROAD DIST. NO. ILLINOIS FED. AID PROJECT				

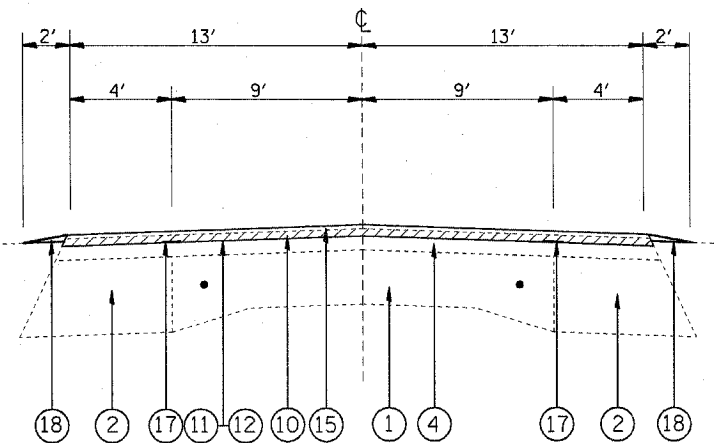

PROPOSED IL 154  
STA. 446+56 TO STA. 454+50

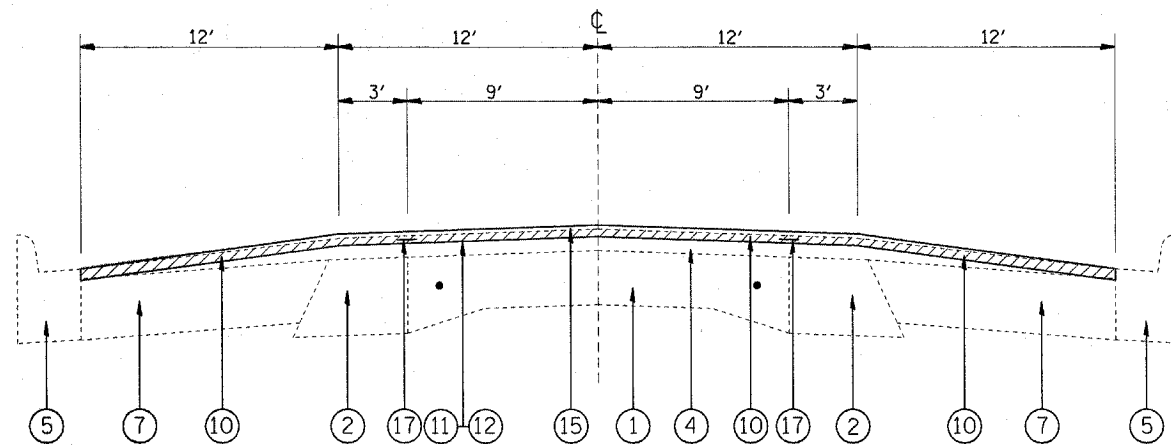

PROPOSED IL 154  
STA. 454+50 TO STA. 457+50

LEGEND

- ① EXISTING P.C.C. PAVEMENT (9''-6''-9'')
- ② EXISTING HOT-MIX ASPHALT BASE COURSE WIDENING, 9''
- ③ EXISTING CONCRETE WIDENING, 8''
- ④ EXISTING HOT-MIX ASPHALT RESURFACING, 3''
- ⑤ EXISTING CONCRETE CURB AND GUTTER
- ⑥ EXISTING CONCRETE GUTTER
- ⑦ EXISTING HOT-MIX ASPHALT PARKING LANE
- ⑧ EXISTING P.C.C. PAVEMENT, 8''
- ⑨ EXISTING STABILIZED SHOULDER, 8'', TO BE REMOVED
- ⑩ PROPOSED HOT-MIX ASPHALT SURFACE REMOVAL, 1''
- ⑪ PROPOSED AGGREGATE (PRIME COAT)
- ⑫ PROPOSED BITUMINOUS MATERIALS (PRIME COAT)
- ⑬ PROPOSED LEVELING BINDER (MACHINE METHOD), N90, 3/4''
- ⑭ PROPOSED LEVELING BINDER (MACHINE METHOD), N90, 1''
- ⑮ PROPOSED HOT-MIX ASPHALT SURFACE COURSE, 1 1/2''
- ⑯ PROPOSED HOT-MIX ASPHALT SHOULDERS, 10 1/2''
- ⑰ PROPOSED STRIP REFLECTIVE CRACK CONTROL
- ⑱ PROPOSED AGGREGATE WEDGE SHOULDER, TYPE B

FILE NAME = a:\projects\ed01588\plan\pin01588a.dgn	USER NAME = dntelmanjn	DESIGNED - ---	REVISED - ---
		DRAWN - ---	REVISED - ---
		CHECKED - ---	REVISED - ---
		DATE - ---	REVISED - ---

STATE OF ILLINOIS  
DEPARTMENT OF TRANSPORTATION

TYPICAL SECTIONS

SCALE: \_\_\_\_\_ SHEET NO. \_\_\_ OF \_\_\_ SHEETS STA. \_\_\_\_\_ TO STA. \_\_\_\_\_

F.A.P. RTE. 329	SECTION (125,126)RS-2	COUNTY RANDOLPH	TOTAL SHEETS 34	SHEET NO. 8
FED. ROAD DIST. NO. _____ ILLINOIS FED. AID PROJECT			CONTRACT NO. 76B38	



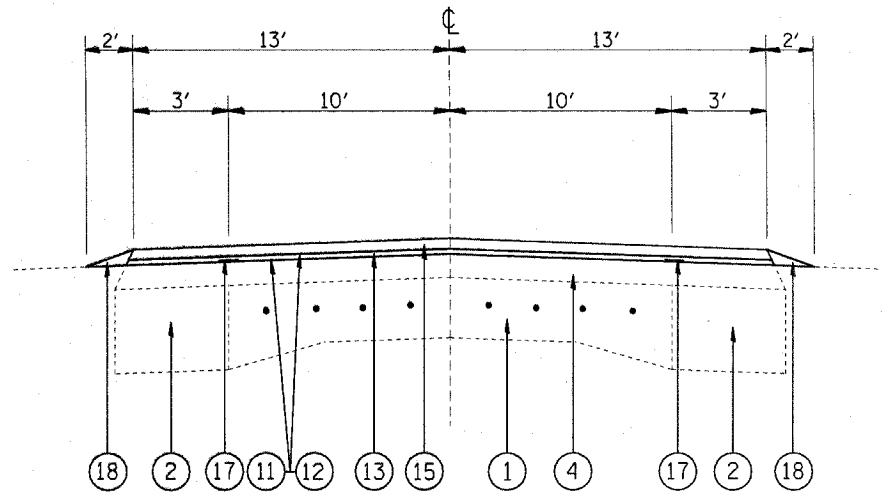

PROPOSED IL 154

STA. 470+25 TO STA. 499+55  
 STA. 505+52 TO STA. 513+18  
 STA. 520+41 TO STA. 596+86  
 STA. 600+94 TO STA. 612+02

STA. 618+30 TO STA. 630+66  
 STA. 632+72 TO STA. 642+64  
 STA. 651+93 TO STA. 797+50  
 STA. 897+30 TO STA. 900+73

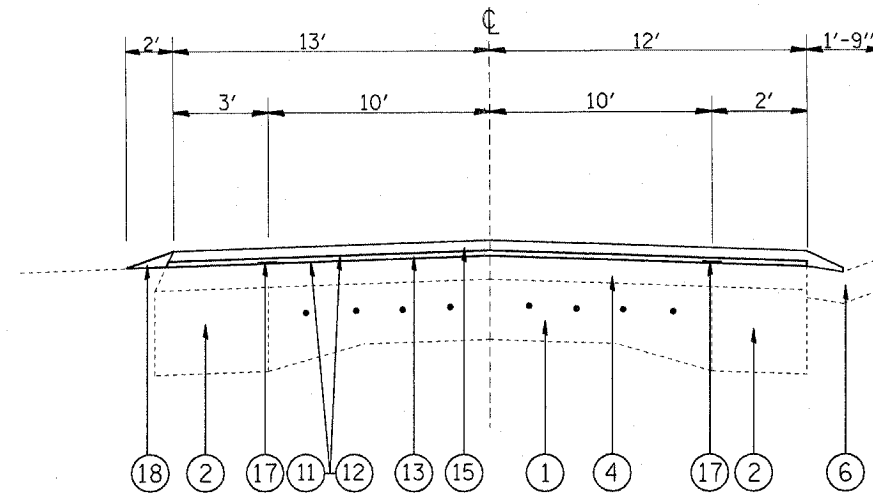

PROPOSED IL 154

STA. 519+09 TO STA. 520+41  
 STA. 642+64 TO STA. 651+93

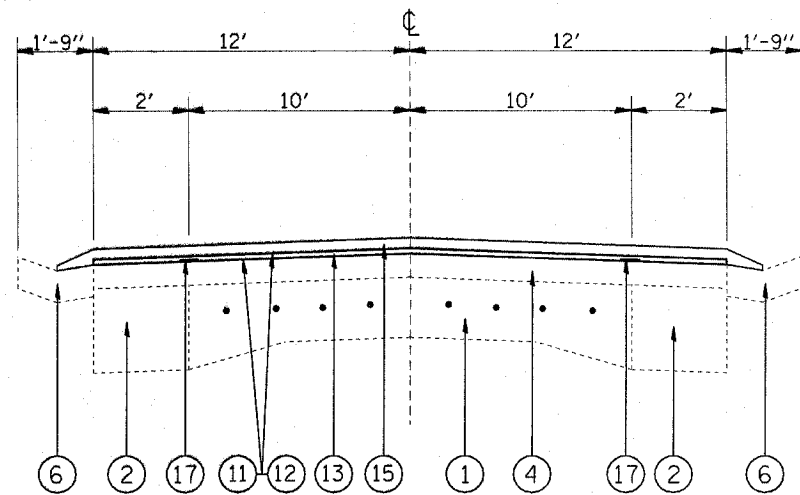

PROPOSED IL 154

STA. 499+55 TO STA. 505+52  
 STA. 513+18 TO STA. 519+09  
 STA. 596+86 TO STA. 600+94  
 STA. 612+02 TO STA. 618+30  
 STA. 630+66 TO STA. 632+72  
 STA. 797+50 TO STA. 810+60

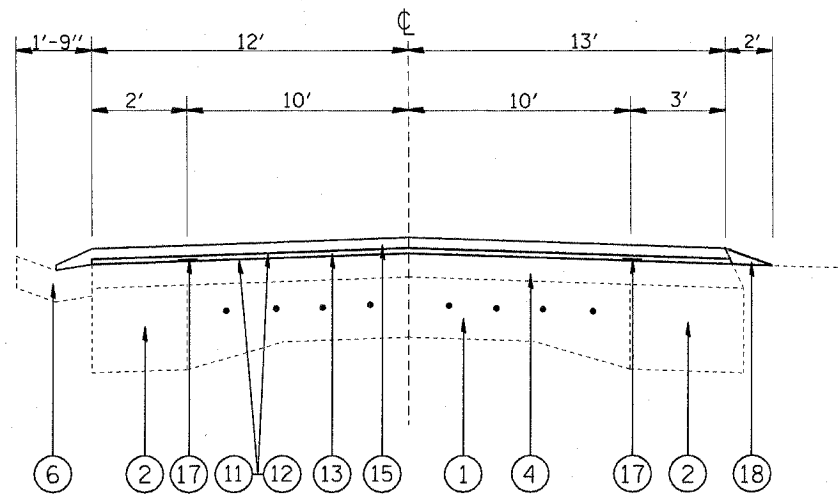

PROPOSED IL 154

STA. 810+60 TO STA. 897+30

LEGEND

- ① EXISTING P.C.C. PAVEMENT (9''-6''-9'')
- ② EXISTING HOT-MIX ASPHALT BASE COURSE WIDENING, 9''
- ③ EXISTING CONCRETE WIDENING, 8''
- ④ EXISTING HOT-MIX ASPHALT RESURFACING, 3''
- ⑤ EXISTING CONCRETE CURB AND GUTTER
- ⑥ EXISTING CONCRETE GUTTER
- ⑦ EXISTING HOT-MIX ASPHALT PARKING LANE
- ⑧ EXISTING P.C.C. PAVEMENT, 8''
- ⑨ EXISTING STABILIZED SHOULDER, 8'', TO BE REMOVED
- ⑩ PROPOSED HOT-MIX ASPHALT SURFACE REMOVAL, 1''
- ⑪ PROPOSED AGGREGATE (PRIME COAT)
- ⑫ PROPOSED BITUMINOUS MATERIALS (PRIME COAT)
- ⑬ PROPOSED LEVELING BINDER (MACHINE METHOD), N90, 3/4''
- ⑭ PROPOSED LEVELING BINDER (MACHINE METHOD), N90, 1''
- ⑮ PROPOSED HOT-MIX ASPHALT SURFACE COURSE, 1 1/2''
- ⑯ PROPOSED HOT-MIX ASPHALT SHOULDERS, 10 1/2''
- ⑰ PROPOSED STRIP REFLECTIVE CRACK CONTROL
- ⑱ PROPOSED AGGREGATE WEDGE SHOULDER, TYPE B

FILE NAME =	USER NAME = dntelmenjn	DESIGNED -	REVISED -
or\projects\1508\plan\pin01508a.dgn		DRAWN -	REVISED -
		CHECKED -	REVISED -
		DATE -	REVISED -

STATE OF ILLINOIS  
 DEPARTMENT OF TRANSPORTATION

TYPICAL SECTIONS

SCALE: \_\_\_\_\_ SHEET NO. \_\_\_\_ OF \_\_\_\_ SHEETS STA. \_\_\_\_\_ TO STA. \_\_\_\_\_

F.A.P. RTE.	SECTION	COUNTY	TOTAL SHEETS	SHEET NO.
329	(125,126)RS-2	RANDOLPH	34	9
FED. ROAD DIST. NO. - ILLINOIS FED. AID PROJECT			CONTRACT NO. 76B38	

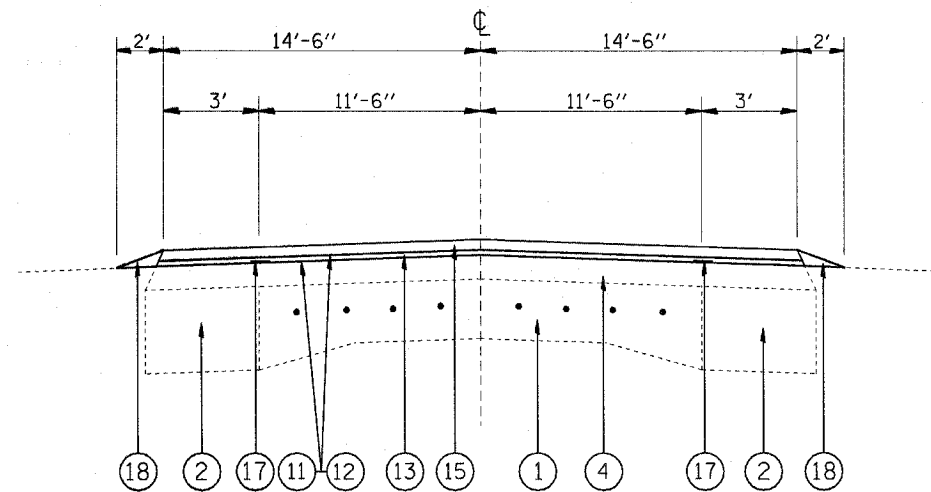

PROPOSED IL 154  
STA. 900+73 TO STA. 910+29

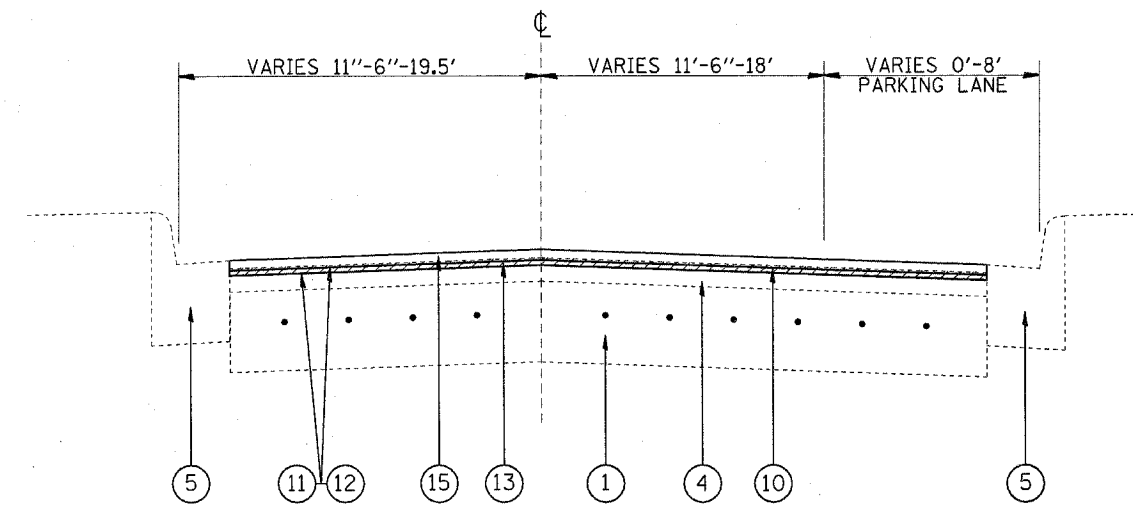

PROPOSED IL 154  
STA. 918+36 TO STA. 935+47  
(WALNUT ST. TO ST. LOUIS ST.)

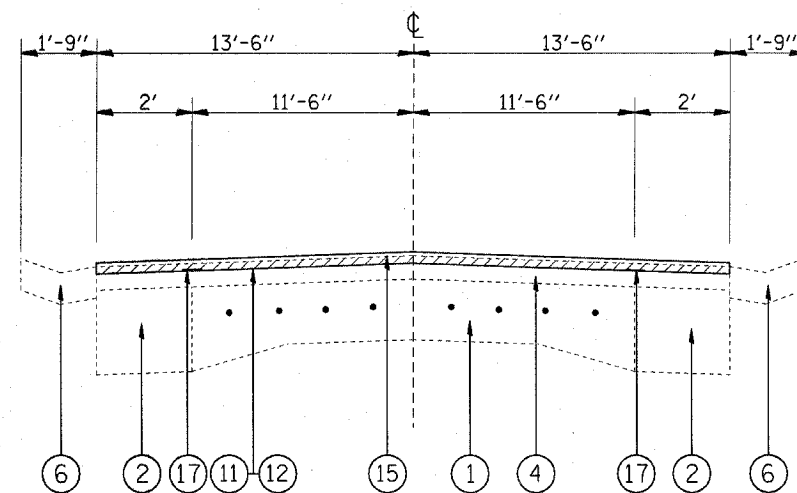

PROPOSED IL 154  
STA. 910+29 TO STA. 918+36

LEGEND

- ① EXISTING P.C.C. PAVEMENT (9'-6"-9')
- ② EXISTING HOT-MIX ASPHALT BASE COURSE WIDENING, 9"
- ③ EXISTING CONCRETE WIDENING, 8"
- ④ EXISTING HOT-MIX ASPHALT RESURFACING, 3"
- ⑤ EXISTING CONCRETE CURB AND GUTTER
- ⑥ EXISTING CONCRETE GUTTER
- ⑦ EXISTING HOT-MIX ASPHALT PARKING LANE
- ⑧ EXISTING P.C.C. PAVEMENT, 8"
- ⑨ EXISTING STABILIZED SHOULDER, 8", TO BE REMOVED
- ⑩ PROPOSED HOT-MIX ASPHALT SURFACE REMOVAL, 1"
- ⑪ PROPOSED AGGREGATE (PRIME COAT)
- ⑫ PROPOSED BITUMINOUS MATERIALS (PRIME COAT)
- ⑬ PROPOSED LEVELING BINDER (MACHINE METHOD), N90, 3/4"
- ⑭ PROPOSED LEVELING BINDER (MACHINE METHOD), N90, 1"
- ⑮ PROPOSED HOT-MIX ASPHALT SURFACE COURSE, 1 1/2"
- ⑯ PROPOSED HOT-MIX ASPHALT SHOULDERS, 10 1/2"
- ⑰ PROPOSED STRIP REFLECTIVE CRACK CONTROL
- ⑱ PROPOSED AGGREGATE WEDGE SHOULDER, TYPE B

FILE NAME =	USER NAME = dintelmanjn	DESIGNED -	REVISED -
at\projects\ed01500\plan\pin01508a.dgn		DRAWN -	REVISED -
		CHECKED -	REVISED -
		DATE -	REVISED -

STATE OF ILLINOIS  
DEPARTMENT OF TRANSPORTATION

TYPICAL SECTIONS

SCALE: \_\_\_\_\_ SHEET NO. \_\_\_\_ OF \_\_\_\_ SHEETS STA. \_\_\_\_\_ TO STA. \_\_\_\_\_

F.A.P. RTE.	SECTION	COUNTY	TOTAL SHEETS	SHEET NO.
329	(125,126)RS-2	RANDOLPH	34	10
FED. ROAD DIST. NO. - ILLINOIS FED. AID PROJECT			CONTRACT NO. 76B38	

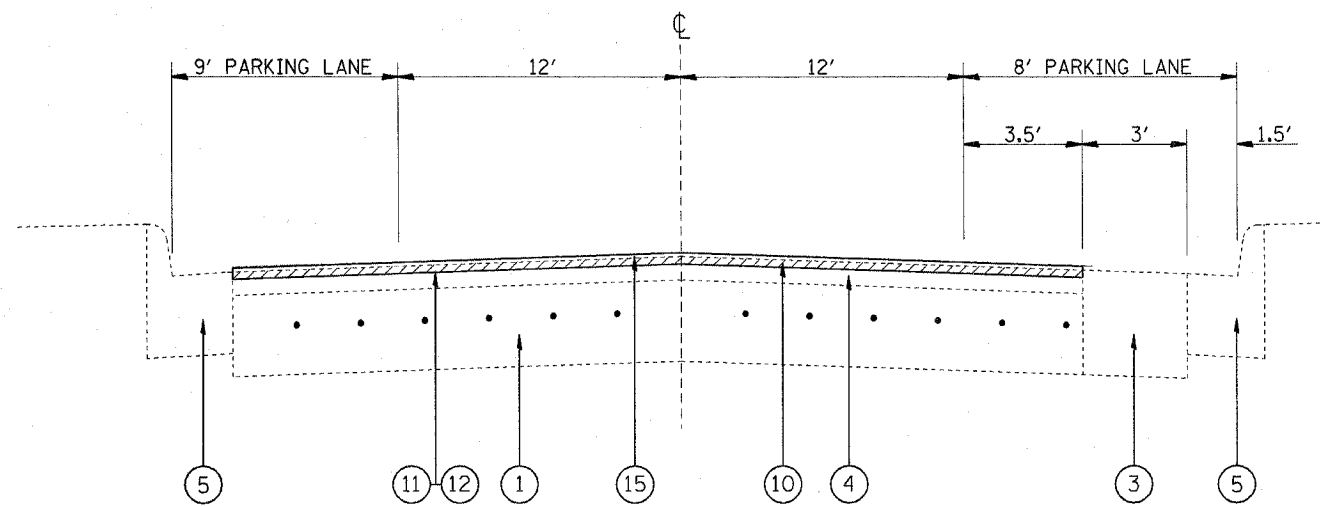

**PROPOSED IL 154**

STA. 935+47 TO STA. 941+54  
(ST. LOUIS ST. TO MARKET ST.)

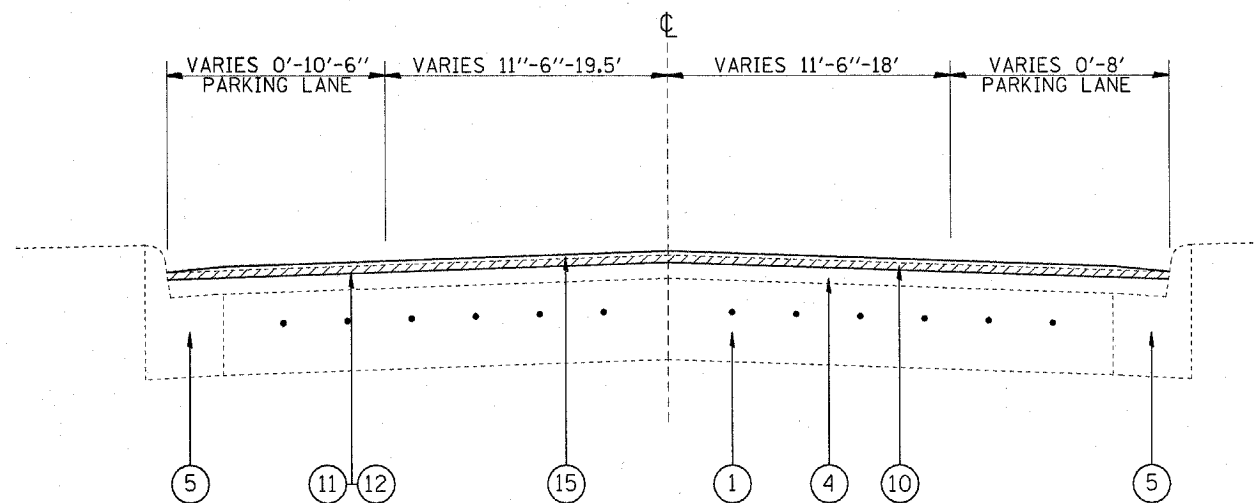

**PROPOSED IL 154**

STA. 941+54 TO STA. 974+20  
(MARKET ST. TO BURNS ST.)

**LEGEND**

- ① EXISTING P.C.C. PAVEMENT (9"-6"-9")
- ② EXISTING HOT-MIX ASPHALT BASE COURSE WIDENING, 9"
- ③ EXISTING CONCRETE WIDENING, 8"
- ④ EXISTING HOT-MIX ASPHALT RESURFACING, 3"
- ⑤ EXISTING CONCRETE CURB AND GUTTER
- ⑥ EXISTING CONCRETE GUTTER
- ⑦ EXISTING HOT-MIX ASPHALT PARKING LANE
- ⑧ EXISTING P.C.C. PAVEMENT, 8"
- ⑨ EXISTING STABILIZED SHOULDER, 8", TO BE REMOVED
- ⑩ PROPOSED HOT-MIX ASPHALT SURFACE REMOVAL, 1"
- ⑪ PROPOSED AGGREGATE (PRIME COAT)
- ⑫ PROPOSED BITUMINOUS MATERIALS (PRIME COAT)
- ⑬ PROPOSED LEVELING BINDER (MACHINE METHOD), N90, 3/4"
- ⑭ PROPOSED LEVELING BINDER (MACHINE METHOD), N90, 1"
- ⑮ PROPOSED HOT-MIX ASPHALT SURFACE COURSE, 1 1/2"
- ⑯ PROPOSED HOT-MIX ASPHALT SHOULDERS, 10 1/2"
- ⑰ PROPOSED STRIP REFLECTIVE CRACK CONTROL
- ⑱ PROPOSED AGGREGATE WEDGE SHOULDER, TYPE B

FILE NAME = c:\projects\ed01508\plan\pin01508a.dgn	USER NAME = dintelmanjn	DESIGNED - ---	REVISED - ---
		DRAWN - ---	REVISED - ---
		CHECKED - ---	REVISED - ---
		DATE - ---	REVISED - ---

**STATE OF ILLINOIS  
DEPARTMENT OF TRANSPORTATION**

**TYPICAL SECTIONS**

SCALE: \_\_\_\_\_ SHEET NO. \_\_\_ OF \_\_\_ SHEETS STA. \_\_\_\_\_ TO STA. \_\_\_\_\_

F.A.P. RTE.	SECTION	COUNTY	TOTAL SHEETS	SHEET NO.
329	(125,126)RS-2	RANDOLPH	34	11
FED. ROAD DIST. NO. _____ ILLINOIS FED. AID PROJECT			CONTRACT NO. 76B38	

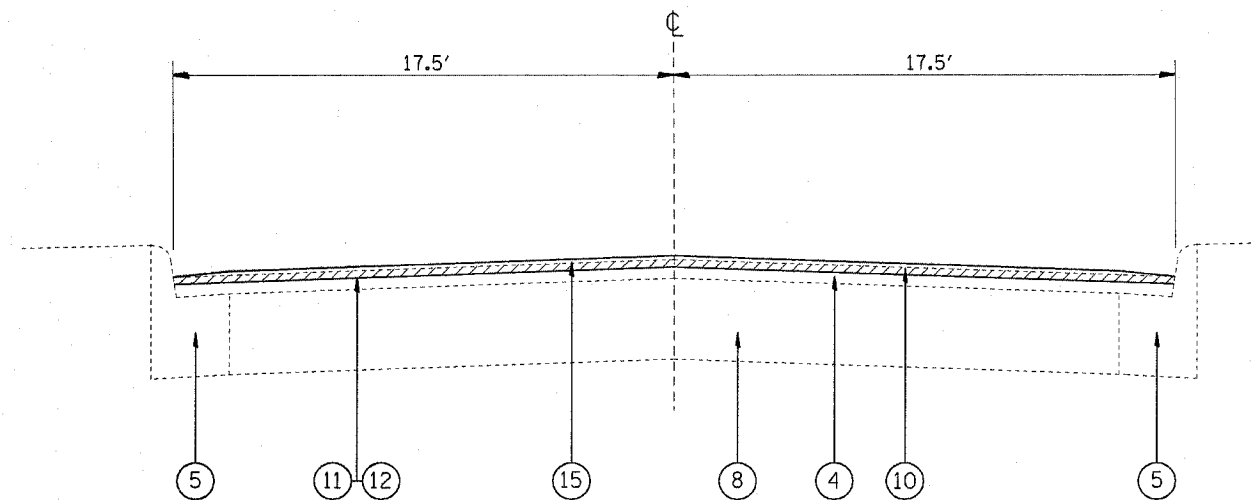

PROPOSED IL 4  
200' SOUTH OF  
IL 154 INTERSECTION

LEGEND

- ① EXISTING P.C.C. PAVEMENT (9"-6"-9")
- ② EXISTING HOT-MIX ASPHALT BASE COURSE WIDENING, 9"
- ③ EXISTING CONCRETE WIDENING, 8"
- ④ EXISTING HOT-MIX ASPHALT RESURFACING, 3"
- ⑤ EXISTING CONCRETE CURB AND GUTTER
- ⑥ EXISTING CONCRETE GUTTER
- ⑦ EXISTING HOT-MIX ASPHALT PARKING LANE
- ⑧ EXISTING P.C.C. PAVEMENT, 8"
- ⑨ EXISTING STABILIZED SHOULDER, 8", TO BE REMOVED
- ⑩ PROPOSED HOT-MIX ASPHALT SURFACE REMOVAL, 1"
- ⑪ PROPOSED AGGREGATE (PRIME COAT)
- ⑫ PROPOSED BITUMINOUS MATERIALS (PRIME COAT)
- ⑬ PROPOSED LEVELING BINDER (MACHINE METHOD), N90, 3/4"
- ⑭ PROPOSED LEVELING BINDER (MACHINE METHOD), N90, 1"
- ⑮ PROPOSED HOT-MIX ASPHALT SURFACE COURSE, 1 1/2"
- ⑯ PROPOSED HOT-MIX ASPHALT SHOULDERS, 10 1/2"
- ⑰ PROPOSED STRIP REFLECTIVE CRACK CONTROL
- ⑱ PROPOSED AGGREGATE WEDGE SHOULDER, TYPE B

FILE NAME = c:\projects\aed\1588\plan\pin@1588a.dgn	USER NAME = dinstelmenjn	DESIGNED - ---	REVISED - ---
		DRAWN - ---	REVISED - ---
	PLOT SCALE = 50.0000' / IN.	CHECKED - ---	REVISED - ---
	PLOT DATE = 3/21/2008	DATE - ---	REVISED - ---

**STATE OF ILLINOIS  
DEPARTMENT OF TRANSPORTATION**

<b>TYPICAL SECTIONS</b>	
SCALE: _____	SHEET NO. ____ OF ____ SHEETS STA. _____ TO STA. _____

F.A.P. RTE. 329	SECTION (125,126)RS-2	COUNTY RANDOLPH	TOTAL SHEETS 34	SHEET NO. 12
FED. ROAD DIST. NO. _____ ILLINOIS FED. AID PROJECT			CONTRACT NO. 76B38	

## RESURFACING SCHEDULE

LOCATION			Length	Gutter Lt.	Gutter Rt.	No Gutter	Curb & Gutter	BIT. MAT'L PRIME COAT	AGGREGATE PRIME COAT	HMA LEVEL BINDER COURSE 3/4"	HMA LEVEL BINDER COURSE 1"	HMA SURFACE COURSE 1.5"	HMA SURFACE COURSE 2"	HMA SHOULDERS, 10 1/2"	AGG WEDGE SHOULDER TYPE B	STRIP REFLECTIVE CRACK CONTROL	REMARKS	
Sta.	To	Sta.																
								(TON)	(TON)	(TON)	(TON)	(TON)	(TON)	(SQ YD)	(TON)	(FOOT)		
IL 154																		
1+44	to	26+27	2483				X	3.45	16.55								4966	PARKING LANES
26+27	to	27+27	100	X	X			0.22	1.04	14.47							200	
27+27	to	35+41	814	X				1.42	6.78	94.97					44.84		1628	
35+41	to	196+55	16114			X		29.14	139.66	1955.17					887.71		32228	
196+55	to	208+00	1145	X				2.00	9.54	133.58					63.08		2290	
208+00	to	214+06	606			X		1.10	5.26	73.53					33.38		1212	
214+06	to	217+50	344		X			0.60	2.86	40.13					18.95		688	
217+50	to	220+00	250			X		0.46	2.16	30.33					13.77		500	
220+00	to	221+00	100		X			0.18	0.84	11.67					5.51		200	
221+00	to	224+73	373	X	X			0.62	2.98	41.78							746	
224+73	to	229+25	452			X		0.82	3.92	54.84					24.90		904	
229+25	to	239+70	1045	X	X			1.74	8.36	117.04							2090	
239+70	to	245+10	540			X		0.98	4.68	65.52					29.75		1080	
245+10	to	252+04	694	X	X			1.16	5.56	77.73							1388	
252+04	to	278+23	2619			X		4.74	22.70	317.77					144.28		5238	
278+23	to	284+73	650	X	X			1.08	5.20	72.8							1300	
284+73	to	295+65	1092			X		1.82	8.74	122.3					60.16		2184	
295+65	to	317+69	2204			X		4.14	19.84		370.27			925.00	157.13			CONCRETE SEC.
317+69	to	326+23	854						0.00									BRIDGE OMISSION
326+23	to	339+09	1286			X		2.42	11.58		216.05			516.00	91.68			CONCRETE SEC.
339+09	to	352+54	1345			X		2.44	11.66	163.19					74.10		2690	
352+54	to	355+47	293	X	X			0.48	2.34	32.82							586	
355+47	to	376+13	2066			X		3.74	17.90	250.67					113.81		4132	
376+13	to	398+36	2223	X	X			3.70	17.78	248.98							4446	
398+36	to	446+56	4820			X		8.72	41.78	584.83					265.53		9640	
446+56	to	454+50	794			X		0.72	3.44	96.34							1588	
454+50	to	457+50	300				X	0.50	2.40								600	PARKING LANES
457+50	to	470+25	1275			X		2.30	11.06	154.7					70.24		2550	
470+25	to	499+55	2930			X		5.30	25.40	355.51					161.41		5860	
499+55	to	505+52	557	X	X			0.92	4.46	62.38							1114	
505+52	to	513+18	766			X		1.38	6.64	92.94					42.20		1532	
513+18	to	519+09	591	X	X			0.98	4.72	66.19							1182	
519+09	to	520+41	132	X				0.22	1.10	15.4					7.27		264	
520+41	to	596+86	7645			X		13.82	66.26	927.59					421.16		15290	
596+86	to	600+94	408	X	X			0.68	3.26	45.7							816	
600+94	to	608+94	800															BRIDGE OMISSION
608+94	to	612+02	308			X		0.56	2.66	37.37					16.97		616	
612+02	to	618+30	628	X	X			1.04	5.02	70.34							1256	
618+30	to	626+86	856			X		1.54	7.42	103.86					47.16		1712	
626+86	to	628+32	146															BRIDGE OMISSION
628+32	to	630+66	234			X		0.42	2.02	28.39					12.89		468	
630+66	to	632+72	206	X	X			0.34	1.64	23.07							412	
632+72	to	642+64	992			X		1.80	8.60	120.36					54.65		1984	
642+64	to	651+93	929	X				1.62	7.74	108.38					51.18		1858	
651+93	to	717+74	6581			X		11.90	57.04	798.49					362.54		13162	
717+74	to	720+21	247														494	BRIDGE OMISSION
720+21	to	785+94	6573			X		11.88	56.96	797.52					362.10		13146	
785+94	to	786+27	33												1.82		66	BRIDGE OMISSION
786+27	to	797+50	1123			X		2.04	9.74	136.26					61.87		2246	
797+50	to	810+60	1310	X	X			2.18	10.48	146.72							2620	
810+60	to	897+30	8670	X				15.68	75.14	1051.96					477.63		17340	
897+30	to	900+73	343			X		0.60	2.86	40.02					18.90		686	
900+73	to	910+29	956			X		1.92	9.24	129.38					52.67		1912	
910+29	to	918+36	807	X	X			0.76	3.63	51.49							1614	
918+36	to	930+67	1231				X	1.24	5.95	166.6							2462	
930+67	to	935+47	480				X	1.26	6.08	85.12								PARKING LANES
935+47	to	941+54	607			X		0.77	3.69		52.58		86					PARKING LANES
941+54	to	944+76	322			X		0.26	1.23		19.82		81					
944+76	to	947+93	317				X	0.28	1.32									
947+93	to	952+31	438			X		0.52	2.48									
952+31	to	958+12	581			X		0.73	3.49									PARKING LANES
958+12	to	974+20	1608			X		2.04	9.78									PARKING LANES
IL 4																		
200' SOUTH OF INTERSECTION			200				X	0.24	1.17		13.61		52					
100' NORTH OF INTERSECTION			100				X	0.14	0.64		23.65		31					
TOTAL								165.8	795	10165	696	23940	250	1441	4252		175186	

FILE NAME =	USER NAME = dntelmerjn	DESIGNED - ---	REVISED - ---	<b>STATE OF ILLINOIS DEPARTMENT OF TRANSPORTATION</b>	<b>RESURFACING SCHEDULE</b>				F.A.P. RTE. 329	SECTION (125,126)RS-2	COUNTY RANDOLPH	TOTAL SHEETS 34	SHEET NO. 13
at\projects\ed01508\plan\p1n01508a.dgn		DRAWN - ---	REVISED - ---		SCALE: _____ SHEET NO. ___ OF ___ SHEETS STA. _____ TO STA. _____				CONTRACT NO. 76B38				
		CHECKED - ---	REVISED - ---		FED. ROAD DIST. NO. _____ ILLINOIS FED. AID PROJECT								
		DATE - -----	REVISED - ---										

ENTRANCE/SIDE ROAD SCHEDULE

LOCATION		MATERIAL	WIDTH	LENGTH	HMA SURFACE REMOVAL- BUTT JOINT	CONC. SURFACE REMOVAL- BUTT JOINT	INCIDENTAL HMA SURFACING	REMARKS
STATION			(FOOT)	(FOOT)	(SQ YD)	(SQ YD)	(TON)	
29+42	RT	HMA	75	15	125.00		14.00	LOCKWOOD DR.
33+12	RT	CONC.	105	15		175.00	19.60	KENNEDY DR.
37+34	RT	CONC.	105	15		175.00	19.60	DISC. YOUTH CENTER
38+98	LT	CONC.	45	15		75.00	8.40	EAST SIDE AUTO
39+46	LT	CONC.	65	15		108.33	12.13	MOORMANS
40+10	LT	CONC.	35	15		58.33	6.53	MOORMANS
41+04	LT	CONC.	145	15		241.67	27.07	B & E INDUSTRIAL
47+90	LT	CONC.	105	15		175.00	19.60	
56+88	LT	CONC.	55	15		91.67	10.27	CHURCH
69+55	LT	HMA	85	15	141.67		15.87	GRIGGS RD.
164+06	LT	HMA	70	15	116.67		13.07	N. PRAIRIE RD.
164+06	RT	HMA	140	15	233.33		26.13	S. PRAIRIE RD.
302+40	LT	HMA	60	15	100.00		11.20	GRIGGS RD.
302+40	RT	HMA	60	15	100.00		11.20	GRIGGS RD.
298+84	RT	CONC.	112	15		186.67	20.91	RIVERVIEW RD.
302+22	LT	AGG.	55	15	91.67		10.27	BOWLIN
360+48	RT	HMA	60	15	100.00		11.20	RABE RD.
360+48	LT	HMA	60	15	100.00		11.20	CONSERVATION RD.
376+32	LT	HMA	95	15	158.33		17.73	ZANDERS
412+22	RT	HMA	55	15	91.67		10.27	SANDY DR
412+75	LT	HMA	40	15	66.67		7.47	K-RIVER MOTEL
500+25	LT	HMA	50	15	83.33		9.33	K-RIVER MOTEL
429+12	RT	HMA	25	15	41.67		4.67	PRIV. ENT.
435+46	LT	CONC.	50	15		83.33	9.33	IRONHORSE INC.
450+24	RT	CONC.	70	15		116.67	13.07	
457+67	LT	HMA	50	40	222.22		24.89	FIFTH ST.
457+67	RT	HMA	50	40	222.22		24.89	FIFTH ST.
470+25	RT	CONC.	50	15	83.33	83.33	9.33	HARTMANN FARM
524+16	RT	HMA	45	15	75.00		8.40	DEGEN LN
526+80	LT	HMA	35	15	58.33		6.53	FALLVIEW RD
557+04	LT	AGG.	60	15	100.00		11.20	CHERIDAN
557+04	RT	AGG.	50	15	83.33		9.33	CHERIDAN
587+52	LT	AGG.	43	15	71.67		8.03	SPRIETLER
614+98	RT	HMA	70	15	116.67		13.07	SPRINGVIEW
639+26	RT	HMA	25	15	41.67		4.67	CEMETARY
654+05	LT	HMA	70	15	116.67		13.07	HICKORY GROVE
654+05	RT	HMA	35	15	58.33		6.53	HICKORY GROVE
690+48	RT	HMA	95	15	158.33		17.73	LESSELY
690+60	LT	HMA	112	15	186.67		20.91	LESSELY
745+92	RT	HMA	63	15	105.00		11.76	WOODCOX
872+64	LT	HMA	65	15	108.33		12.13	PLUM CREEK
876+25	RT	HMA	100	15	166.67		18.67	RIDGE
876+25	LT	AGG.	50					RIDGE
883+20	LT	HMA	24	15	40.00		4.48	PRIV. ENT.
883+73	LT	HMA	24	15	40.00		4.48	PRIV. ENT.
901+68	LT	HMA	30	15	50.00		5.60	PRIV. ENT.
TOTAL					3785	1570	591	

BUTT JOINTS/TEMP. RAMPS

LOCATION			LENGTH	WIDTH	HMA SURFACE REMOVAL- BUTT JOINT	CONC. SURFACE REMOVAL- BUTT JOINT	TEMPORARY RAMPS	COMMENTS
STA.	TO	STA.			(sq yds)	(sq yds)	(sq yds)	
1+44	TO	1+54	10	40	45		22	BEG. RESURF.
295+00	TO	295+45	45	26	130		14	R&R CROSSING
295+65	TO	295+80	50	24		134	13	BEG. CONC.
316+96	TO	317+69	73	24	195		13	STR. 0013 WST
326+23	TO	326+96	73	24	195		13	STR. 0013 EST
623+14	TO	623+59	45	26	130		14	STR. 0046 WST
631+29	TO	631+74	45	26	130		14	STR. 0046 EST
717+29	TO	717+74	45	26	130		14	STR. 0016 WST
719+21	TO	720+36	45	26	130		14	STR. 0016 EST
785+49	TO	785+94	45	26	130		14	STR. 0017 WST
786+27	TO	786+72	45	26	130		14	STR. 0017 EST
974+10	TO	974+20	10	36	45		20	END RESURF.
IL 4								
100' NORTH OF INTERSECTION				38			42	
200' SOUTH OF INTERSECTION			10	35	39		19	
ST. LOUIS STR. NORTH				26			28	
ST. LOUIS STR. SOUTH				26			28	
TOTAL					1517	134	324	

RIPRAP  
SCHEDULE

LOCATION	DUMPED RIPRAP	REMARKS
STATION	(TON)	
509+34	9	(079-2460)*
711+40	9	(079-2463)*
TOTAL	18	

\*SEE DETAIL SHEET NO. 33

REMOVAL SCHEDULE

LOCATION			HMA SURFACE REMOVAL 1"	HMA SURFACE REMOVAL 1.5"	HMA SURFACE REMOVAL 3"	PAVED SHOULDER REMOVAL	REMARKS
STA	TO	STA	(SQ YD)	(SQ YD)	(SQ YD)	(SQ YD)	
IL 154							
1+44	to	26+27	11036				RED BUD
26+27	to	27+27	350				RED BUD
295+65	to	316+46				694	
327+46	to	339+07				387	
446+56	to	454+50	2294				BALDWIN
454+50	to	457+50	1600				BALDWIN
457+50	to	458+50	289				BALDWIN
910+29	to	918+36	2421				
918+36	to	930+67	3967				
930+67	to	935+47	2027				SPARTA *
935+47	to	941+54	2765		762		SPARTA *
941+54	to	944+76	1395		718		SPARTA
944+76	to	947+93	1268				SPARTA
947+93	to	952+31	1752				SPARTA
952+31	to	958+12	2324	643			SPARTA
958+12	to	974+01	6356				SPARTA
IL 4							
200' SOUTH OF INTERSECTION			583		268		
100' NORTH OF INTERSECTION					458		
TOTAL =			40426	643	2206	1081	

\*SEE PLAN SHEET 23 FOR LOCATION

AGGREGATE SURFACE COURSE, TYPE B						
LOCATION			AGGREGATE ENTRANCES		MAILBOX TURNOUTS	REMARKS
			PRIVATE ENTRANCE	COMMERCIAL ENTRANCE		
			(TON)	(TON)	(TON)	
1+44	TO	50+00	1.40			1 P.E.
50+00	TO	100+00	8.40	3.73	38.26	6 P.E./1 C.E./4 M.B.
100+00	TO	150+00	4.20		19.13	3 P.E./2 M.B.
150+00	TO	200+00				
200+00	TO	250+00	4.20		9.57	3 P.E./1 M.B.
250+00	TO	300+00	1.40	3.73		1 P.E./1 C.E.
300+00	TO	350+00	7.00			4 P.E.
350+00	TO	400+00	2.80		57.40	2 P.E.
400+00	TO	450+00	22.40	14.93	172.19	16 P.E./4 C.E. /6 M.B.
450+00	TO	500+00	25.20	3.73		18 P.E./1 C.E./18 M.B.
500+00	TO	550+00	5.60	11.20		4 P.E./3 C.E.
550+00	TO	600+00	1.40		9.57	1 P.E./1 M.B.
600+00	TO	650+00				
650+00	TO	700+00	2.80		19.13	2 P.E./2 M.B.
700+00	TO	750+00	5.60	7.47	19.13	4 P.E./2 M.B./2 C.E.
750+00	TO	800+00	8.40		47.83	6 P.E./5 M.B.
800+00	TO	850+00	14.00		76.53	10 P.E./8 M.B.
850+00	TO	900+00	11.20	7.47	76.53	8 P.E. /2 C.E./8 M.B.
900+00	TO	950+00	2.80	3.73	9.57	2 P.E./1 C.E./1 M.B.
950+00	TO	1000+00				
SUB-TOTALS			129	56	555	
TOTAL				740		







PATCHING SCHEDULE

LOCATION	LT/RT	LENGTH	WIDTH	PAVEMENT PATCHING 12"		
				TYPE 2	TYPE 3	TYPE 4
				(FEET)	(FEET)	(SQ YDS)
5+28	LT	6	12	8		
5+28	RT	6	12	8		
15+84	LT	6	8	5		
18+48	RT	500	3			167
21+12	LT	25	6		17	
47+52	RT	20	13			29
52+80	RT	8	13	12		
53+32	RT	8	6	5		
55+44	RT	8	13	12		
57+05	RT	6	16	11		
58+08	RT	6	13	9		
60+72	RT	15	6	10		
63+36	LT	8	13	12		
63+36	RT	8	13	12		
66+00	LT	6	13	9		
66+00	RT	6	13	9		
67+06	RT	10	13	14		
68+64	LT	30	6		20	
68+68	RT	30	6		20	
73+92	LT	6	13	9		
73+92	RT	8	13	12		
89+76	LT	30	13			43
116+16	LT	20	13			29
121+44	RT	6	13	9		
132+00	RT	8	6	5		
142+56	RT	30	6		20	
147+84	LT	6	13	9		
150+48	LT	10	13	14		
150+48	RT	10	13	14		
151+80	LT	10	13	14		
151+80	RT	10	13	14		
153+12	LT	10	13	14		
153+12	RT	40	6			27
158+40	LT	6	13	9		
158+40	RT	6	13	9		
168+96	LT	8	13	12		
168+96	RT	8	13	12		
174+24	RT	40	6			27
174+24	LT	10	13	14		
184+40	RT	15	13		22	
184+40	LT	15	13		22	
195+36	RT	6	13	9		
195+36	LT	6	13	9		
196+41	LT	6	13	9		
216+48	LT	8	13	12		
217+54	LT	20	13			29
219+12	LT	30	10			33
242+88	RT	10	13	14		
242+88	LT	10	13	14		
258+72	LT	8	13	12		
217+54	LT	20	13			29
219+12	LT	30	10			33
242+88	LT	10	13	14		
242+88	RT	10	13	14		
261+36	RT	6	13	9		
264+00	LT	12	13		17	
269+28	LT	12	13		17	
269+28	RT	12	13		17	
270+34	RT	10	13	14		
270+34	LT	10	13	14		
271+92	RT	200	6			133
271+92	LT	200	6			133

LOCATION	LT/RT	LENGTH	WIDTH	PAVEMENT PATCHING 12"		
				TYPE 2	TYPE 3	TYPE 4
				(FEET)	(FEET)	(SQ YDS)
273+50	RT	25	6		17	
274+56	LT	6	13	9		
353+76	RT	20	6	13		
380+16	LT	8	13	12		
401+28	LT	20	6	13		
406+56	LT	6	13	9		
406+56	RT	10	13	14		
438+24	LT	15	6	10		
443+52	LT	6	13	9		
464+64	LT	10	13	14		
469+92	LT	8	13	12		
469+92	RT	8	13	12		
485+76	LT	6	13	9		
485+76	RT	6	13	9		
491+04	LT	10	13	14		
496+32	LT	10	13	14		
496+32	RT	10	13	14		
506+88	RT	20	6	13		
509+52	RT	8	13	12		
512+16	LT	10	6	7		
513+22	LT	10	6	7		
514+80	LT	10	6	7		
515+86	RT	6	13	9		
515+86	LT	6	13	9		
533+28	RT	30	6		20	
554+40	LT	10	6	7		
570+24	LT	20	6	13		
570+24	RT	20	6	13		
586+08	LT	10	13	14		
607+20	LT	10	13	14		
644+16	RT	8	13	12		
644+16	LT	8	13	12		
681+12	RT	8	13	12		
681+12	LT	8	13	12		
686+40	LT	15	6	10		
691+68	LT	15	13		22	
694+32	RT	15	6	10		
731+28	LT	6	13	9		
749+76	RT	8	13	12		
749+76	LT	8	13	12		
760+32	LT	50	6			33
770+88	LT	30	13			43
823+68	LT	25	13			36
824+74	LT	10	6	7		
836+88	LT	6	13	9		
860+64	RT	10	13	14		
865+92	LT	30	13			43
897+60	LT	8	6	5		
910+80	RT	10	6	7		
924+00	RT	8	6	5		
929+28	RT	15	6	10		
939+84	RT	10	13	14		
941+16	RT	8	6	5		
942+48	RT	8	6	5		
955+68	RT	10	6	7		
966+24	RT	10	6	7		
SUB--TOTALS				958	231	867
15% FOR ANTICIPATED FAILURES				144	35	130
TOTALS				1102	266	997

FILE NAME = c:\projects\ed01508\plan\pln01508a.dgn	USER NAME = dntelmenjn	DESIGNED - ---	REVISED - ---
		DRAWN - ---	REVISED - ---
		CHECKED - ---	REVISED - ---
		DATE - ---	REVISED - ---

STATE OF ILLINOIS  
DEPARTMENT OF TRANSPORTATION

PATCHING SCHEDULE

SCALE: \_\_\_\_\_ SHEET NO. \_\_\_ OF \_\_\_ SHEETS STA. \_\_\_\_\_ TO STA. \_\_\_\_\_

F.A.P. RTE. 329	SECTION (125,126)RS-2	COUNTY RANDOLPH	TOTAL SHEETS 34	SHEET NO. 18
CONTRACT NO. 76B38				
FED. ROAD DIST. NO. _____ ILLINOIS FED. AID PROJECT				

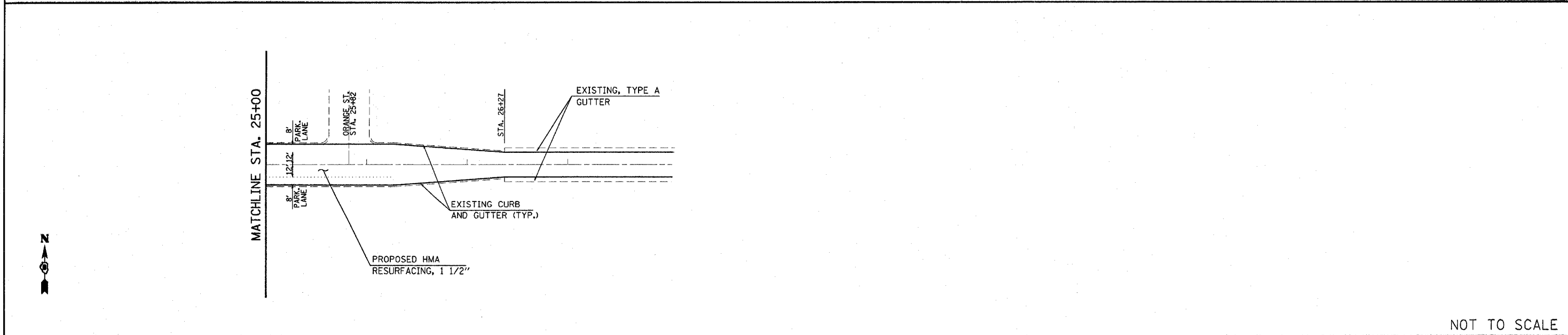
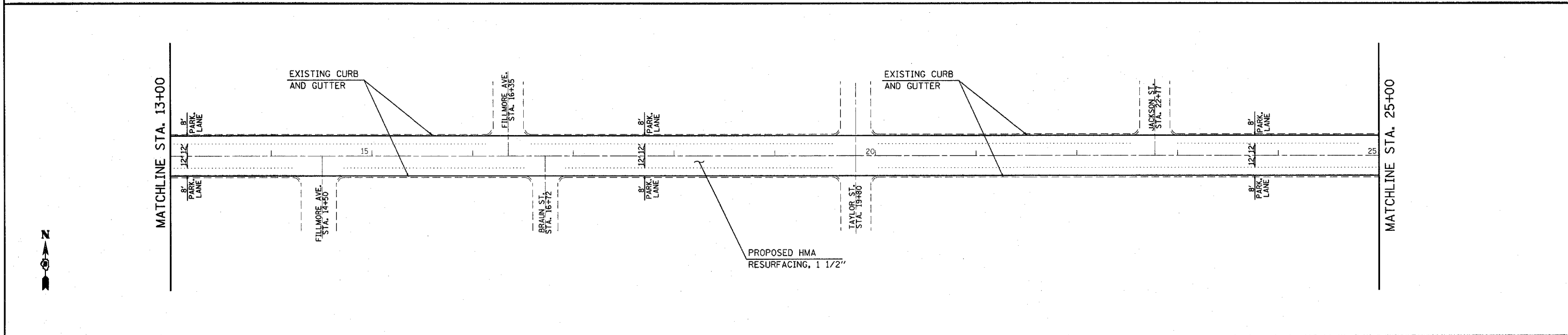
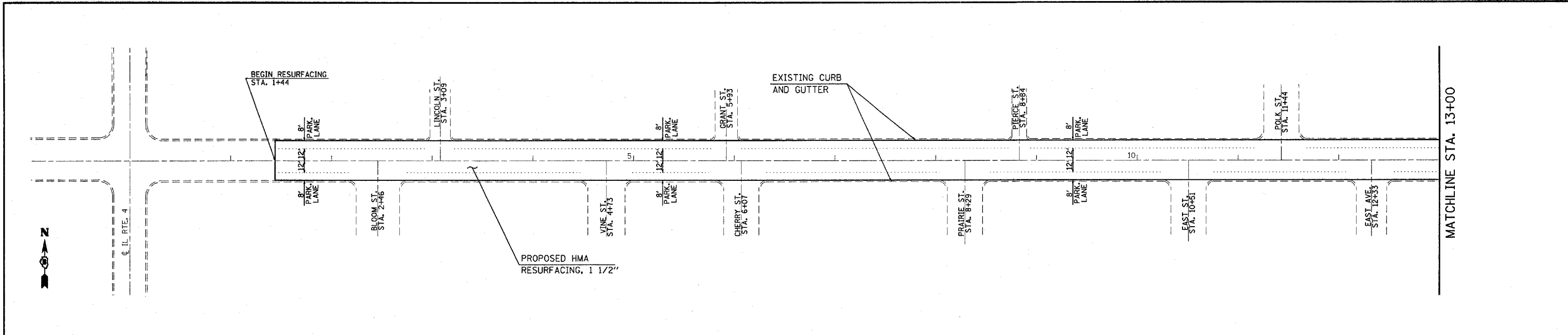

FILE NAME =  
c:\projects\redbud\plan\pin01588a.dgn

USER NAME = dntelmerjn  
DESIGNED -  
DRAWN -  
PLOT SCALE = 50.0000' / IN.  
CHECKED -  
PLOT DATE = 3/21/2008

DESIGNED -  
DRAWN -  
CHECKED -  
DATE -

REVISED -  
REVISED -  
REVISED -  
REVISED -

**STATE OF ILLINOIS  
DEPARTMENT OF TRANSPORTATION**

**PLAN VIEW (RED BUD)**

SCALE: \_\_\_\_\_ SHEET NO. \_\_\_\_ OF \_\_\_\_ SHEETS STA. \_\_\_\_\_ TO STA. \_\_\_\_\_

F.A.P. RTE.	SECTION	COUNTY	TOTAL SHEETS	SHEET NO.
329	(125,126)RS-2	RANDOLPH	34	19
CONTRACT NO. 76B38				
FED. ROAD DIST. NO. _____ ILLINOIS FED. AID PROJECT				

NOT TO SCALE

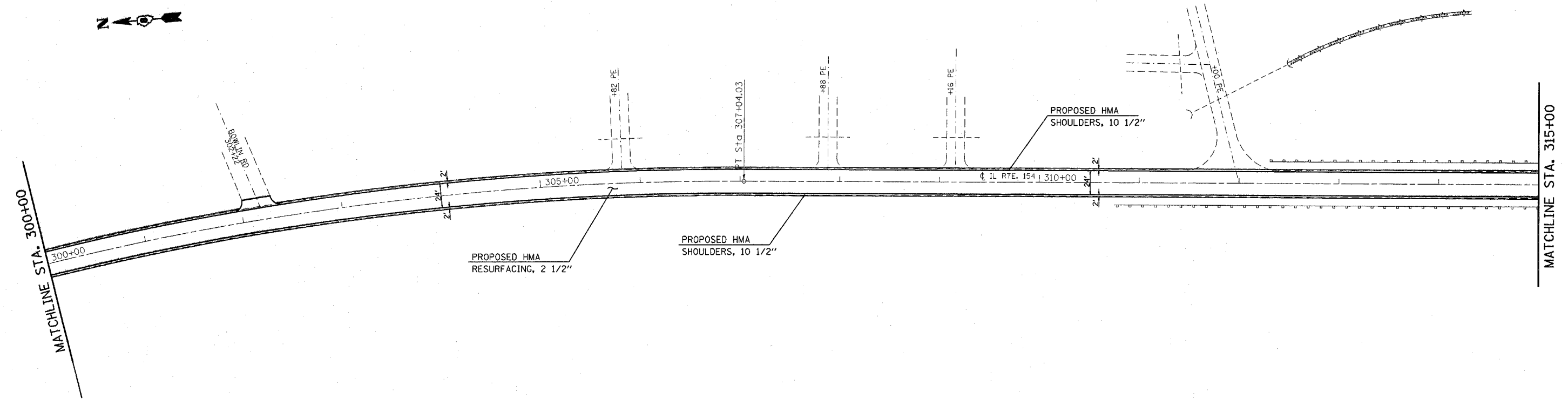
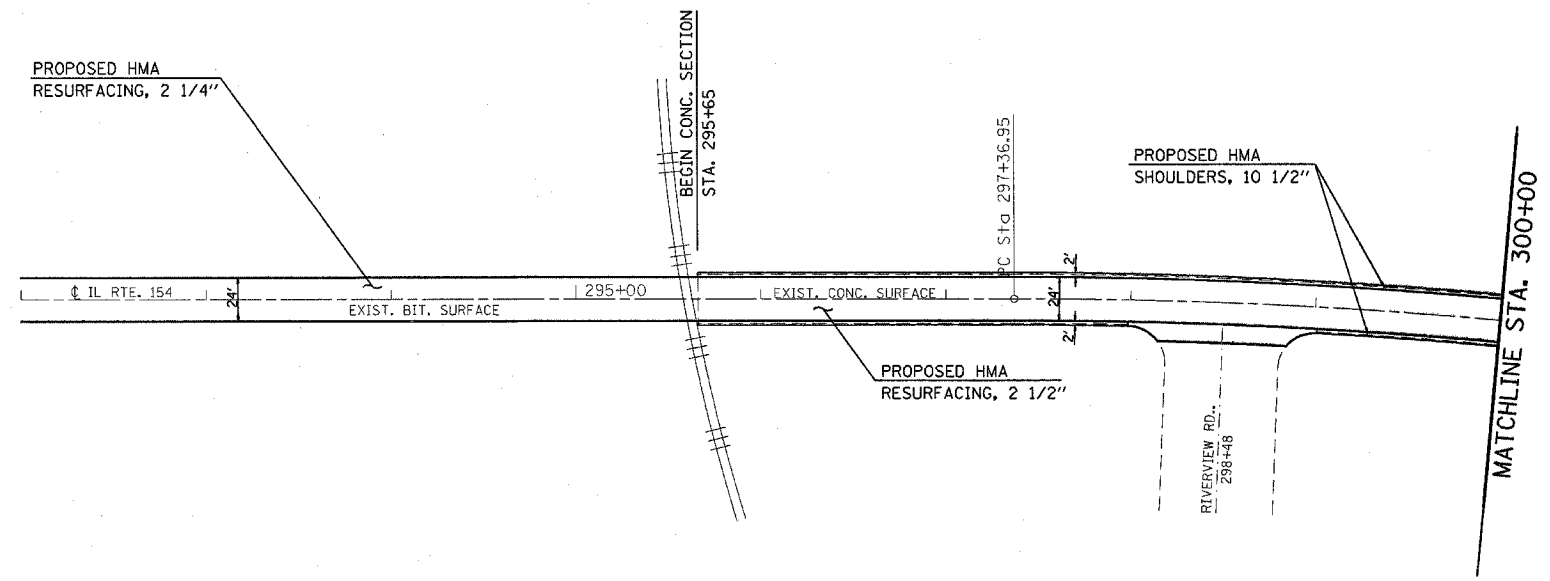

FILE NAME =	USER NAME = dintelmenjn	DESIGNED -	REVISD -
at\projects\ed01608\plan\pin01588a.dgn		DRAWN -	REVISD -
	PLOT SCALE = 50.0000' / IN.	CHECKED -	REVISD -
	PLOT DATE = 3/21/2008	DATE -	REVISD -

**STATE OF ILLINOIS  
DEPARTMENT OF TRANSPORTATION**

**PLAN VIEW**

SCALE: \_\_\_\_\_ SHEET NO. \_\_\_\_ OF \_\_\_\_ SHEETS STA. \_\_\_\_\_ TO STA. \_\_\_\_\_

F.A.P. RTE.	SECTION	COUNTY	TOTAL SHEETS	SHEET NO.
329	(125,126)RS-2	RANDOLPH	34	20
CONTRACT NO. 76B38				
FED. ROAD DIST. NO. ILLINOIS FED. AID PROJECT				

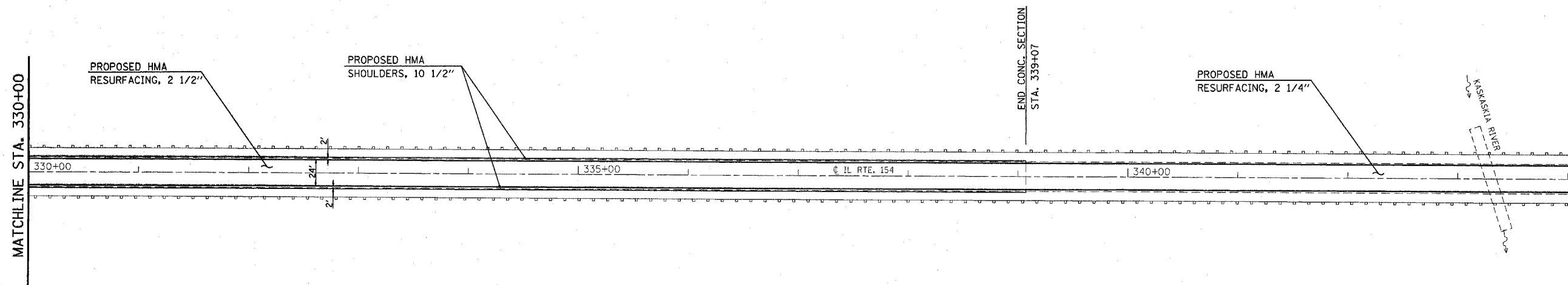
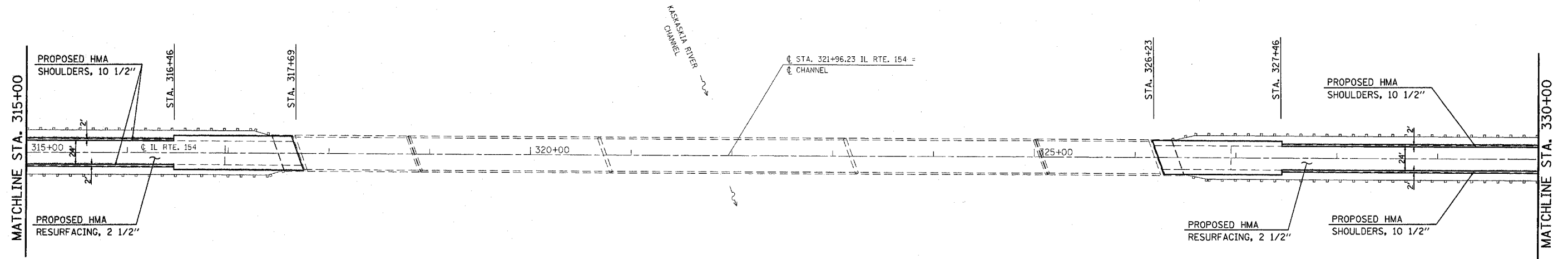

FILE NAME = c:\projects\aed\1588\plan\plan\1588a.dgn	USER NAME = dintelmernj	DESIGNED - ---	REVISED - ---
		DRAWN - ---	REVISED - ---
	PLOT SCALE = 50.0000' / IN.	CHECKED - ---	REVISED - ---
	PLOT DATE = 3/21/2008	DATE - ---	REVISED - ---

**STATE OF ILLINOIS  
DEPARTMENT OF TRANSPORTATION**

**PLAN VIEW**

SCALE: \_\_\_\_\_ SHEET NO. \_\_\_\_ OF \_\_\_\_ SHEETS STA. \_\_\_\_\_ TO STA. \_\_\_\_\_

F.A.P. RTE. 329	SECTION (125,126)RS-2	COUNTY RANDOLPH	TOTAL SHEETS 34	SHEET NO. 21
CONTRACT NO. 76B38				
FED. ROAD DIST. NO. _____ ILLINOIS FED. AID PROJECT				

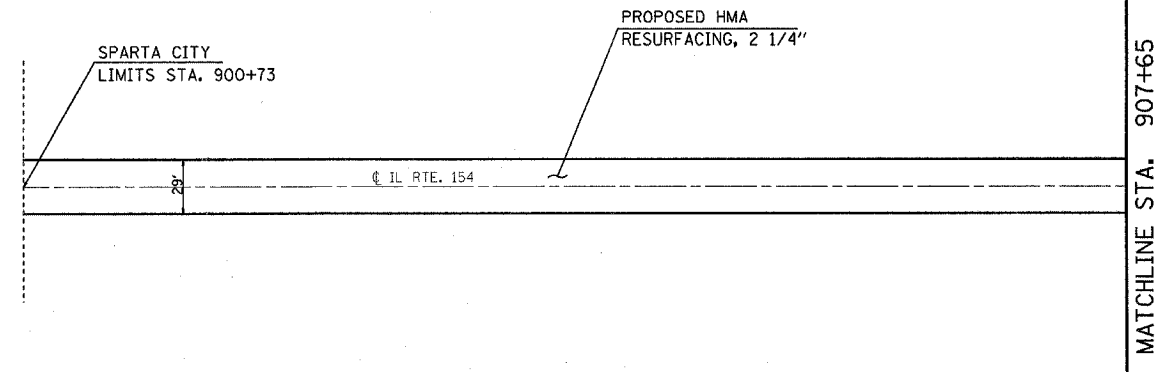

NOT TO SCALE

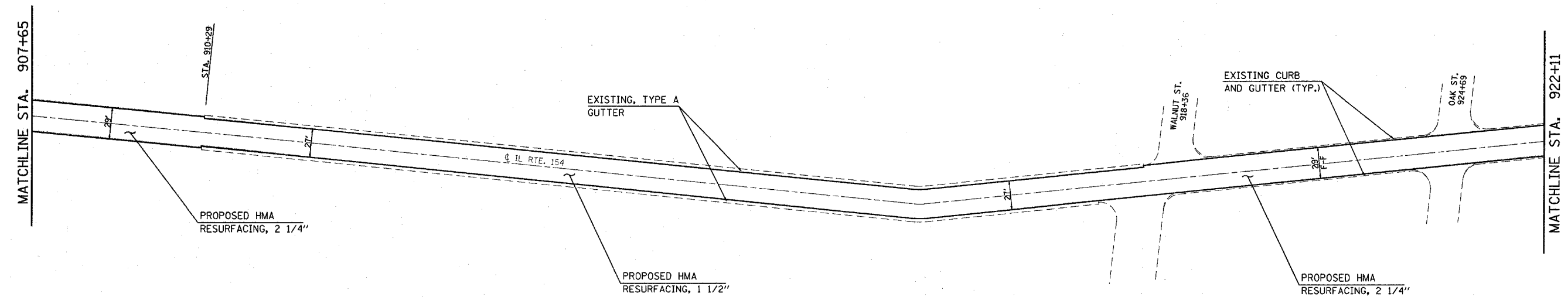

NOT TO SCALE

FILE NAME = c:\projects\ed01588\plan\plan01588a.dgn	USER NAME = dntselmanjn	DESIGNED - ---	REVISED - ---
	PLOT SCALE = 50.0000' / IN.	DRAWN - ---	REVISED - ---
	PLOT DATE = 3/21/2008	CHECKED - ---	REVISED - ---
		DATE - ---	REVISED - ---

**STATE OF ILLINOIS  
DEPARTMENT OF TRANSPORTATION**

**PLAN VIEW (SPARTA)**

SCALE: \_\_\_\_\_ SHEET NO. \_\_\_ OF \_\_\_ SHEETS STA. \_\_\_\_\_ TO STA. \_\_\_\_\_

F.A.P. RTE.	SECTION	COUNTY	TOTAL SHEETS	SHEET NO.
329	(125,126)RS-2	RANDOLPH	34	22
CONTRACT NO. 76B38				
FED. ROAD DIST. NO. _____ ILLINOIS FED. AID PROJECT				

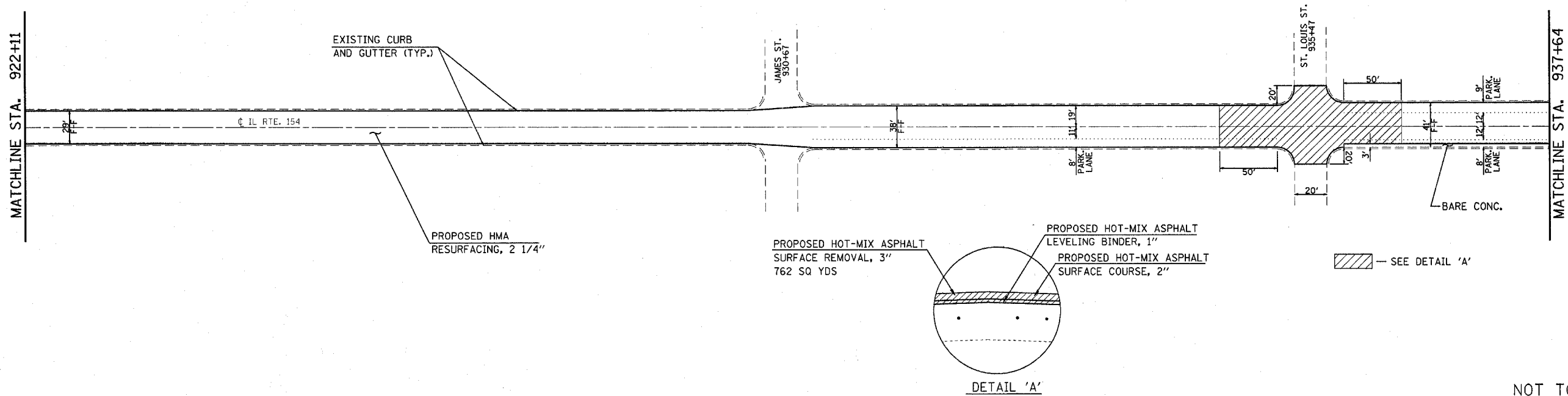

NOT TO SCALE

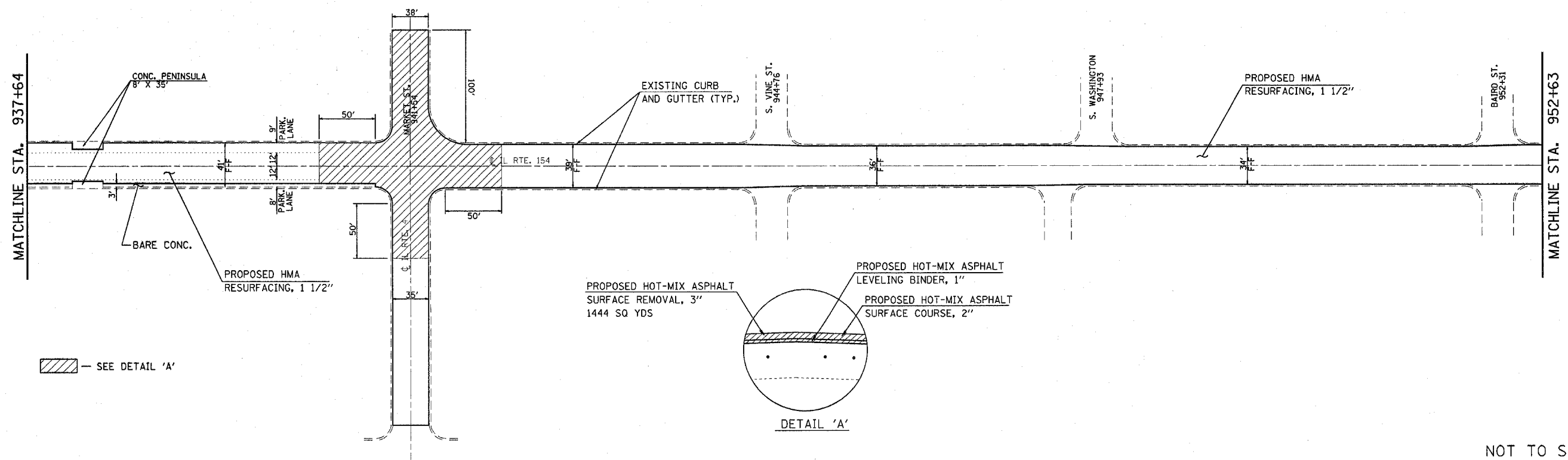

NOT TO SCALE

FILE NAME = c:\projects\ed01508\plan\pin01508a.dgn	USER NAME = duntelman,j	DESIGNED -	REVISED -	<b>STATE OF ILLINOIS DEPARTMENT OF TRANSPORTATION</b>	<b>PLAN VIEW (SPARTA)</b>			F.A.P. RTE. 329	SECTION (125,126)RS-2	COUNTY RANDOLPH	TOTAL SHEETS 34	SHEET NO. 23
	PLOT SCALE = 50,0000' / IN.	DRAWN -	REVISED -		SCALE: _____	SHEET NO. _____ OF _____ SHEETS	STA. _____ TO STA. _____	CONTRACT NO. 76B38				
	PLOT DATE = 3/21/2008	CHECKED -	REVISED -		FED. ROAD DIST. NO. _____ ILLINOIS FED. AID PROJECT							
		DATE -	REVISED -									

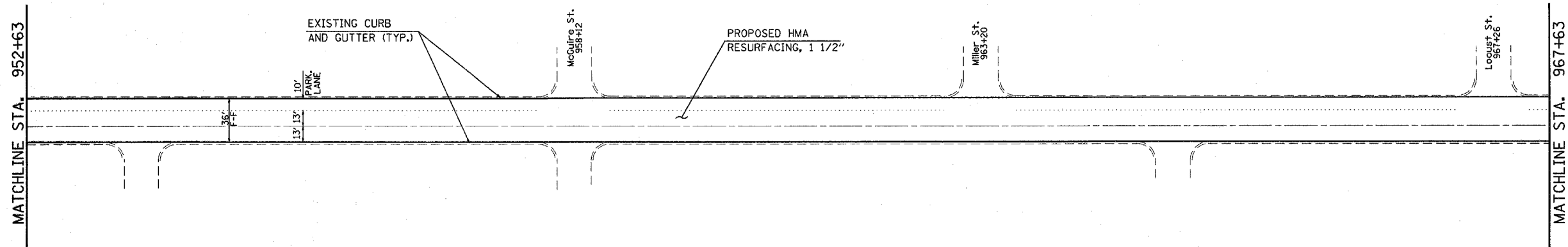

NOT TO SCALE

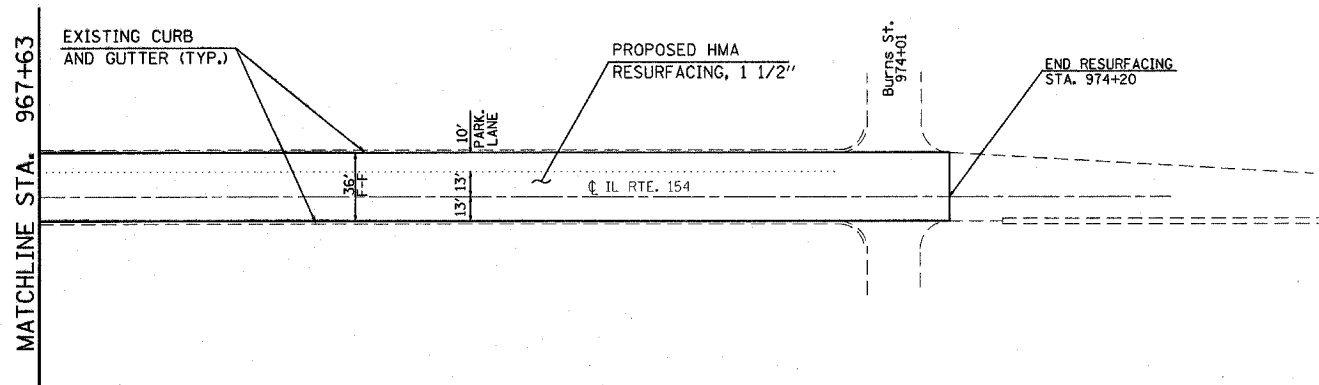

NOT TO SCALE

FILE NAME = c:\projects\ed01508\plan\pin01508a.dgn	USER NAME = dante\manjn	DESIGNED -	REVISED -	<b>STATE OF ILLINOIS DEPARTMENT OF TRANSPORTATION</b>	<b>PLAN VIEW (SPARTA)</b>			F.A.P. RTE.	SECTION	COUNTY	TOTAL SHEETS	SHEE NO.
	PLOT SCALE = 50.0000' / IN.	DRAWN -	REVISED -					329	(125,126)RS-2	RANDOLPH	34	24
	PLOT DATE = 3/21/2009	CHECKED -	REVISED -		SCALE: _____ SHEET NO. _____ OF _____ SHEETS STA. _____ TO STA. _____			CONTRACT NO. 76B3E				
		DATE -	REVISED -		FED. ROAD DIST. NO. _____ ILLINOIS FED. AID PROJECT							



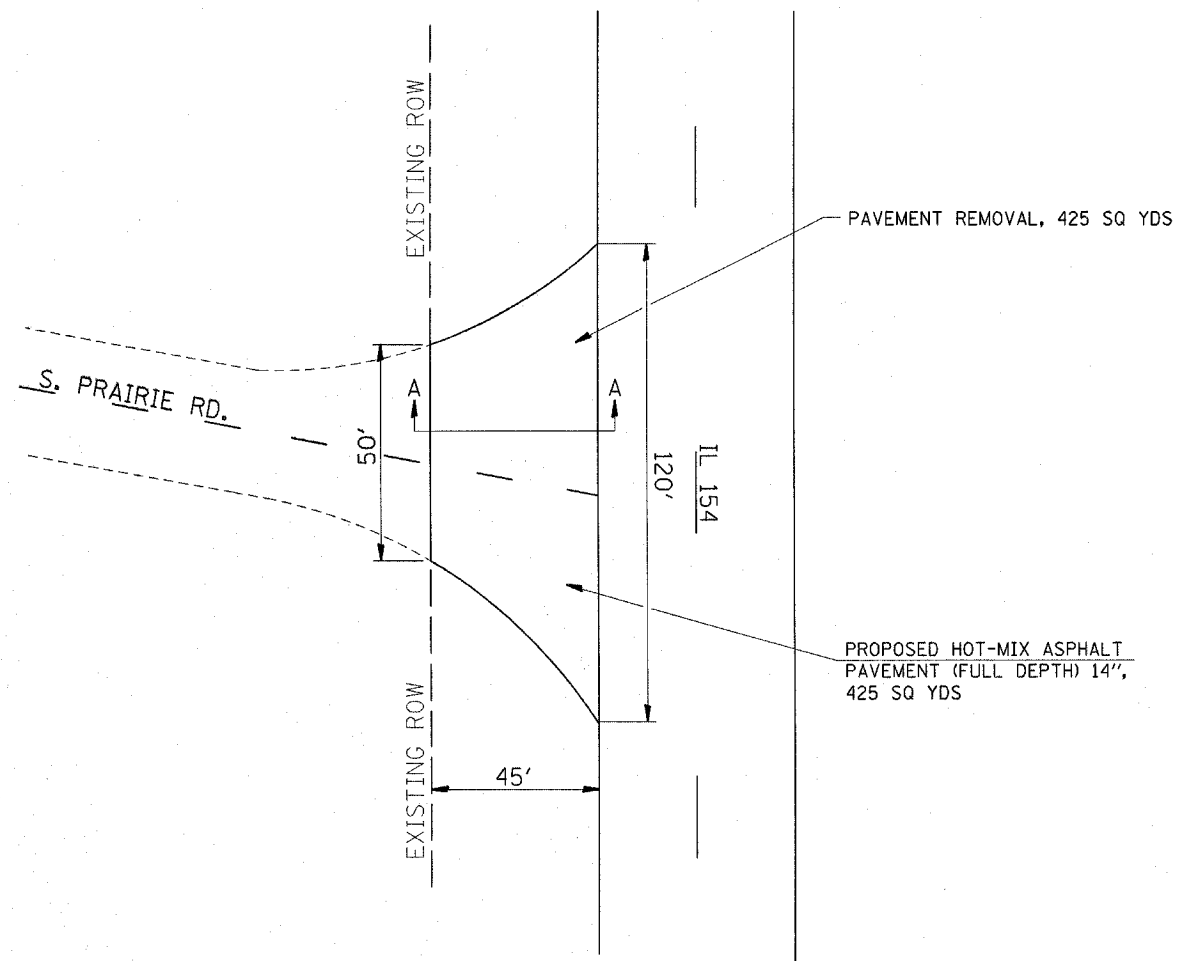

SOUTH PRAIRIE RD

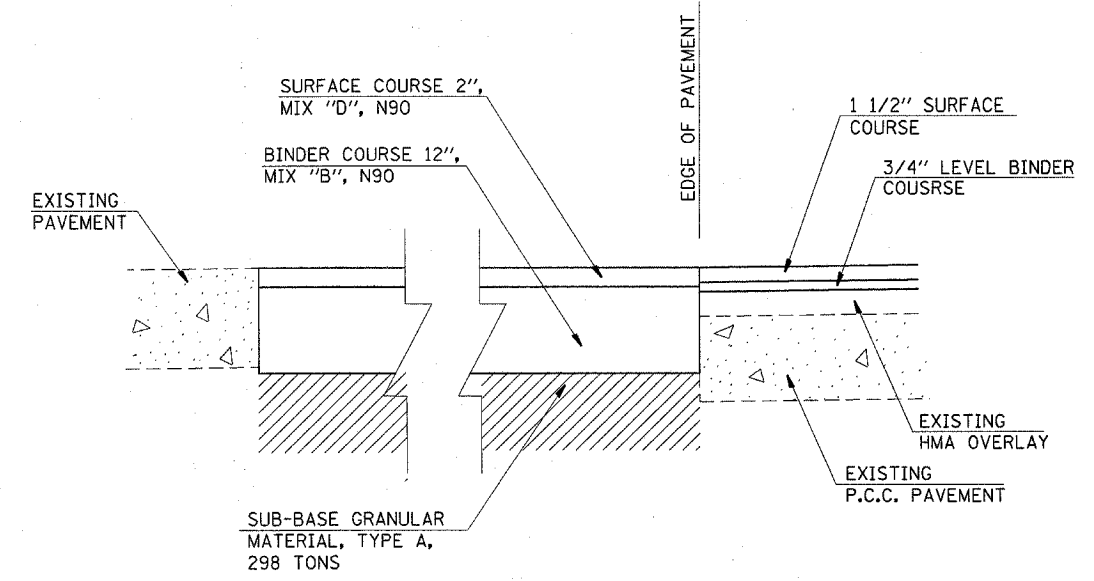

SECTION A-A

NOTE:  
 ACCESS TO S. PRAIRIE RD. SHALL BE MAINTAINED THROUGHOUT CONSTRUCTION  
 ANY SEEDING REQUIRED, DUE TO THE AREA AROUND SOUTH PRAIRIE RD. BEING DISTURBED, WILL BE INCLUDED IN THE PAY ITEM 'HOT-MIX ASPHALT PAVEMENT (FULL DEPTH) 14'''

FILE NAME = c:\projects\ed01500\plan\p1n01500a.dgn	USER NAME = dintelmen,jn	DESIGNED - ---	REVISED - ---
		DRAWN - ---	REVISED - ---
	PLOT SCALE = 50.0000' / IN.	CHECKED - ---	REVISED - ---
	PLOT DATE = 3/21/2008	DATE - ---	REVISED - ---

**STATE OF ILLINOIS  
 DEPARTMENT OF TRANSPORTATION**

**S. PRAIRIE RD. DETAIL SHEET**  
 SCALE: \_\_\_\_\_ SHEET NO. \_\_\_ OF \_\_\_ SHEETS STA. \_\_\_\_\_ TO STA. \_\_\_\_\_

F.A.P. RTE. 329	SECTION (125,126)RS-2	COUNTY RANDOLPH	TOTAL SHEETS 34	SHEET NO. 25
FED. ROAD DIST. NO. _____ ILLINOIS FED. AID PROJECT				

CONTRACT NO. 76B38

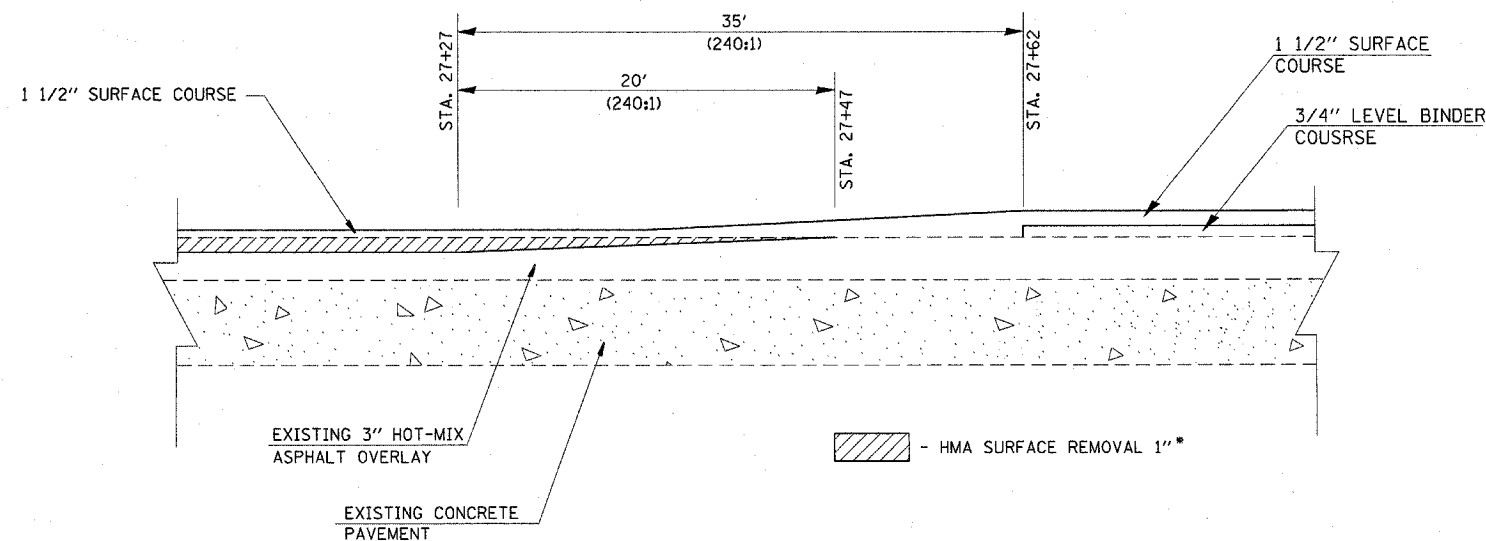
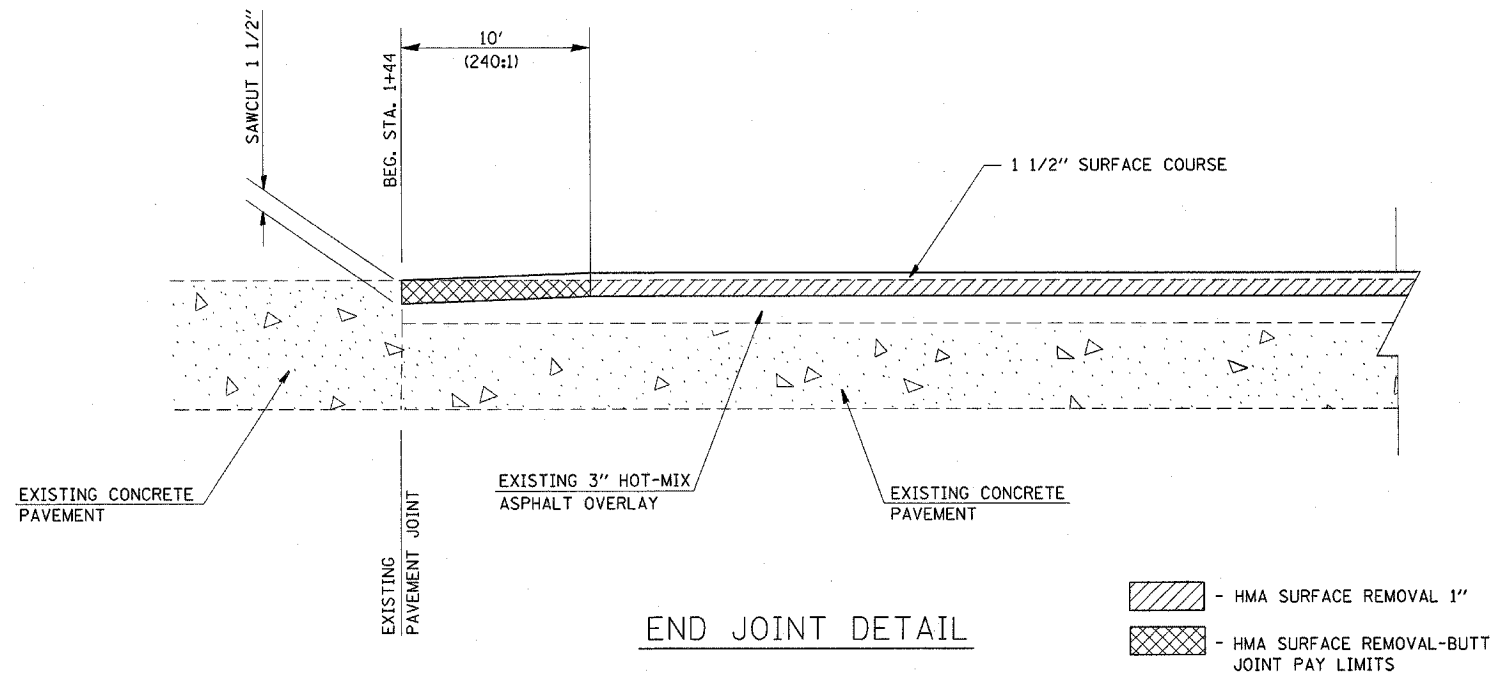
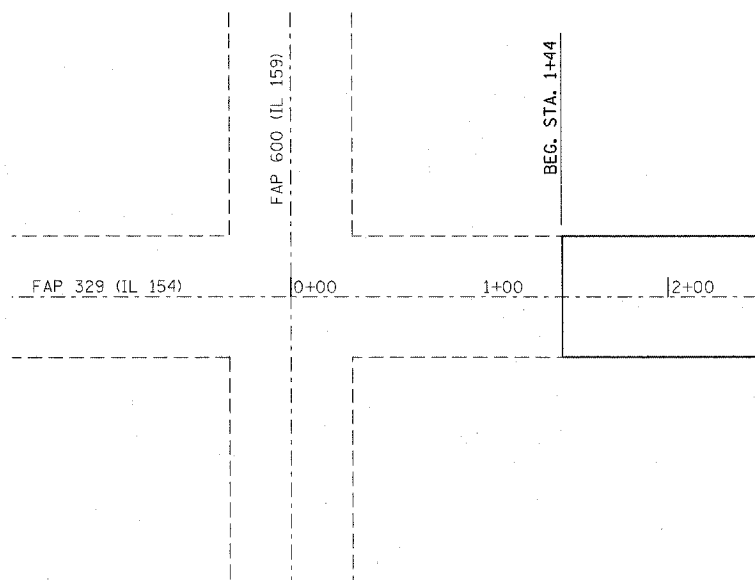

\* THE TRANSITION FROM 1" DEPTH MILLING TO NO MILLING WILL BE INCLUDED IN THE COST OF THE 1" HMA SURFACE REMOVAL PAY ITEM

TRANSITION DETAIL

FILE NAME = c:\projects\ed01508\plan\pin01508a.dgn	USER NAME = dntelmonjn	DESIGNED - ---	REVISED - ---
		DRAWN - ---	REVISED - ---
	PLOT SCALE = 50.0000' / IN.	CHECKED - ---	REVISED - ---
	PLOT DATE = 3/21/2008	DATE - ---	REVISED - ---

**STATE OF ILLINOIS  
DEPARTMENT OF TRANSPORTATION**

**DETAILS**

SCALE: \_\_\_\_\_ SHEET NO. \_\_\_ OF \_\_\_ SHEETS STA. \_\_\_\_\_ TO STA. \_\_\_\_\_

F.A.P. RTE. 329	SECTION (125,126)RS-2	COUNTY RANDOLPH	TOTAL SHEETS 34	SHEET NO. 26
CONTRACT NO. 76B38				
FED. ROAD DIST. NO. _____ ILLINOIS FED. AID PROJECT				

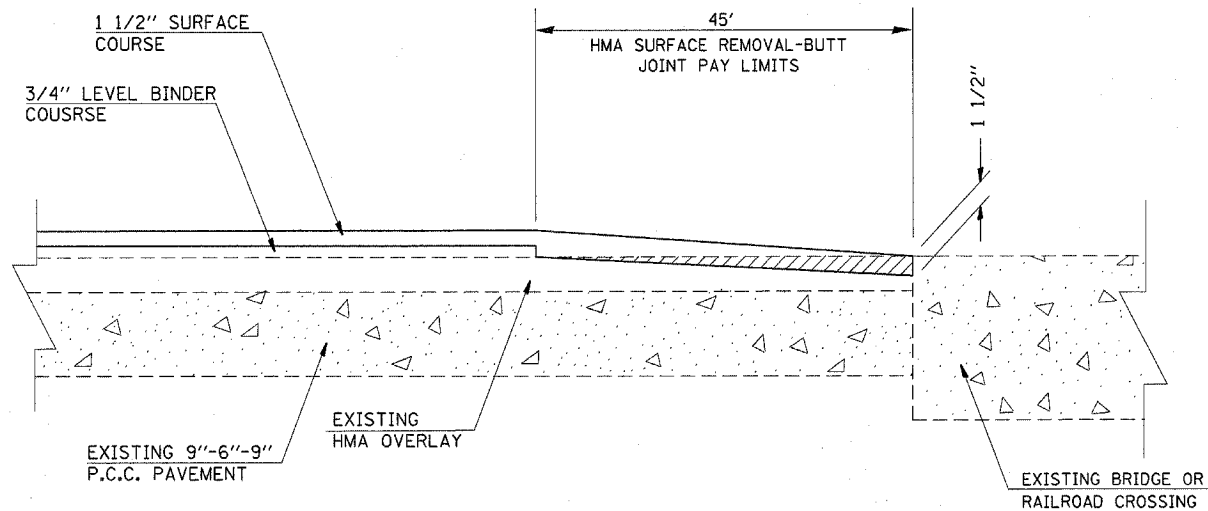

**BUTT-JOINT DETAIL**

S.N. 079-0042  
R&R CROSSING

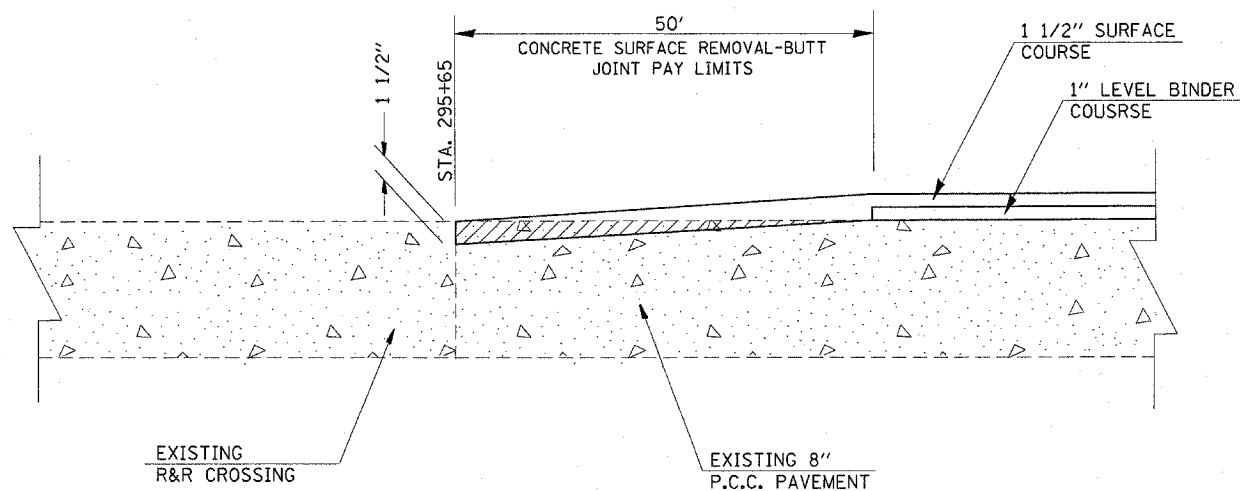

**TRANSITION DETAIL**

BEG. BARE CONC. SECTION

FILE NAME = c:\projects\ed01588\plan\pl-01588a.dgn	USER NAME = dintelmanjn	DESIGNED - ---	REVISED - ---
		DRAWN - ---	REVISED - ---
	PLOT SCALE = 50.0000 ' / IN.	CHECKED - ---	REVISED - ---
	PLOT DATE = 3/21/2009	DATE - ---	REVISED - ---

**STATE OF ILLINOIS  
DEPARTMENT OF TRANSPORTATION**

**DETAILS**

SCALE: \_\_\_\_\_ SHEET NO. \_\_\_ OF \_\_\_ SHEETS STA. \_\_\_\_\_ TO STA. \_\_\_\_\_

F.A.P. RTE. 329	SECTION (125,126)RS-2	COUNTY RANDOLPH	TOTAL SHEETS 34	SHEET NO. 27
FED. ROAD DIST. NO. _____ ILLINOIS FED. AID PROJECT				
CONTRACT NO. 76B38				

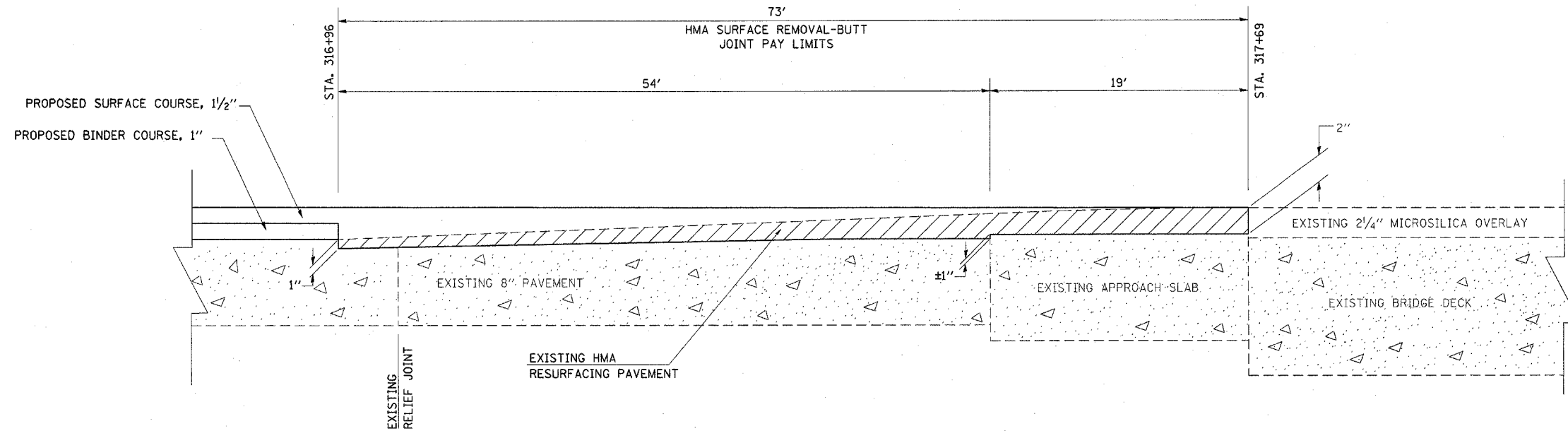

**PROPOSED BUTT JOINT**  
(079-0013)

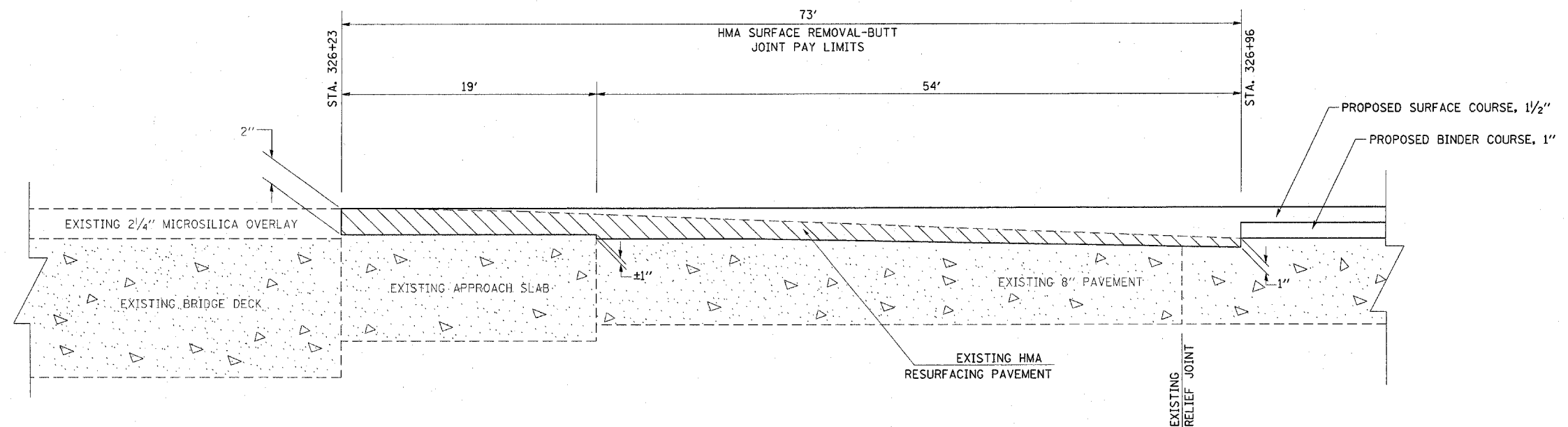

**PROPOSED BUTT JOINT**  
(079-0013)

FILE NAME = c:\projects\ed01500\plan\plan01500a.dgn	USER NAME = dinstelmerjn	DESIGNED - ---	REVISED - ---
		DRAWN - ---	REVISED - ---
		CHECKED - ---	REVISED - ---
		DATE - ---	REVISED - ---

**STATE OF ILLINOIS**  
**DEPARTMENT OF TRANSPORTATION**

<b>DETAILS</b>	
SCALE: _____	SHEET NO. ____ OF ____ SHEETS
STA. _____ TO STA. _____	

F.A.P. RTE. 329	SECTION (125,126)RS-2	COUNTY RANDOLPH	TOTAL SHEETS 34	SHEET NO. 28
CONTRACT NO. 76B3				
FED. ROAD DIST. NO. - ILLINOIS FED. AID PROJECT				

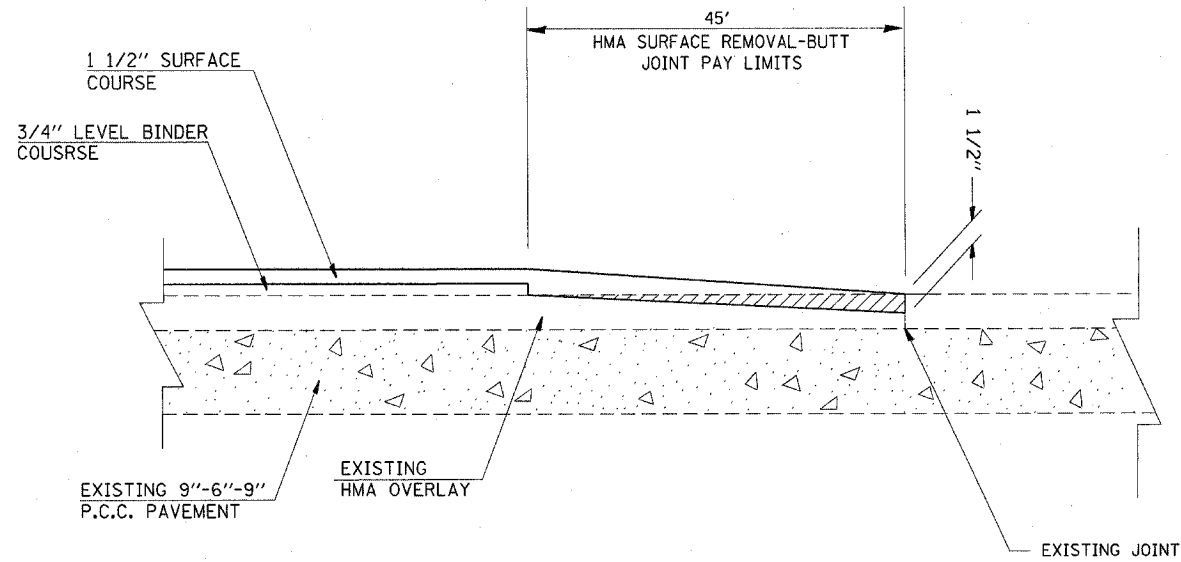

**BRIDGE OMISSION DETAIL**

S.N. 079-0046  
 S.N. 079-0016  
 S.N. 079-0017

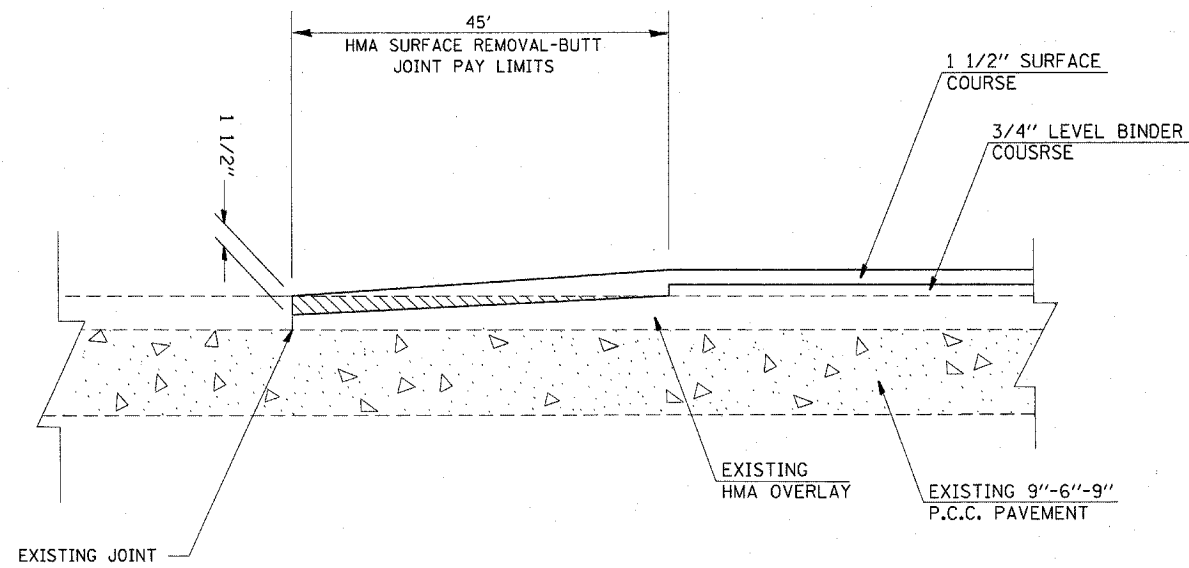

**BRIDGE OMISSION DETAIL**

S.N. 079-0046  
 S.N. 079-0016  
 S.N. 079-0017

FILE NAME =	USER NAME = dintelmanjn	DESIGNED -	REVISD -
ct:\projects\ed01508\plan\pln01508a.dgn		DRAWN -	REVISD -
	PLLOT SCALE = 50.0000' / IN.	CHECKED -	REVISD -
	PLLOT DATE = 3/21/2008	DATE -	REVISD -

**STATE OF ILLINOIS  
 DEPARTMENT OF TRANSPORTATION**

**DETAILS**

SCALE: \_\_\_\_\_ SHEET NO. \_\_\_\_\_ OF \_\_\_\_\_ SHEETS STA. \_\_\_\_\_ TO STA. \_\_\_\_\_

F.A.P. RTE.	SECTION	COUNTY	TOTAL SHEETS	SHEET NO.
329	(125,126)RS-2	RANDOLPH	34	29
CONTRACT NO. 76B38				
FED. ROAD DIST. NO. ILLINOIS FED. AID PROJECT				

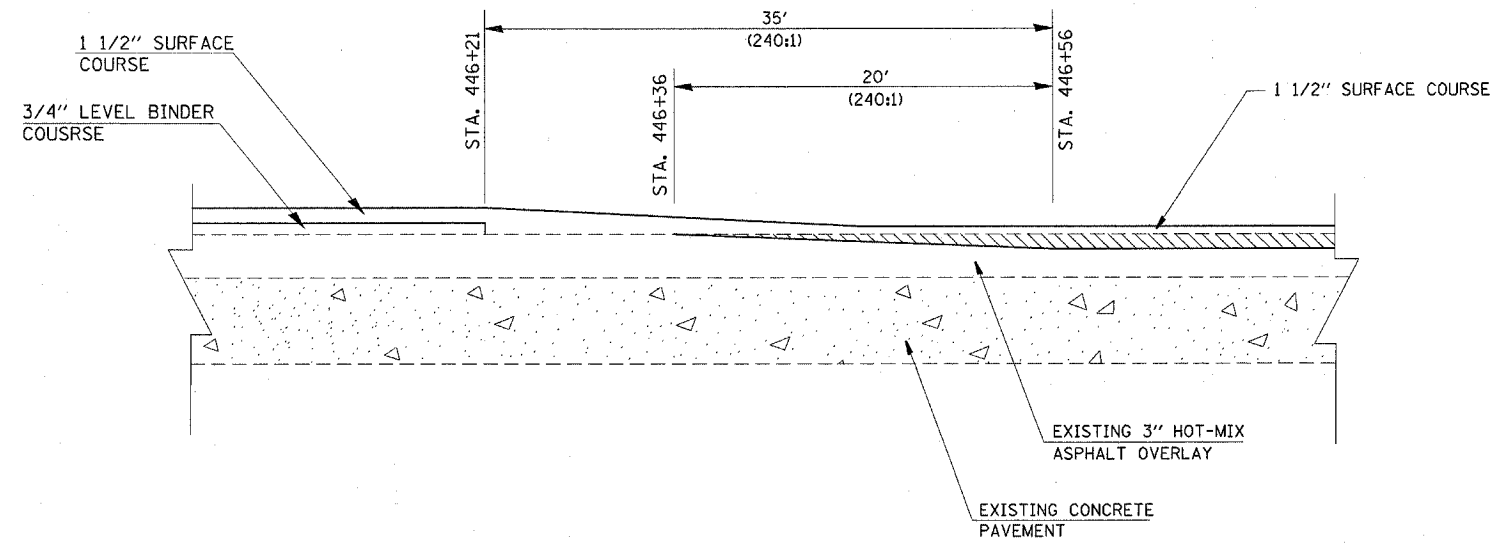

TRANSITION DETAIL  
(BALDWIN)

\* THE TRANSITION FROM 1" DEPTH MILLING TO NO MILLING WILL BE INCLUDED IN THE COST OF THE 1" HMA SURFACE REMOVAL PAY ITEM

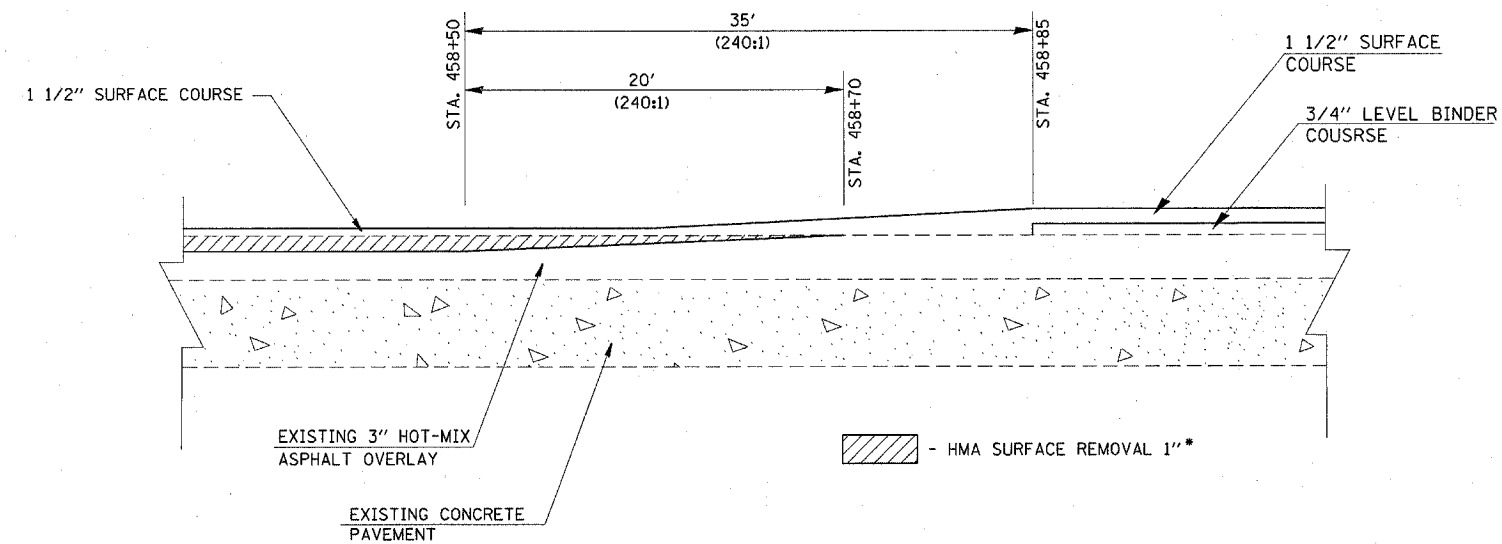

TRANSITION DETAIL  
(BALDWIN)

\* THE TRANSITION FROM 1" DEPTH MILLING TO NO MILLING WILL BE INCLUDED IN THE COST OF THE 1" HMA SURFACE REMOVAL PAY ITEM

FILE NAME = c:\projects\ed01508\plan\pl-01508a.dgn	USER NAME = dntolmanjn	DESIGNED - ---	REVISED - ---
		DRAWN - ---	REVISED - ---
	PLOT SCALE = 50.0000' / IN.	CHECKED - ---	REVISED - ---
	PLOT DATE = 3/21/2008	DATE - ---	REVISED - ---

**STATE OF ILLINOIS  
DEPARTMENT OF TRANSPORTATION**

**MILLING DETAILS (BALDWIN)**

SCALE: \_\_\_\_\_ SHEET NO. \_\_\_ OF \_\_\_ SHEETS STA. \_\_\_\_\_ TO STA. \_\_\_\_\_

F.A.P. RTE. 329	SECTION (125,126)RS-2	COUNTY RANDOLPH	TOTAL SHEETS 34	SHEET NO. 30
FED. ROAD DIST. NO. - ILLINOIS FED. AID PROJECT				
CONTRACT NO. 76B3				

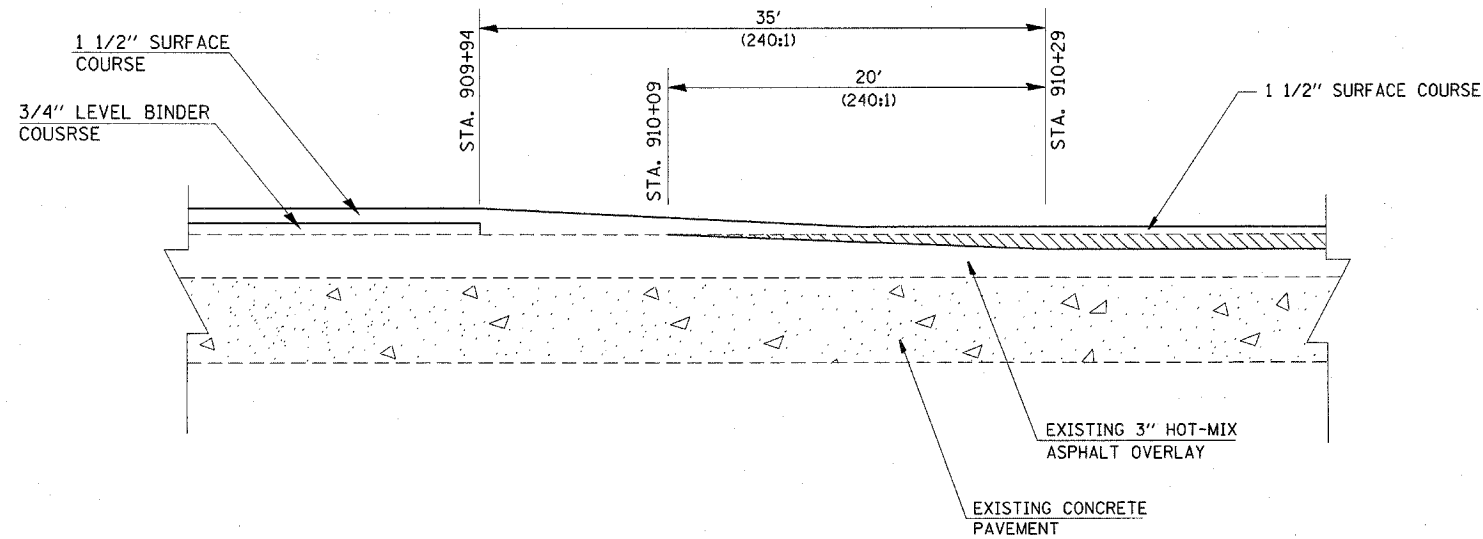

TRANSITION DETAIL

\* THE TRANSITION FROM 1" DEPTH MILLING TO NO MILLING WILL BE INCLUDED IN THE COST OF THE 1" HMA SURFACE REMOVAL PAY ITEM

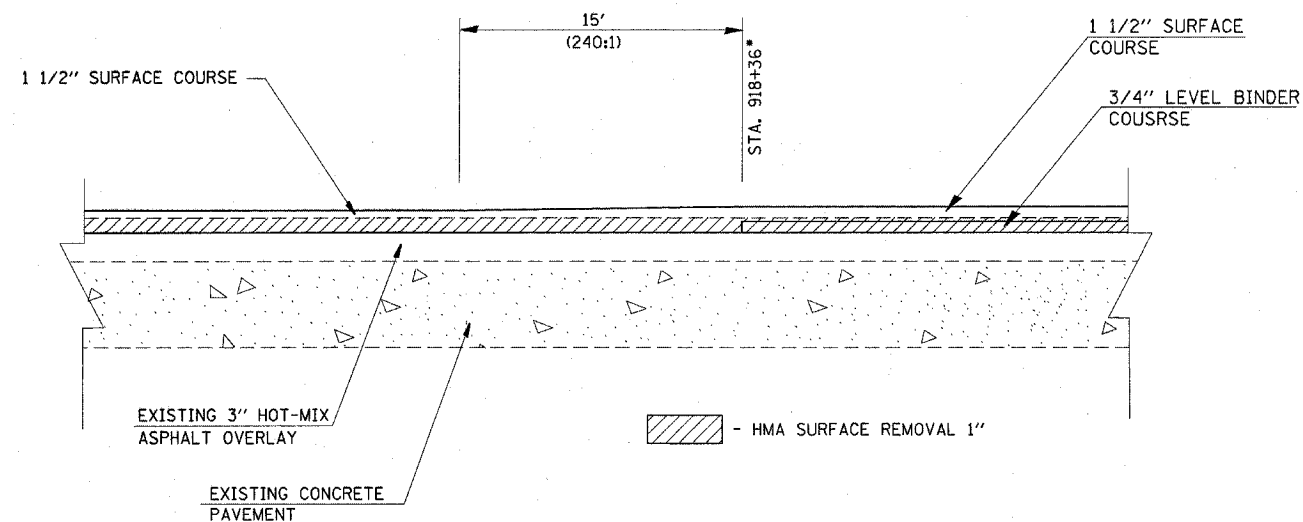

TRANSITION DETAIL

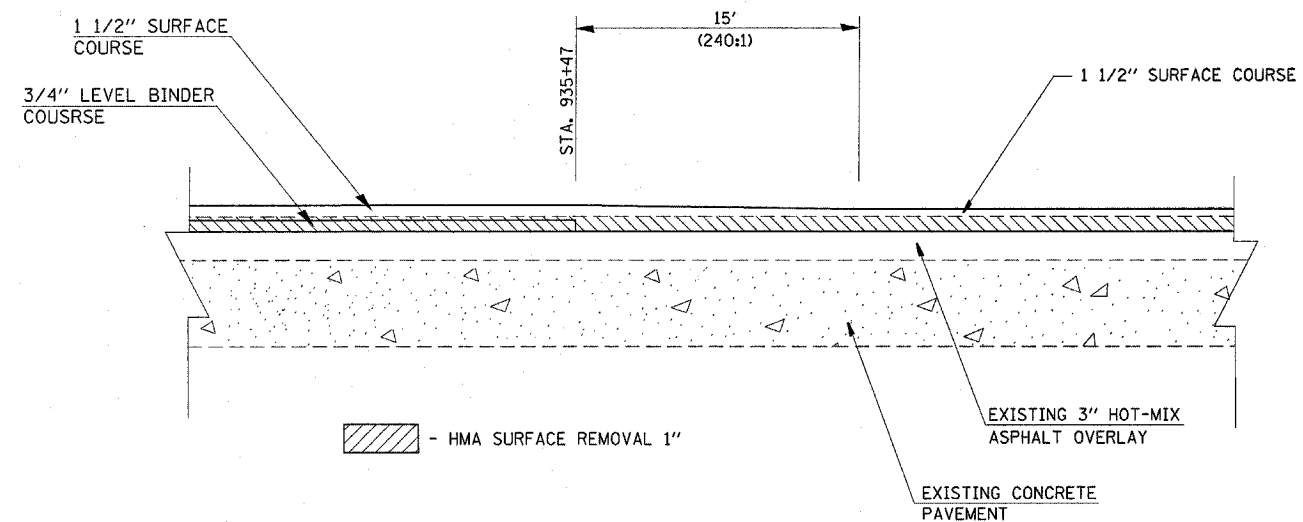

TRANSITION DETAIL

FILE NAME =	USER NAME = dintelmenjp	DESIGNED -	REVISED -
c:\projects\ed01508\plan\pln01508a.dgn		DRAWN -	REVISED -
	PLOT SCALE = 50.0000' / IN.	CHECKED -	REVISED -
	PLOT DATE = 3/21/2008	DATE -	REVISED -

STATE OF ILLINOIS  
DEPARTMENT OF TRANSPORTATION

MILLING DETAILS (SPARTA)

SCALE: \_\_\_\_\_ SHEET NO. \_\_\_\_\_ OF \_\_\_\_\_ SHEETS STA. \_\_\_\_\_ TO STA. \_\_\_\_\_

F.A.P. RTE.	SECTION	COUNTY	TOTAL SHEETS	SHEET NO.
329	(125,126)RS-2	RANDOLPH	34	31
CONTRACT NO. 76B38				
FED. ROAD DIST. NO. - ILLINOIS FED. AID PROJECT				

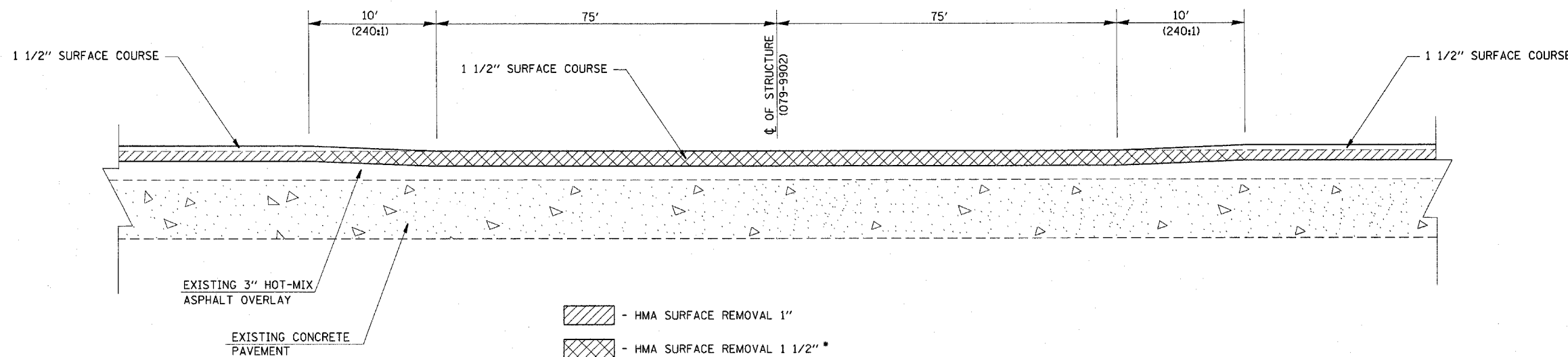

**DETAIL**  
(MILLING UNDER SN 079-9902)

\* THE TRANSITION FROM 1" DEPTH MILLING TO 1 1/2" MILLING WILL BE INCLUDED IN THE COST OF THE 1 1/2" HMA SURFACE REMOVAL PAY ITEM

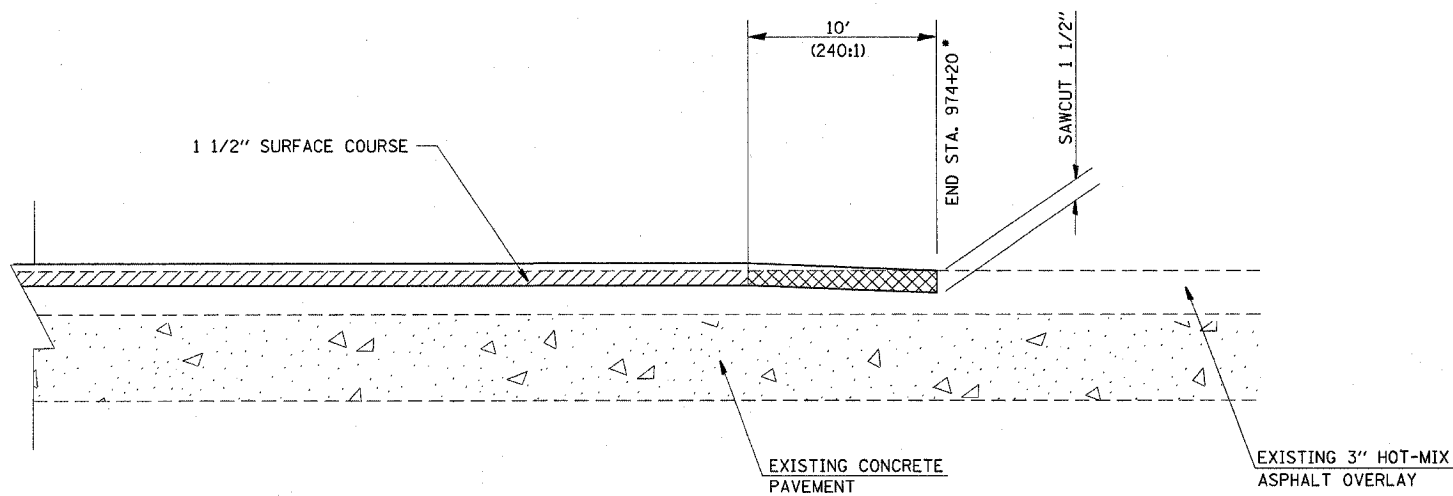
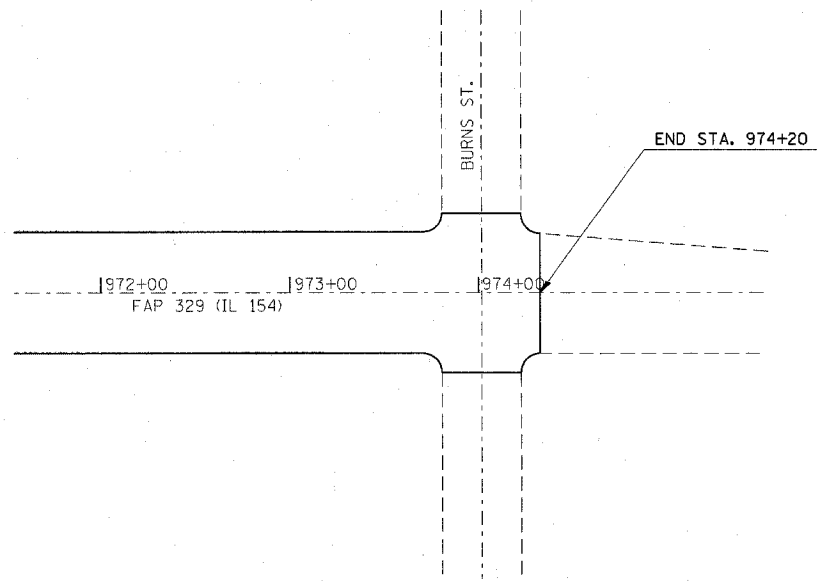

**END JOINT DETAIL**

\* (TO BE USED AT SOUTH END OF IL 4 ALSO)

- HMA SURFACE REMOVAL 1"
- HMA SURFACE REMOVAL-BUTT JOINT PAY LIMITS

FILE NAME = ot\projects\ed01508\plan\pln01508a.dgn	USER NAME = dntolmanjn	DESIGNED - ---	REVISED - ---	<b>STATE OF ILLINOIS DEPARTMENT OF TRANSPORTATION</b>	<b>MILLING DETAILS (SPARTA)</b>			F.A.P. RTE. 329	SECTION (125,126)RS-2	COUNTY RANDOLPH	TOTAL SHEETS 34	SHEET NO. 32
PLOT SCALE = 50.0000' / IN.	CHECKED - ---	REVISED - ---	REVISED - ---		SCALE: -----	SHEET NO. ___ OF ___ SHEETS	STA. ----- TO STA. -----	FED. ROAD DIST. NO. - ILLINOIS FED. AID PROJECT				
PLOT DATE = 3/21/2009	DATE - -----	REVISED - ---	REVISED - ---		CONTRACT NO. 76B38							



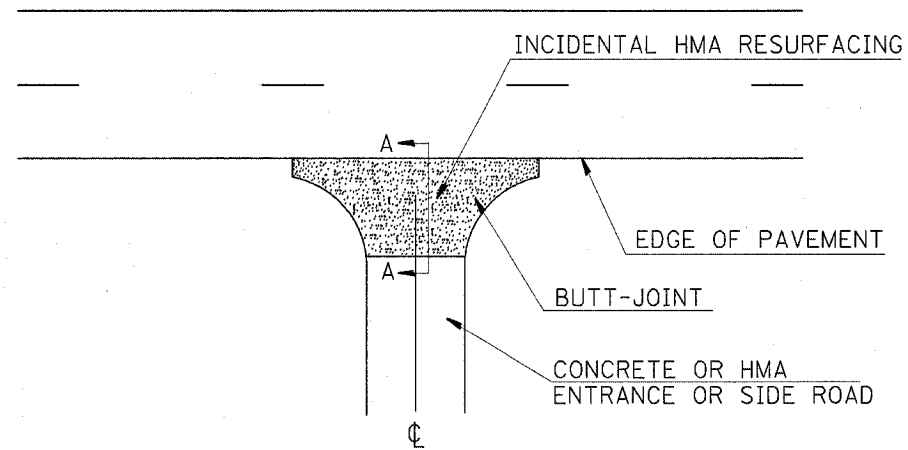

SIDE ROAD &  
ENTRANCE DETAIL

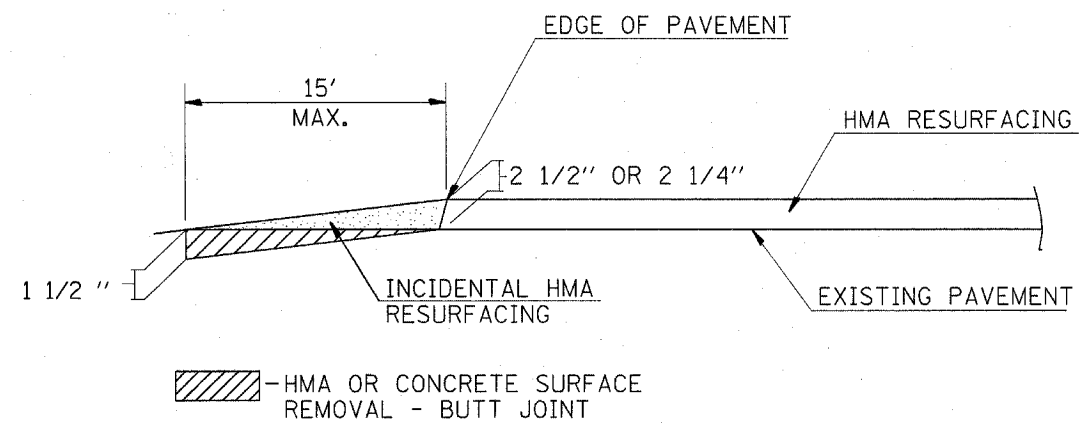

SIDE ROAD &  
ENTRANCE DETAIL  
(SECTION A-A)

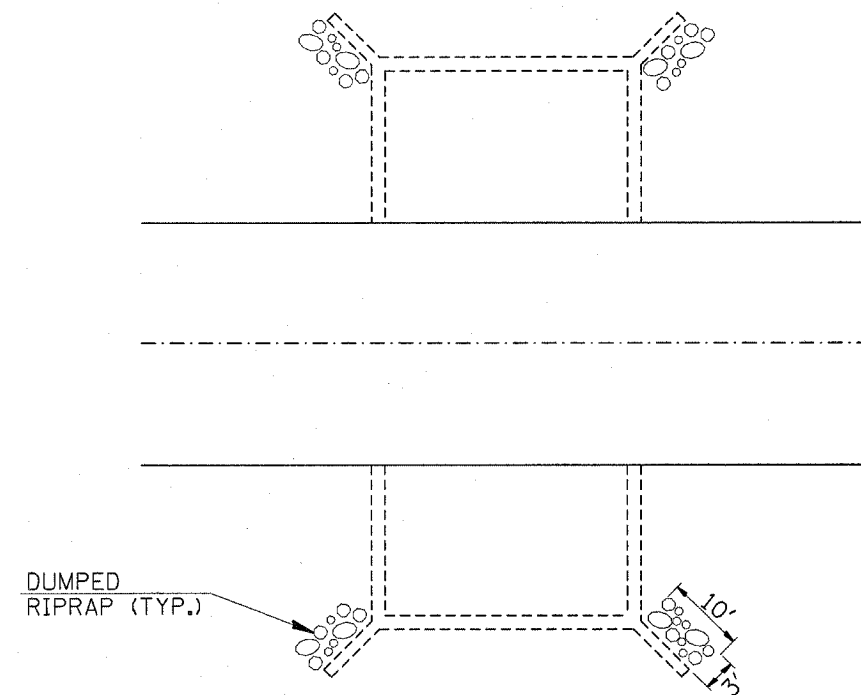

RIPRAP DETAIL  
(079-2460)  
(079-2463)

FILE NAME = c:\projects\ed01500\plan\pin01508a.dgn	USER NAME = dntalmanjn	DESIGNED - ---	REVISED - ---
	PLOT SCALE = 50.0000' / IN.	DRAWN - ---	REVISED - ---
	PLOT DATE = 3/21/2008	CHECKED - ---	REVISED - ---
		DATE - ---	REVISED - ---

STATE OF ILLINOIS  
DEPARTMENT OF TRANSPORTATION

SCALE: _____		SHEET NO. ___ OF ___ SHEETS		STA. _____ TO STA. _____	
--------------	--	-----------------------------	--	--------------------------	--

F.A.P. RTE.	SECTION	COUNTY	TOTAL SHEETS	SHEET NO.
329	(125,126)RS-2	RANDOLPH	34	33
FED. ROAD DIST. NO. - ILLINOIS FED. AID PROJECT			CONTRACT NO. 76B38	

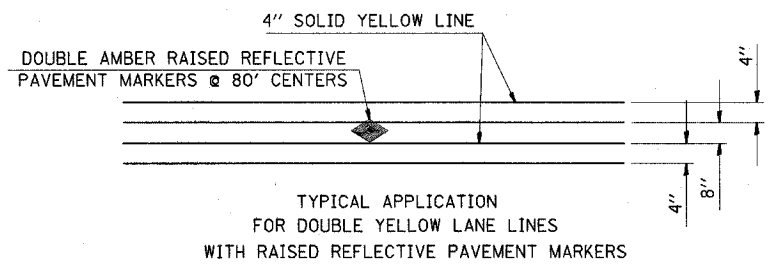

**DETAIL 'B'**

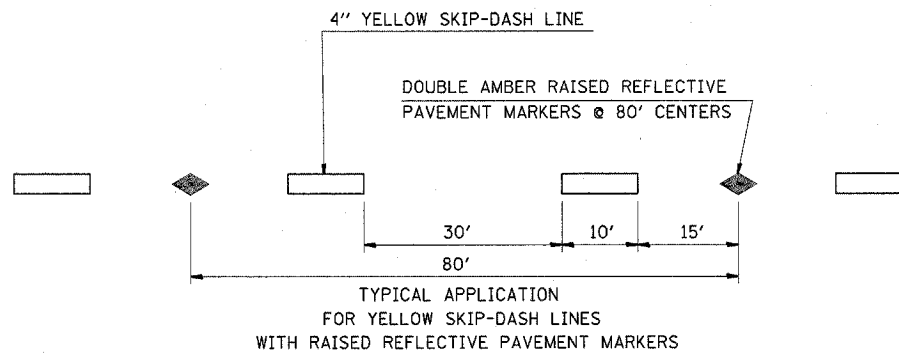

**DETAIL 'C'**

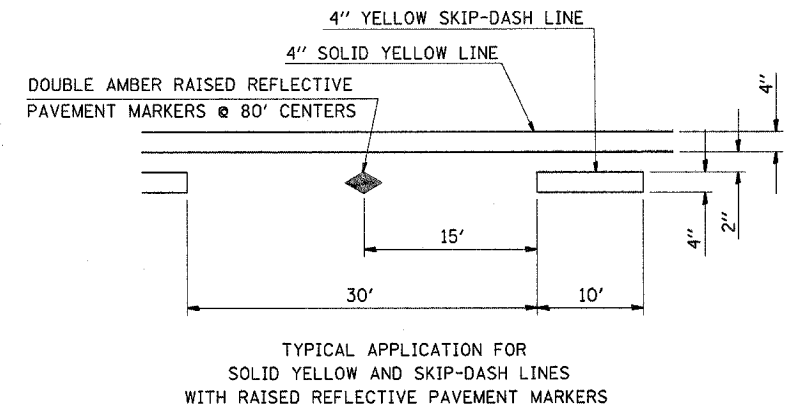

**DETAIL 'D'**

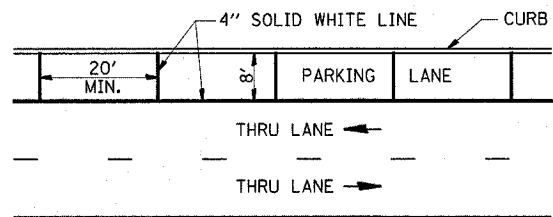

**TYPICAL PARKING LANE MARKINGS**

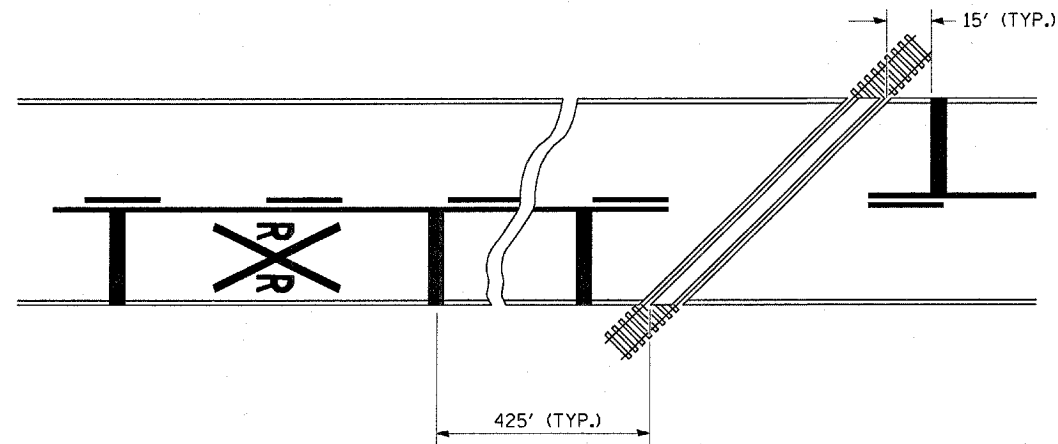

FILE NAME =	USER NAME = dntelmenjn	DESIGNED -	REVISED -
cr\projects\ed01508\plan\pin01508a.dgn		DRAWN -	REVISED -
	PLOT SCALE = 50.0000' / IN.	CHECKED -	REVISED -
	PLOT DATE = 3/21/2008	DATE -	REVISED -

**STATE OF ILLINOIS  
DEPARTMENT OF TRANSPORTATION**

**PAVEMENT MARKING  
DETAILS**

SCALE: \_\_\_\_\_ SHEET NO. \_\_\_\_ OF \_\_\_\_ SHEETS STA. \_\_\_\_\_ TO STA. \_\_\_\_\_

F.A.P. RTE.	SECTION	COUNTY	TOTAL SHEETS	SHEET NO.
329	(125,126)RS-2	RANDOLPH	34	34
CONTRACT NO. 76B38				
FED. ROAD DIST. NO. ILLINOIS FED. AID PROJECT				