

STATE OF ILLINOIS  
DEPARTMENT OF TRANSPORTATION

ROUTE NO.	SECTION	COUNTY	DISTRICT	SHEET NO.	SHEET TOTAL
FAS 899	8BR-1	SALINE	75	16	13 SHEETS

78028

BENCHMARK: Chiseled square on southwest wingwall of SN 083-0035, Sta. 663+98, 17' Rt., Elev. 403.46.

EXISTING STRUCTURE: SN 083-0035 was originally built as S.B.I. 13, Section 8B-1 Sta. 664+15 in 1942. The superstructure originally consisted of a reinforced concrete slab, 31.8' out to out, on 34.8' back to back reinforced concrete closed abutments on timber piles. In 1980, the superstructure was replaced utilizing 17" PPC deck beams. The out-to-out width is 33'-0". The existing superstructure shall be removed and replaced utilizing stage construction.

No salvage

STATION 664+15.00  
REBUILT 20\_\_ BY  
STATE OF ILLINOIS  
F.A.S. RT. 899 SEC. 8BR-1  
LOADING HS20  
STR. NO. 083-0035

**NAME PLATE**

Note: See Std. 515001  
Existing Name Plate shall be cleaned and relocated adjacent to the new plate. Cost included with Name Plates.

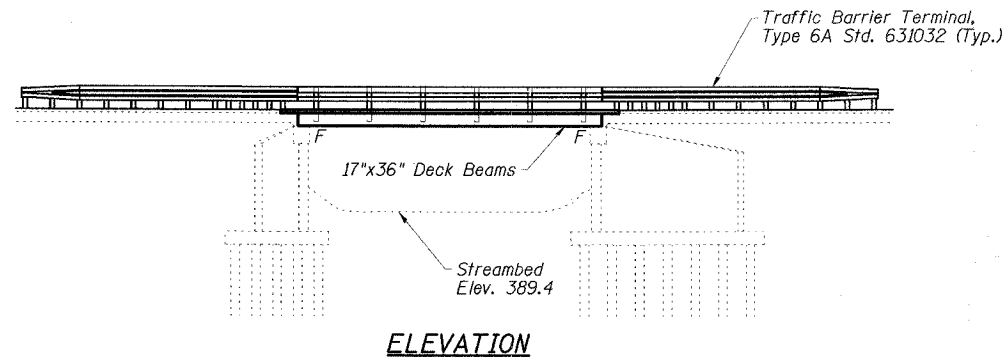

**STRUCTURE INDEX OF SHEETS**

General Plan	Dwg. No. 1 of 13
General Data	Dwg. No. 2 of 13
Stage Construction Details	Dwg. No. 3 of 13
Temporary Concrete Barrier	Dwg. No. 4 of 13
Superstructure	Dwg. No. 5 of 13
Superstructure Details	Dwg. No. 6-8 of 13
Steel Railing, Type SM	Dwg. No. 9 of 13
West Abutment	Dwg. No. 10 of 13
East Abutment	Dwg. No. 11 of 13
Abutment Details	Dwg. No. 12 of 13
Bar Splicer Assembly Details	Dwg. No. 13 of 13

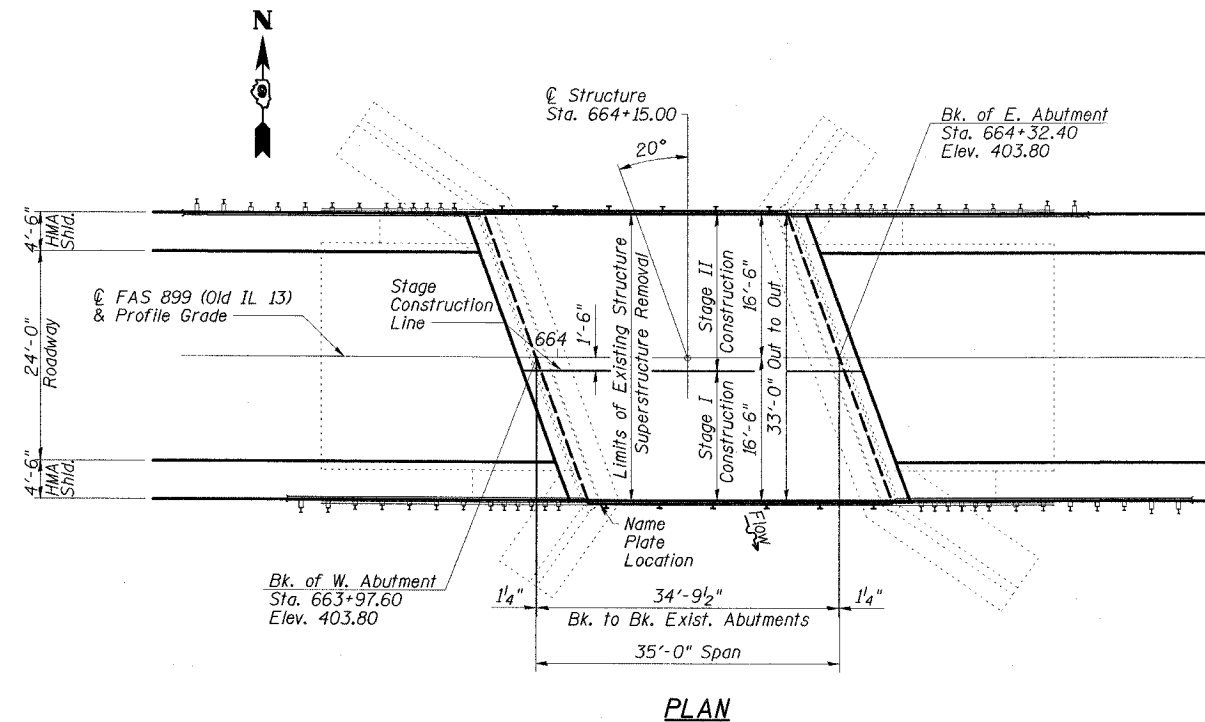

PROFILE GRADE  
(Along © Roadway)

**ESCA**  
CONSULTANTS, INC.

DESIGNED BY:	JMS	09/07
DRAWN BY:	CJ/HAS	09/07
CHECKED BY:	DAJ/ELH	02/08
APPROVED BY:	RDP	02/08

APPROVED  
FOR STRUCTURAL ADEQUACY ONLY

Ralph C. Anderson  
ENGINEER OF BRIDGES AND STRUCTURES



EXPIRES 11-30-08  
SIGNATURE  
02/29/08  
DATE

**DESIGN SPECIFICATION**

2002 AASHTO  
LOADING HS20-44  
No allowance for future wearing surface

**DESIGN STRESSES**

**FIELD UNITS**  
f'c = 5,000 psi (Concrete Wearing Surface)  
f'c = 3,500 psi (All concrete except CWS)  
fy = 60,000 psi (reinf.)

**PRECAST PRESTRESSED UNITS**

f'c = 6,000 psi  
f'ci = 5,000 psi  
f's = 270,000 psi (1/2" low lax strands)  
f'si = 201,960 psi (1/2" low lax strands)

**SCOPE OF WORK**

1. Remove existing surfacing, steel railing, and deck beams.
2. Repair beam bearing seats and perform other repairs at abutments as required.
3. Reconstruct a one-span PPC Deck Beam superstructure with Concrete Wearing Surface and Steel Railing, Type SM.

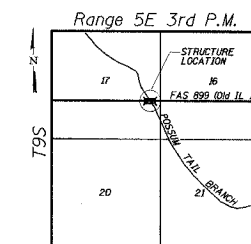

LOCATION SKETCH

GENERAL PLAN  
OLD IL 13 OVER POSSUM TAIL BRANCH  
FAS ROUTE 899 - SECTION 8BR-1  
SALINE COUNTY  
STATION 664+15.00  
STRUCTURE NO. 083-0035