

LEGEND

	- PROPOSED STONE RIPRAP DITCH
	- PROPOSED STONE RIPRAP CLASS A3
	- PROPOSED SEEDING

NOTE: SEE SHEET 18 FOR DETAILS OF STONE RIPRAP DITCH, STONE RIPRAP CLASS A3, AND SEEDING

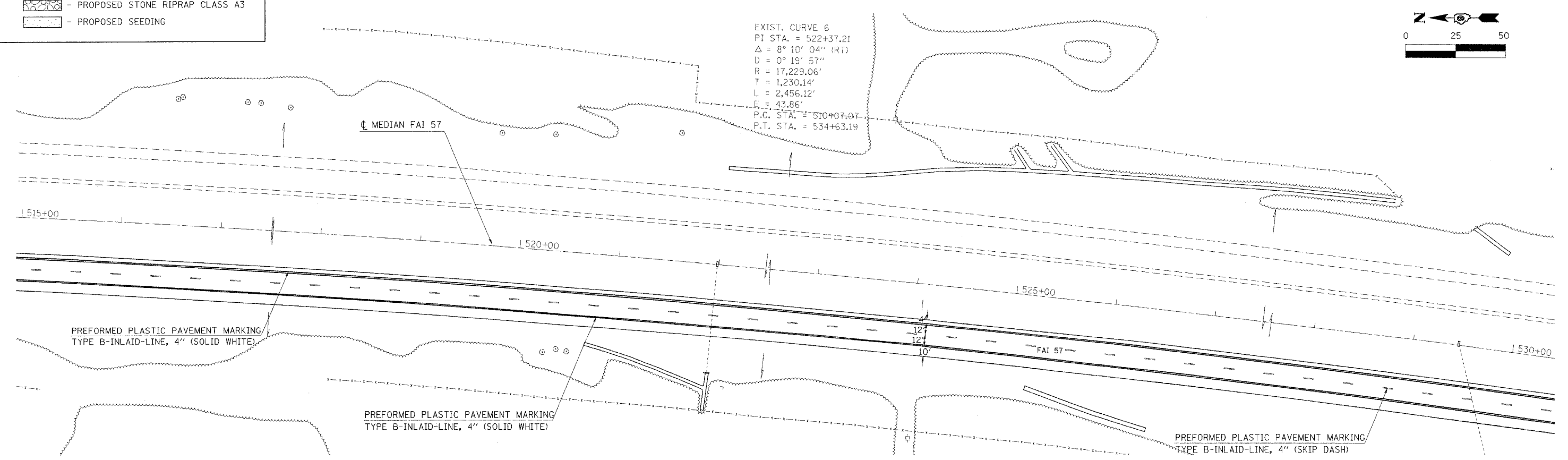
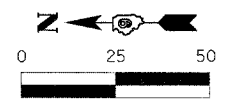

EXIST. CURVE 6
 PI STA. = 522+37.21
 $\Delta = 8^{\circ} 10' 04''$ (RT)
 $D = 0^{\circ} 19' 57''$
 $R = 17,229.06'$
 $T = 1,230.14'$
 $L = 2,456.12'$
 $E = 43.86'$
 P.C. STA. = 510+07.07
 P.T. STA. = 534+63.19

FILE NAME = c:\p\proj\78051\78051-misc.dgn	USER NAME = oar\stonej	DESIGNED -	REVISED -	STATE OF ILLINOIS DEPARTMENT OF TRANSPORTATION	PLAN SHEET	F.A.I. RTE. 57	SECTION 77-(2,3)RS	COUNTY PULASKI	TOTAL SHEETS 19	SHEET NO. 9	
PLOT SCALE = 50.0000' / IN.	DATE = 3/18/2008	DRAWN -	REVISED -			SCALE: SHEET NO. OF SHEETS STA. 500+00 TO STA. 530+00		CONTRACT NO. 78051			
		CHECKED -	REVISED -			ILLINOIS FED. AID PROJECT					
		DATE -	REVISED -								