

F.A.U. RTE.	SECTION	COUNTY	TOTAL SHEETS	SHEET NO.
369	00-00018-00-PV	COOK	20	18
STA. 24+50.00		TO STA. 28+00.00		
FED. ROAD DIST. NO. 1 ILLINOIS FED. AID PROJECT				

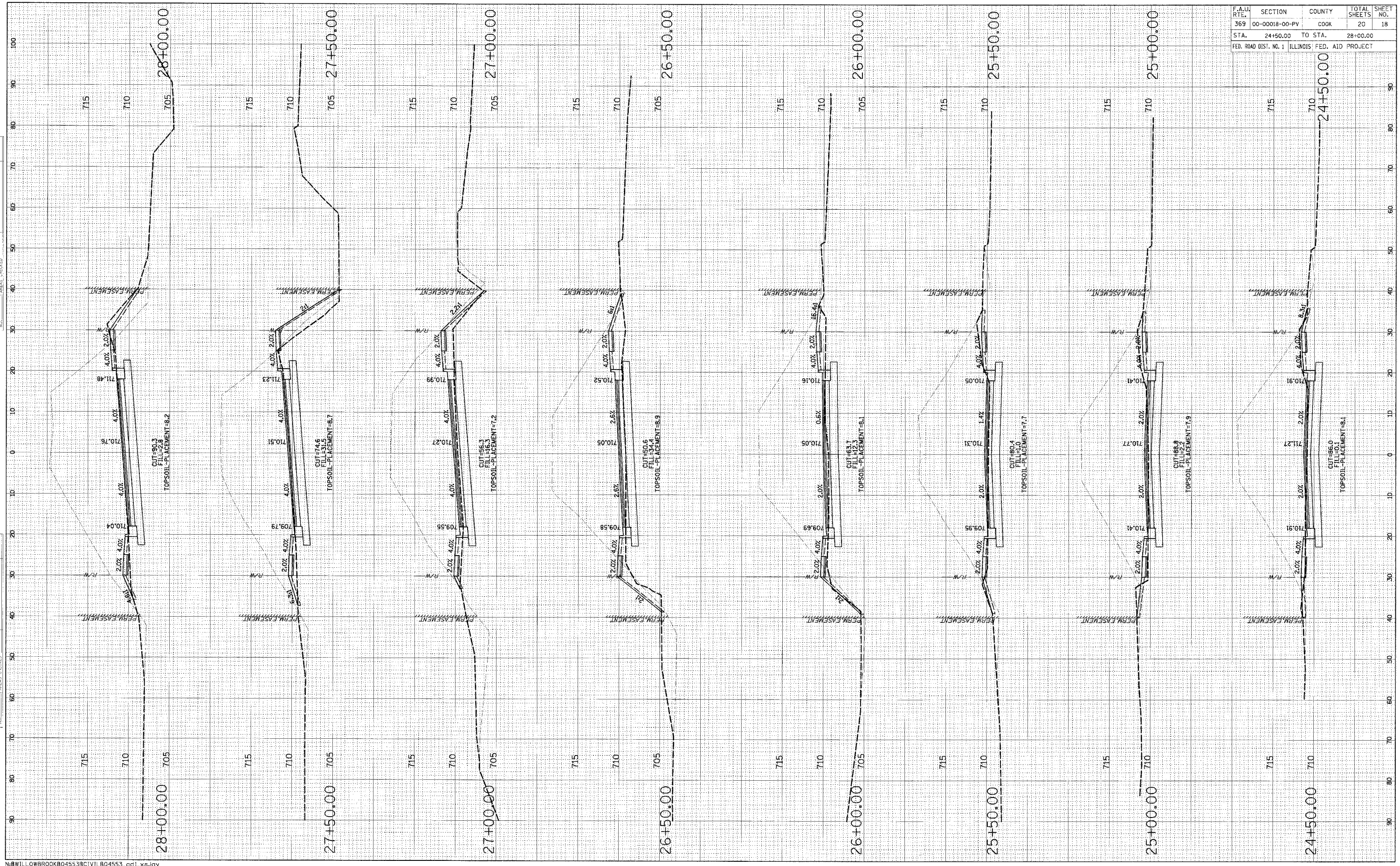

FINAL SURVEY PLOTTED NOTE BOOK AREAS CHECKED

ORIGINAL SURVEY PLOTTED NOTE BOOK AREAS CHECKED