

**STATE OF ILLINOIS
DEPARTMENT OF TRANSPORTATION
PLANS FOR PROPOSED
LOCAL AGENCY IMPROVEMENT
FEDERAL-AID HBP PROJECT
HIGHWAY BRIDGE PROGRAM
TR 61A
SECTION 06-15118-01-BR/ OGLE COUNTY
SECTION 06-02121-01-BR/ WINNEBAGO COUNTY
PROJECT BHOS-141(64)
JOB NO. C-92-062-07
CONTRACT NO. 85416
2008**

INDEX OF SHEETS

- 1 = COVER SHEET
- 2 = PLAN AND PROFILE
- 3 = GENERAL PLAN AND ELEVATION
- 4 = CAP REPAIR DETAILS FOR PIERS 1,2, & 3
- 5 = BACKWALL REPAIR DETAILS FOR ABUTMENTS

SUMMARY OF QUANTITIES

PAY CODE	QUANTITY	UNIT	ITEM
*20200100	5	Cu. Yd.	Earth Excavation
*20700220	3	Cu. Yd.	Porous Granular Embankment
*28100109	156	Sq. Yd.	Stone Riprap, Class A5
40800050	21	Ton	Incidental Hot-Mix Asphalt Surfacing
*44000900	66	Sq. Yd.	Bituminous Concrete Removal
50102400	1.1	Cu. Yd.	Concrete Removal
*50300225	10.0	Cu. Yd.	Concrete Structures
50500405	3,375	Pound	Furnishing and Erecting Structural Steel
50800205	1.190	Pound	Reinforcement Bars, Epoxy Coated
51500100	1	Each	Name Plates
58100200	66	Sq. Yd.	Waterproofing Membrane System
67100100	1	L. Sum	Mobilization
*70101700	1	L. Sum	Traffic Control and Protection
*X0325305	2.8	Sq. Ft.	Structural Repair of Concrete (Depth Equal to or Less Than 5 inches)
*Z0032400	3	Each	Joint Repair

* See Special Provisions

STANDARDS

- 000001-05 STANDARD SYMBOLS, ABBREVIATIONS AND PATTERNS
- 515001-02 NAME PLATE FOR BRIDGES
- 701901 TRAFFIC CONTROL DEVICES
- 720011 METAL POSTS FOR SIGNS, MARKERS & DELINEATORS
- 728001 TELESCOPING STEEL SIGN SUPPORT
- 729001 APPLICATIONS OF TYPES A & B METAL POSTS (FOR SIGNS & MARKERS)
- BLR-21-7 TYPICAL APPLICATION OF TRAFFIC CONTROL DEVICES FOR CONSTRUCTION ON RURAL LOCAL HIGHWAYS
- BLR-22-5 TYPICAL APPLICATION OF TRAFFIC CONTROL DEVICES FOR CONSTRUCTION ON RURAL LOCAL HIGHWAYS

NET LENGTH 219.58 FT. = 0.042 MILES

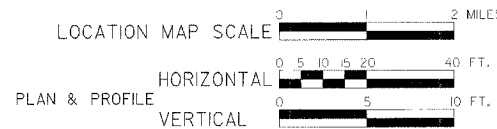

PAVEMENT MIXTURE REQUIREMENTS

LOCATION:	EDSON RD STA 39+90.21 - 42+09.79
MIXTURE USE:	SURFACE
PG:	PG 64-22
DESIGN AIR VCIDS	4%
MIXTURE COMPOSITION (GRADATION MIXTURE)	1L 12.5 - 1L 9.5
FRICTION AGGREGATE	D

Bituminous Materials (Prime Coat) not required.

NAME AND ADDRESS OF UTILITIES	TYPE
NICOR GAS Attn: Scott Puffer 300 West Terra Cotta Crystal Lake, IL 60014 (815) 455-0271	GAS
COMED Attn: Dave Schacht 123 Energy Avenue Rockford, IL 61109 (815) 490-3261	ELECTRIC
VERIZON NORTH, INC. Attn: Garrett Burt 112 West Elm Street Sycamore, IL 60178 (815) 855-1538	TELEPHONE

STRUCTURE REHABILITATION (S.N. 071-3304)
REHABILITATION ONLY.
REPAIR JOINTS, WATERPROOFING MEMBRANE SYSTEM OVER PIERS & AT ABUTMENTS, WIDEN PIER CAPS & ADD POST-TENSIONING RODS, PLACE STONE RIPRAP, CLASS A5 AROUND PIERS.

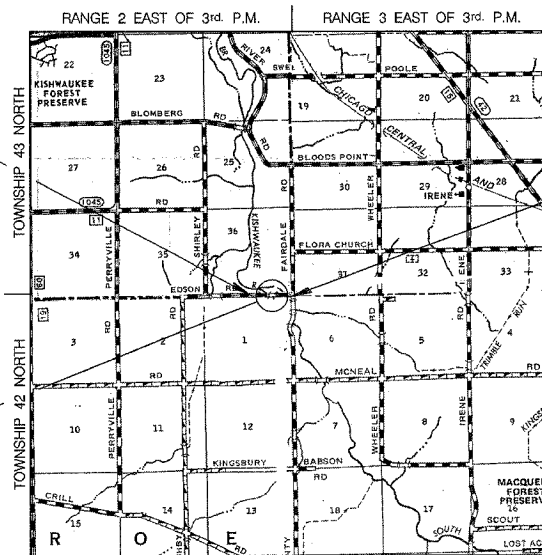

LOCATION MAP

AGENCY RESPONSIBLE FOR LETTING	
APPROVED	<i>[Signature]</i> 2008 OGLE COUNTY, COUNTY ENGINEER
APPROVED	<i>[Signature]</i> 2008 WINNEBAGO COUNTY, COUNTY ENGINEER
PASSED	<i>[Signature]</i> 2008 DISTRICT 2 ENGINEER OF LOCAL ROADS & STREETS
RELEASING FOR BID BASED ON LIMITED REVIEW	<i>[Signature]</i> 2008 DEPUTY DIRECTOR OF HIGHWAYS, REGION 2 ENGINEER



Plans Prepared By:
Brian K. Converse
DATE: 3/11/2008
EXPIRES 11/30/09

Plans Prepared By:
**WILLETT,
HOFMANN &
ASSOCIATES, INC.**
CONSULTING ENGINEERS
Land Surveying - Transportation - Structural
Environmental - Architecture
800 East Second Street Dixon, Illinois 61021
Phone 815-294-3391 Fax 815-294-5355
Design Firm #184-000918
www.willett-hofmann.com

WHA # 1092D06

HIGHWAY CLASSIFICATION: LOCAL ROAD (NON-URBAN)
DESIGN SPEED: 30 MPH
ADT = 125
3R GUIDELINES

