

F.A. RTE.	SECTION	COUNTY	TOTAL SHEETS	SHEET NO.
05-00174-00-B1	ROCK ISLAND	ILLINOIS	112	24
STA.	TO STA.			
FED. ROAD DIST. NO.	ILLINOIS FED. AID PROJECT			

STAGING PLAN

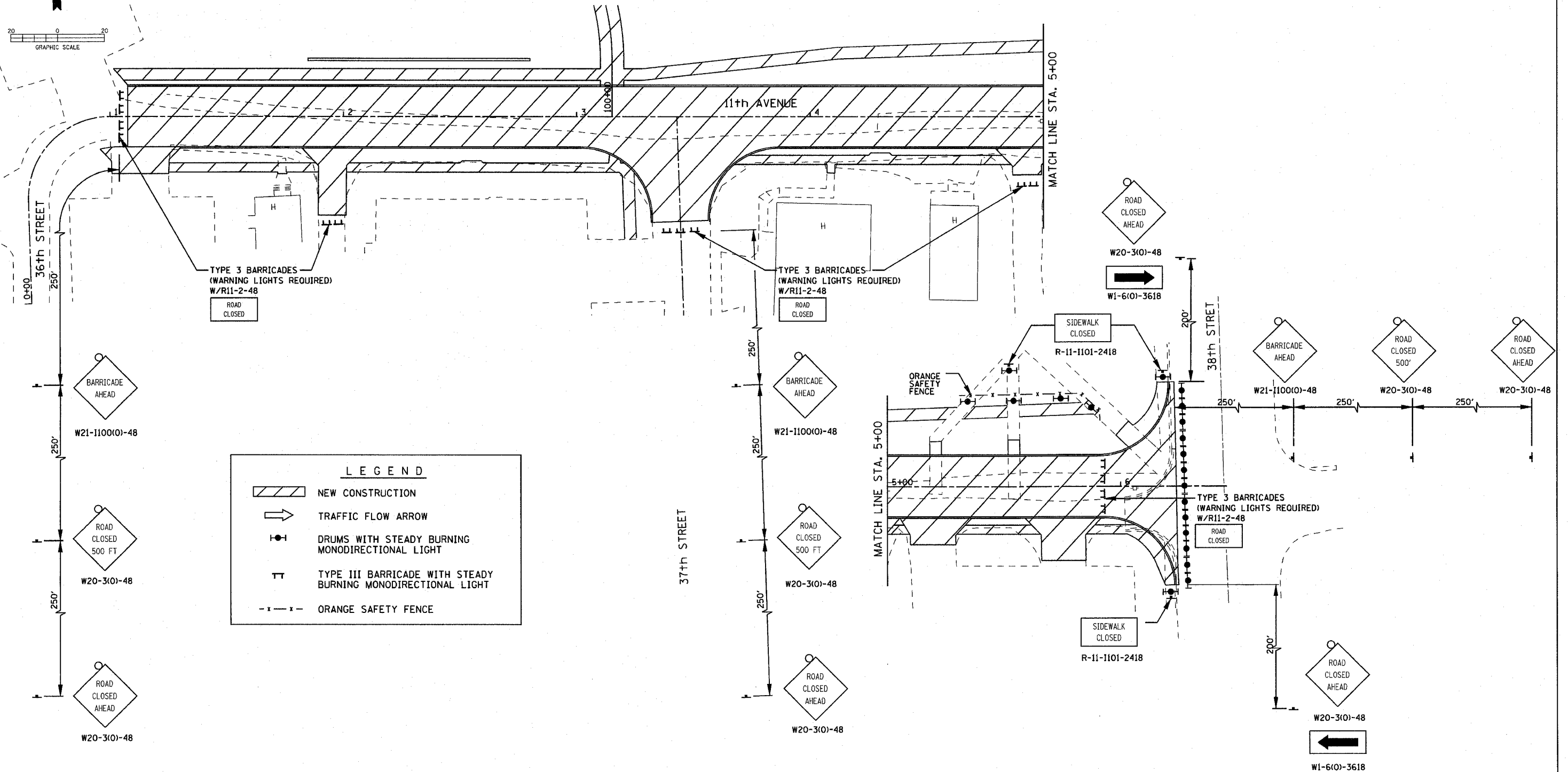
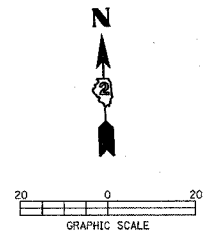

LEGEND	
	NEW CONSTRUCTION
	TRAFFIC FLOW ARROW
	DRUMS WITH STEADY BURNING MONODIRECTIONAL LIGHT
	TYPE III BARRICADE WITH STEADY BURNING MONODIRECTIONAL LIGHT
	ORANGE SAFETY FENCE

- NOTES:
1. WATERMAIN CONSTRUCTION WILL BE COMPLETED UNDER STAGE 1 TRAFFIC CONTROL. ONCE THE WATERMAIN ALONG 37TH STREET IS COMPLETED, TEMPORARY ROCK WILL BE PLACED AS DIRECTED BY THE ENGINEER TO MAINTAIN ACCESS ON 37TH STREET.
 2. STAGE 1: CONSTRUCT 11TH AVENUE, THE MULTI-USE PATH, AND THE NATURE TRAIL.

PLOT DATE * DATES *
 FILE NAME * FILES *
 PLOT SCALE * SCALES *
 USER NAME * USERS *

REVISIONS	
NAME	DATE

ILLINOIS DEPARTMENT OF TRANSPORTATION

STAGING PLAN STAGE 1

SCALE: VERT. DRAWN BY
 HORIZ. CHECKED BY
 DATE