

PHASING

1. RELOCATE OR COVER EXISTING REGULATORY SIGNS AS APPLICABLE
2. PLACE SIGNING, FLAGGERS AND TRAFFIC CONTROL DEVICES PER STD. 701601, 701701, 701901, 701606 AND IDOT DIST II DETAIL # 94.2 (ALL TEMPORARY TRAFFIC CONTROL PLACEMENT BASED ON 45 MPH DESIGN)
3. REMOVE MEDIAN IN AREAS SHOWN, CLOSE SIDE ROADS AS DIRECTED BY ENGINEER
4. CONSTRUCT AREAS TO BE USED BY TRAFFIC DURING CONSTRUCTION
5. RECONSTRUCT PERRYVILLE MEDIAN NOSE, NORTH LEG
6. POST AN ADVISORY SPEED LIMIT OF 35 MPH THROUGH CONSTRUCTION AREA

LEGEND

- PROP RECONSTRUCTION AREAS
- EXISTING CURB LINE
- PROPOSED CURB LINE
- TRAFFIC BARRICADES
- MEDIAN REMOVAL AREAS
- TEMPORARY PAVEMENT MARKING

SCALE 1"=60'

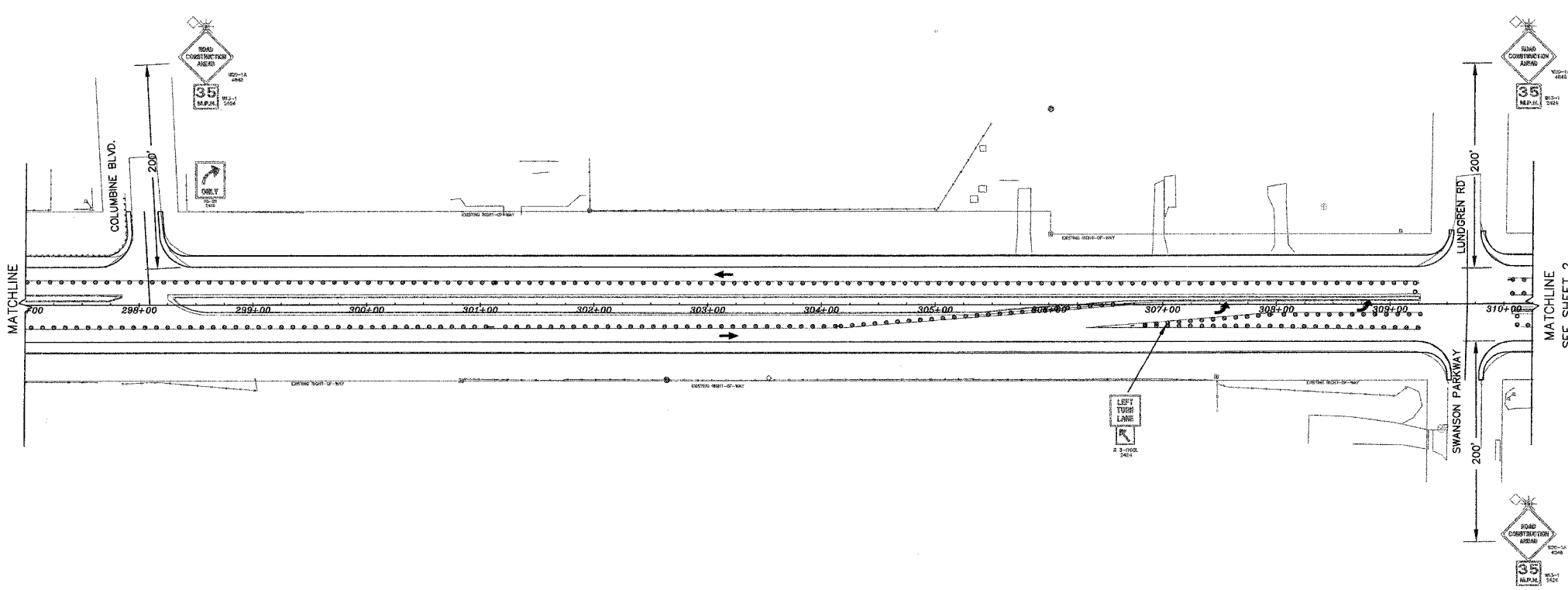

TRAFFIC CONTROL AND PROTECTION AT TURN BAYS (TO REMAIN OPEN TO TRAFFIC)

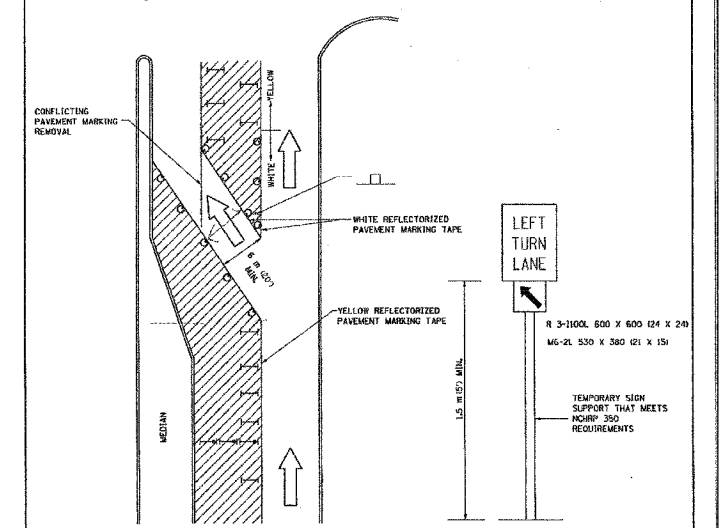

LEGEND

- WORK AREA
- LANE OPEN TO TRAFFIC
- BARRICADE OR DRUM WITH FLASHING BURNING LIGHT
- DRUM OR BARRICADE WITH STEADY BURN LIGHT
- SIGN (SEE DETAIL)
- TYPE I OR II CHECK BARRICADE WITH STEADY LIGHT BURN

GENERAL NOTES

CONES MAY BE SUBSTITUTED FOR BARRICADES OR DRUMS AT HALF THE SPACING DURING BAY OPERATIONS. CONES SHALL BE A MINIMUM OF 110 CM IN HEIGHT. STEADY BURNING LIGHTS WILL NOT BE REQUIRED ON BARRICADES OR DRUMS FOR BAY OPERATIONS. ALL LIGHTS WILL BE UNIDIRECTIONAL.

REFLECTORIZED TEMPORARY PAVEMENT MARKING TAPE SHALL BE PLACED THROUGHOUT THE BARRICADED AREA OF EACH BAY WHERE THE CLOSURE TIME IS GREATER THAN FOURTEEN DAYS.

THIS APPLICATION ALSO APPLIES WHEN WORK IS BEING PERFORMED IN THE RIGHT LANES AND THE RIGHT TURN BAY IS TO REMAIN OPEN. UNDER THIS CONDITION, "RIGHT TURN LANE" 80 300 600 X 800 424 X 210 AND 46-28 530 X 200 421 X 151 SHALL BE USED.

THESE CONTROLS SHALL SUPPLEMENT MAINLINE TRAFFIC CONTROL FOR LANE CLOSURES. LONGITUDINAL DIMENSIONS MAY BE ADJUSTED TO FIT FIELD CONDITIONS.

TRAFFIC CONTROL AND PROTECTION AT TURN BAYS TO REMAIN OPEN TO TRAFFIC SHALL BE INCLUDED IN THE COST SPECIFIED TRAFFIC CONTROL STANDARDS OF ITEMS.

ALL DIMENSIONS ARE IN MILLIMETERS UNLESS OTHERWISE NOTED.

REVISION	DATE	BY	SECTION	COUNTY	TOTAL SHEETS
REVISION	DATE	BY	SECTION	COUNTY	TOTAL SHEETS
REVISION	DATE	BY	SECTION	COUNTY	TOTAL SHEETS

SCALE: 1/4" = 10' (SHEET NO. OF SHEETS) 1/4" = 10' (SHEET NO. OF SHEETS)

TRAFFIC CONTROL AND PROTECTION AT TURN BAYS (TO REMAIN OPEN TO TRAFFIC) 94.2

I:\Projects\2008\04-00355-00-RS (Harrison & Perryville Staging) - 4/16/2008 12:52:07 PM. C:\TCS\400.dwg